

CoralCare 控制器

CoralCare Controller





用户手册
User manual

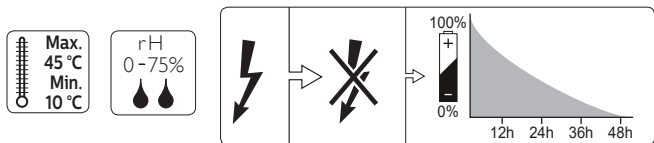
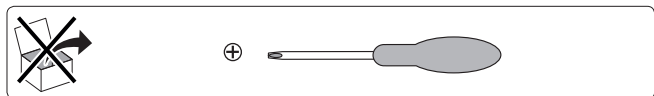
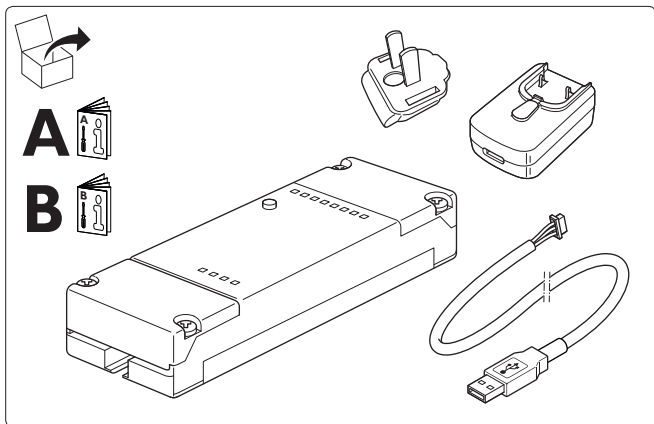

PHILIPS

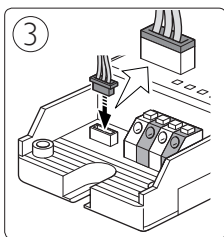
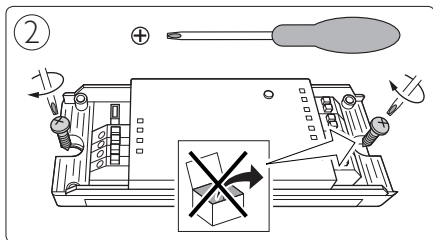
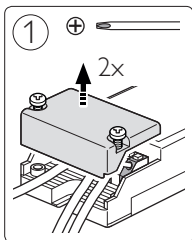





"使用 0-10V 接口"
--> 继续进行步骤 4a
"use 0-10V interface"
--> Continue with step 4a

"使用 PC 调度程序选项"
--> 跳过步骤 4a、4b
"use PC scheduler option"
--> Skip step 4a, b

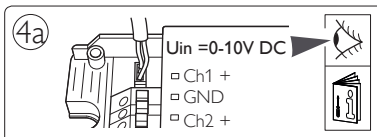

Min. $2 \times 0,50\text{mm}^2$
Max. $2 \times 1,50\text{mm}^2$
 $\varnothing 6-\varnothing 13\text{mm}$



④b 水族计算机
Aquarium computer

(蓝色通道)
(Blue channel)

Ch1+
GND

Ch2+
GND

(白色通道)
(White channel)

$U_{in} = 0-10V\ DC$

■ Ch1+ (蓝色通道)
(Blue channel)

□ GND

■ Ch2+ (白色通道)
(White channel)

□ GND

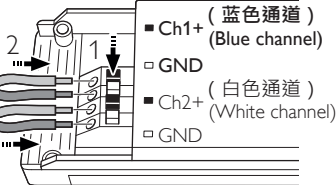

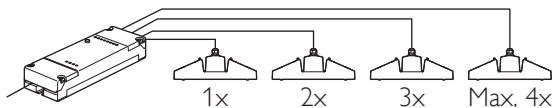
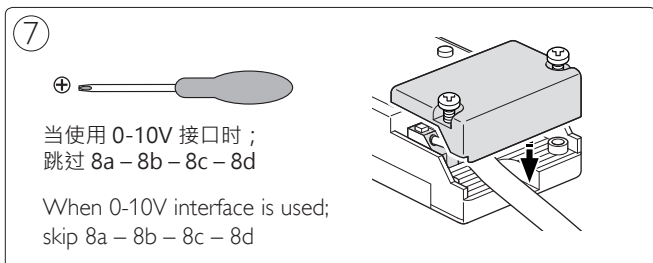
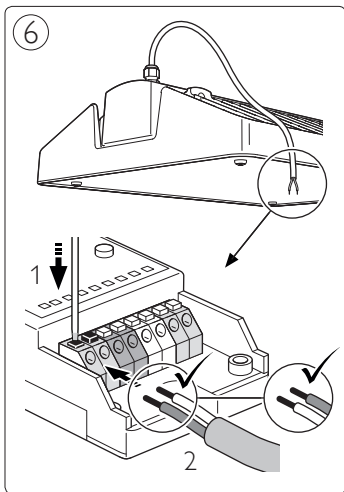
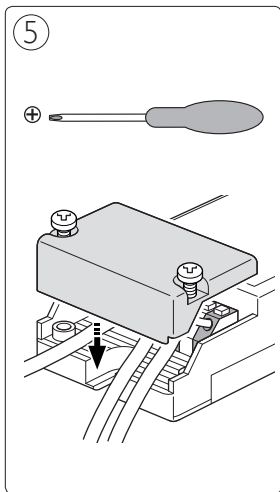

8a



下载

DOWNLOAD



请参阅: www.philips.com.cn/c-m-li/coralcare

See: www.philips.com/coralcare

8b



8c

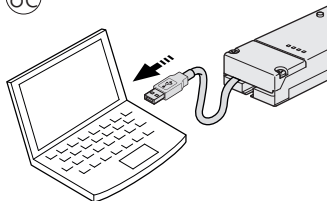

请参阅: www.philips.com.cn/c-m-li/coralcare

See: www.philips.com/coralcare

8d

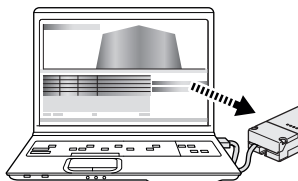

9

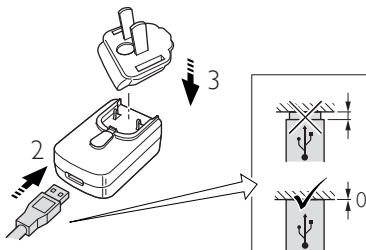
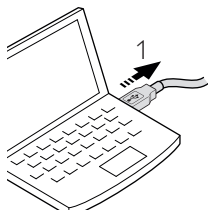



www.philips.com.cn/c-m-li/coralcare

服务热线：

8008201201/4009201201

www.philips.com/coralcare

飞利浦照明（中国）投资有限公司
中国上海市闵行区田林路888弄9号楼
邮编：200233

3222 635 71099

上次更新时间：

Last update: 16/10/17