



EB-Certalume for TL5 lamps

EB-C 114 TL5 220-240V 50/60Hz

Affordable, reliable, high frequency electronic ballast for TL5 fluorescent lamps, ideal alternative for electromagnetic (EM) ballasts

Product data

• General Characteristics

Rated Lamptype	TL5
Rated Number of Lamps	1 piece
Rated Ballast-Lamp Power	14
Line Voltage	220-240 V
Line Frequency	50/60 Hz
Housing	L 275x20x21
Energy Efficiency Index	A3

• Operating Characteristics

Automatic restart	No
Operating frequency *	40-60 kHz
Mains voltage safety (AC)	-10%/+10%
Mains voltage performance (AC)	220-240V/50-60Hz
Earth leakage current	0.7 (max) mA
Power losses gear	4 W
PowerFactor 100% output power	0.95 -
Overvoltage protection 276Vac	48 hr
Crestfactor	1.7 -

• Wiring Characteristics

Cable-Cap output-wires to earth	120 (max) pF
Color input terminals	Orange
Color output terminals	Grey

Conn.type input terminals	250 manual connector [Suitable for manual wiring and easy release button]
Conn.type output terminals	250 manual connector [Suitable for manual wiring and easy release button]
Max. cable length	0.75 m
Hot Wires	
Striplength	7.5-8.5 mm
Dual fixture Master/Slave	No [Master/Slave operation not possible]
Wcs Input terminals	0.50-1.50 mm ²
Wcs Output terminals	0.50-1.50 mm ²

• System Chars on driver level

Rated Lamp Power on TL5	14
System Power on TL5	17
Lamp Power on TL5	14
Power Loss on TL5	3

• Temperature Characteristics

T-case life	75 C
T-case maximum	65 (max) C

• Product Dimensions

Length A1	275.0 mm
Fixing Hole Distance	265.0 mm
Length A2	
Width B1	19.8 mm
Height C1	21.0 mm

PHILIPS

EB-Certalume for TL5 lamps

Fixing Hole Diameter 4.2 mm
D1

• Approval & Application Chars

EMI 9kHz .. 30 MHz EN 55015
Vibrations IEC 68-2-6 Fc
Bumps IEC 68-2-29 Eb
Humidity IEC 61347-2-3
CCC certificate Yes
CB Certificate Yes

• Product Data

Order code 913713196214

Full product code 913713196214
Full product name EB-C 114 TL5 220-240V 50/60Hz
Order product name EB-C 114 TL5 220-240V 50/60Hz
Pieces per pack 1
Packing configuration 50
Packs per outerbox 50
Bar code on pack - EAN1 8711500998903
Bar code on outerbox - EAN3 8727900886542
Logistic code(s) - 12NC 913713196214
Net weight per piece 0.044 kg

Dimensional drawing

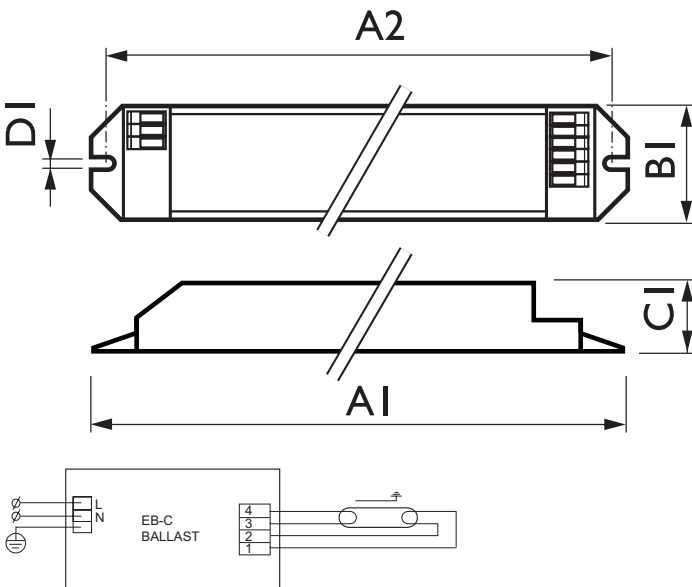

EB-C 114 TL5 220-240V 50/60Hz

Product	A1 (Norm)	A2 (Norm)	B1 (Norm)	C1 (Norm)	D1 (Norm)
EB-C 114 TL5 220-240V 50/60Hz	275.0	265.0	19.8	21.0	4.2



© 2015 Koninklijke Philips N.V. (Royal Philips)
All rights reserved.

Specifications are subject to change without notice. Trademarks are the property of Koninklijke Philips N.V. (Royal Philips) or their respective owners.

www.philips.com/lighting

2015, August 29
data subject to change