

# Field install guide

Philips Advance 503441 Emergency LED driver for EvoKit G2

This installation guide is only valid for the following Philips EvoKit models:

EvoKit	2x4 P	36L xxW	835	2 0-10 7 <b>G2</b>
	2x2 P	23L	830	1 Mk10
	2x4 P	32L	835	2 0-10
		36L	840	2 STEP
		42L		5 Mk10
		52L		

# PHILIPS

### **⚠ WARNING**

FAILURE TO FOLLOW THESE INSTRUCTIONS AND WARNINGS MAY RESULT IN SERIOUS INJURY OR SIGNIFICANT PROPERTY DAMAGE.

For your protection, carefully read these warnings and instructions in their entirety before installing or maintaining this equipment. These instructions do not attempt to cover all installation and maintenance situations. If you do not understand these instructions or if additional information is required, contact your local Philips representative. Retain these instructions for maintenance reference.

### **⚠ WARNING**

RISK OF FIRE OR ELECTRIC SHOCK

The Emergency LED driver must be installed and maintained by a professional electrician in accordance with the applicable federal, state and local laws, regulations and electrical codes, and the installation instructions provided in this document. This professional should be familiar with the construction and operation of this product and any hazards involved. If not qualified, do not attempt installation. Contact a qualified electrician.

### **⚠ WARNING**

RISK OF FIRE, ELECTRIC SHOCK OR PERSONAL INJURY

Do not install in a damaged fixture.

Before installation, turn power off.

### **⚠ WARNING**

RISK OF FIRE OR ELECTRIC SHOCK

To prevent wiring damage or abrasion, do not expose wiring to edges of sheet metal or other sharp objects.

### **⚠ WARNING**

RISK OF PERSONAL INJURY

This equipment may have sharp edges. Wear gloves to prevent cuts or abrasions when removing from carton, handling and maintaining this equipment.

### **⚠ WARNING**

RISK OF PERSONAL INJURY

Ensure all warning and cautionary markings given in the Philips Advance 503441 installation instructions are heeded.

### **⚠ WARNING**

RISK OF FIRE OR ELECTRIC SHOCK

Luminaire wiring and electrical parts may be damaged when drilling for installation of LED retrofit kit. Check for enclosed wiring and components.

### **Caution**

This kit is designed for permanent installation in ordinary (Non-Hazardous) locations in accordance with the National Electrical Code and all applicable local codes. Do not use in areas of limited ventilation or in high ambient enclosures.

### **Caution**

Do not make or alter any open holes in an enclosure of wiring or electrical components during kit installation except if specifically mentioned in these installation guide.

### **Notice**

Do not use abrasive materials, glass cleaners or other solvents on cover plate or lens. To clean the faceplate, use a mild soap solution.

Do not expose the product to substances and /or materials containing sulphur, chlorine or other halogen compounds and to chemicals mentioned in below table.

Category	Chemical Name
Solvents	Toluene, xylene, benzene, chloromethane, chloroform, ethyl acetate, butyl acetate, acetone, MEK, MIBK
Acid	HCl, H <sub>2</sub> SO <sub>4</sub> , HNO <sub>3</sub>
Alkali	KOH, NaOH, LiOH, Ca(OH) <sub>2</sub>
Oil	Diesel oil, petroleum, hydro carbons

### **Notice**

Ensure an un-switched hot circuit is available to the fixture. This is required for proper emergency fixture operation.

### **Notice**

Handle components with care. Do not drop, slide or scratch any of the components to prevent visual damage to the product, loss of functionality or difficulties during installation.

# Field install Philips Advance 503441 Emergency LED driver

## Set contains

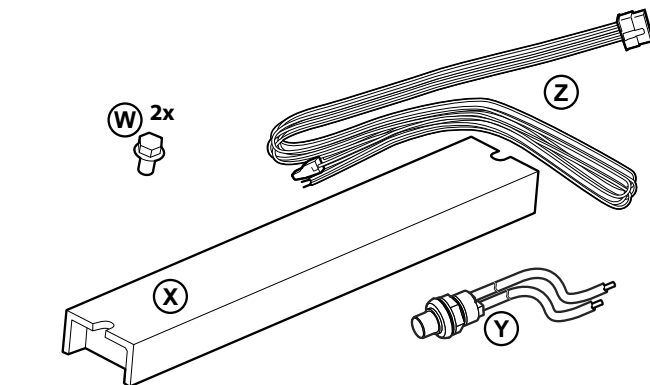

W Screw (2x)  
X Emergency LED driver

Y Test switch  
Z Wiring harness

## Tools required

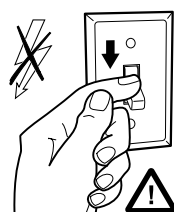
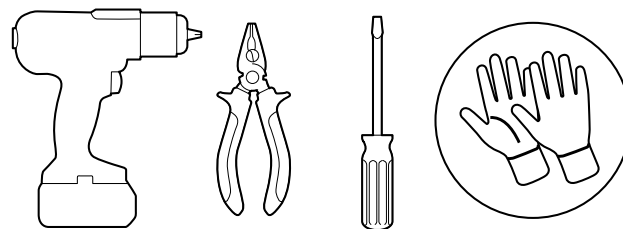

## ⚠ WARNING

RISK OF FIRE, ELECTRIC SHOCK  
OR PERSONAL INJURY

Before installation, turn power off.

## Remove Diffuser

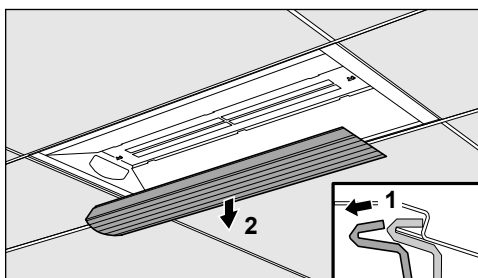
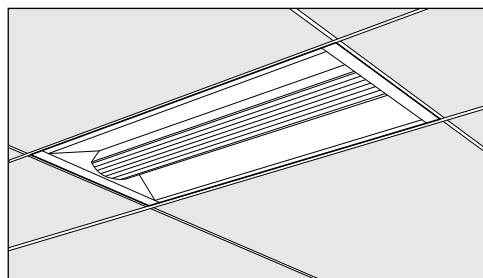

**1** Remove Diffuser by pressing one side of the Diffuser.

## Remove Closing Panel

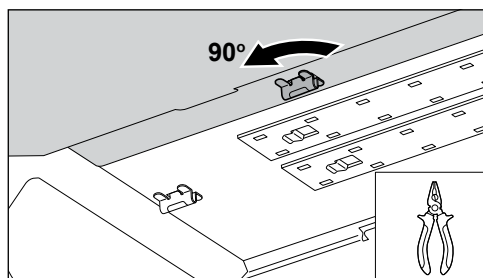

**2** Turn each fastener 90 degrees.

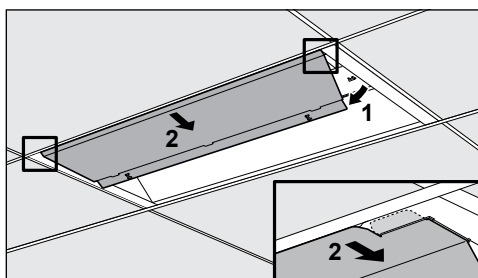

**3** Lower the Closing Panel and slide it out.

## Mains disconnection

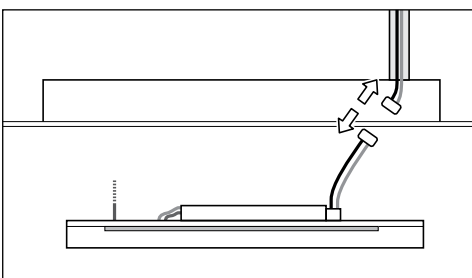

**4** Disconnect mains.

## Ground disconnection (Situation 1 - 2)

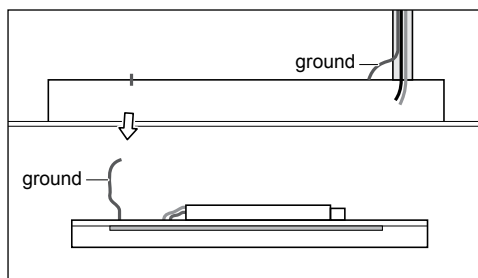
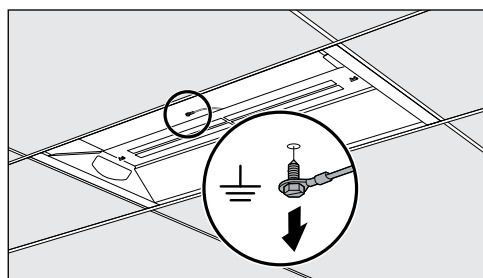

**5a** Situation 1 Grounding:  
Unscrew grounding cable.

**5b** Situation 2 Grounding:  
Disconnect the ground lead from conduit.

## Remove LED Panel

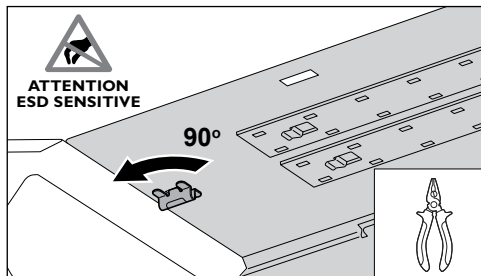

**6** Turn each fastener 90 degrees.

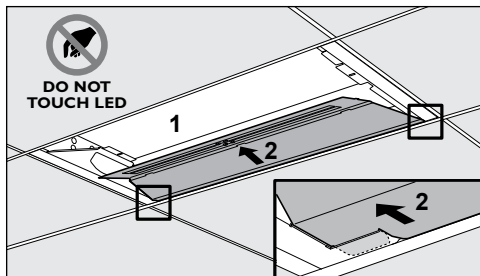

**7** Lower LED panel and slide it out.

## Notice

Do not touch the LEDs with hands or tooling! Touching LEDs can lead to failure of the product.

## Installation Philips Advance 503441 Emergency LED driver (X)

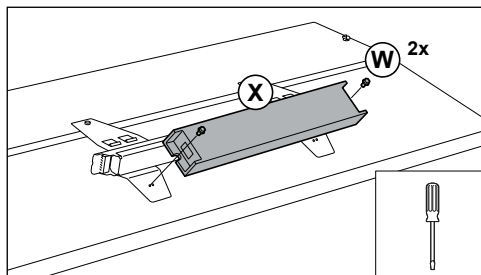

**8** Secure 503441 (X) to the back side of LED Panel using two screws (W).

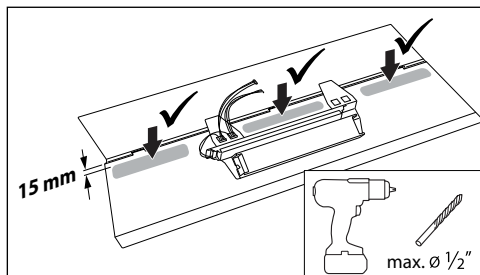

**9** Drill 1/2" hole in the LED Panel for installation of LED/test switch on indicated area.

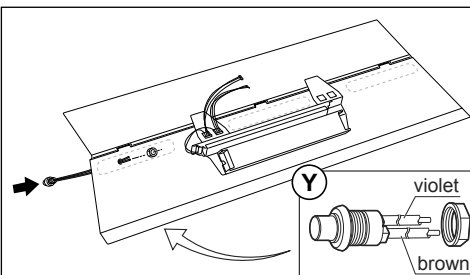

**10** Install the test switch (Y) by feeding the violet and brown wires through this 1/2" hole and hand tighten the plastic nut included with the test switch/LED combo. Add connect from test switch to wiring harness (Z) (violet - violet, brown - brown).

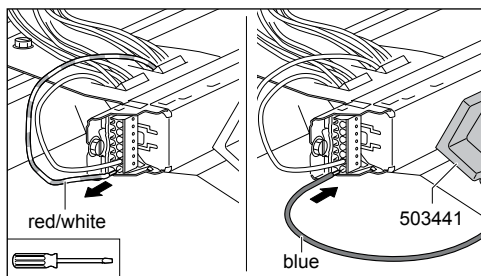

**11** Disconnect the red/white single wire from the EvoKit driver. Replace it with the blue output wire from the 503441 (Z). Place a wire nut over the original red/white wire for proper isolation.

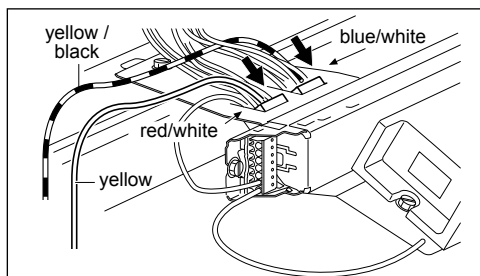

**12** Connect the yellow output wire from the 503441 to the EvoKit red/white wire connection block and the yellow/black output wire from the 503441 (Z) to the EvoKit blue/white wire connection block.

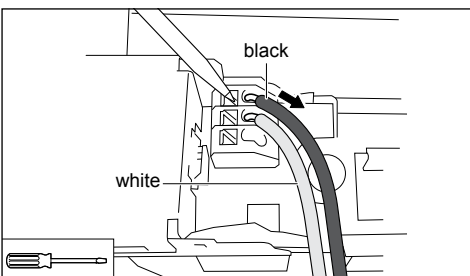

**13** Disconnect black wire and insert white/black wire (Z) in the EvoKit driver.

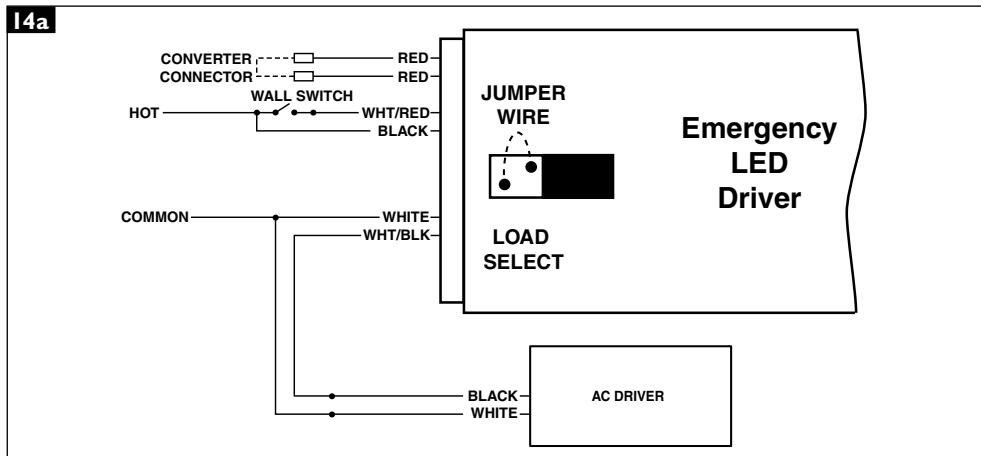

**14a** Connect WHT/RED, BLACK and WHITE (2x) wires (Z) as per the 503441 wiring diagram.

Connect the 503441 red to red as indicated in schematic (Z).

**I4b**

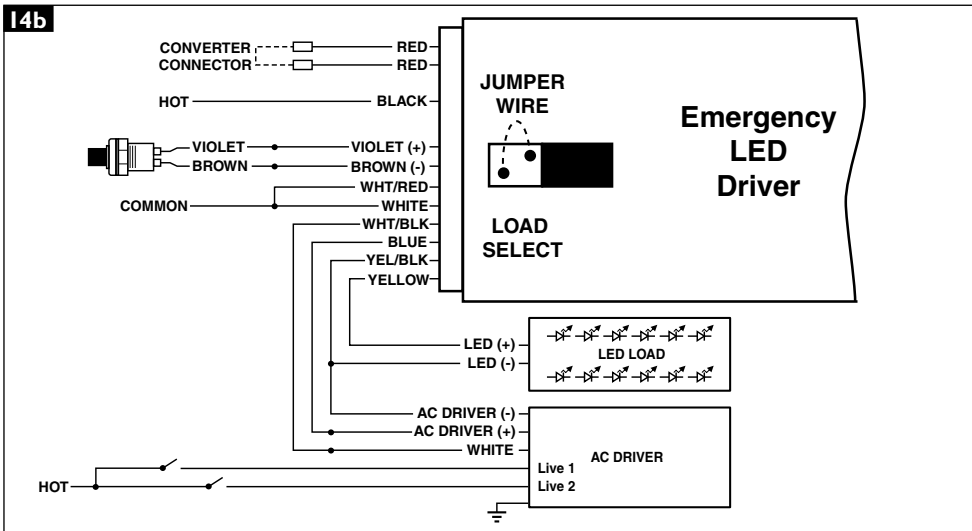

**I4b** Emergency LED driver wiring in combination with **STEP** version.

### Notice

For the EvoKit, do not connect the jumper wire / load select (yellow/red) on 503441.

## Installation LED Panel

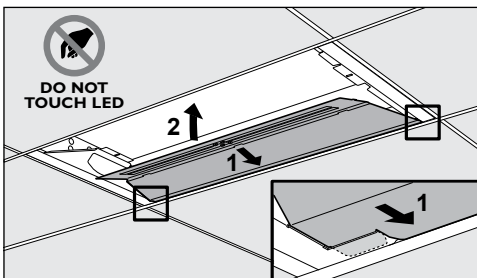

**I5** Install LED panel in between troffer and T-grid, making sure the tabs at each corner of the LED panel slide into the respective slots on the side panel.

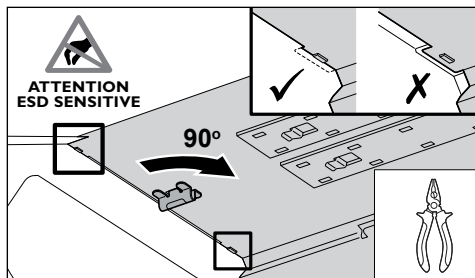

**I6** Push LED panel upward into position so that the tabs sits above the side panels (this may require a push up on the tabs while pushing outward on the side panels). Fixate panels and establish ground by turning each fastener 90 degrees.

### WARNING

RISK OF PERSONAL INJURY

While installing the LED panel and Closing Panel, make sure the electrical wiring is not clamped between panels.

### Notice

Do not touch the LEDs with hands or tooling! Touching LEDs can lead to failure of the product.

## Ground connection (Situation 1 - 2)

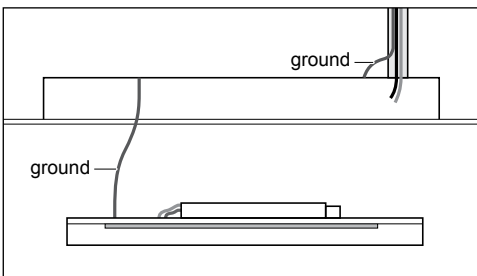

**I7a** Situation 1 Grounding:  
Screw grounding cable from Led Panel to original troffer if host fixture ground connection is made through host fixture.

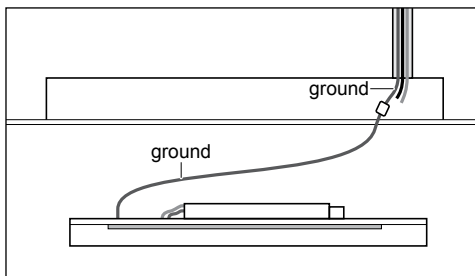

**I7b** Situation 2 Grounding:  
Connect to the incoming ground lead from conduit.

### WARNING

RISK OF PERSONAL INJURY

Proper grounding of EvoKit metal parts is required to ensure personal safety.

### Notice

Make new electrical connections to mains by employing applicable connectors in accordance with the applicable federal, state and local laws, regulations and electrical codes.

## Mains connection

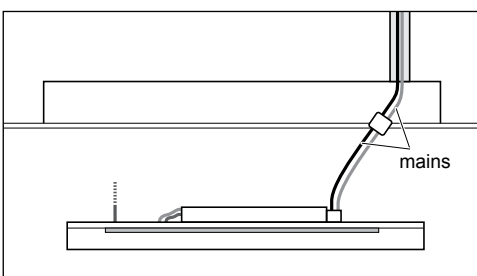

**I8** Connect mains and hide connected wires behind LED Panel.

## Installation Closing Panel

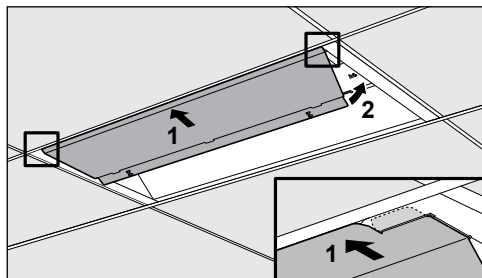

**19** Install Closing Panel in-between troffer and T-grid.

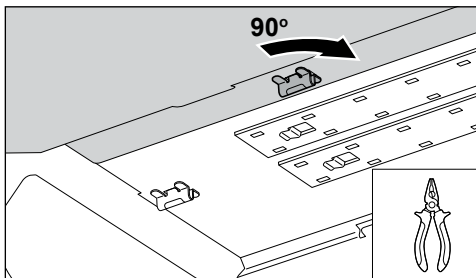

**20** Fixate panels and establish ground by turning each fastener 90 degrees.

### **⚠ WARNING**

**RISK OF FIRE OR ELECTRIC SHOCK**

While installing the LED panel and Closing Panel, make sure the electrical wiring is not clamped between panels.

## Installation Diffuser

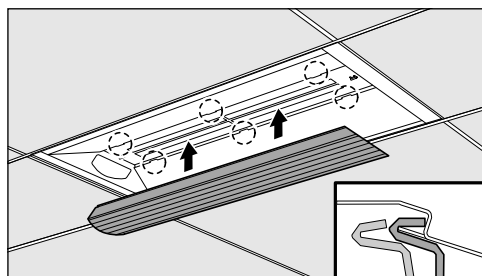

**21** Slide Diffuser under the tabs on one side from either Panel and press diffuser over the tabs on opposite panel.

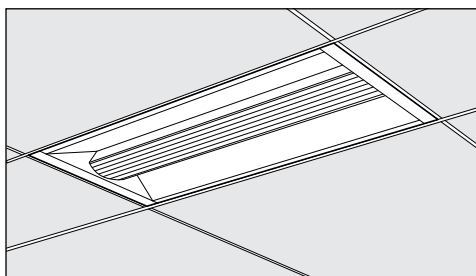

© 2014 Philips Lighting Company.  
A Division of Philips Electronics North  
America Corporation.  
All rights reserved.  
Printed in USA 9/14  
[www.philips.com](http://www.philips.com)

Philips Lighting Company  
200 Franklin Square Drive  
Somerset, NJ 08873  
1-800-555-0050

Philips Lighting  
281 Hilmont Road  
Markham, Ontario  
Canada, L6C 2S3  
1-800-555-0050  
A Division of Philips Electronics Ltd.