



Calculite LED 4" generation 3 features industry leading visual comfort, excellent uniform illumination over time, and patented installation flexibility.

Complete luminaire = Frame + Engine + Trim + Accessories (optional)

Project: _____

Location: _____

Cat.No: _____

Type: _____

Lamps: _____ Qty: _____

Notes: _____

Frame

example: 4RNIP

Series	Installation	Voltage/Options	
4R			
4R 4" Non-IC Round	N New construction	— Universal 120 V/277 V (specify for Power Over Ethernet) EM Emergency (see page 2 for details and limitations) ¹ IP Interact Pro ready (for 0-10V engine only)	LC Chicago Plenum 3 347 V (not compatible with ELV dimming) 3IP 347 V with Interact Pro (for 0-10V engine only)
	R Remodeler	— Universal 120 V/277 V (specify for Power Over Ethernet)	3 347 V (not compatible with ELV dimming)

Engine

example: C4L15835NZ10U

Series	Lumens	CRI	CCT	Beam	Dimming	Voltage
C4L						
C4L Calculite LED 4"	05 500 lm (Z10 only) 10 1000 lm 15 1500 lm 20 2000 lm 25 2500 lm ² 30 3000 lm ²	8 80 CRI 9 90 CRI	27 2700 K 30 3000 K 35 3500 K 40 4000 K	N Narrow (43°) M Medium (56°) W Wide (76°)	Z10 0-10 V 1% SOL EldoLED Solo 0-10V 0.1% D Dali 0.1% L Lutron LDE1 EcoSystem (fade-to-black) DMX Digital Multiplexing	U Universal 120 V/277 V/347 V
					E ELV (for up to 2000lm only) P Power over Ethernet (PoE) Only compatible with 1000 (10) to 2500 (25) lumen configurations.	1 120 V E Ethernet 48 V DC

Trim

example: C4RDLCCP

Series	Aperture	Style	Finish	Flange
C4	R	DL		
C4 Calculite LED 4"	R Round	DL Downlight	BK Black (anodized) CL Specular clear	CC Comfort clear CD Comfort clear diffuse CZ Champagne bronze
			WH White (matte)	P Polished (matches aperture) F Flangeless (requires CA4RFT)
		SL Shower light (non-conductive) ³	WH White (matte)	F Flangeless (requires CA4RFT) — Not applicable

Accessories

CA4RFT	Mud-in ring for use in flangeless trim installations (ordered with a flangeless trim)
CAEM	Field installable EM pack (for use with new construction frame only)
C4RVPWH	IP65 Rated vandal proof matte white accessory mounts onto flangeless trims (C4RDL*F) and new construction frame only
AMS	ActiLume multi-sensor (optional accessory for PoE configurations)
SWZDT	SpaceWise wireless controller with dwell time functionality (compatible with all 0-10V options, see SWZDT spec sheet)
SRAINT	InterAct Office Accessory (for use with Lightolier UniFrame 0-10V products)

- Emergency (EM) frame includes emergency battery with ceiling and reflector mountable test switch (see page 2 for details and limitations).
- The 2500lm (25) and 3000lm (30) packages have marked spacing requirements (see page 3).
- Non-conductive flush mount lens with pre-installed gasket (matte white non-conductive flange with diffuse lens that is flush with the flange).

C4RDL Calculite LED 4" gen 3

Round Downlight

Frame-in-kits

New Construction:

Galvanized stamped steel for dry or plaster ceilings. Preinstalled telescoping mounting bars from 13" to 24". For 4' distances, use 1/2" EMT, 1-1/2" x 1/2" U or C channel.

Max ceiling thickness is 2" (51 mm) including PoE frame 4.88" (124 mm) plenum depth for installation.

Emergency:

For reflector mounted emergency test switch add "EM" to end of catalog code (example: C4RDLCCEM). Leave blank for ceiling mounted test switch. Reflector mounted test switch requires above ceiling access.

Patented install Mounting frame:

- Pre-installed mounting bars for fast and tool-less installs into T-grid & hat channel ceilings.
- Close-cut aperture design eliminates possibility of gap between ceiling opening and reflector flange.
- Separate wiring compartment for wiring frame to building allows inspection prior to light engine install.
- Simple plug-and-play connection between frame and light engine from below ceiling.

Dimming

- Advance 0-10V 1% dimming
- Lutron Hi-lume EcoSystem H Series 1% dimming
- EldoLED ECoDrive Dali 1% dimming
- EldoLED SOLOdrive 0-10V 0.1% dimming
- EldoLED DMX POWERdrive

Power over Ethernet

Powered via Lightolier PoE lighting controller:

Complies with FCC rules per Title 47 part 15 (Class A) for EMI / RFI (conducted & radiated). PoE lighting controller accessible from below ceiling.

Optical systems

Comfort throughout the space:

True 50° physical cutoff and 45° reflected cutoff

Quality of light:

2 SDCM ensures color consistency from fixture to fixture and over the luminaire's long lifetime.

Light engine

Quick connect power pack allow for easy installation and replacement from below ceiling with no need for additional wiring. This allows for:

- Frame and ceiling installation to be performed while still finalizing details such as lumen packages, CCT and control type.
- Easy replacement of electronics at end of life with minimal wasted material and labor required.
- Ease and upgradability of technology.

Wired Controls Options

Interact Office Wired (PoE):

- PoE based IoT connected lighting solution for large enterprises that span across multiple floors, buildings and require multiple gateways.
- Use Interact Office software and insights to increase building efficiency, achieve building wide integration and optimize space through occupancy analytics.
- Supports advanced IoT Apps on Personal Control, Space Management, wayfinding, room/desk reservation and offers open APIs for light control and data exchange.
- PoE lighting controller is accessible from below.
- Integral sensor option for occupancy sensing (PIR) and/or daylight harvesting available for additional energy savings.
- Optional integral emergency controller and battery pack provides 600lm nominal output.
- Test switch and indicator light mounted on side of chassis on one end.
- Emergency battery has a 3 month pre-installed shelf life, and must be stored and installed in environments of 20C to 30C (-4F to 86F) ambient, and 45-85% relative humidity.
- For more information on Interact Office Wired, visit: www.interact-lighting.com/office or www.usa.lighting.philips.com/systems/systemareas/offices.

Interact Office Wired (PoE),

Static White and Tunable White:

- A wireless IoT connected lighting solution for large enterprises that span across multiple floors, buildings and require multiple gateways.
- View all your projects under one dashboard and easily compare insights from multiple projects in one view.
- Compatible Zigbee Green Power wall dimmer and wireless Occupancy or Daylight & Occupancy sensors available.
- Use Interact Office software and insights to increase building efficiency, achieve building wide integration and optimize space through occupancy analytics.
- Supports advanced IoT Apps on wayfinding, room/desk reservation and offers open APIs
- Requires compatible Interact Office Gateway and internet connectivity for commissioning.
- For more information on Interact Office Wireless, visit: www.interact-lighting.com/office or www.usa.lighting.philips.com/systems/systemareas/offices.

Interact Pro (IAP)

- Interact Pro brings the power of connected lighting to small and medium businesses without the complexity usually associated with connected lighting.
- Interact Pro includes an app, a portal and a broad portfolio of wireless Luminaires, lamps and retrofit kits all working on the same system.
- Commissioning via Interact Pro App (Android or iPhone).
- Prepare commissioning remotely via Interact Pro portal.
- Requires compatible Interact Pro Gateway and internet connectivity for commissioning.
- Compatible with UID8451/10 ZigBee Greenpower wireless dimmer switch.
- Compatible with wireless Occ sensor (OCC SENSOR IA CM IP42 WH 10/1) or wireless Day/Occ sensor (OCC MULTI SENSOR IA CM WH 10/1).
- For more information on Interact Pro visit: www.interact-lighting.com/pro.
- For more information on Interact Ready visit: www.philips.com/interact-ready.

Options and Accessories

Flangeless mud-in ring: Use CA4RFT

for use with flangeless plaster installations.

Sloped ceilings: Compatible with sloped ceiling adapters (see SCA spec sheet).

Vandal Proof: Use C4RVPWH for an IP65 rated vandal proof matte white accessory. Must be ordered with flangeless trim and new construction frame.

ENERGY STAR® exceptions

- 500lm & 90 CRI configurations
- Champagne Bronze & Black finishes
- 347V & Emergency voltage/options
- Dali, EldoLED Solo & PoE drivers

Title 24 exceptions

- 1000lm configurations
- Champagne Bronze & Black finishes

Labels and Listings

- cULus listed for wet locations
- ENERGY STAR® certified
- CEC Title 24 JA8 certified
- CCEA (frames with *LC suffix)
- IP65 rated with vandal proof accessory

Warranty



5 year limited warranty

Visit Signify.com/warranties for more information on Signify's standard 5-year limited warranty on complete luminaire systems.

C4RDL Calculite LED 4" gen 3

Round Downlight

Narrow

Light engine	Input volts	Input freq	Input current	Drive current	Input power	THD power	Power factor
C4L05_NZ10U	120V	50/60Hz	0.05	110 mA	6W	<20%	>0.95
	277V		0.03			<20%	>0.90
C4L10_NZ10U	120V	50/60Hz	0.08	230 mA	11W	<15%	>0.95
	277V		0.04			<20%	>0.95
C4L15_NZ10U	120V	50/60Hz	0.12	360 mA	16W	<10%	>0.95
	277V		0.06			<15%	>0.95
C4L20_NZ10U	120V	50/60Hz	0.17	490 mA	21W	<10%	>0.95
	277V		0.08			<15%	>0.95
C4L25_NZ10U	120V	50/60Hz	0.22	640 mA	27W	<10%	>0.95
	277V		0.10			<15%	>0.95
C4L30_NZ10U	120V	50/60Hz	0.27	790 mA	33W	<10%	>0.95
	277V		0.13			<15%	>0.95

Medium/Wide

Light engine	Input volts	Input freq	Input current	Drive current	Input power	THD power	Power factor
C4L05_MZ10U	120V	50/60Hz	0.05	110 mA	6W	<20%	>0.95
	277V		0.03			<20%	>0.90
C4L10_MZ10U	120V	50/60Hz	0.08	230 mA	11W	<15%	>0.95
	277V		0.04			<20%	>0.95
C4L15_MZ10U	120V	50/60Hz	0.12	350 mA	16W	<10%	>0.95
	277V		0.06			<15%	>0.95
C4L20_MZ10U	120V	50/60Hz	0.16	470 mA	21W	<10%	>0.95
	277V		0.08			<15%	>0.95
C4L25_MZ10U	120V	50/60Hz	0.21	610 mA	25W	<10%	>0.95
	277V		0.09			<15%	>0.95
C4L30_MZ10U	120V	50/60Hz	0.26	770 mA	31W	<10%	>0.95
	277V		0.12			<15%	>0.95

Narrow (Power over Ethernet)

Light engine	Input				
	Volts ¹	Voltage ²	Freq	Current	Power
C4L10___NPE	53V	51-54V	DC	160 mA	8.9 W
C4L15___NPE	53V	51-54V	DC	250 mA	13.6 W
C4L20___NPE	53V	51-54V	DC	340 mA	18.5 W
C4L25___NPE	53V	51-54V	DC	460 mA	24.6 W

Medium (Power over Ethernet)

Light engine	Input				
	Volts ¹	Voltage ²	Freq	Current	Power
C4L10___MPE	53V	51-54V	DC	160 mA	8.8 W
C4L15___MPE	53V	51-54V	DC	250 mA	13.4 W
C4L20___MPE	53V	51-54V	DC	320 mA	17.6 W
C4L25___MPE	53V	51-54V	DC	430 mA	23.2 W

Wide (Power over Ethernet)

Light engine	Input				
	Volts ¹	Voltage ²	Freq	Current	Power
C4L10___WPE	53V	51-54V	DC	160 mA	8.8 W
C4L15___WPE	53V	51-54V	DC	250 mA	13.4 W
C4L20___WPE	53V	51-54V	DC	320 mA	17.6 W
C4L25___WPE	53V	51-54V	DC	430 mA	23.2 W

1. Nominal input volts.
2. Preferred volt range.

Marked spacing applications

Light engine	2500lm	3000lm
C4L_Z10U series	—	X
C4L_LU series	X	X
C4L_DU series	—	X
C4L_DMXX series	—	X

Modules marked with an X require marked spacing:
 - Center-to-center of adjacent luminaires: 24" (610mm)
 - Luminaire center to side building member: 12" (305mm)

Lifetime (TM-21) data

Lumens	Narrow beam	Medium/Wide beam*
500lm 1000lm 1500lm	L90 @ 60,000hrs.	L90 @ 60,000hrs.
2000lm 2500lm 3000lm*	L90 @ 60,000hrs.	L85 @ 60,000hrs.

* Lutron 3000lm with Medium/Wide beam is L80 @ 60,000hrs.

In accordance with CAN ICES-005-A/ NEB-005-A and FCC Part 15-A.

C4RDL Calculite LED 4" gen 3

Round Downlight

New Construction (N)

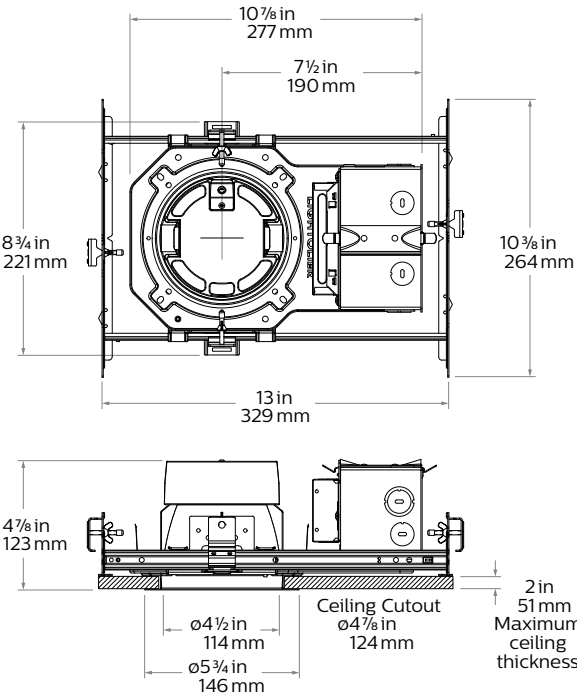

Chicago Plenum (LC)

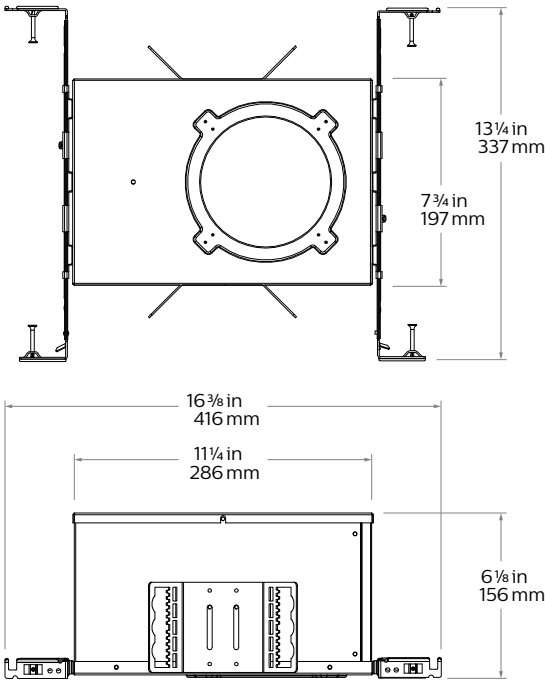

Remodeler (R)

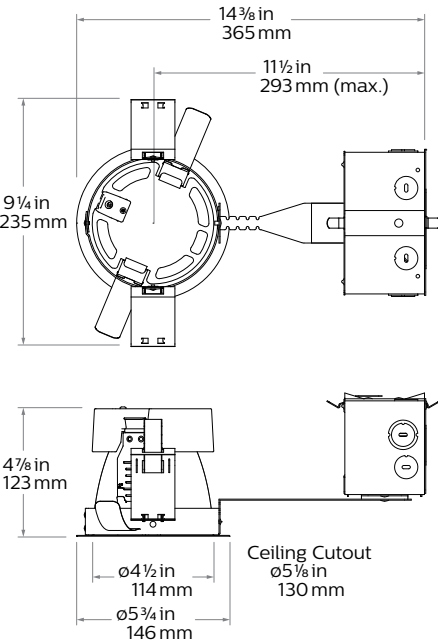

Flangeless mud-in ring (CA4RFT) accessory

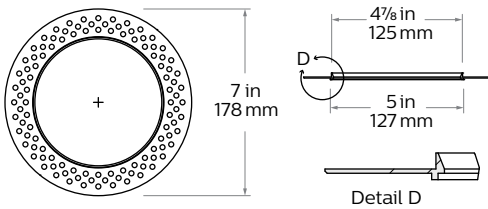

Vandal Proof (VP) accessory

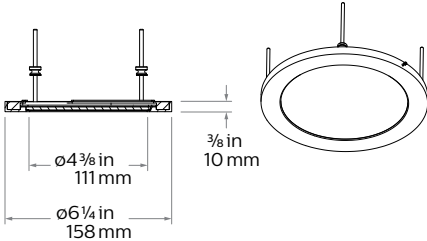

C4RDL Calculite LED 4" gen 3

Round Downlight

Reflector



Specular clear (CL): Most specular and most efficient finish, delivers maximum photometric performance but can produce a mirror image effect of the interior space.



Champagne bronze (CZ): Semi-specular finish that softens light at the source of the reflector while providing a warmer reflector appearance (slightly warmer).



Comfort clear (CC): Semi-specular finish that softens the light at the source of the reflector and creates a subtle, even luminance from the reflector cone.



White (WH): (matte) Brightest illuminated aperture and provides the smoothest transition to most ceilings when off (white is only available with a white flange).



Comfort clear diffuse (CD): Slightly diffuse clear finish, that eliminates iridescence and reduces the mirror image effect inherent with specular finishes.



Black (BK): (matte) Specular finish that provides the lowest aperture brightness possible and significantly reduces source identification in a ceiling.



Vandal proof (VP): Provides an elegant solution for vandal resistant needs. One piece machined aluminum ring with impact resistant clear lens. Flangeless (F) flange must be ordered. Provides the luminaire with an IK10 impact and IP65 rating.



Shower light (SL): Wet location rated shower light applicable in any installation requiring dead front trims, interior or exterior non-corrosive applications, or where a diffused lens at the ceiling is required (non-conductive).

Flange



White (-): (matte) Provides the smoothest transition to ceilings when off.



Polished (P): (matches aperture) Produces a continuous look throughout the reflector (aperture matching).



Flangeless (F): (flush-mount) Creates a flush, virtually seamless transition from aperture to ceiling.

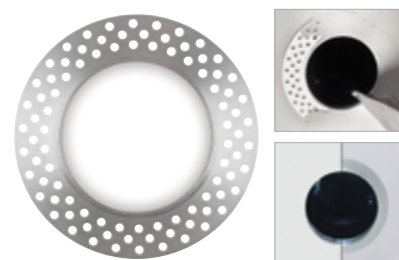

Mud-in ring (FT): Low profile, machined aluminum mud-in ring provides a raised rib to plaster up to and a 3/16" flange thickness. The ring is attached to the ceiling material as opposed to the frame-in kit to avoid conduction of heat and vibration which can cause yellowing or cracking of the plaster.

C4RDL Calculite LED 4" gen 3

Round Downlight

Narrow beam, 1500lm Engine, 103.8 lm/W at 14.7W or 112.2 lm/W at 13.6W (Power over Ethernet)

Candela Curve

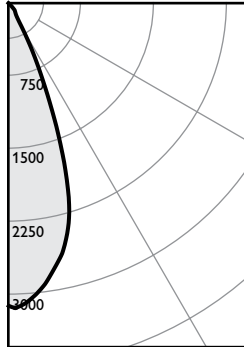

Frame: **C4RN or 4RN**
Engine: **C4L15835NZ10U**
Trim: **C4RDLCL**

Output lumens: 1526 lms
Input watts: 14.7 W
CRI: 80 min
CCT¹: 3500K
Spacing Crit.: 0.6
Beam Angle: 43°

Zonal summary

Zone	Lumens	%Luminaire
0-30	1354	88.7%
0-40	1469	96.3%
0-60	1526	100.0%
0-90	1526	100.0%

Angle	Mean CP	Lumens
0	3112	
5	3044	282
10	2785	
15	2410	652
20	1672	
25	837	420
30	324	
35	163	115
40	128	
45	77	57
50	0	
55	0	0
60	0	
65	0	0
70	0	
75	0	0
80	0	
85	0	0
90	0	

Single unit data

Height to lighted plane	Initial center beam foot-candles	Beam diameter (ft)*
5'	124	3.0'
6'	86	3.6'
7'	64	4.2'
8'	49	4.8'
9'	38	5.4'

* Beam diameter is where foot-candles drop to 50% of maximum.

Multiple unit data - RCR 2

Spacing on center	Initial center beam foot-candles	Watts per sq. ft.
5'	71.3	0.65
6'	46.8	0.43
7'	33.4	0.31
8'	27.8	0.25
9'	22.3	0.20

38' x 38' x 10' Room, Workplane 2.5' above floor, 80/50/20% Reflectances

Efficacy: 103.8lm/w
Report#: T20161390

Adjustment factors

Finish	CCT	Lumens
CL = 100%	80CRI 4000K = 107%	3000lm = 200%
CC = 95%	80CRI 3500K = 100%	2500lm = 167%
CD = 87%	80CRI 3000K = 99%	2000lm = 133%
CZ = 63%	80CRI 2700K = 93%	1500lm = 100%
WH = 87%	90CRI 3000K = 87%	1000lm = 67%
BK = 57%	90CRI 2700K = 81%	500lm = 33%

Coefficients of utilization

Ceiling	80%				70%				50%				30%				0%
Wall	70	50	30	10	50	10	50	10	50	10	50	10	50	10	50	10	0
RCR	Zonal cavity method - Effective floor reflectance = 20%																
0	119	119	119	119	116	116	111	111	106	106	100	100	106	106	100	95	
1	114	112	110	108	110	106	106	103	102	100	95	95	102	100	95	91	
2	110	106	102	99	104	98	101	96	98	94	91	91	98	94	91	86	
3	105	100	96	92	99	92	96	90	94	89	86	86	94	89	86	82	
4	101	95	90	87	94	86	92	85	90	84	82	82	90	84	82	78	
5	97	90	85	82	89	81	88	81	86	80	78	78	86	80	78	74	
6	93	86	81	77	85	77	84	77	83	76	74	74	83	76	74	71	
7	90	82	77	74	81	73	80	73	79	73	71	71	79	73	71	68	
8	86	79	74	70	78	70	77	70	76	69	68	68	76	69	68	65	
9	83	75	70	67	75	67	74	67	73	66	65	65	73	66	65	62	
10	80	72	67	64	72	64	71	64	70	64	62	62	70	64	62	60	

Medium beam, 1500lm Engine, 114.6 lm/W at 14.2W or 121.4 lm/W at 13.4W (Power over Ethernet)

Candela Curve

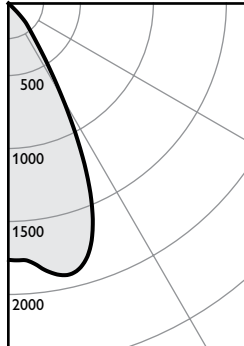

Frame: **C4RN or 4RN**
Engine: **C4L15835MZ10U**
Trim: **C4RDLCL**

Output lumens: 1627 lms
Input watts: 14.2 W
CRI: 80 min
CCT¹: 3500K
Spacing Crit.: 0.9
Beam Angle: 56°

Zonal summary

Zone	Lumens	%Luminaire
0-30	1269	78.0%
0-40	1537	94.5%
0-60	1627	100.0%
0-90	1627	100.0%

Angle	Mean CP	Lumens
0	1760	
5	1783	174
10	1886	
15	1887	524
20	1702	
25	1283	572
30	762	
35	406	268
40	236	
45	116	89
50	14	
55	0	1
60	0	
65	0	0
70	0	
75	0	0
80	0	
85	0	0
90	0	

Single unit data

Height to lighted plane	Initial center beam foot-candles	Beam diameter (ft)*
5'	70	4.5'
6'	49	5.4'
7'	36	6.3'
8'	28	7.2'
9'	22	8.1'

* Beam diameter is where foot-candles drop to 50% of maximum.

Multiple unit data - RCR 2

Spacing on center	Initial center beam foot-candles	Watts per sq. ft.
5'	74.8	0.63
6'	49.1	0.41
7'	35.0	0.30
8'	29.2	0.25
9'	23.4	0.20

38' x 38' x 10' Room, Workplane 2.5' above floor, 80/50/20% Reflectances

Efficacy: 114.6lm/w
Report#: T20161397

Adjustment factors

Finish	CCT	Lumens
CL = 100%	80CRI 4000K = 102%	3000lm = 200%
CC = 95%	80CRI 3500K = 100%	2500lm = 167%
CD = 87%	80CRI 3000K = 97%	2000lm = 133%
CZ = 63%	80CRI 2700K = 87%	1500lm = 100%
WH = 87%	90CRI 3000K = 77%	1000lm = 67%
BK = 57%	90CRI 2700K = 73%	500lm = 33%

Coefficients of utilization

Ceiling	80%				70%				50%				30%				0%
Wall	70	50	30	10	50	10	50	10	50	10	50	10	50	10	50	10	0
RCR	Zonal cavity method - Effective floor reflectance = 20%																
0	119	119	119	119	116	116	111	111	106	106	100	100	106	106	100	94	
1	114	111	109	107	109	105	105	102	101	99	94	94	96	92	88	88	
2	108	104	100	97	102	96	99	94	96	91	85	85	91	85	82	82	
3	103	97	93	89	96	88	93	87	91	85	82	82	86	80	77	77	
4	98	91	86	82	90	81	88	81	86	80	77	77	81	74	72	72	
5	94	86	80	76	85	76	83	75	81	74	72	72	76	69	68	68	
6	89	81	75	71	80	71	79	70	77	70	68	68	73	66	64	64	
7	85	76	70	66	76	66	74	66	73	66	64	64	70	64	62	62	
8	81	72	66	62	71	62	70	62	69	62	60	60	66	58	57	57	
9	77	68	63	59	68	59	67	58	66	58	57	57	63	55	54	54	
10	74	65	59	55	64	55	63	55	63	55	54	54	60	54	52	52	

1. Correlated Color Temperature within specs as defined in ANSI_NEMA_ANSLG C78.377-2008: Specifications for the Chromaticity of Solid State Lighting Products.
2. Tested using absolute photometry as specified in LM79: IESNA Approved Method for the Electrical and Photometric Measurements of Solid-State Lighting Products.

C4RDL Calculite LED 4" gen 3

Round Downlight

Wide beam, 1500lm Engine, 106.6 lm/W at 14.2W or 113.2 lm/W at 13.4W (Power over Ethernet)

Candela Curve

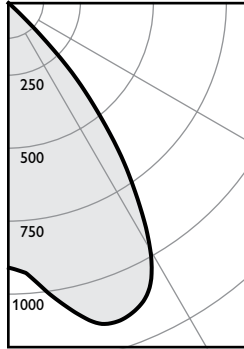

Frame: **C4RN or 4RN**
Engine: **C4L15835WZ10U**
Trim: **C4RDLCL**

Output lumens: 1517 lms
Input watts: 14.2 W
CRI: 80 min
CCT¹: 3500K
Spacing Crit.: 1.2
Beam Angle: 76°

Zonal summary

Zone	Lumens	%Luminaire
0-30	918	60.5%
0-40	1368	90.2%
0-60	1517	100.0%
0-90	1517	100.0%

Angle	Mean CP	Lumens
0	906	
5	945	93
10	1040	
15	1128	318
20	1153	
25	1114	506
30	978	
35	732	450
40	460	
45	175	148
50	18	
55	0	2
60	0	
65	0	0
70	0	
75	0	0
80	0	
85	0	0
90	0	

Single unit data

Height to lighted plane	Initial center beam foot-candles	Beam diameter (ft)*
5'	36	6.0'
6'	25	7.2'
7'	18	8.4'
8'	14	9.6'
9'	11	10.8'

* Beam diameter is where foot-candles drop to 50% of maximum.

Multiple unit data - RCR 2

Spacing on center	Initial center beam foot-candles	Watts per sq. ft.
5'	68.5	0.63
6'	45.0	0.41
7'	32.1	0.30
8'	26.8	0.25
9'	21.4	0.20

38' x 38' x 10' Room, Workplane 2.5' above floor, 80/50/20% Reflectances

Efficacy: 106.6 lm/w
Report#: T20161406

Adjustment factors

Finish	CCT	Lumens
CL = 100%	80CRI 4000K = 102%	3000lm = 200%
CC = 95%	80CRI 3500K = 100%	2500lm = 167%
CD = 87%	80CRI 3000K = 97%	2000lm = 133%
CZ = 63%	80CRI 2700K = 87%	1500lm = 100%
WH = 87%	90CRI 3000K = 77%	1000lm = 67%
BK = 57%	90CRI 2700K = 73%	500lm = 33%

Coefficients of utilization

Ceiling	80%				70%				50%				30%				0%
Wall	70	50	30	10	50	10	50	10	50	10	50	10	50	10	50	10	0
RCR	Zonal cavity method - Effective floor reflectance = 20%																
Room Cavity Ratio	0	119	119	119	119	116	116	111	111	106	106	100	106	106	100	97	93
1	113	110	108	105	108	104	104	104	100	100	97	94	94	89	86	81	79
2	107	102	98	94	100	93	97	91	94	89	86	81	79	72	66	61	56
3	101	94	89	85	93	84	90	83	88	81	79	72	66	61	56	52	48
4	96	87	82	77	86	77	84	76	82	75	72	66	61	56	52	48	45
5	90	81	75	70	80	70	78	69	77	69	66	61	56	52	48	45	42
6	85	75	69	64	75	64	73	64	72	63	61	56	52	48	45	42	39
7	80	70	64	59	69	59	68	59	67	58	56	52	48	45	42	39	36
8	76	65	59	55	65	54	64	54	63	54	52	48	45	42	39	36	33
9	72	61	55	50	61	50	60	50	59	50	48	45	42	39	36	33	30
10	68	57	51	47	57	47	56	47	55	46	45	42	39	36	33	30	27

1. Correlated Color Temperature within specs as defined in ANSI_NEMA_ANSI C78.377-2008: Specifications for the Chromaticity of Solid State Lighting Products.
2. Tested using absolute photometry as specified in LM79: IESNA Approved Method for the Electrical and Photometric Measurements of Solid-State Lighting Products.

The information presented in this document is not intended as any commercial offer and does not form part of any quotation or contract.

