

PHILIPS

GentleSpace 3

BY480P, BY481P

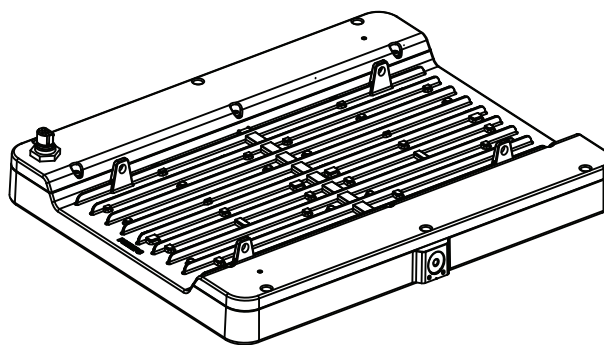
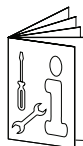

220V
240V

50Hz
60Hz

LEDs



LIFE
L80B50
100K hrs

IP65

GLOW
WIRE
650 °C



	W	kg	IK	max	min	GreenWarehouse
BY480P LED130S	84	7.9	IK07	45	-30	
BY480P LED170S	120	8	IK07	45	-30	
BY481P LED250S	162	12	IK07	45	-30	
BY481P LED350S	232	12	IK07	45	-30	
BY480P LED170S BR	120	8.5	IK07	45	-30	
BY481P LED250S BR	162	12.9	IK07	45	-30	
BY481P LED250S ELXX	162	12.5	IK07	25	0	
BY481P LED350S ELXX BR	232	13.4	IK07	25	0	
BY480P LED170S PC	120	7.2	IK08	45	-30	
BY481P LED250S PC	162	11	IK08	45	-30	
BY480X LED130S	84	8.4	IK02	45	-30	●
BY480X LED170S	120	8.5	IK02	45	-30	●
BY481X LED250S	162	12.5	IK02	45	-30	●
BY481X LED350S	232	12.5	IK02	45	-30	●

BY480P

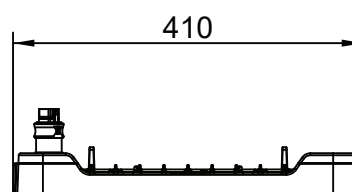
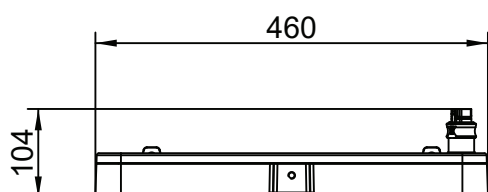

BY481P

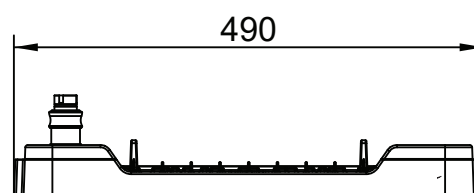
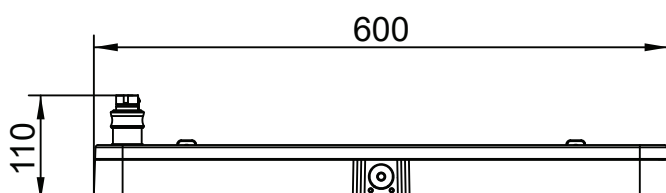

BY480X

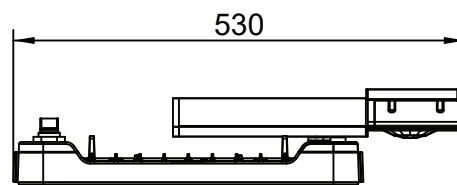
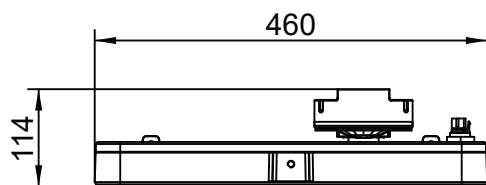

BY481X

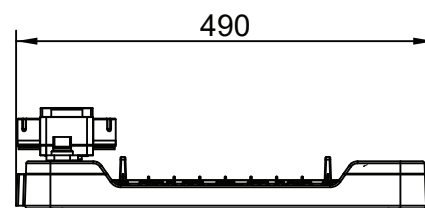
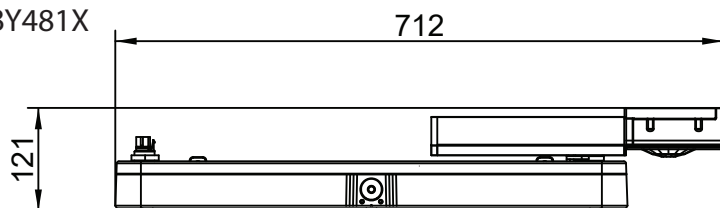

SMT Standard suspension set

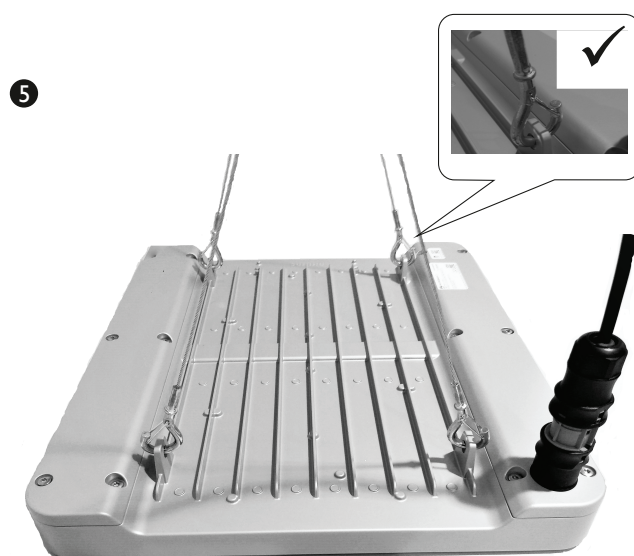
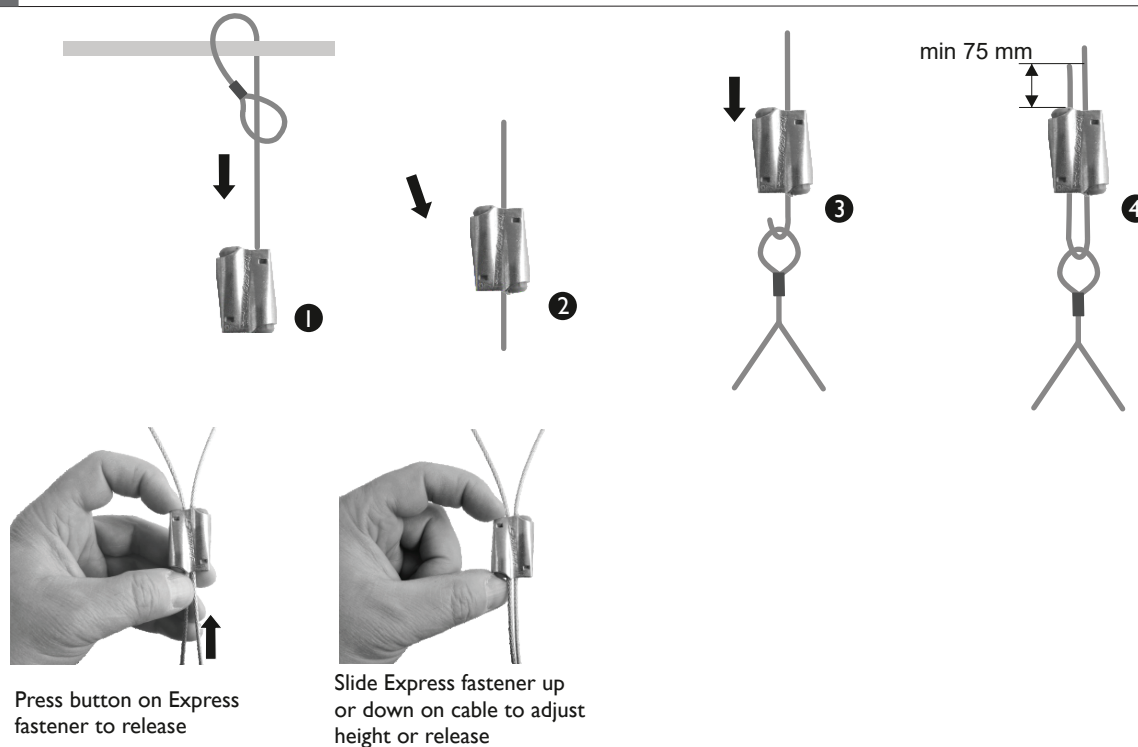

Connect the luminaire to the suspension set

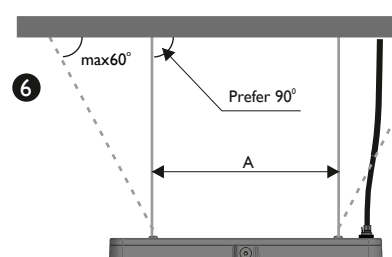

Distance between the hooks		
	BY480P	BY481P
A [mm]	350	495

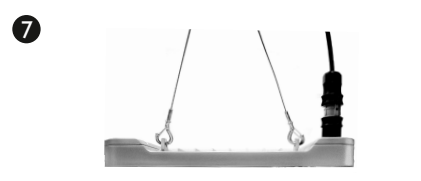

Make sure the load is supported



Mounting bracket set

Mounting bracket set content

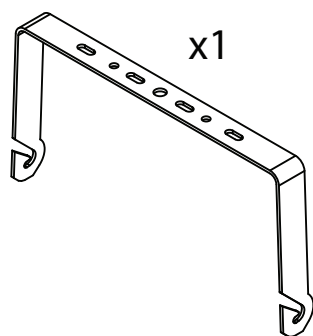

x1

x2

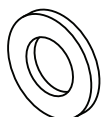

x2

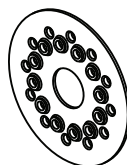

x2



x2

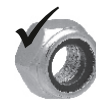

16Nm

tightening torque
for all Mounting Bracket screws
in standard applications

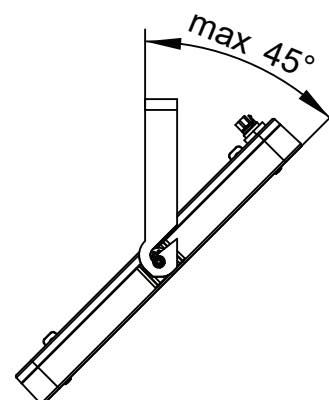
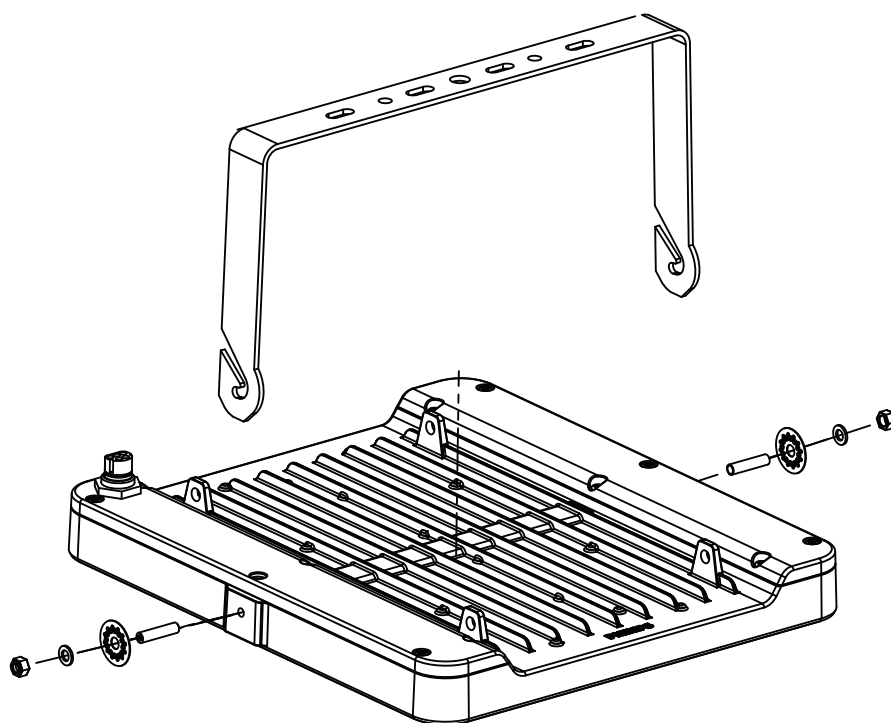

BY480P

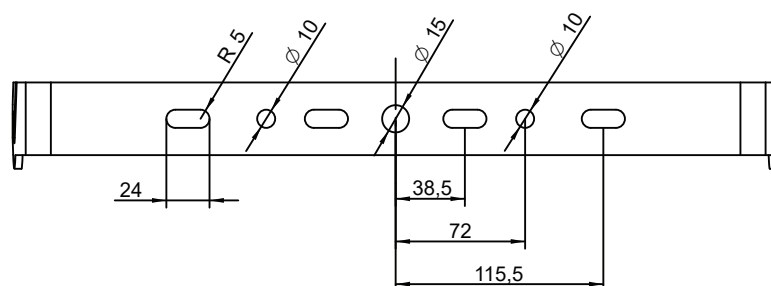
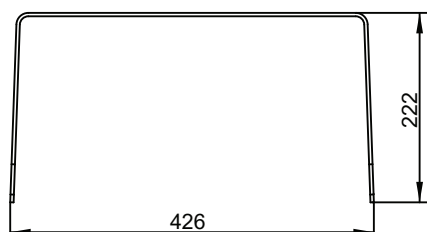

BY481P

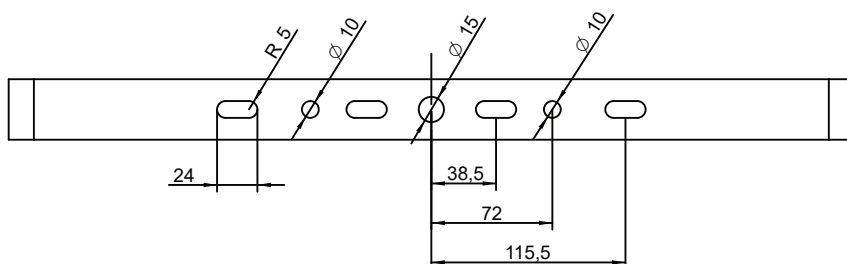

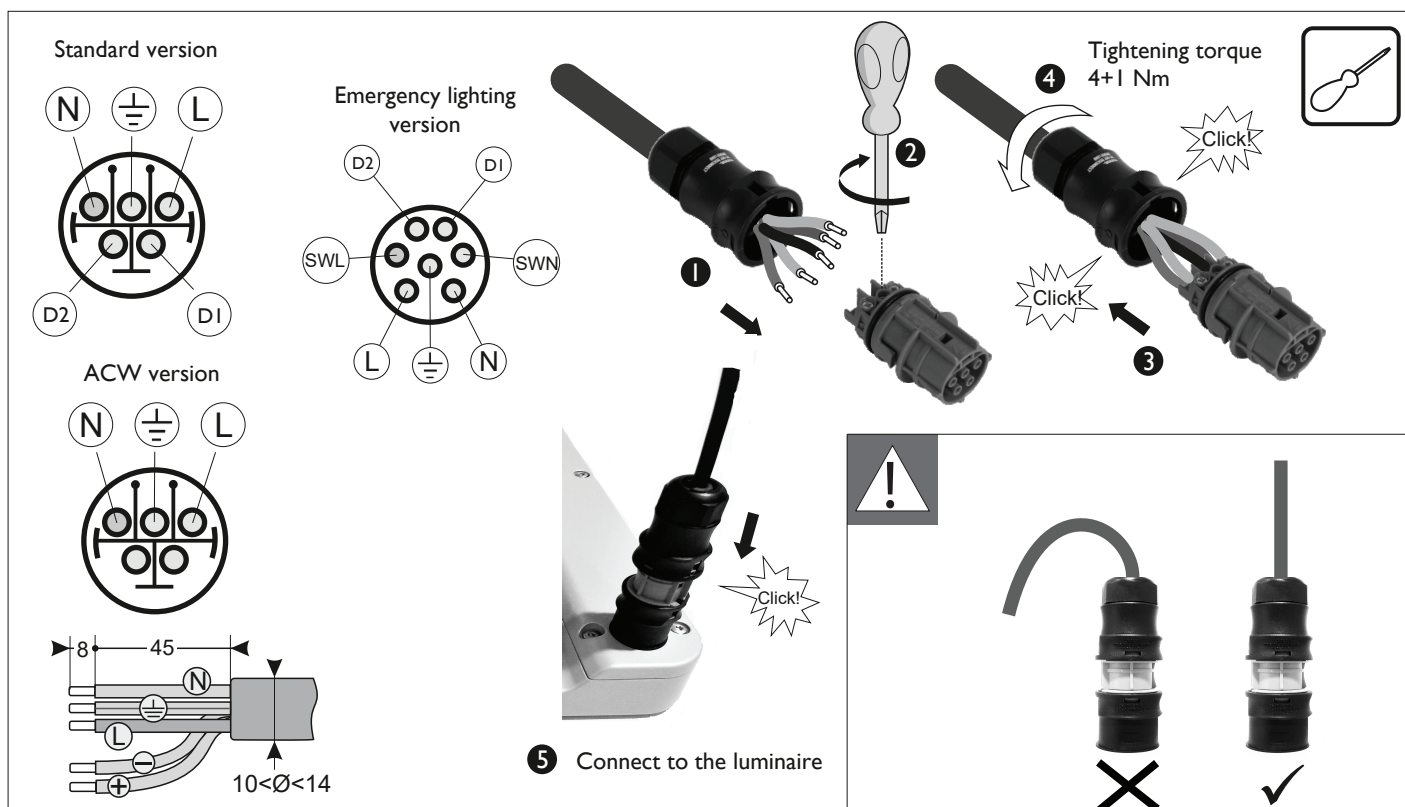

Adjustable Beam

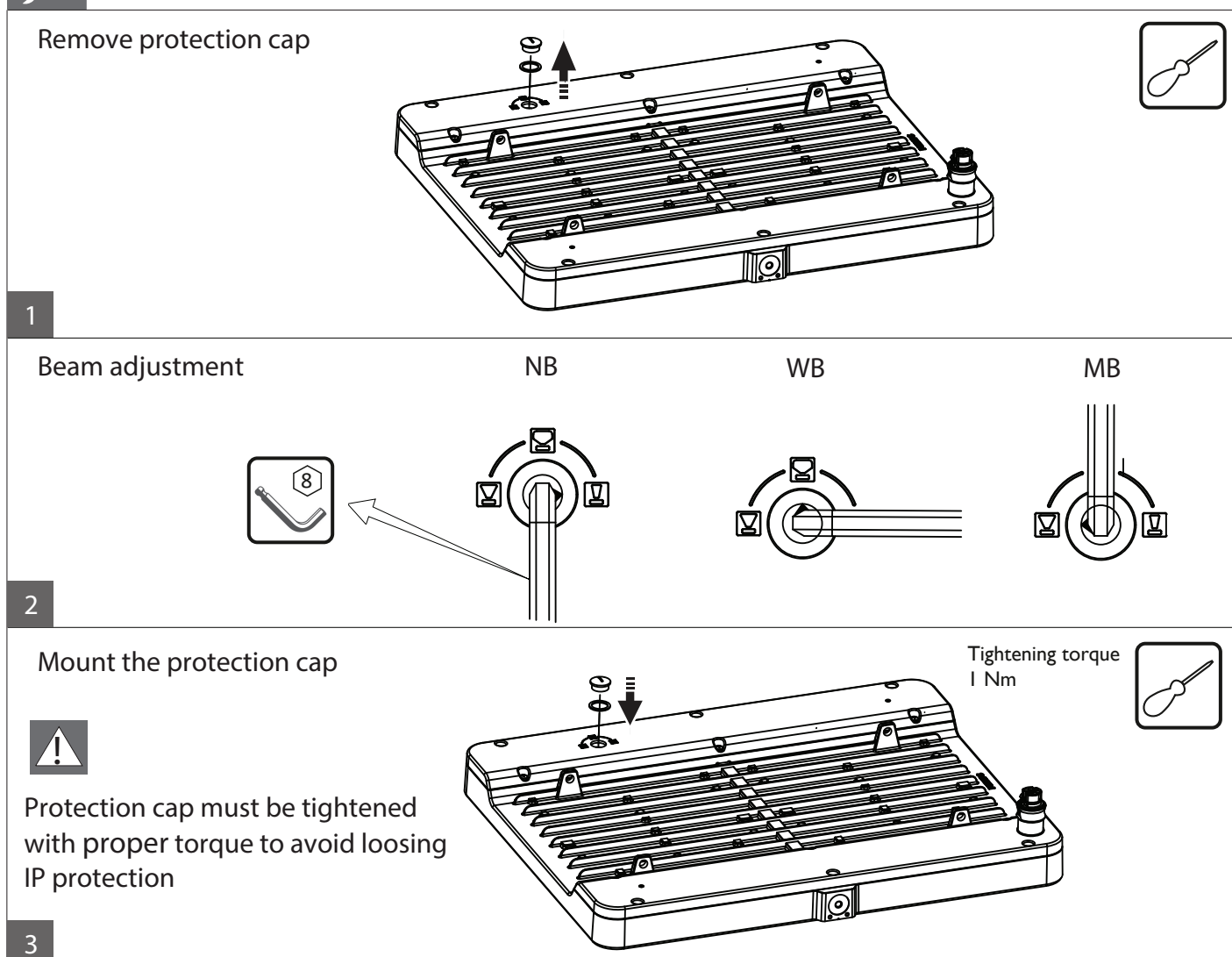

Beam adjustment

Window on the glass
from the bottom



Arrow on the knob
from the top

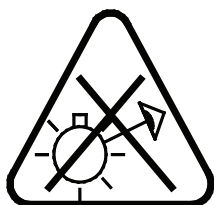
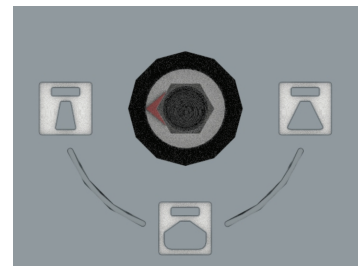

The following versions of the luminaires should be positioned so that prolonged staring into the luminaire at a distance closer than the indicated value in the table is not expected!

Luminaire type	Distance
LED130S/865 NB	6.5
LED130S/865 XNB	10.2
LED170S/840 NB	6
LED170S/840 XNB	8.9
LED170S/865 NB	7.8
LED170S/865 XNB	11.8
LED250S/865 NB	9.9
LED250S/865 XNB	14.4
LED350S/840 NB	8.4
LED350S/840 XNB	12.8
LED350S/865 NB	14.1
LED350S/865 XNB	16.5

Aisle orientation for High Rack Optic (HRO)

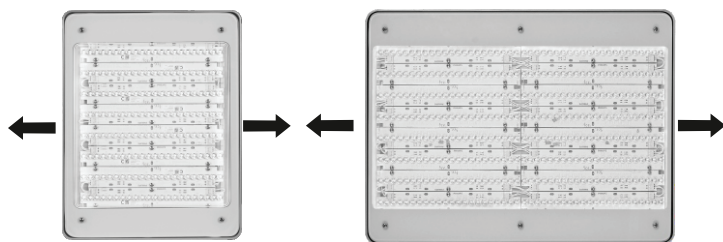

Inrush current

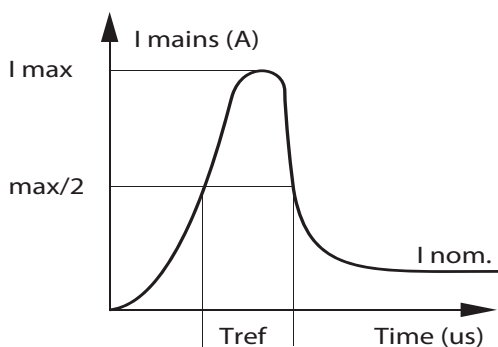

	LED130S, LED250S	LED170S	LED350S
Electrical characteristics			
I _{max} (A)	5,1	17,7	15,3
T _{ref} (μs)	2300	162	61
MCB	No. of driver max.		
B-10 A	8	17	5
B-16 A	12	22	8
C-10 A	12	28	8
C-16 A	20	36	13



ATTENTION
OBSERVE PRECAUTIONS
FOR HANDLING
ELECTROSTATIC
SENSITIVE
DEVICES

The luminaire shall be installed by a qualified electrician and wired in accordance with the latest IEE regulations or the national requirements.

The light source contained in this luminaire shall only be replaced by the manufacturer or his service agent or a similar qualified person

During the installation or maintaining the luminaire please use gloves to avoid spots on the cover

To remove dirt spots use the following:

- Dust: use micro fiber cloths
- Fingerprints, etc. : use a cleaner for with antistatic properties.