

Linear

SS staggered strip

2', 3', 4', or 8', T5 or T5HO



Project: _____

Location: _____

Cat.No: _____

Type: _____

Lamps: _____ Qty: _____

Notes: _____

Day-Brite / CFI SS staggered strip features a full 3" overlap and eliminates shadows from lamp ends. Its housing is only 1-7/16" deep with safe-handling metal edges and fully enclosed wire way. The SS staggered strip is excellent for applications where continuous, even illumination is required.

Ordering guide

Example: SS4S228UNV-1/2-EB

Family	Nominal length	Ceiling type	Lamp quantity/ cross section	Lamp Type (by others)	Voltage	Options
SS		S			—	
SS Staggered strip	2 nominal 2' 3 nominal 3' 4 nominal 4' 8 nominal 8' (tandem lamps)	S Surface	1 2	14 14WT5 24 24WT5HO 21 21WT5 39 39WT5HO 28 28WT5 54 54WT5HO	UNV Universal Voltage 120-277V 120 120V 277 277V 347 347V	1/1 One 1-lamp ballast 1/2 One 2-lamp ballast 2/2 ¹ Two 2-lamp ballasts 1/4 ¹ One 4-lamp ballast EB Electronic ballast, <10% THD, std. ballast factor E7LP ² LP550 emerg. ballast T5/T5HO, 430-700 lumens, 120/277V E6LP ² LP600 emerg. ballast U.S. or Canada market, T5/T5HO, 750-1325 lumens, 120/277V GLR Fusing, fast blow Power-Connect modular wiring – see sheet 1604-OA

Accessories (order separately)

- SS5R1W22ASLD³ Nominal 2' white asymmetric reflector, 2 lamp
- SS5R1W32ASLD³ Nominal 3' white asymmetric reflector, 2 lamp
- SS5R1W42ASLD³ Nominal 4' white asymmetric reflector, 2 lamp

Footnotes

- 1 SS8S2 models only
 2 4' and 8' models only
 3 For symmetrical distribution, order two (2) asymmetric reflectors per strip.

SS Staggered strip

2', 3', 4', or 8', T5 or T5HO

Features

- Only 1-7/16" deep.
- Utilizes compact, high efficiency, T5 or T5HO lamps.
- Fully enclosed wiring.
- Push through lamp holders with rotor for secure lamp retention.
- 3" lamp overlap for uniform lighting

Specifications

- **Materials:** Chassis parts are die-formed heavy gauge cold rolled steel, 1-7/16" deep x 3" channel width.
- **Finish:** Chassis exterior—phosphate undercoating, baked white acrylic matte high reflectance paint finish.
- **Electrical:** Rapid start HPF, thermally protected class "P" ballast. If K.O. is within 3" of ballast, use wire suitable for at least 90°C.
- **Labels:** cULus listed. Suitable for damp locations.

Dimensions

1 Lamp

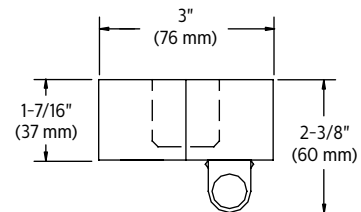
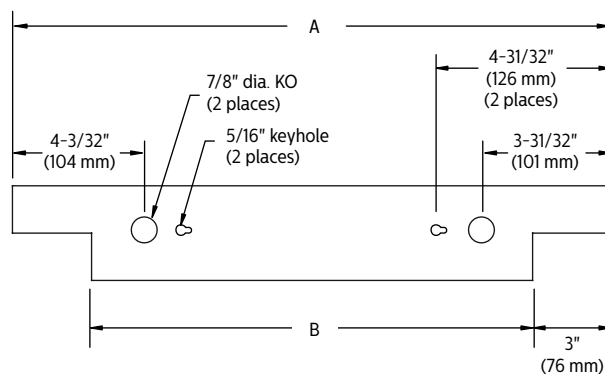

Nominal Length	A	B
2'	22-7/16" (570 mm)	16-7/16" (417 mm)
3'	34-9/32" (871 mm)	28-9/32" (718 mm)
4'	46-1/16" (1170 mm)	40-1/16" (1018 mm)
8'	89-1/8" (2264 mm)	83-1/8" (2112 mm)

2 Lamp

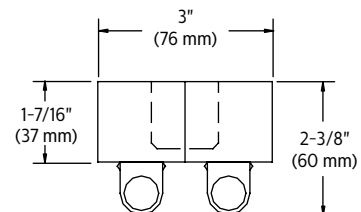
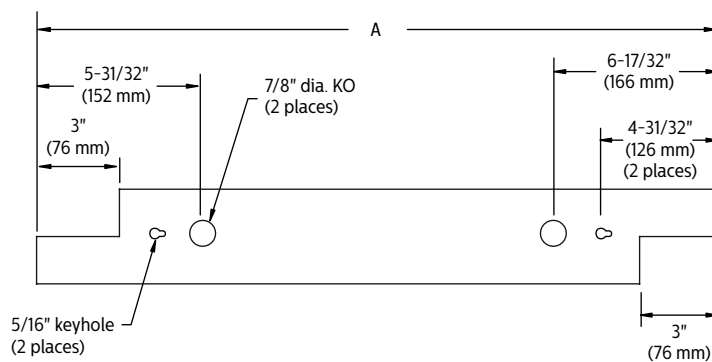

Nominal Length	A
2'	25-7/16" (646 mm)
3'	37-9/32" (947 mm)
4'	49-1/16" (1246 mm)
8'	95-1/8" (2416 mm)

SS Staggered strip

2', 3', 4', or 8', T5 or T5HO

Photometry

SS staggered strip, 4', 2 Lamp, T8

Efficiency – 89.3%

LER – 71

TER – 39

		Candlepower				Light Distribution				Average Luminance			
Catalog No.	SS4S228-UNV-1/2-EB	Angle	End	45	Cross	Degrees	Lumens	% Lamp	% Luminaire	Angle	End	45'	Cross
Test No.	CA777	0	952	952	952	0-30	777	14.9	16.7	45	9922	11970	13400
S/MH	1.5	5	946	954	945	0-40	1322	25.3	28.3	55	9400	12845	14891
Lamp Type	28WT5	15	921	941	963	0-60	2584	49.5	55.4	65	8398	14282	17644
Lumens/Lamp	2610	25	856	908	967	0-90	4018	77.0	86.2	75	6626	17636	20760
Ballast Factor	1.00	35	757	873	962	0-180	4662	89.3	100.0	85	3078	18651	23006
Input Watts	66.0	45	629	821	944								
		55	485	740	890								
		65	321	641	834								
		75	157	543	692								
		85	26	294	423								
		95	0	278	424								
		105	0	195	365								
		115	0	119	272								
		125	0	44	167								
		135	0	1	58								
		145	0	0	0								
		155	0	0	0								
		165	0	0	0								
		175	0	0	0								

Comparative yearly lighting energy cost per 1000 lumens – **\$3.38** based on 3000 hrs. and \$.08 pwr KWH.

The photometric results were obtained in the Day-Brite laboratory which is NVLAP accredited by the National Institute of Standards and Technology.

Coefficients of Utilization													
EFFECTIVE FLOOR CAVITY REFLECTANCE 20 PER (pfc=0.20)													
pcc	80			70			50						
pw	70	50	30	70	50	30	70	50	30	50	30		
RCR													
0	103	103	103	100	100	100	92	92					
1	92	85	81	88	82	79	77	72					
2	81	72	66	78	69	64	65	59					
3	73	63	55	69	60	53	56	50					
4	67	55	46	64	53	45	48	42					
5	60	48	40	58	46	39	44	36					
6	56	44	34	54	41	34	39	32					
7	52	39	30	50	38	29	34	28					
8	47	35	28	46	34	27	32	26					
9	45	33	25	42	32	23	29	23					
10	41	29	23	40	28	22	27	20					



Some luminaires use fluorescent or high intensity discharge (HID) lamps that contain small amounts of mercury. Such lamps are labeled, "Contain Mercury" and/or the symbol "HG". Lamps that contain mercury must be disposed of in accordance with local requirements. Information regarding lamp recycling and disposal can be found at www.lamprecycle.org

