

INSTALLATION INSTRUCTIONS

FLUXSTREAM EZ LED

CAUTION: THE INSTALLATION AND SERVICING OF THIS PRODUCT SHOULD BE PERFORMED BY A QUALIFIED ELECTRICIAN OR SERVICE PERSONNEL

Page 1 of 4

- 1) Remove unit from carton and inspect to ensure no shipping damage has occurred.
- 2) This luminaire is supplied with knockout holes for wiring access across the back of housing and side of each end cap.
- 3) To install with HANGER BRACKETS (See FIG.1):
 - A. Mount hanger brackets to structure with #8 screws. (Minimum 2 brackets per luminaire)
 - B. Once mounting brackets are secured to surface, snap luminaire into brackets. Mounting bracket should be secured into reveal of luminaire. Tighten mounting bracket with #8-18 x 2" bolt that is provided.
 - C. Secure LED board to housing by looping tether over "T" lance as shown in Figure 2.
 - D. For "stand alone installation" bring customer supply wires into luminaire through preferred knockout hole. Make electrical connection per electrical code.
 - E. For "continuous row mounting" refer to "CONNECTING LUMINAIRES FOR ROW MOUNTING": follow steps A, B and C above for each luminaire. A customer supplied chase nipple and lock nut should be inserted into the knockout hole on each end of the adjoining fixtures as shown in Fig 6.
- 4) To install with optional chain/hanger kit (PURCHASED SEPARATELY): Remove the V-Hook and chains from the bag pack. Hook the V-Hook into each end of the luminaire in provided holes. The chains should then be attached to the permanent structure of the building.
- 5) To install with cable/stem mounting assembly (PURCHASED SEPARATELY):
 - A. Mount cable or stem to building structure above luminaire.
 - B. Remove stem mount KOs shown in Fig 1 at each end of fixture
 - C. Mount cable or stem to fixture in KO hole using included hardware.

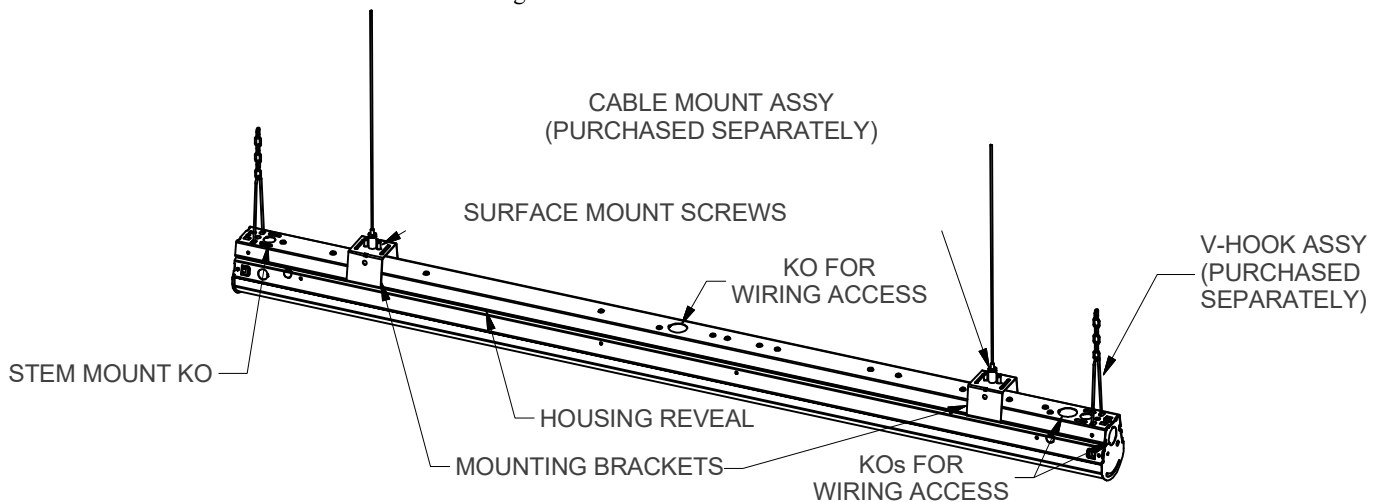

FIGURE 1: STAND ALONE CONFIGURATION

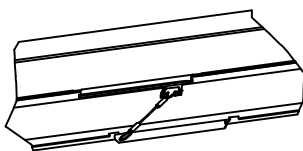

FIGURE 2: TETHERS

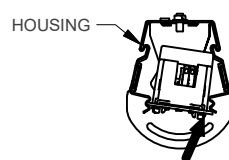

FIGURE 3: BOARD SNAP IN

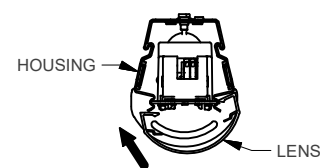

FIGURE 4: LENS

- 6) Snap in 4' LED board by inserting driver cover into the housing. Then start one side of board into groove and snap LED board into housing by pushing opposite of board until it snaps into place as shown in Fig 3.
- 7) Snap on lens by angling one side in and then pivot the opposite end around to snap in the other side as shown in Fig 4.

CAUTION: This fixture is designed for permanent installation in ordinary (Non-Hazardous) locations in accordance with the National Electrical Code and all applicable local codes. Do not use in areas of limited ventilation or in high ambient enclosures. The lamp and fixture operate at high temperatures. Contact with combustible materials can cause fire and personal contact can cause severe burns.

Day-Brite
CFI

Signify Corporation North America
200 Franklin Square Drive
Somerset, NJ 08873
Phone: 855-486-2216
www.day-brite.com

Signify Canada Ltd./Signify Canada Ltée. 281 Hillmount Road Markham ON, Canada L6C 2S3 Phone: 800-668-9008
www.cfi-lighting.com

442100256130 Sep/2018
DB100439 (ENGLISH)

INSTALLATION INSTRUCTIONS

FLUXSTREAM EZ LED

Page 2 of 4

CAUTION: THE INSTALLATION AND SERVICING OF THIS PRODUCT SHOULD BE PERFORMED BY A QUALIFIED ELECTRICIAN OR SERVICE PERSONNEL

FOR FIXTURE MAINTENANCE (ACCESSING WIRING COMPARTMENT)

To remove lens from housing, push side of lens until the opposite side of lens protrudes from housing. Then pull protruding lens downward until removed as shown in Figure 5. This should be applied down the length of the fixture. To remove the LED board, start on one end of housing using a flat head screw driver in the slots provided as shown in Figure 6. **IMPORTANT:** Make sure to apply a force parallel to board to reduce the risk of damaging the board.

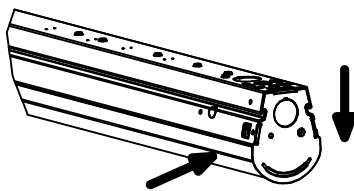

FIGURE 5: REMOVING LENS

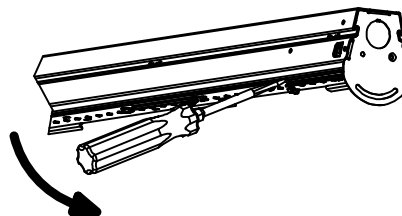

FIGURE 6: REMOVING THE 4' LED BOARD

CONNECTING LUMINAIRES FOR ROW MOUNTING

- 1) Make sure each luminaire is secured to building structure, by at least two points, before process begins, do not use "endcap to endcap" connection for replacing cable, pendant or surface mounting options.
- 2) Remove joining end caps by spreading channel open and sliding endcap off. Then remove KOs and secure the endcaps together with customer supplied (2) #8 screws and (1) 1/2" chase nipple to create joiner as shown in FIG 6.
- 3) Slide joiner assembly/endcap into fixture. Slide in next luminaire into joiner assembly as shown in FIG 7.

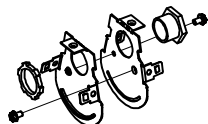

FIG 7: JOINER ASSY

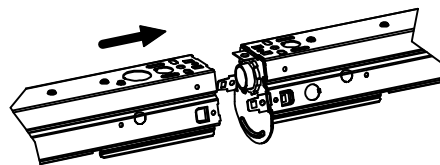

FIG 8: ROW MOUNT CONNECTION

- 4) Install screws as shown in FIG 8 and make electrical connections inside luminaire in accordance with the National Code and local regulations. Refer to page 2 for installing the LED carrier and lens.

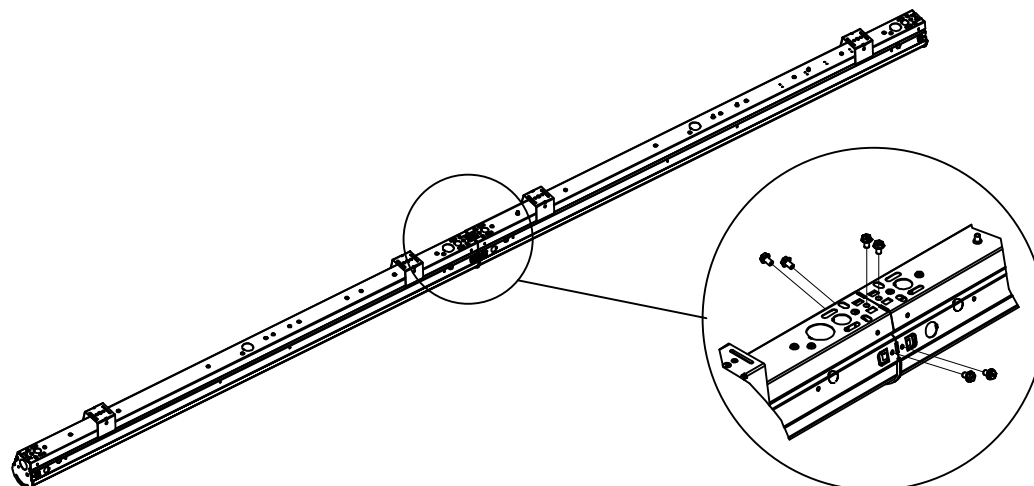

FIG 9: ROW MOUNT CONFIGURATION

CAUTION: This fixture is designed for permanent installation in ordinary (Non-Hazardous) locations in accordance with the National Electrical Code and all applicable local codes. Do not use in areas of limited ventilation or in high ambient enclosures. The lamp and fixture operate at high temperatures. Contact with combustible materials can cause fire and personal contact can cause severe burns.

Day-Brite
CFI

Signify Corporation North America
200 Franklin Square Drive
Somerset, NJ 08873
Phone: 855-486-2216
www.day-brite.com

Signify Canada Ltd./Signify Canada Ltée. 281 Hillmount Road Markham ON, Canada L6C 2S3
Phone: 800-668-9008
www.cfi-lighting.com

442100256130 Sep/2018
DB100439 (ENGLISH)

