

Day-Brite

CFI

by @signify

Special Application

LPL series
low profile linear

Vandal resistant
T5, T5HO, or T8



Project: _____
 Location: _____
 Cat.No: _____
 Type: _____
 Lamps: _____ Qty: _____
 Notes: _____

Day-Brite / CFI LPL series low profile linear features a marine grade extruded aluminum backplate with die-cast aluminum round or square end caps. Its heavy duty construction is designed to meet the demands of extreme environments.

Ordering guide

Example: LPLS232-UNV-F1-1/2-EB

Family	Ends	No. of Lamps/ Cross Section	Lamp Type ^{1,2}	Voltage	Fasteners	No. of Ballasts	Ballast Type	Options	
LPL Low Profile Linear Fluorescent (2 or 4 ft)	S Square R Round	2	2 Lamps	14 14WT5 (24")	UNV Universal voltage, 120-277V 120 120V 277 277V 347 347V	1/2 2-Lamp Ballast	EB Electronic ballast, <10% THD, T8 instant start, T5 rapid start EB10R Electronic ballast, T8 rapid start, <10% THD	E7 B60 emerg. ballast, T8, 600-700 lumens, 120/277V ⁴	
		3	3 Lamps (4' only)	17 17WT8 (24")				2/1 Two 1-Lamp Ballasts	E5 B50 emerg. ballast, U.S. or Canada market, T8, 1100-1400 lumens, UNV LP550 emerg. ballast T5/T5HO, 430-700 lumens, 120/277V ⁴
		4	4 Lamps (4' only) ³	24HO 24WT5HO (24")				1/3 3-Lamp Ballast	E7LP 700 lumens, 120/277V ⁴
		28 28WT5 (48")	1/21 2-Lamp and 1-Lamp Ballast	E6LP LP600 emerg. ballast U.S. or Canada market, T5/T5HO, 750-1325 lumens, 120/277V ⁴					
		32 32WT8 (48")	1/4 4-Lamp Ballast	GLR Fusing, fast blow					
		54HO 54WT5HO (48")	2/2 Two 2-Lamp Ballasts	AG Agion™ antimicrobial protection in powder coat paint (white finish only)					
		NLF7 7W PL Night Light ⁴ (4' only)							
		NLEDS LED nightlight ⁴ (120V only)							
		NSF NSF Listed, Food Zone/Non-Contact & Splash Zone							
		WO White opal polycarbonate lens							
BK Black finish									
BZ Bronze finish									
CS Custom color (provide RAL#)									
XTR Natatorium environment									

Footnotes

- Lamps supplied by others.
- Length without end caps. For actual lengths, see dimensions.
- Not available in T5HO.
- Specify voltage.

General Notes

- Consult factory for additional configurations.
- Many luminaire components, such as reflectors, refractors, lenses, sockets, lampholders, and LEDs are made from various types of plastics which can be adversely affected by airborne contaminants. If sulfur based chemicals, petroleum based products, cleaning solutions, or other contaminants are expected in the intended area of use, consult factory for compatibility.



LPLS/LPLR LPL series low profile linear

Vandal resistant, T5, T5HO, or T8

Standards

- ETL (US/Canada)
- Wet location 200 psi spray down listed
- ADA Compliant
- NSF National Sanitation Foundation Approved, Food Zone/ Non-Contact and Splash Zone, with NSF option
- Suitable for Natatorium environments with XTR option

Construction/Finish

- Marine grade extruded aluminum backplate with die cast aluminum end caps.
- End caps available in round or square profiles.
- Stainless steel center pin reject Allen-head fasteners. Other fasteners are available.
- Multi-stage pretreatment process, standard finishes are baked white polyester powder coating. Gloss 85%, reflectance 90%, salt spray 1,000 hrs.

Lens

- Clear lens is .156" thick positive interlocking, lighting grade, UV stabilized, extruded high impact polycarbonate lens with integral linear prisms.
- White opal lens is also available.
- Lens sealed to the housing ends with EPDM sponge rubber cord and closed cell neoprene gasketing.

Electrical

- Standard Class P, sound rated A electronic ballasts.

Installation

- Wall or ceiling mounted individually.

Option

- Agion® antimicrobial protection using silver technology inhibits bacterial colonization on metal interior or exterior surfaces. Agion® antimicrobial protection is FDA recognized and EPA registered meeting all applicable EPA standards.

Dimensions

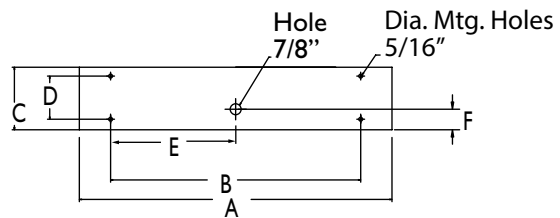
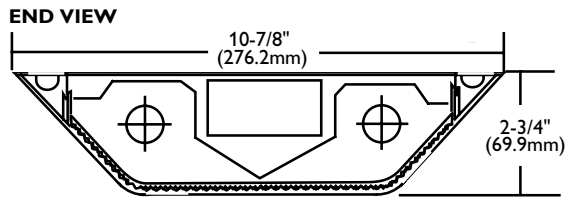

	EndCap	Length	A	B	C	D	E	F
LPL	Square	24"	27.625"	23"	10.875"	7.75"	11.5"	4.5"
LPL	Square	48"	51.625"	47"	10.875"	7.75"	23.5"	4.5"
LPL	Round	24"	32"	23"	10.875"	7.75"	11.5"	4.5"
LPL	Round	48"	56"	47"	10.875"	7.75"	23.5"	4.5"



Some luminaires use fluorescent or high intensity discharge (HID) lamps that contain small amounts of mercury. Such lamps are labeled, "Contain Mercury" and/or the symbol "HG". Lamps that contain mercury must be disposed of in accordance with local requirements. Information regarding lamp recycling and disposal can be found at www.lamprecycle.org

LPLS/LPLR LPL series low profile linear

Vandal resistant, T5, T5HO, or T8

Photometry

LPL 2 Lamp F32T8

Efficiency – 64.8

LER – 62

TER – 53

		Candlepower				Light Distribution				Average Luminance			
		Angle	End	45	Cross	Degrees	Lumens	% Lamp	% Luminaire	Angle	End	45°	Cross
Catalog No.	LPL-232-EB	0	1187	1187	1187	0-30	899	15.8	24.3	45	3352	3349	3729
Test No.	28712	5	1188	1184	1180	0-40	1459	25.6	39.5	55	2377	3101	3576
S/MH	1.2	15	1143	1141	1113	0-60	2590	45.4	70.1	65	1400	2725	3241
Lamp Type	F32T8	25	1050	980	999	0-90	3444	60.4	93.2	75	561	2547	3148
Lumens/Lamp	2850	35	910	867	941	90-120	238	4.2	6.4	85	85	2542	3342
Ballast Factor	1.0	45	679	764	873	90-130	249	4.4	6.7				
Input Watts	59	55	397	610	728	90-150	250	4.4	6.8				
		65	177	434	541	90-180	250	4.4	6.8				
		75	46	298	394	0-180	3694	64.8	100.0				
		85	3	181	266								
		95	0	121	215								
		105	0	73	166								
		115	0	32	106								
		125	0	1	45								
		135	0	0	2								
		145	0	0	0								
		155	0	0	0								
		165	0	0	0								
		175	0	0	0								
Comparative yearly lighting energy cost per 1000 lumens – \$3.87 based on 3000 hrs. and \$.08 pwr KWH.													
The photometric results were obtained in the Day-Brite laboratory which is NVLAP accredited by the National Institute of Standards and Technology.													
		Coefficients of Utilization											
		EFFECTIVE FLOOR CAVITY REFLECTANCE 20 PER (pfc=0.20)											
		pcc			80			70			50		
		pw		70	50	30	70	50	30	50	30		
		RCR											
		0	76	76	76	73	73	73	69	69			
		1	68	65	61	66	63	60	59	56			
		2	61	56	52	59	55	51	52	47			
		3	56	50	44	55	47	42	46	40			
		4	52	44	38	50	42	36	40	35			
		5	47	39	33	46	38	33	35	30			
		6	44	34	28	41	34	28	33	28			
		7	40	32	26	39	30	26	29	25			
		8	38	28	23	36	28	23	27	23			
		9	34	27	20	34	26	20	25	20			
		10	33	25	19	32	23	19	23	19			

LPL 2 Lamp F54T5HO

Efficiency – 79.7

LER – 66

TER – 55

		Candlepower				Light Distribution				Average Luminance			
		Angle	End	45	Cross	Degrees	Lumens	% Lamp	% Luminaire	Angle	End	45°	Cross
Catalog No.	LPL-254HO-EB	0	2283	2283	2283	0-30	1853	18.5	23.3	45	6523	6948	7523
Test No.	28713	5	2274	2330	2379	0-40	3060	30.6	38.4	55	5500	5852	7670
S/MH	1.4	15	2140	2325	2339	0-60	5294	52.9	66.4	65	3562	5644	8211
Lamp Type	F54T5HO	25	1896	2160	2211	0-90	7282	72.8	91.4	75	2387	5761	8716
Lumens/Lamp	5000	35	1593	1960	2104	90-120	648	6.5	8.1	85	562	6544	10240
Ballast Factor	1.0	45	1256	1507	1673	90-130	682	6.8	8.6				
Input Watts	121	55	874	1095	1484	90-150	686	6.9	8.6				
		65	429	856	1303	90-180	686	6.9	8.6				
		75	187	643	1038	0-180	7968	79.7	100.0				
		85	19	446	777								
		95	0	307	633								
		105	0	187	442								
		115	0	73	273								
		125	0	13	104								
		135	0	3	15								
		145	0	0	0								
		155	0	0	0								
		165	0	0	0								
		175	0	0	0								
Comparative yearly lighting energy cost per 1000 lumens – \$3.64 based on 3000 hrs. and \$.08 pwr KWH.													
The photometric results were obtained in the Day-Brite laboratory which is NVLAP accredited by the National Institute of Standards and Technology.													
		Coefficients of Utilization											
		EFFECTIVE FLOOR CAVITY REFLECTANCE 20 PER (pfc=0.20)											
		pcc			80			70			50		
		pw		70	50	30	70	50	30	50	30		
		RCR											
		0	93	93	93	90	90	90	84	84			
		1	83	79	75	81	77	72	71	68			
		2	76	68	63	72	66	60	61	57			
		3	68	59	53	66	57	52	55	48			
		4	63	53	46	60	52	45	48	42			
		5	57	46	40	56	46	39	44	38			
		6	53	42	34	51	40	34	39	33			
		7	50	39	32	47	38	30	35	29			
		8	46	34	28	44	34	28	33	27			
		9	42	32	26	41	32	25	29	23			
		10	40	29	23	39	28	23	28	22			

