

UniPoint

BGP312

Mounting instruction/安装说明

IEC
60598

GB
7000



IP66

III

IK06

ta35°C

S.Cx ☐
0.019m²

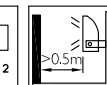

Product Type 产品型号	Control Interface 控制方式	Power Consumption 功率	Input Voltage 输入电压	CCT 色温	Beam Angle 光束角	Weight 重量
BGP312 LED1	ON / OFF	1x3 W	DC24V	2700/3000/4000K	10°/25°/40°	0.4KG
BGP312 LED3	ON / OFF	3x2 W	DC24V	2700/3000/4000K	10°/25°/40°	0.4KG
BGP312 LED5	ON / OFF	5x2 W	DC24V	2700/3000/4000K	10°/25°/40°	0.8KG

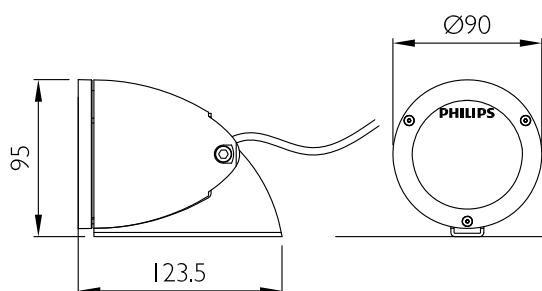

BGP312 LED5

Dimension / 尺寸图

Unit: mm

单位: mm

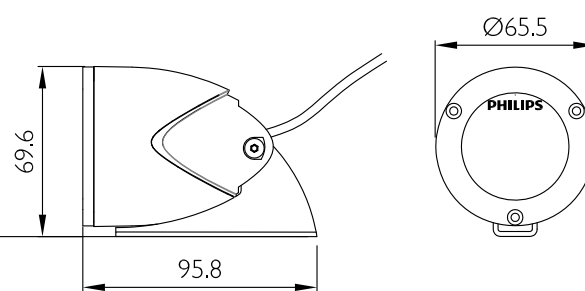

BGP312 LED1/3

Dimension / 尺寸图

Unit: mm

单位: mm

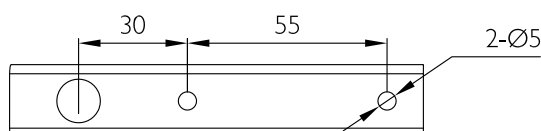

BGP312 LED5

Punching Size / 开孔尺寸

Unit: mm

单位: mm

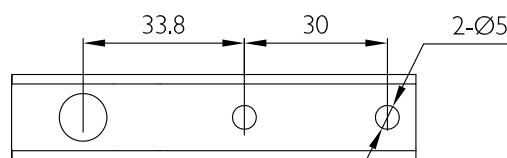

BGP312 LED1/3

Punching Size / 开孔尺寸

Unit: mm

单位: mm

表面安装 Surface mounting

① 打安装孔, 预埋两个膨胀管
Drill two holes, then insert two plastic expansion slots.

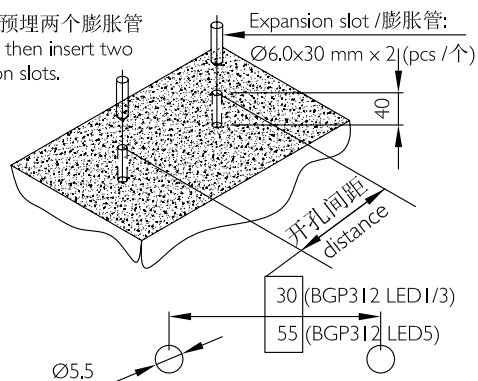

② 使用两颗自攻螺丝固定BGP312
Using self-tapping screw to fix BGP312.

Self-tapping screw / 自攻螺丝:
Ø3.9x30 mm x 2 (pcs / 个)

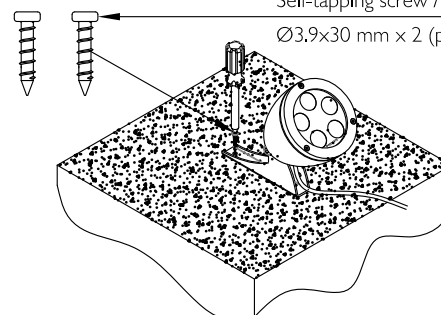

Philips Lighting Luminaires (Shanghai) Co., Ltd.
Address: 2nd floor, Bldg.6, HuYi Rd. 1805, MaLu Town, JiaDing District, Shanghai, China
Postalcode: 201801

飞利浦灯具(上海)有限公司
地址: 中国上海市嘉定区马陆镇沪宜公路1805号6幢二层
邮编: 201801

PHILIPS

③投射角度 Projection Angle

根据需要调节投射角度, BGP312 LED1/3/5 完全一样
Set the projection angle as needed

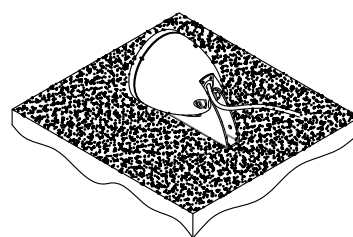
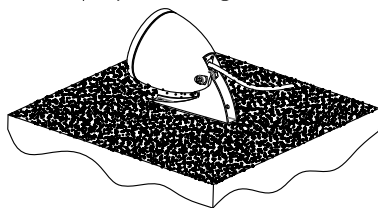
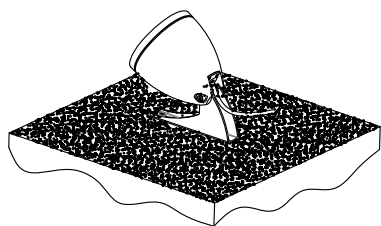

调整方式: 手动调节投射角度, 无须借助任何工具。
Manually adjust the projection angle.

可调角度范围 Adjustable Range

BGP312 LED5

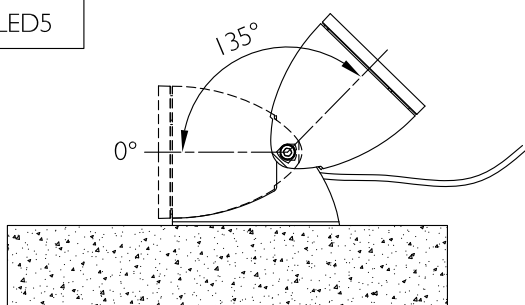

BGP312 LED1/3

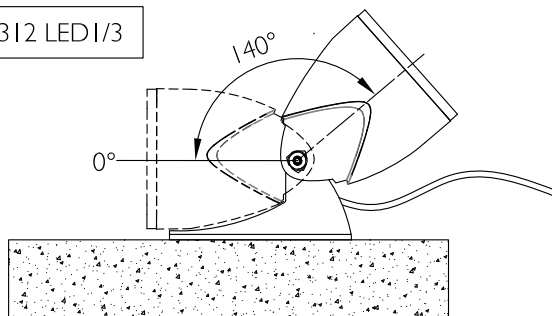

其他安装方式 Other installation

BGP312 LED5

Selected accessory / 可选配件

Serrated mounting clip/鳄鱼齿安装夹
I2NC: 911401711722, ZGP312 5LED

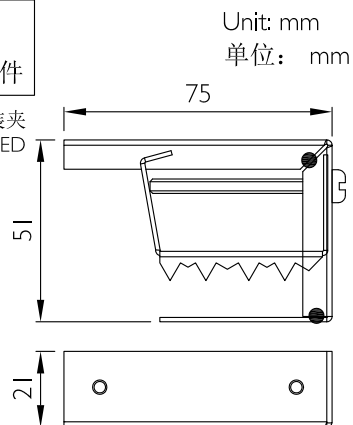

BGP312 LED1/3

Selected accessory / 可选配件

Serrated mounting clip/鳄鱼齿安装夹
I2NC: 911401711712, ZGP312 1&3LED

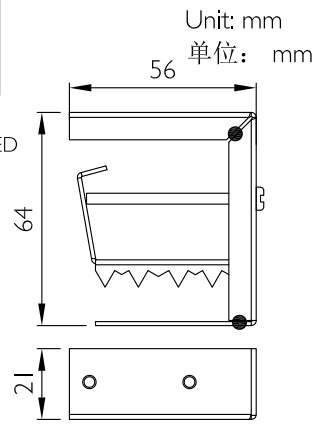

选配件与灯具装配图

Diagram of installation between BGP312 and ZGP312

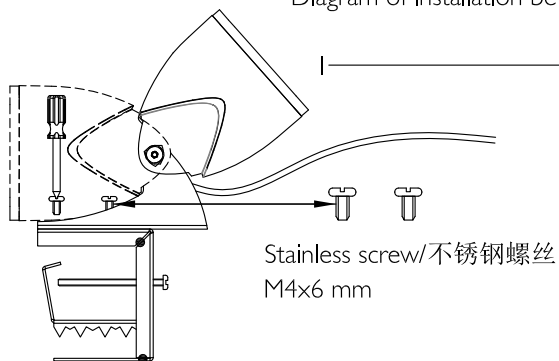

Stainless screw/不锈钢螺丝
M4x6 mm

将灯具与选配支架锁到一起。
Using stainless screws to lock on together.

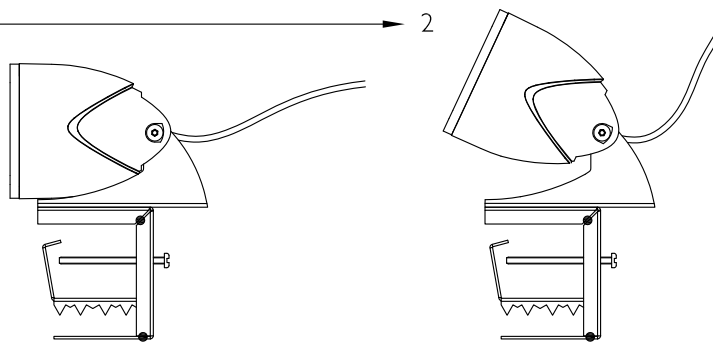

根据需要调整角度, 此步骤也可以打胶好以后进行。
The projection angle can also be adjusted after sealing.

①用瓦檐安装附件卡住瓦檐
Lock on

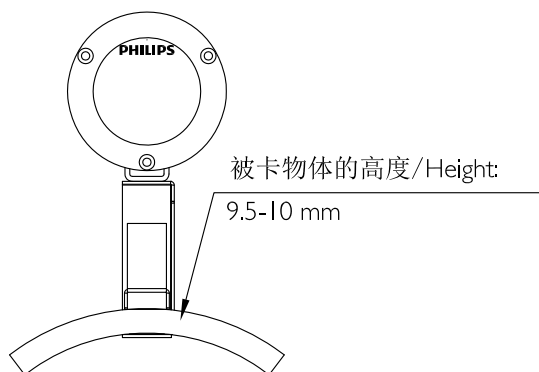

②拧紧螺丝
Screw down

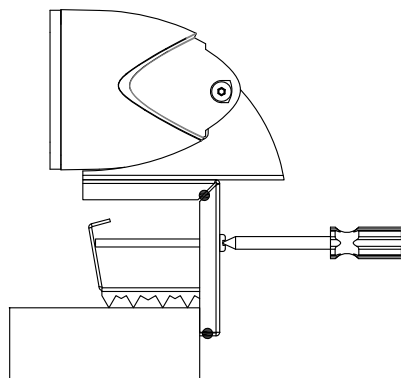

③打胶辅助固定
Sealing-off

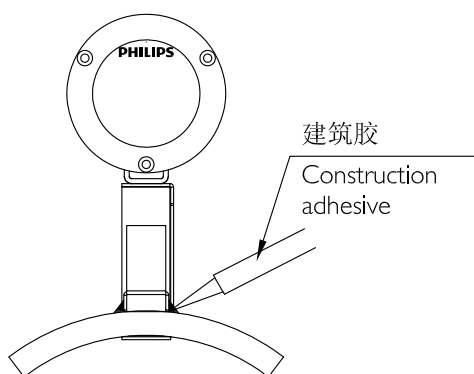

灯具接线 Cable connection

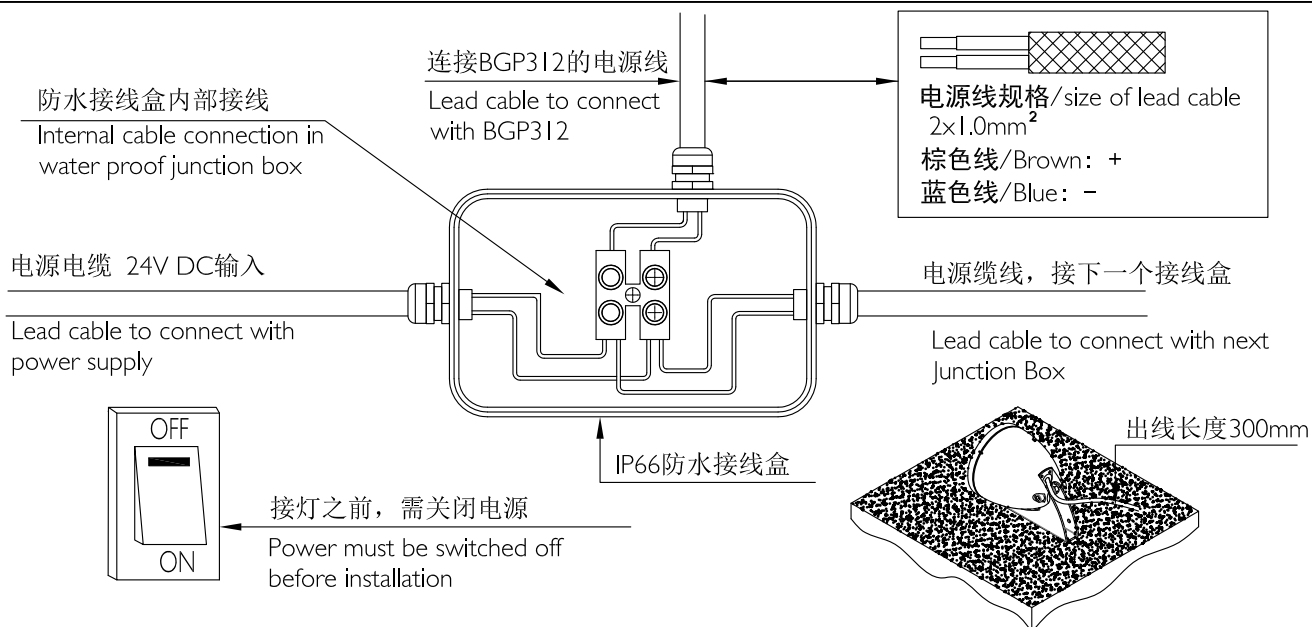

推荐电源型号
Recommend Driver Type

品牌 Brand	驱动器型号 Model	防护等级 IP rating	额定功率 Rated power	额定电流 Rated current	可连接数量 (个) Qty for connecting with driver (pcs)		
					BGP312 LED1	BGP312 LED3	BGP312 LED5
明纬/MEAN WELL	HLG-320H-24	IP67	320W	13A	80PCS	40PCS	24PCS
明纬/MEAN WELL	HLG-320H-24A	IP65	320W	13A	80PCS	40PCS	24PCS

BGP312与驱动器接线图，接线方式为并联（以明纬 320W driver为例）
Diagram of connection between driver and BGP312 (E.g. MW 320W driver)

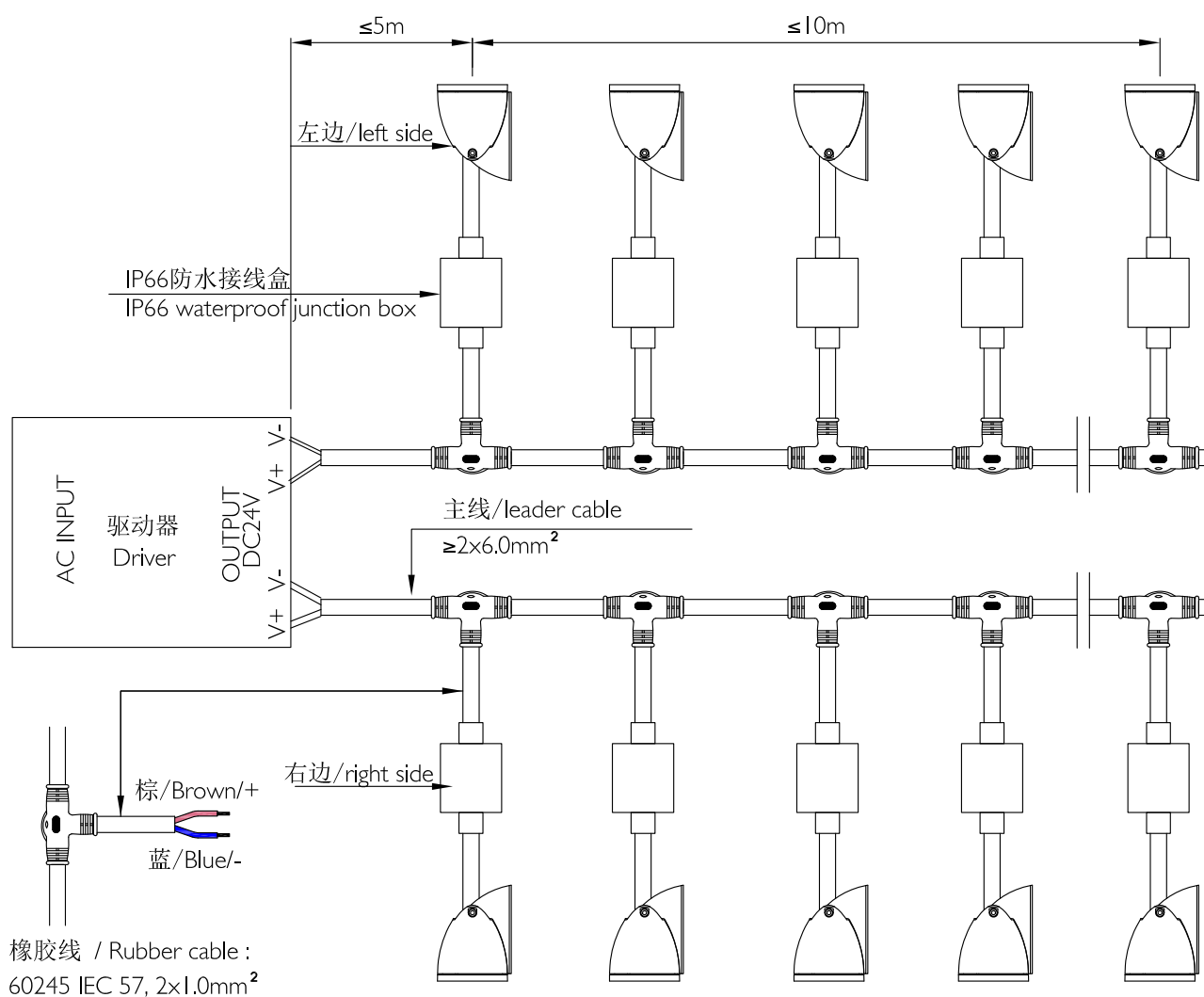

建议主线的线径不小于2x6.0mm²，第1个灯具到驱动器的最大距离为5米，如超过5米具体连接数量请根据现场安装情况咨询有关销售或技术支持人员。各灯具要以并联方式连接到电源主线。

The size of power cable must be over 2x6.0mm². The maximum distance of the first luminaire to the driver is 5 meters. If length of power cable is more than 5 meters, the quantity of BGP312 should be less than the number shown on the sheet. And the luminaires should be in parallel to the power cable.

Inrush Current

I _{peak} (A)/峰值电流	498mA	724mA	1.01A
T _{width} (ms)/脉宽	10ms	10ms	10ms
Product Type/产品型号	1 LED/3W	3 LED/6W	5 LED/10W

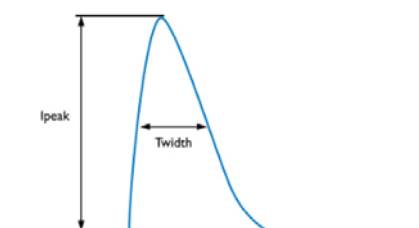



1. Need to consider the diameter of main cable when several fixtures connect together, and the loaded current of main cable need to more than the total current of all fixtures.

当多个灯具并接在电源总线上时，应考虑总线电缆线的线径大小，使用的电缆线线径所承载的过电流要大于总线上所有灯具额定电流之和。

2. Need to choose the suitable leakage protection switch for power distribution, also need to pay attention on fixture driver, cable length and wet environment might increase leakage current.

配电时要注意合理选用漏保开关的规格；并且要考虑到灯具电源、电缆线长度以及潮湿环境等因素都会使漏电流增大。

3. Need to consider the max surge current can be loaded when do power distribution and set enough tolerance, suggest to use start-up process.

配电时要考虑到空开所能承受的浪涌电流，需留有足够余量；建议分级启动。

4. Please use IP66 junction boxes (purchased by customer).

请使用防水等级IP66的接线盒(需客户自购)。

5. The wire connection method is determined by local electrical codes and regulations. Typical method is to use either wire, nuts or screw terminal blocks.

接线方式取决于当地电气法规及规定，一般是使用螺纹旋紧型导线连接器或螺钉接线端子。

6. The luminaire should be installed by a qualified electrician and wired in accordance with the latest IEE electrical regulations or the national requirements.

灯具应由有资格的电工安装，接线要符合IEE电气标准或国家标准。

7. Do not switch on before complete installation. Do not disconnect when power on.

接线过程中切勿通电。不能热插拔，不能带电操作。

8. The external cable of this luminaire cannot be replaced. If the cord is damaged, the luminaire should be destroyed.

此灯具的外部伸出线缆不能替换。如果线缆损坏，该灯具即报废。

9. The waterproof junction box must be suitable for luminaire lead cable.

接线盒的进线接头必须和灯具提供的引线相匹配。

10. The light source contained in this luminaire shall only be replaced by the manufacturer or his service agent or a similar qualified person.

此灯具内的光源应由制造商或其服务代理商或有类似资格的人来替换。

11. Regularly check; Regularly clean, etc.

定期检测，定期清洗等

产品中有有害物质清单

产品中有有害物质的名称及含量						
部件名称	有害物质					
	铅(Pb)	汞(Hg)	镉(Cd)	六价铬(Cr(VI))	多溴联苯(PBB)	多溴二苯醚(PBDE)
LED灯板/光源	○	○	○	○	○	○
驱动器(板)，铜制及电子零部件	×	○	○	○	○	○
透镜光学部件	○	○	○	○	○	○
外壳及其它零部件	○	○	○	○	○	○
本表格依据SJ/T 11364的规定编制						
○:表示该有害物质在该部件所有均质材料中的含量均在GB/T 26572规定的限量要求以下。						
×:表示该有害物质至少在该部件的某一均质材料中的含量超出GB/T 26572规定的限量要求。						
Applicable to China Only						

Disclaimer

免责条款

1. Please mount and apply in accordance with the classification of the luminaire and the IP number as well as other notes marked in mounting instruction. Do not immerse in water. The manufacturer will not be held responsible for IP protection failure caused by improper usage above mentioned.

请根据本产品【安装说明】中标注的防护等级和其他注意事项，正确使用和安装灯具。不可将本产品应用于浸水环境中。由此导致的灯具防护失效，生产商不承担责任。

2. The manufacturer will not be held responsible for product damages, physical injuries, or property damages caused by improper mount or improper usage.

如果不按照要求安装或操作，由此导致的产品损坏、人员伤亡、或其他财产损失，生产商不承担责任。

3. The manufacturer will not be held responsible for product damages, physical injuries, or property damages caused by improper usage or modifications of the product.

由不当使用或自行更改产品结构而导致的产品损坏、人员伤亡、或其他财产损失，生产商不承担责任。

4. The product didn't be tested by flood lighting/tunnel lighting standards, so can't be used as tunnel lighting

本灯具没有对防止灯具高空坠落的附加防护措施和灯具防风结构进行过考核，不可用作隧道灯具等