

TF8 / TF9 / TXF9 Teardrop Installation Instructions



Read These Instructions Carefully Before Installing This Fixture!



ATTENTION:

All wiring must be done by a qualified electrician.



WARNING:

Install, operate and maintain to meet all applicable codes.



WARNING:

Make sure that power is disconnected before performing installation and maintenance on this fixture.



WARNING:

This fixture is intended to be wired in accordance with the National Electrical Code and local code specifications. Failure to adhere to these codes may result in serious personal injury.



WARNING:

Ballast voltage must match supply voltage.

PRE-INSTALLATION

1 Determine the Hanger Type

(The Hanger feature is located on the top of the Upper Bell Housing. The Lower Bell Housing has the Optical Assembly attached to it.)

Cast Neck



Pipe Hanger



Install the pole and arm and attach the quick disconnect* in the arm to the supply wiring.

*For the Cast Neck version, the disconnect is supplied with the Hadco arm.

*For the Pipe Hanger version, the disconnect is supplied with the fixture.

2 Determine the Reflector Orientation

STREET SIDE direction is shown on the Lens Ring (oriented with the fixture latch).



NOTE: For the TF9 with Type III Horizontal Optics (3), refer to the label for STREET SIDE direction (oriented opposite the fixture latch).

3 Open the Fixture (TF8 / TF9 ONLY)



Always support the Lower Bell Housing when opening the fixture.

Disengage the external fixture latch by depressing the spring clip with your thumb while lifting up on the latch handle. Swing the Lower Bell Housing away from the Upper Bell Housing.

4 Disconnect the Safety Cable (TF8 / TF9 ONLY)



Disconnect the safety cable clamp from the tab on the Lower Bell Housing at the hinge and separate the Upper and Lower Bell Housings.

INSTALLATION

1 Install the Upper Bell Housing (TXF9 installed as complete unit)

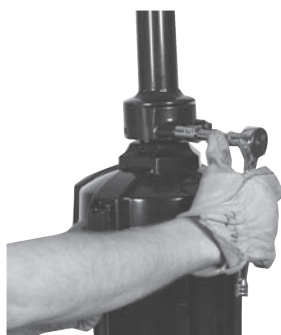

NOTE: Reference Arm and/or Adapter instructions for more information specific to mounting the fixture. (Reference Hadco drawing number 32000824 supplied with arm).

Connect the quick disconnect attached to the Upper Bell Housing terminal block to the power supply quick disconnect in the arm. Secure the Upper Bell Housing to the arm making sure that it is oriented properly (see reflector orientation above). Insure that the Upper Bell Housing is hanging level.

2 Install the Ballast Assembly (Steps 2-8 for TF8 / TF9 ONLY)

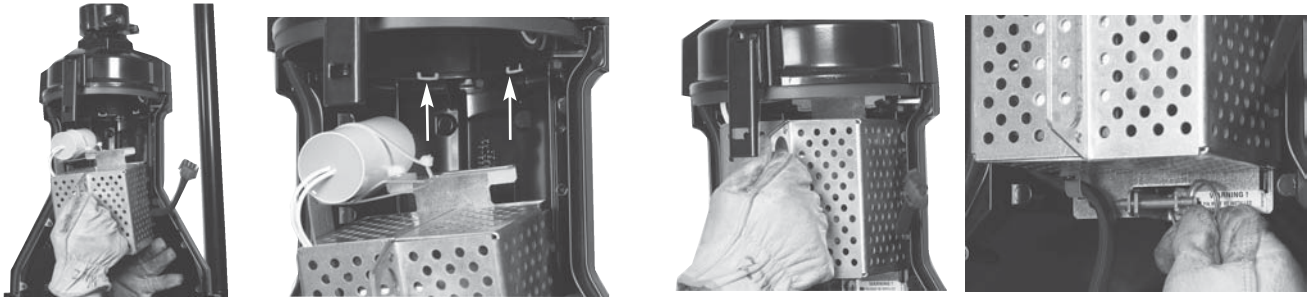

Hang the colored tabs of the ballast assembly in the color-coded internal notches located in the top of the Upper Bell Housing. Secure the ballast assembly with the quick release pin that is located in the Upper Bell Housing.

WARNING!!! The ballast assembly quick release pin **MUST** be installed.

3 Connect the Ballast Assembly to the Power Supply



Plug the blue male power quick disconnect exiting from the right side of the ballast assembly into the blue female power supply quick disconnect in the Upper Bell Housing.

4 Install the Lamp

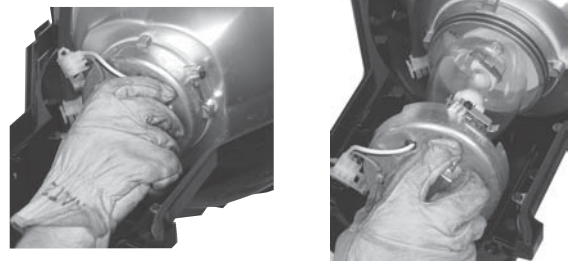

On the Lower Bell Housing, turn the socket cap counter-clockwise, lift the cap off, install the proper lamp and re-install the cap making sure the socket cap latch is secured in place.

NOTE: For the TF9 with Type III Horizontal Optics (3), note the socket cap latch position label.

5 Install the Lower Bell Housing

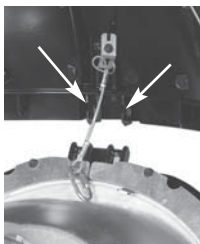

Hang the Lower Bell Housing onto the hinge bracket located on the Upper Bell Housing.

6 Reconnect the Safety Cable



WARNING!!! Be sure to reconnect the safety cable clamp and tighten securely with fingers only.

7 Connect the Ballast Assembly to the Lamp Socket



Connect the yellow male quick disconnect exiting the left side of the ballast assembly to the yellow female quick disconnect attached to the socket cap.

8 Close the Fixture



NOTE: Use caution not to pinch the socket lead wires between the Upper and Lower Bell Housing halves when closing the fixture.

Swing the Lower Bell Housing up to meet the Upper Bell Housing. Finish closing the fixture and insure the external fixture latch is securely engaged.

TF8 / TF9 Teardrop Installation Instructions

Replacement Parts, Ballast Modules

Fixture # (TF8) (TF9)	-	Wattage	Voltage (E) 120V (F) 208V (G) 240V (H) 277V (J) 480V (K) 377V
TF8	-	70S = 70W HPS	()
TF8	-	100S = 100W HPS	()
()	-	150S = 150W HPS	()
()	-	*200S = 200W HPS	()
()	-	*250S = 250W HPS	()
TF9	-	400S = 400W HPS	()
TF8	-	70H = 70W MH	()
TF8	-	100H = 100W MH	()
()	-	175H = 175W MH	()
()	-	*250H = 250W MH	()
TF9	-	400H = 400W MH	()
()	-	175P = 175W PSMH	()
()	-	200P = 200W PSMH	()
()	-	*250P = 250W PSMH	()
TF9	-	320P = 320W PSMH	()
TF9	-	350P = 350W PSMH	()
()	-	85R = 85W QL	**(E,F,G,H)

*Not available for TF8 with Type III (3) optics.

**Consult factory.

Replacement Optical Assembly

Fixture # (TF8) (TF9)	-	Finish (A) Black (B) White (G) Verde (H) Bronze (J) Green	Lens (KL) Long Acrylic (GF)* Flat Glass (GL) Long Glass	Optics (3)** Type III (4) Type IV (5) Type V
()	-	()	()	()

*For use with Type III (3) only.

**TF8 with Type III (3) optics only available with medium base (D) socket.

Brim

Fixture # (TF8) (TF9)	-	Brim Type (FB) Flat Brim (RB) Radial Wave Brim	Finish (A) Black (B) White (G) Verde (H) Bronze (J) Green
()	-	()	()

PHILIPS
HADCO

P.O. Box 128 • 100 Craftway

Littlestown, PA 17340

Phone 717.359.7131

Fax 717.359.9289

