

# PHILIPS

CoreLine  
Waterproof

WT120C G2 MDU

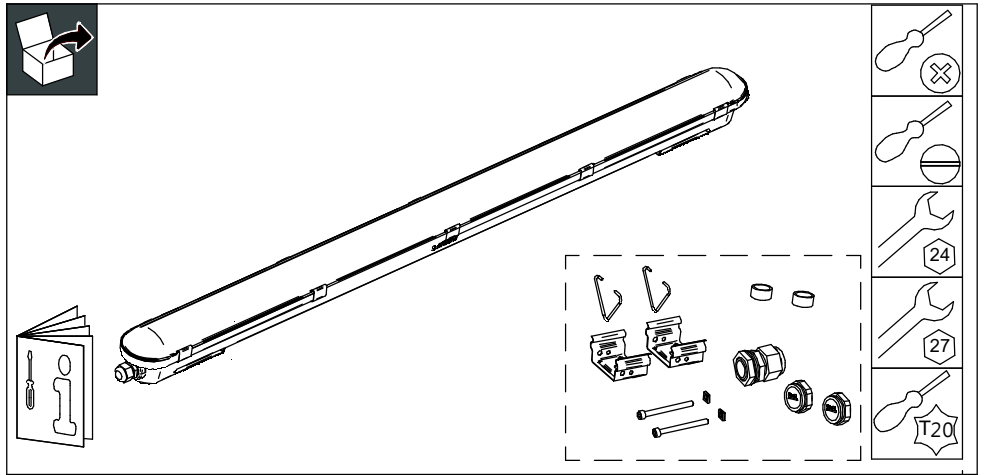

220 V  
240 V

50 Hz  
60 Hz



Max. 35 °C  
Min. -20 °C



LIFE  
L75  
50K hrs



IP65

IK08

GLOW WIRE  
850 °C



	System light output (Lm)	
WT120C G2 LED19S/840 PSU MDU L600	1900	0,9
WT120C G2 LED27S/840 PSU MDU L1200	2700	1,4
WT120C G2 LED27S/840 PSU MDU TW3 L1200	2700	1,5
WT120C G2 LED40S/840 PSU MDU L1200	4000	1,4
WT120C G2 LED40S/840 PSU MDU TW3 L1200	4000	1,5
WT120C G2 LED34S/840 PSU MDU L1500	3400	1,7
WT120C G2 LED34S/840 PSU MDU TW3 L1200	3400	1,8
WT120C G2 LED60S/840 PSU MDU L1500	6000	1,7
WT120C G2 LED60S/840 PSU MDU TW3 L1500	6000	1,8
WT120C G2 LED80S/840 PSU MDU L1500	8000	1,7

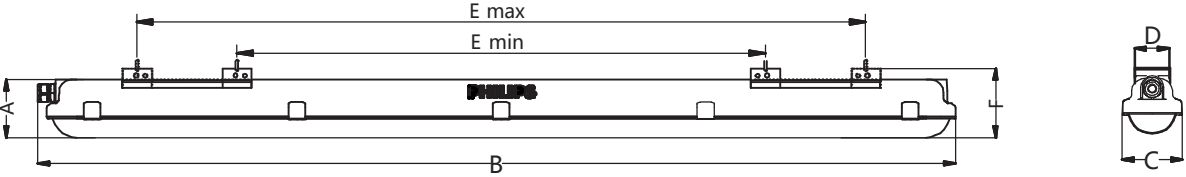

Type	Dimension (mm)							Nr. of clips
	A	B	C	D	E <sub>min</sub>	E <sub>max</sub>	F	
WT120C G2 LED18S L600	76	665	80	38	308	512	85	6
WT120C G2 LED27S L1200		1215			538	1062		10
WT120C G2 LED40S L1200		1515			838	1362		12
WT120C G2 LED34S L1500								
WT120C G2 LED60S L1500								
WT120C G2 LED80S L1500								

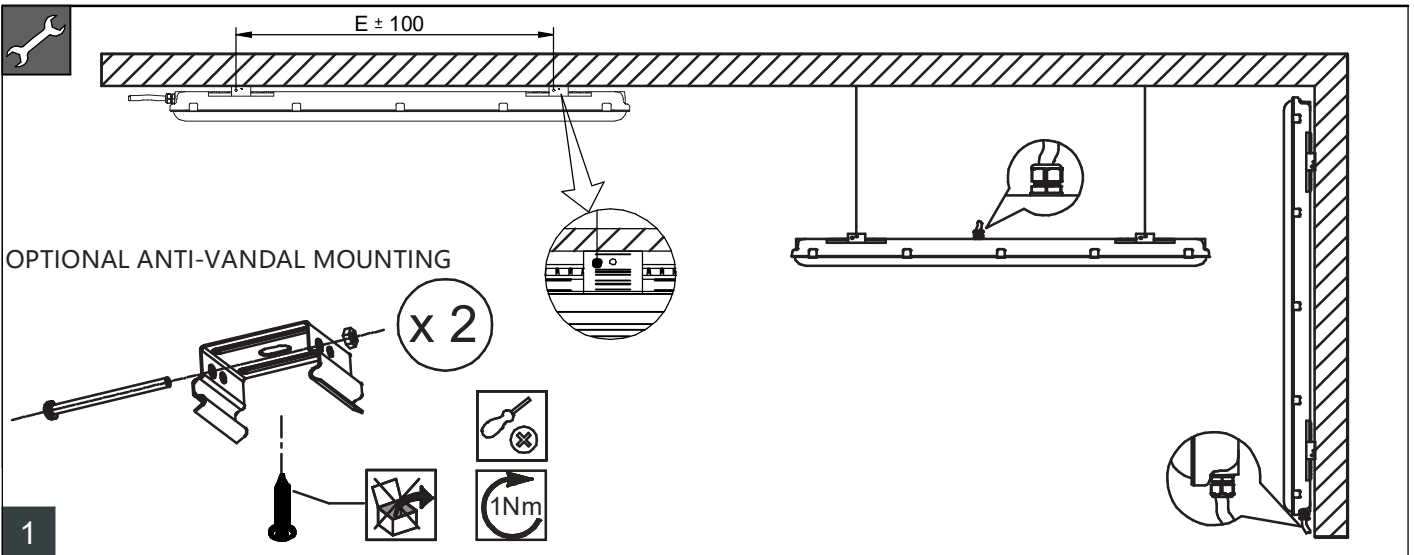

PSU versions

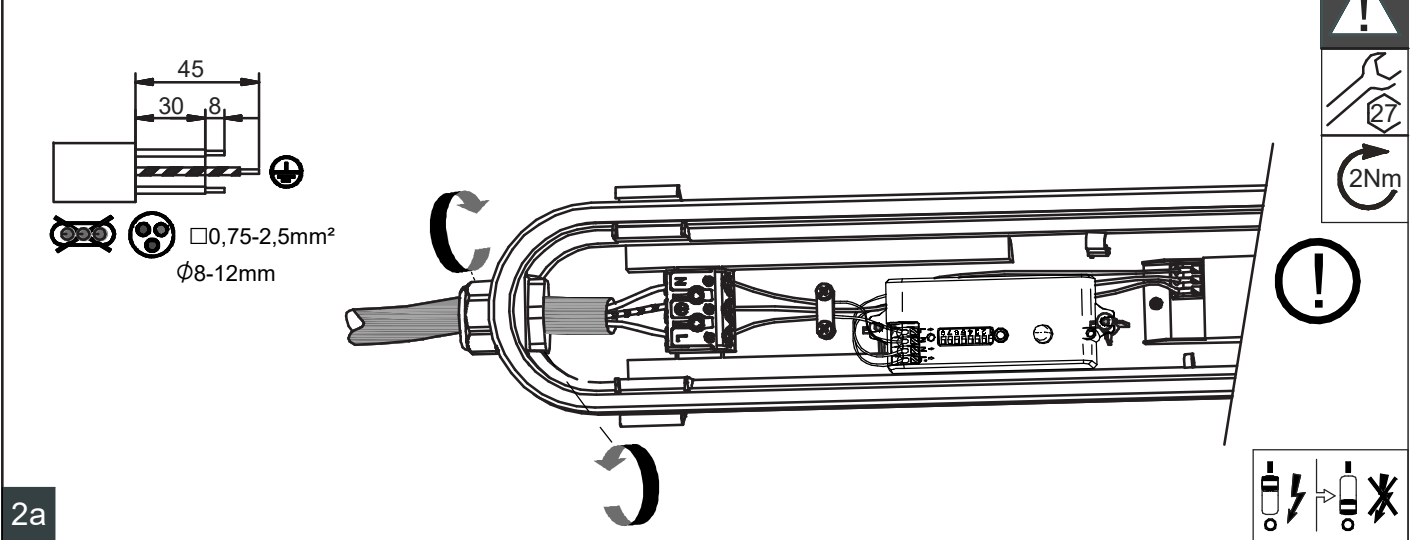

TW3 versions

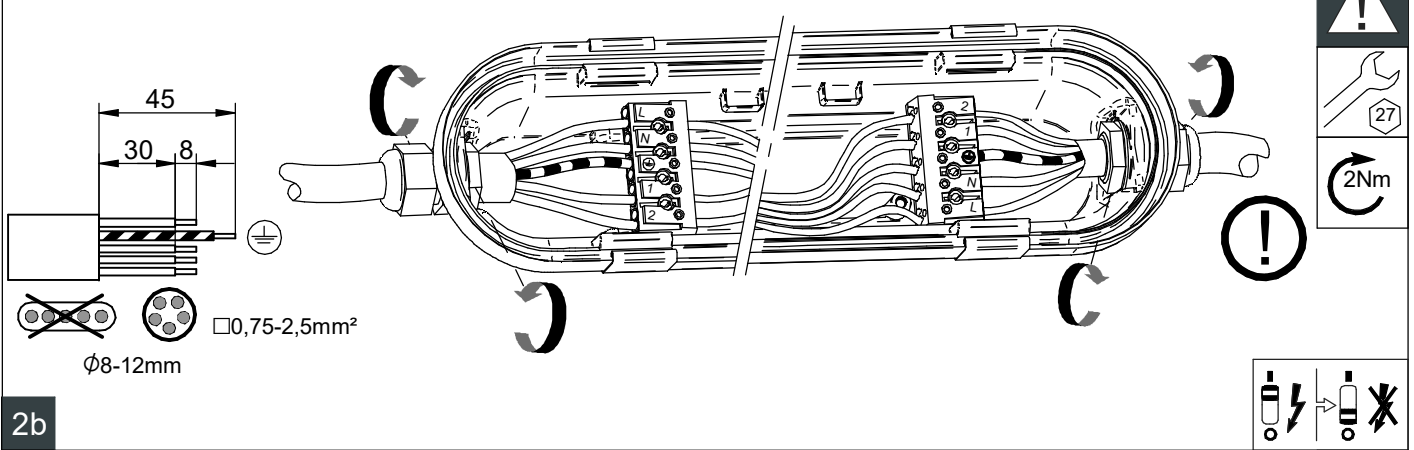

Through wiring

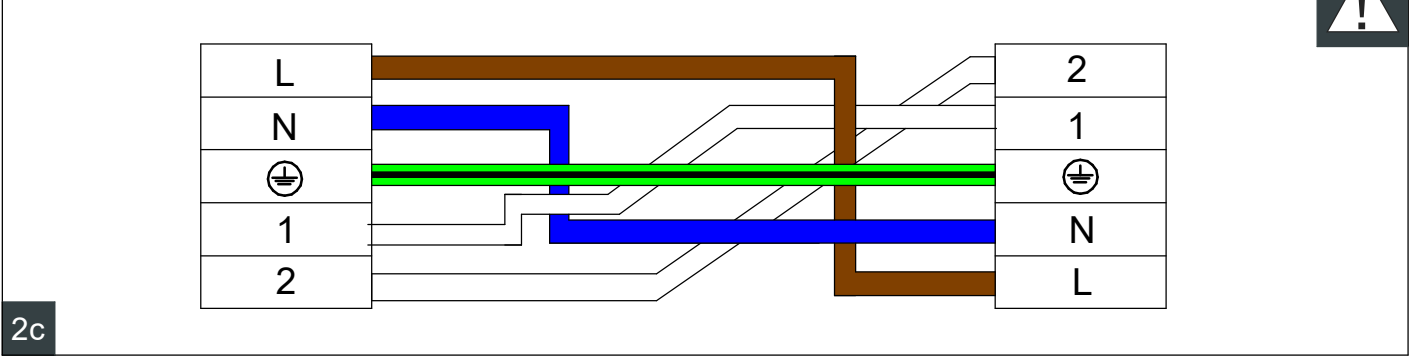

Install cable in other location (optional)

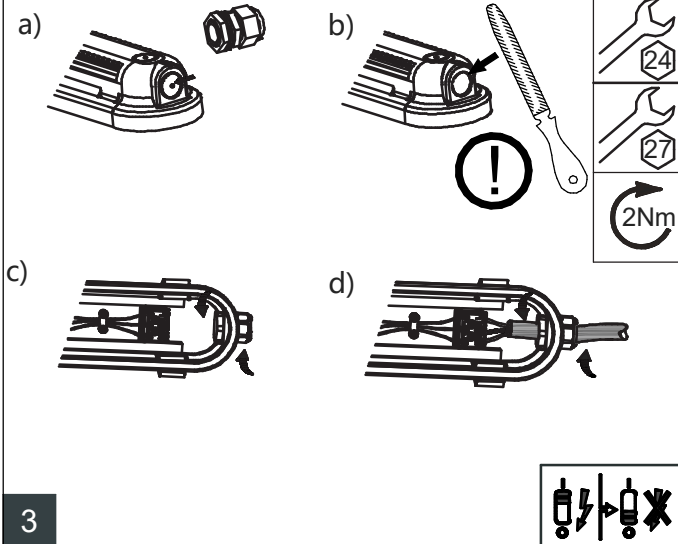

Replacement of Silicone Plug (optional)

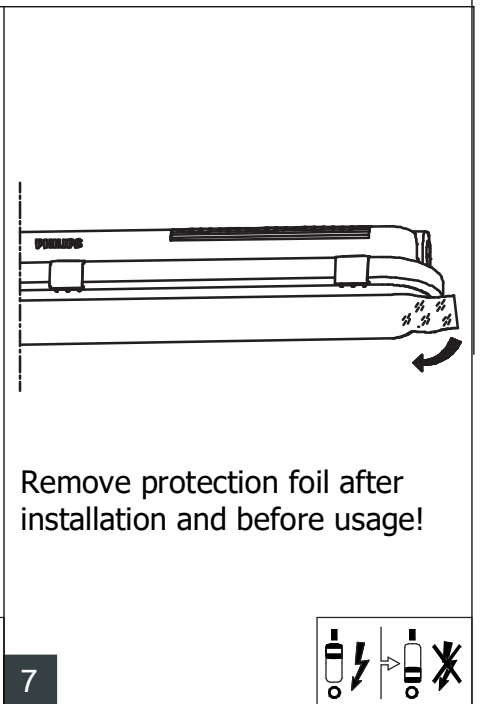
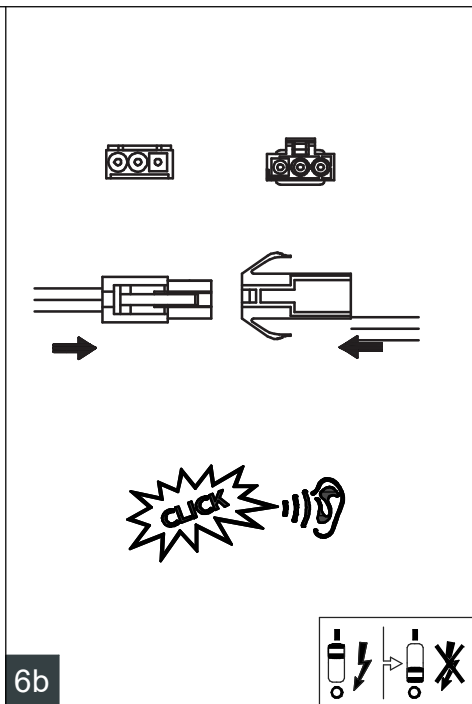
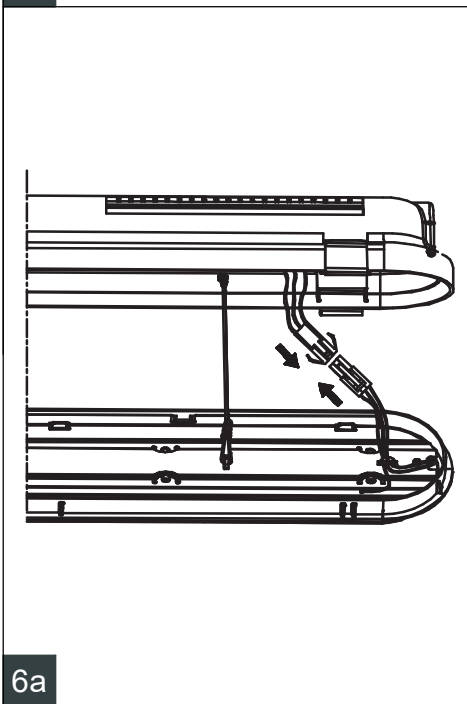
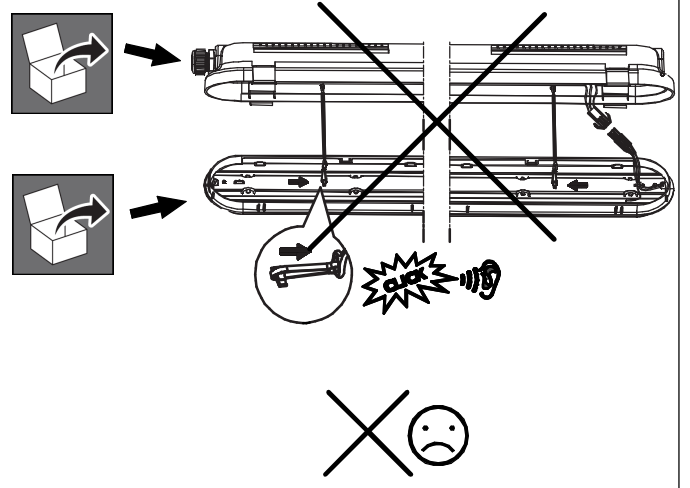
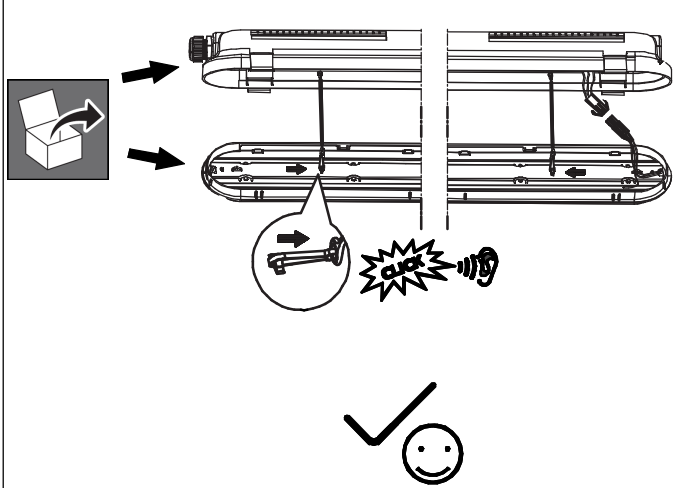
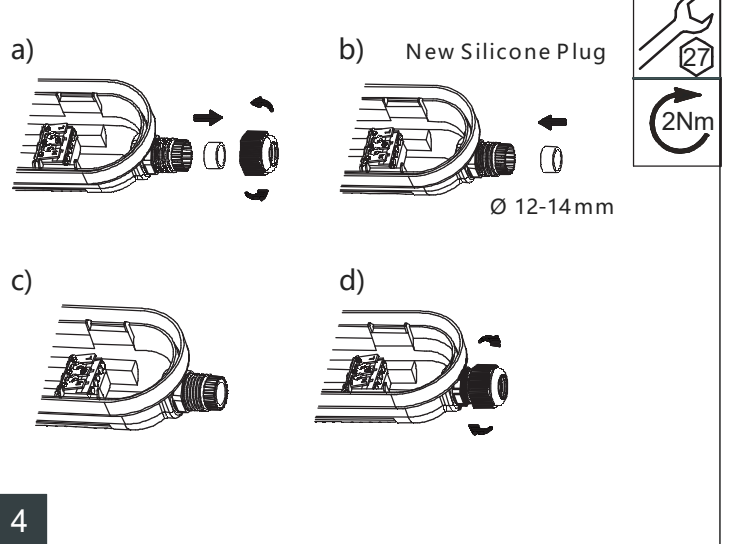

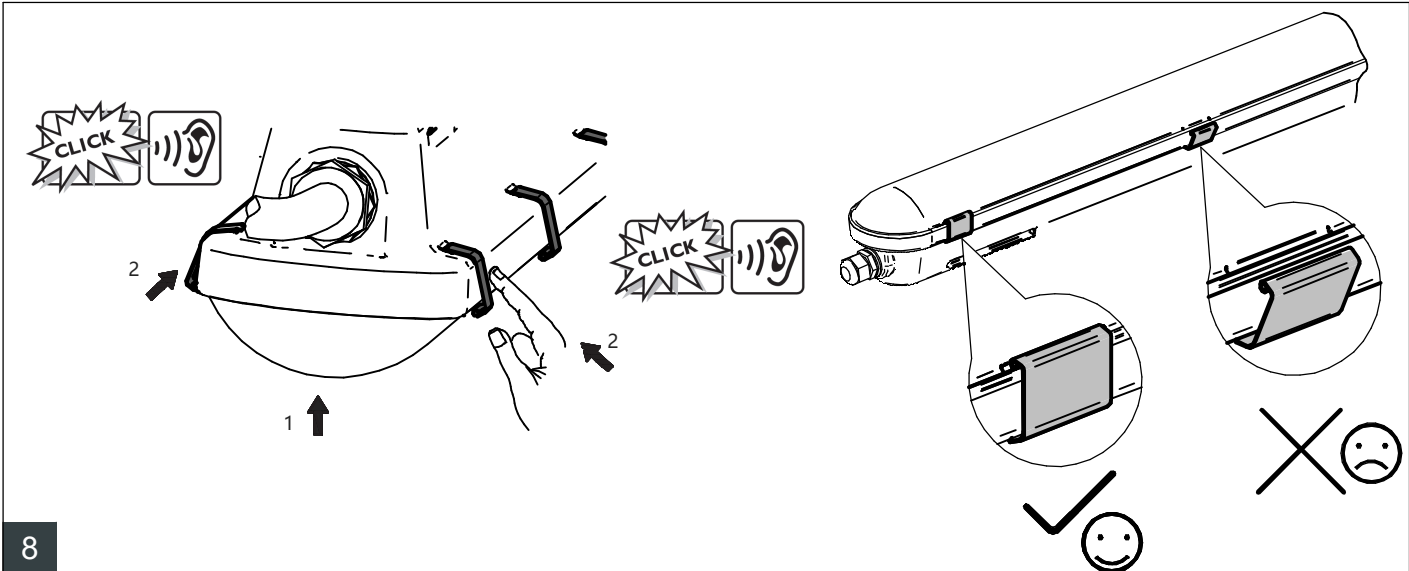

8

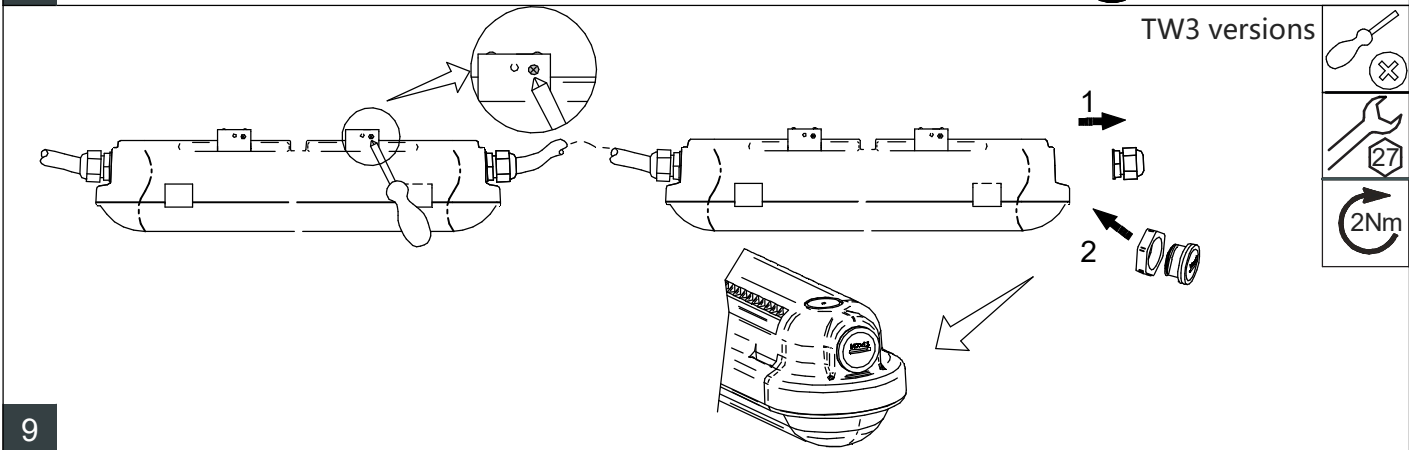

9

**Microwave Motion Sensor**

Mounting height: 4m max.  
 Detecting angle: 150° (wall mounted)  
 360° (ceiling mounted)

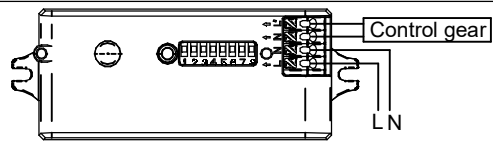
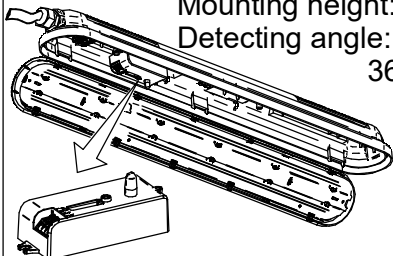

The sensor is designed to connect one load only.  
 Connecting more than one load may damage the sensor.

**DIP Switch settings:**

**Detection area**

(default 100%)  
 Detection area can be reduced by selecting the combination on the DIP switches to fit precisely each application.  
 Detection radius: 6-8m (mounting height 3m)

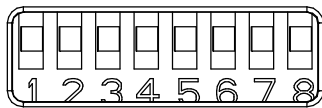

**Hold time** (default 5 min.)  
 Refers to the time period the lamp remains at 100% illumination after no motion detected.

**Daylight sensor** (default disabled)

The sensor can be set to only allow the luminaire to illuminate below a defined ambient brightness threshold. When set to Disable mode, the daylight sensor will switch on the luminaire when motion is detected regardless of ambient light level. 40 lux, 30 lux: twilight operation, 10 lux, 2 lux: darkness operation only.

	1	2	
I	ON	ON	100%
II	-	ON	75%
III	ON	-	50%
IV	-	-	25%

	3	4	5	
I	ON	ON	ON	5 sec
II	-	ON	ON	30 sec
III	ON	-	ON	90 sec
IV	-	-	ON	5 min
V	ON	ON	-	20 min
VI	-	-	-	30 min

	6	7	8	
I	ON	ON	ON	2 Lux
II	ON	ON	-	10 Lux
III	-	ON	-	30 Lux
IV	ON	-	-	40 Lux
V	-	-	-	Disable

10a

Radiation pattern

Ceiling mounted height: 4m  
Sensitivity: 100%/75%/50%/25%

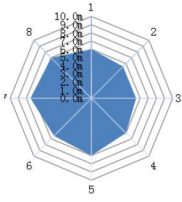

Normal moving (Speed:0.3m/s)

Ceiling mounted height: 4m(\*)  
Sensitivity:100%

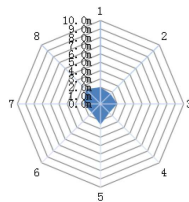

Normal moving (Speed:1m/s)

Horizon mounted height: 2.5m  
Sensitivity: 100%/75%/50%/25%

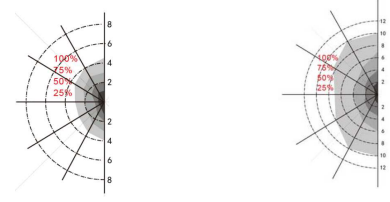

Normal moving (Speed: 1m/s) Slow moving (Speed 0.3m/s)

\*Only 100% detection sensitivity is workable when installed at 4m mounting height. 25%/50%/75% sensitivity is not able to detect motion signal.

10b

Initialization:

After power on, the sensor automatically turns on light at 100% brightness. After 10sec, it turns off the light. During the initialization, the sensor is not able to detect movement.

Override function:

- quick switch ON/OFF 3 times within 2sec to override sensor function. Light will switch on regardless of motion. Power off and on again to recover sensor function

10c

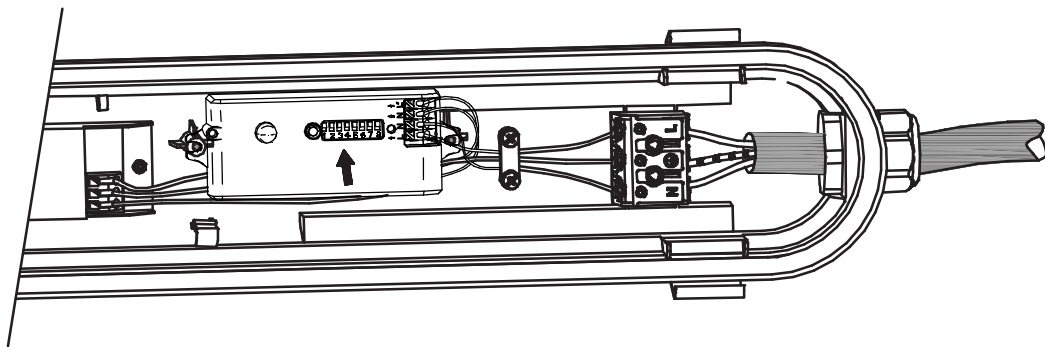

11

SERVICE

Light source (LED) is non-user replaceable. The light source contained in this luminaire shall only be replaced by the manufacturer or his agent or a similar qualified person.

Do not touch electronic components!  
Electronic components maybe under high voltage.  
Caution, risk of electric shock

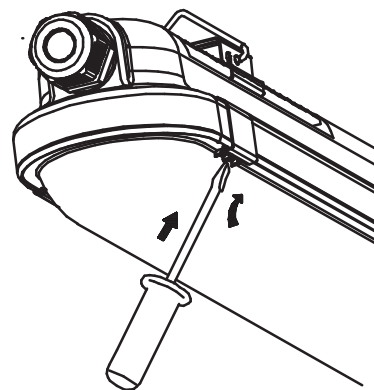

12a



## Driver replacement

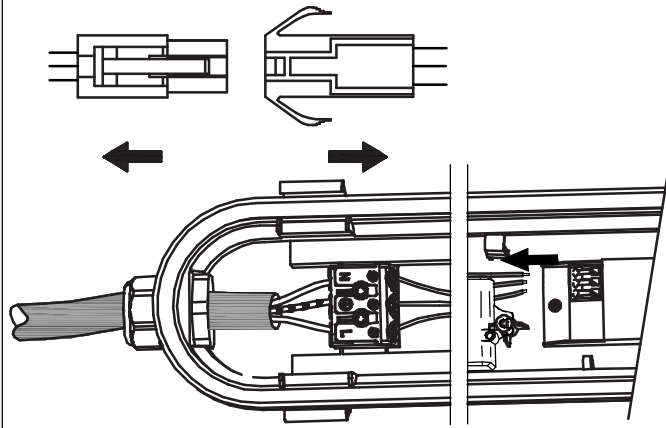

12b

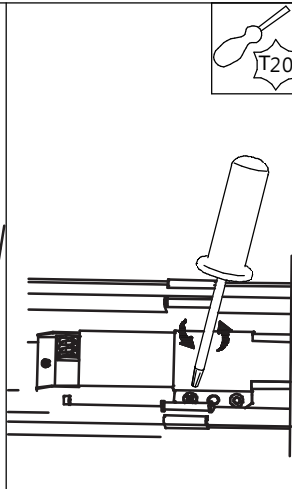

12c

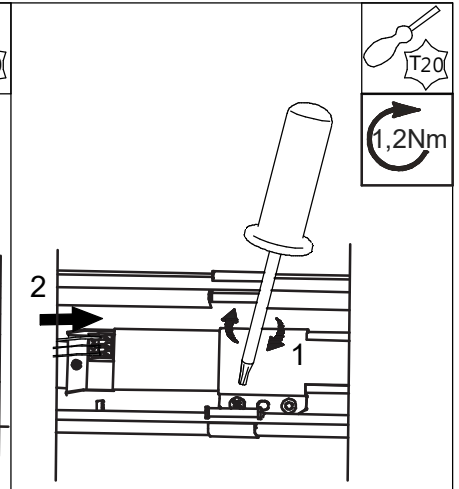

12d

New driver

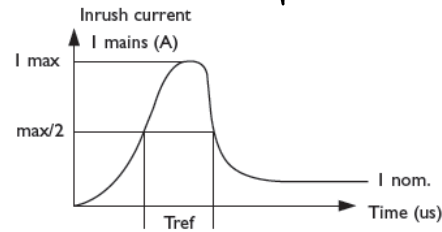
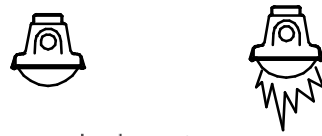
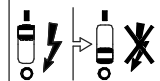

	LED19S	LED27S	LED34S	LED40S	LED60S	LED80S
Driver type	PSU	PSU	PSU	PSU	PSU	PSU
I <sub>peak</sub> [A]	3,58	3,58	5,16	5,16	5,56	6,9
T <sub>ref</sub> [μs]	40	40	47	47	47	58
Max. Nr of products						
Drivers / MCB 16A type B [max.]	80	80	60	60	45	30
Drivers / MCB 10A type B [max.]	50	50	37	37	28	18
Drivers / MCB 16A type C [max.]	136	136	102	102	76	51
Drivers / MCB 10A type C [max.]	80	80	62	62	46	31

\* Do not stare into LED light beam

\* The luminaire shall be installed by a qualified electrician and wired in accordance with the latest IEE electrical regulations or the national requirements

\* The luminaires are not suitable for CBS (Central Battery System)

