

Good

Better

Best

Click on products to learn more

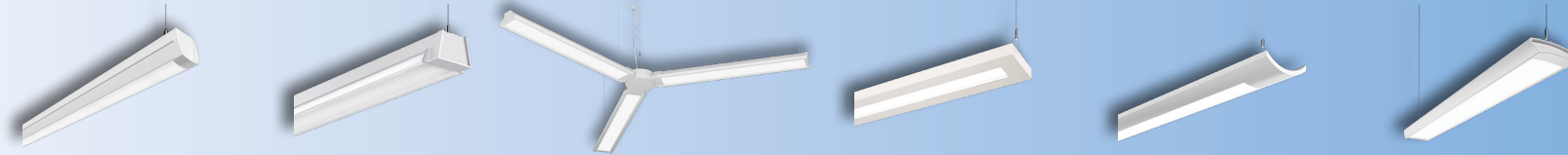

		Hugo	RZL	WSLA	Jaylum	Iridium i3	Continua CTA
APPLICABILITY	Education	★★★	★★	★★	★★★	★★★	★★★
	Office	★★	★	★★★	★★★	★★	★★
	Healthcare	★★	★★	★★	★★	★★	★★
	Retail	★★★	★★★	★★★	★	★	★★
FEATURES / PERFORMANCE	Construction	Extruded Aluminum	Cold Rolled Steel	Steel/Extruded Aluminum	Cold Rolled Steel	Cold Rolled Steel	Extruded Aluminum
	Lengths	4', 8', 12', Cont.	4', 8', 12', Cont.	4', 8', Cont.	4', 8', Cont.	4', 8', Cont.	4', 8', 12', Cont.
	Pattern / Layout	Straight	Straight	Straight, Intersection (Up to 6-way with hub)	Straight	Straight	Straight
	lm/W (Max)	145	135	133	157	158	147
	Lumens (Max)	8000 (2000 lms/ft)	8800 (2200 lms/ft)	8000 (2000 lms/ft)	8000 (2000 lms/ft)	8000 (2000 lms/ft)	6000 (1500 lms/ft)
	Up/Down % Options	2	2	3	5	5	4+
	CIE Type	Direct, Semi-Direct	Direct, Semi-Direct	Direct, Semi-Direct	Direct/Indirect	Direct/Indirect	Direct, Direct/Indirect
	Life (@60K)	L85	L85	L93	L93	L93	L84
	Shielding	Frost - Smooth, Drop Lens, Baffle	Frost -Linear Prismatic, Baffle	WaveStream - Acrylic	Frost - Smooth	Frost - Smooth	Frost - Continuous Roll Lens
	Companion Family Fixtures	Surface	Surface	Surface	Wall, Sconce	-	Wall
	Driver Location	Integral	Integral	Integral	Integral	Integral	Integral
	Emergency	Integrated	Integrated	Integrated	Integrated	Integrated	Integrated
	CRI	80+ / 90	80+ / 90	80+ / 90	80+ / 90	80+ / 90	80+ / 90
Sensor Location	Integrated, Side Mount	Integrated	Integrated, Fixture or Hub	Integrated	Integrated	Integrated, Side Mount	
DLC	Premium	Premium	Premium	Premium	None	Premium	
VividTune™	No	No	No	Tunable White	Tunable White	No	
INTEGRATED CONTROLS	Stand Alone Daylight / Occupancy		✓	✓	✓	✓	
	WaveLinx Lite	✓	✓	✓	✓	✓	✓
	WaveLinx	✓	✓	✓	✓	✓	✓
	Enlighted	✓	✓	✓	✓	✓	✓
	DLVP						

Notes: 1. ★★★ = high applicability, ★★ = medium applicability, ★ = low applicability, blank = non-applicable

Click on products to learn more

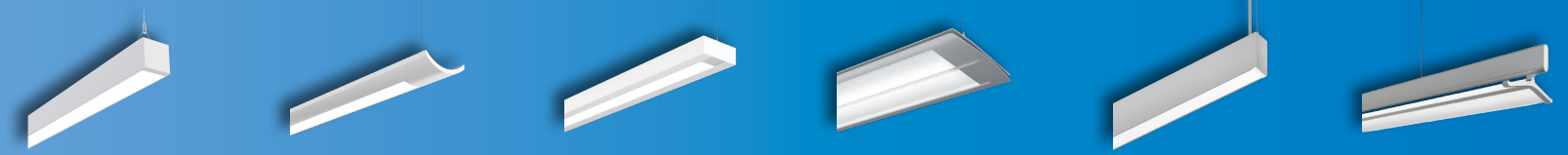

		Continua SQ4	Iridium i2 WaveStream	Element /Loft / Vertechs WaveStream	Divide	Define	Converge
APPLICABILITY	Education	★★★	★★★	★★★	★★	★★	★★★
	Office	★★★	★★	★★	★★★	★★★	★★★
	Healthcare	★★	★★	★★	★	★★	★
	Retail	★★	★	★	★★	★	★★
FEATURES / PERFORMANCE	Construction	Extruded Aluminum	Cold Rolled Steel	Extruded Aluminum	Extruded Aluminum	Extruded Aluminum	Extruded Aluminum
	Lengths	2', 4', 6', 8', 12', Cont.	4', 8', Cont.	4', 8', 12', Cont.	4', 8', Cont.	2' - 12', Cont.	4', 8', Cont.
	Pattern / Layout	Straight	Straight	Straight	Straight	Straight, Corners, Intersection	Straight
	lm/W (Max)	147	114	116	140	164	119
	Lumens (Max)	10,800+ lm (2,700+ lms/ft)	7200 (1800 lms/ft)	7200 (1800 lms/ft)	6000 (1500 lms/ft)	9900 (2475 lms/ft)	6700 (1700 lms/ft)
	Up/Down % Options	28+	3	3	2	∞	3
	CIE Type	Direct, Direct/Indirect, Indirect	Direct, Direct/Indirect	Direct, Direct/Indirect	Direct, Direct/Indirect	Direct, Direct/Indirect, Indirect	Direct, Direct/Indirect
	Life (@60K)	L84	L81	L81	L87	L90	L85
	Shielding	Frost - Continuous Roll Lens Black/White Louvered Baffle	Frost - Linear Prismatic	Frost - Smooth	WaveStream - Acrylic Specular, Diffuse	Frost - Smooth, Drop & Regressed, Asymmetric and Batwing Lens	WaveStream - Acrylic Diffuse
	Companion Family Fixtures	Recessed, Wall	-	-	Surface, Wall, Recessed	Surface, Wall, Recessed, Perimeter	-
	Driver Location	Integral	Integral	Integral	Integral	Integral	Remote w/ Luxwire
	Emergency	Integrated	Integrated	Integrated	Integrated	Integrated	Remote
	CRI	80+ / 90	80+ / 90	80+ / 90	80+ / 90	80+ / 90	80+ / 90
Sensor Location	Integrated, Endcap/Side Mount	Integrated	Integrated	Integrated	Integrated	Tile Mount	
DLC	Premium	Standard	Standard	Premium	Premium	None	
VividTune™	Tunable White	No	No	No	Tunable White	No	
INTEGRATED CONTROLS	Stand Alone Daylight / Occupancy		✓	✓		✓	✓
	WaveLinx Lite	✓			✓	✓	
	WaveLinx	✓	✓	✓	✓	✓	✓
	Enlighted	✓	✓	✓	✓	✓	✓
	DLVP						✓

Notes: 1. ★★★ = high applicability, ★★ = medium applicability, ★ = low applicability, blank = non-applicable

# Architectural Linear LED

Lines of Light

# Metalux | Corelite | Neo-Ray

Good

Better

Best

Whether lighting contemporary architectural spaces or general area lighting, **Cooper Lighting Solution's architectural linear LED** products offer a complete family of innovative, affordable, and energy saving LED solutions for your next project.

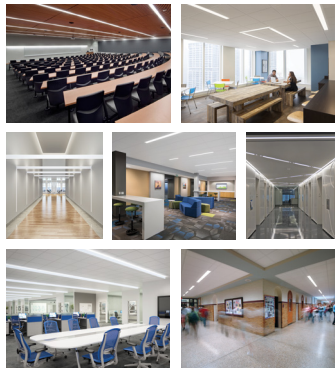

Click on products to learn more

		Metalux RBG	Metalux RCG	Corelite CL	Neo-Ray Define Standard	Neo-Ray Define Premium
<b>APPLICABILITY<sup>1</sup></b>	<b>Office</b>	★★	★★	★★	★★★	★★★
	<b>Secondary Education</b>	★★	★★	★★	★★★	★★
	<b>Primary Education</b>	★★★	★★★	★★★	★★	★
	<b>Healthcare</b>	★★	★	★	★★	★★★
	<b>Tenant Improvement</b>	★★★	★★★	★★★	★★	★
<b>FEATURES / PERFORMANCE</b>	<b>Apertures</b>	4"	3"	2", 4"	1.5", 2", 3", 4", 5"	1.5", 2", 3", 4", 5"
	<b>Sizes</b>	Fixed 2', 4', 8'	4', 8'	4', 8' + Continuous Runs	2'-12' + Continuous Runs	2'-12' + Continuous Runs
	<b>Length Resolution</b>	Fixed	Fixed	4' Increments	1" Increments	1" Increments
	<b>Installation Type</b>	Ceiling, Wall	Ceiling	Ceiling	Ceiling, Wall, Perimeter	Ceiling, Wall, Perimeter
	<b>Configuration Geometry</b>	Straight	Straight	Straight	Straight, Corners, Intersection	Straight, Corners, Intersection
	<b>Compatible Family Fixtures</b>	Surface/Susp & Drywall Kits	N/A	N/A	Suspended, Surface, Wall	Suspended, Surface, Wall
	<b>lm/W (Max)</b>	115	121	124	127	141
	<b>Lms/ft (Max)</b>	1,000	1,000	1,200	1,400	1,500
	<b>Standard Lumen Levels</b>	3	4	5	5 + Custom	5 + Custom
	<b>Lens</b>	Flush Frosted	Flush Frosted, Asymmetric	Flush Frosted, Asymmetric	Flush & Drop Frosted, Asymmetric, Louver	Flush & Drop Frosted, Asymmetric, Louver
	<b>Emergency</b>	Integrated, Remote Switch	Integrated	Integrated	Integrated	Integrated
	<b>CRI</b>	80+	80 Standard, 90 Optional	80 Standard, 90 Optional	80 Standard, 90 Optional	80 Standard, 90 Optional
	<b>Ceiling Integration / Flange Type</b>	Standard T-Grid, Gypsum	Standard T-Grid, Gypsum	6 Common Architectural Systems	>12 Architectural Ceiling Systems	>12 Architectural Ceiling Systems
	<b>DLC</b>	Standard	Standard	Standard	Standard & Premium	Standard & Premium
	<b>VividTune™</b>	No	No	No	No	Tunable White
<b>INTEGRATED CONTROLS</b>	<b>WaveLinx, Enlighted, DLVP, Stand Alone</b>	Integrated or Tile Mount	Integrated	Integrated	Integrated or Tile Mount	Integrated or Tile Mount
	<b>Integral Downlights</b>	N/A	N/A	N/A	Optional Fixed or Adjustable	Optional Fixed or Adjustable

Notes: 1. ★★★ = high applicability, ★★ = medium applicability, ★ = low applicability, blank = non-applicable