

A photograph of a city street in autumn. The street is lined with red brick buildings and trees with yellow leaves. A modern, silver, pole-mounted street lamp is visible on the right side of the street. The ground is covered with fallen yellow leaves. In the bottom right corner, a small pigeon is visible on the sidewalk.

PHILIPS

TownTune

Public lighting



Extending the
home
experience
to the street



Introduction

Extending the home
experience to the street

Cities are evolving as urbanization increases. By 2050, over two thirds of the world's population is expected to live in cities. As a result, different city areas are developing and changing, each with its own purpose and needs. For example, in residential areas people want to relax. They are looking for attractive, welcoming spaces that invite them to take a late evening walk.

Contents

Street lighting
TownTune
Content

4

Introduction

6

Meet TownTune



8

TownTune range



11

Lighting performance

12

LEDGINE optimized

14

Application areas

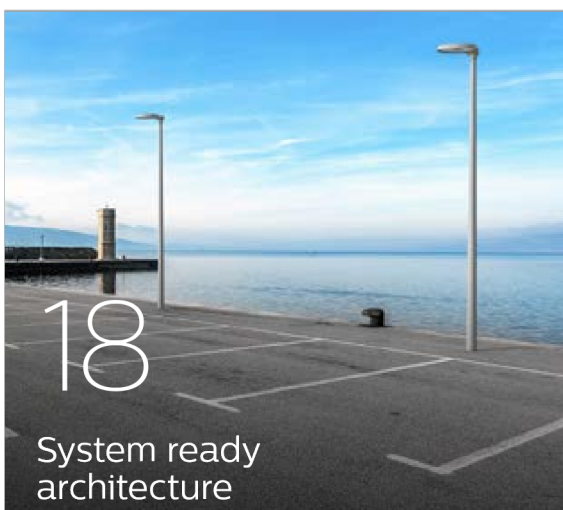

18

System ready
architecture

16

Designed for serviceability

21

Technical Components
Design

22

Dimensional drawings

26

Specifications





The evolving role of lighting

As the needs and roles of cities evolve, requirements in terms of lighting are also changing. Cities want to create their own signature, emphasizing their unique character. Whether through adding a custom touch to their urban furniture or by bringing a more personal feel to the urban landscape.

Going beyond basic illumination, modern urban lighting also has to deliver additional value in residential areas, helping to make spaces safer and more livable for citizens. Lighting needs to create ambience and enhance quality of light to the maximum. In addition, it has to be easy to maintain while keeping energy consumption and total cost of ownership to a minimum.

Meet TownTune

Designed for evolving urban spaces, TownTune is ready to meet the needs and expectations of cities by offering comfortable, yet efficient lighting experiences and advanced connectivity options packaged in a customizable design. All this makes TownTune suitable for many different applications in urban spaces.





Comfort and high quality of light

Thanks to the dedicated bowl and the high quality of light TownTune delivers comfortable lighting without compromising on visibility and safety



Customizable design

With its simple and pure design, TownTune can be integrated into various urban environments. And with a wide range of accessories, you can customize it to create a unique light signature, which can also become part of the urban furniture in daytime.



Wide application coverage

TownTune has a wide application coverage and offers great performance through the latest LEDGINE optimized LED platform, which provides access to a broad range of light distributions. Furthermore, thanks to L-Tune, you can configure an application-optimized solution for any project.



Future-proof and easily serviceable

TownTune is easy to service thanks to the Philips Service tag. And since it's System ready, it can be paired with lighting control and software applications like Interact City, either today or in the future.

TownTune range

TownTune was dedicatedly designed to seamlessly blend into urban and residential spaces. By making use of the customization options like add on accessories, you can also create a unique signature across your city or certain districts.

Modular options

TownTune's modular configuration allows you to add various accessories, creating a different look and feel for every application, while leaving the heart of the luminaire accessible for easy maintenance.

Design options:

- A standard minimal design.
- A decorative ring at the bottom of the luminaire with either a clear or golden finish. The specific texture inside the ring makes it visible both during the day and at nighttime.
- The top cone and decorative dome accessories feature specially designed details which can change the overall appearance of the luminaire. As well as offering a completely different look and feel, these decorative elements can be used to hide additional components such as antennas and GPRS nodes.

Each accessory can be further customized with additional options. For example, a decorative top cone can have an additional golden ring.



		Without Ring	Clear ring	Golden ring
Central post-top	Standard			
	Top cone Accessory			
	Top dome Accessory			
Asymmetric	Standard			
	Top cone Accessory			
	Top dome Accessory			
Lyre	Standard			
	Top cone Accessory			
	Top dome Accessory			

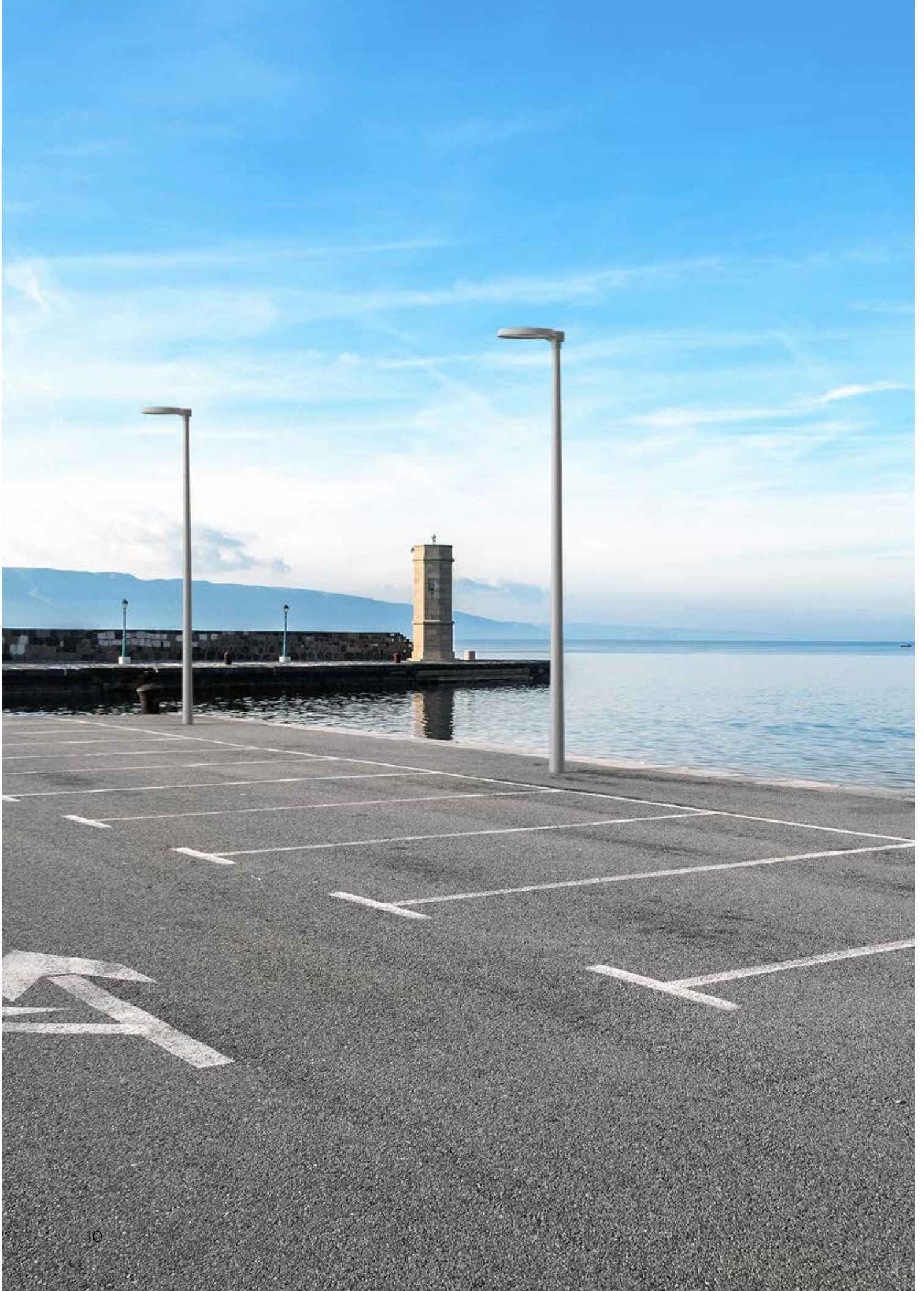

Lighting performance

TownTune uses the standardized Philips LEDGINE optimized optics platform, ensuring that you always have the right amount of light and in the right direction. An extensive range of lumen packages is available in both warm (3000K) and neutral white color (4000K). In combination with an extensive range of optics, it's possible to deliver the right distribution for virtually any urban application.

Portfolio of optics

Illuminance classes (P, C)

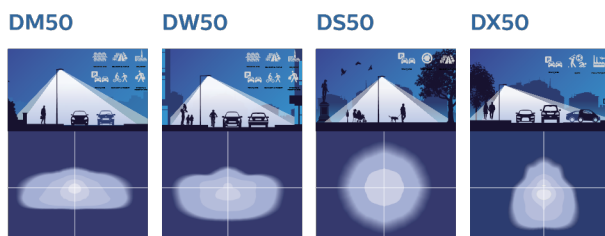

Dedicated applications

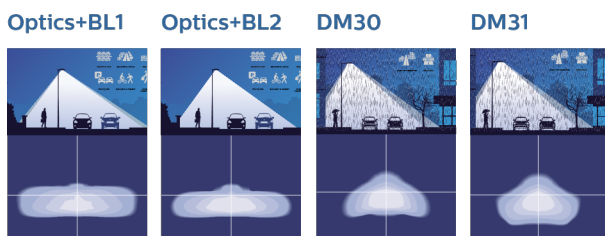

Luminance classes (M)

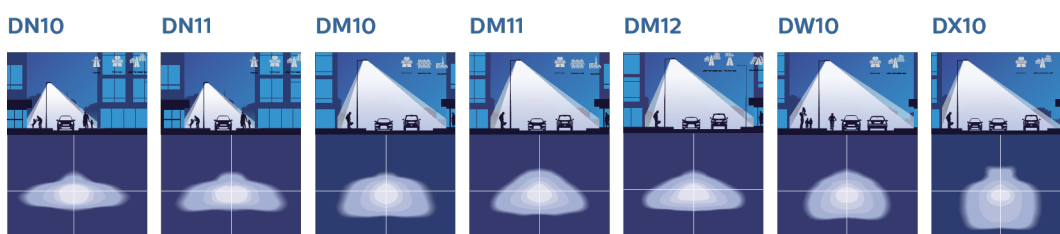

LEDGINE

optimized



Standardized
optics



Standard
engine



Tailor-made
solutions

The new generation LEDGINE offers a unique combination of standardization and customization, so you can tune lighting solutions to suit your exact needs. The three pillars that characterize the LEDGINE are standardized optics, standard engine and tailor-made solutions.

Standardized optics

Complete new optics range ensures a perfect fit for every application. The optics offer flexibility, enabling standardization over applications with outstanding performance across a wide range of geometries – as well as design parameters such as tilt and overhang. They are easy to use and distribution remains the same, so even after a LED upgrade you are assured of design continuity. The optics comply with national and European road lighting standards.

Standard engine

Using a standard engine across key portfolio means you can benefit from the latest LED upgrades to various products without changing light distributions. The flux packages are pre-defined across product ranges, including CLO options. Flux minimization is achieved by using the highest flux package (up to L96B10) per standard. And for upgrades, the lighting image is continued and the engine is available for your installed base. Easy configuration is assured thanks to the Philips Service tag.

Tailor-made solutions

For tuned project solutions, we can support you with the exclusive L-Tune tool. It enables you to build the required flux to ensure the best balance between operational life, maintained flux, energy costs and product type. You can create your own standard by matching requirements to your own policy. For serviceability, the L-Tune program codes are linked to the Philips Service tag.



Application areas

Whether specified for new installations or as a 1:1 retrofit, TownTune is well suited to residential areas, parks, squares and pathways as well as private spaces near offices, campuses or parking areas.

The built-in Philips standardized LEDGINE optimized optics allow an array of different distributions. Together with the various dimming and control options, you can easily create the right lighting scenario for each application.

The TownTune application areas include:

office and industrial areas

Pathways

Parks

Squares

Residential area



Street lighting

TownTune

Application
areas



Designed for serviceability

Since LED luminaires require different competencies and processes for maintenance, fault finding and repair, TownTune and its components are designed with serviceability in mind. Furthermore, to provide better support, 24/7 access to information and spare parts ordering, all TownTune products and packages can be identified by the unique Philips Service tag QR code.

“

The greatest value of the Philips Service tag is that it enables us **to save precious time and avoid human errors.**”



Why Philips Service tag?



Easy access to relevant information

Improving installation process by providing easy access to product configuration information



More effective maintenance

Enabling more effective maintenance operations by identifying spare parts

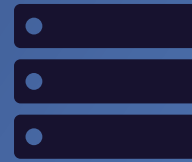

Digital maintenance

Enabling you to pre-program spare parts to factory settings

Instant access to procedures, spare part list and programming

This tag features a QR-based identification system that gives you instant access to critical information during unpacking, installation, diagnostics, fault reporting and programming. Simply scan the tag with a smartphone or tablet running the Philips Service tag app, and the contents of the box plus installation information are described. The tag also activates the five-year warranty. To assist in diagnosing breakdowns, scanning the tag provides the troubleshooting guide applicable to that luminaire. Sourcing spare parts and 'one touch' programming of parts to original settings can also be done using the app. It's that simple.

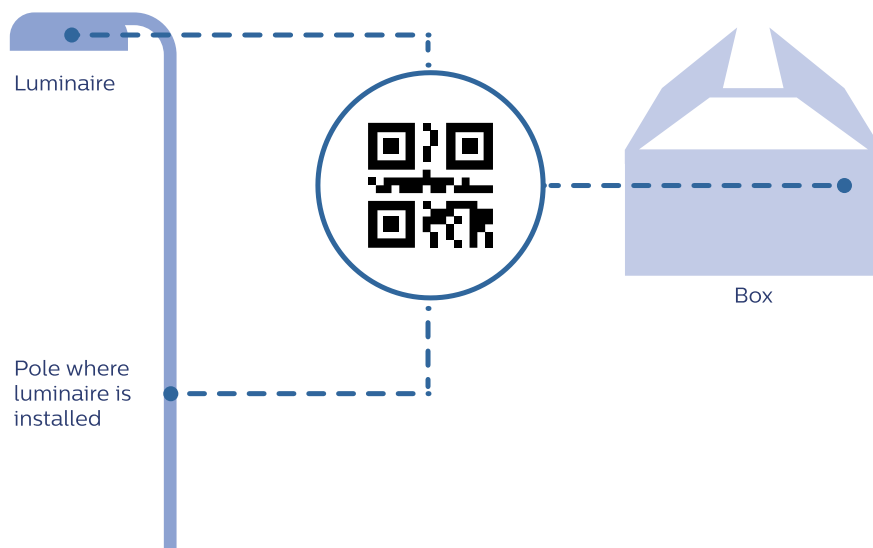

System ready architecture

The digital and smart city era is accelerating fast. To keep pace, cities need luminaires that are not only designed for today's technologies, but are prepared for future advances and upgrades. The System ready architecture gives you a scalable foundation that you can build on whenever your city is ready to opt into new advances in technology. So you can take light beyond illumination into a dynamic world of sensor-rich lighting - whenever you're ready.

Upgrade now or later

TownTune is a System ready luminaire, coming with universal sockets on each luminaire, so all you have to do is click in controllers or sensors to activate new applications. That means you can install your luminaires today and mount controllers and sensors at a later date - without any hassle.

An open platform

Our System ready luminaires use state-of-the-art architectures and components. Because they are SR certified, they are compatible with all components released in our SR program. This ensures you'll always be ready for the latest innovations that will enable you to get more out of your lighting infrastructure.



Future-proof upgrades

System ready luminaires can be paired with sensors and controllers now or later. A city solution that is completely flexible and scalable.



Plug and play

Designed for hassle-free installation, controllers and sensors can be mounted without opening the luminaire.



Standardized technology

Thanks to Zhaga standardization and the SR certified program, you will have access to preferred technology, allowing you to make use of innovations from different suppliers.



Aesthetic design

The small, unobtrusive form factor can be mounted discreetly on luminaires.



Flexibility

The SR socket can be mounted on the top, or on top and bottom of the luminaire, giving you the flexibility to choose from all sources of sensor applications. The IP66 rating also ensures there is no risk of water ingress.



Open innovation platform

Using this new System ready architecture gives you access to new innovations that could enhance your lighting even further in the future.

Street lighting

TownTune

System ready
architecture

Ready to be connected to **Interact City**

Interact City lighting management software turns your street lighting into a connected network capable of hosting sensors and other IoT enabled devices. It enables you to tap into a wide range of both lighting and non-lighting benefits such as dimming, presence detection, noise or air quality monitoring, and incident detection.

Already today, by the simply twist of a controller Philips TownTune is ready to be connected to the Interact City lighting management software.



Get more value out of **your lighting infrastructure**

Control and monitor your street lighting remotely and immediately identify lighting failures using a single dashboard application. With full control of your city lighting you can identify opportunities for further energy savings by dimming, scheduling and zoning. Interact City enables you to reduce CO₂ emissions, meet sustainability targets and reduce costs, enabling you to reinvest the savings into other areas of your city's infrastructure.

The Open API's of the system also allow Interact City lighting management software to be integrated into your other city management systems and allows your existing partners or independent third parties to use it as a platform for future innovation

For more information about Interact City visit:
www.interact-lighting.com/city





Technical Components Design

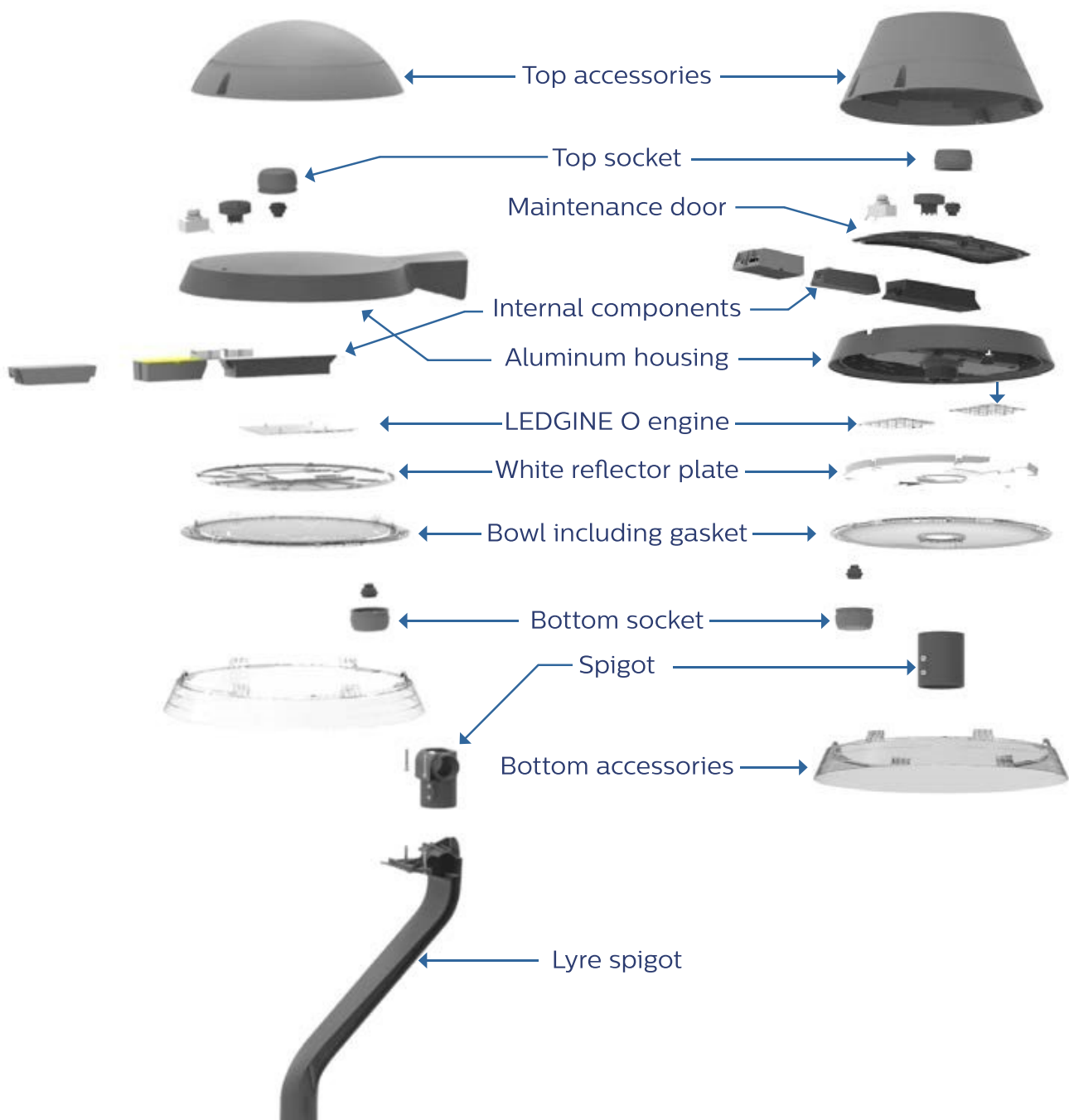

Dimensional drawings

BDP260 LD

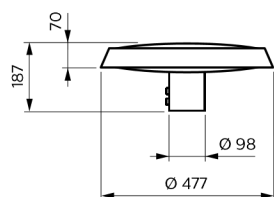

BDP261 DR-LD

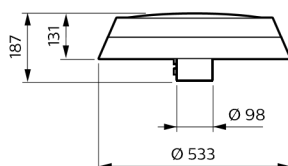

BDP262 DT-LD

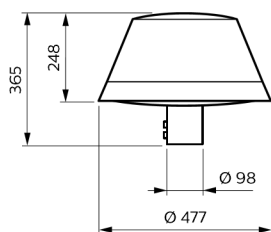

BDP262 DR DTC-LD

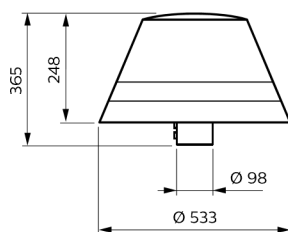

BDP263 DTD-LD

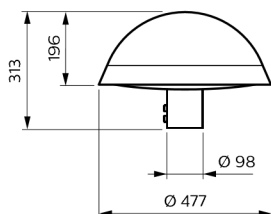

BDP263 DR DTD-LD

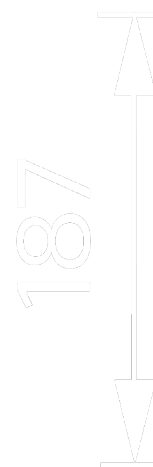
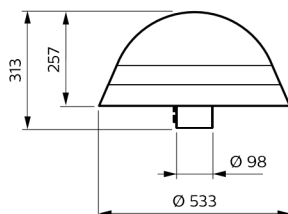

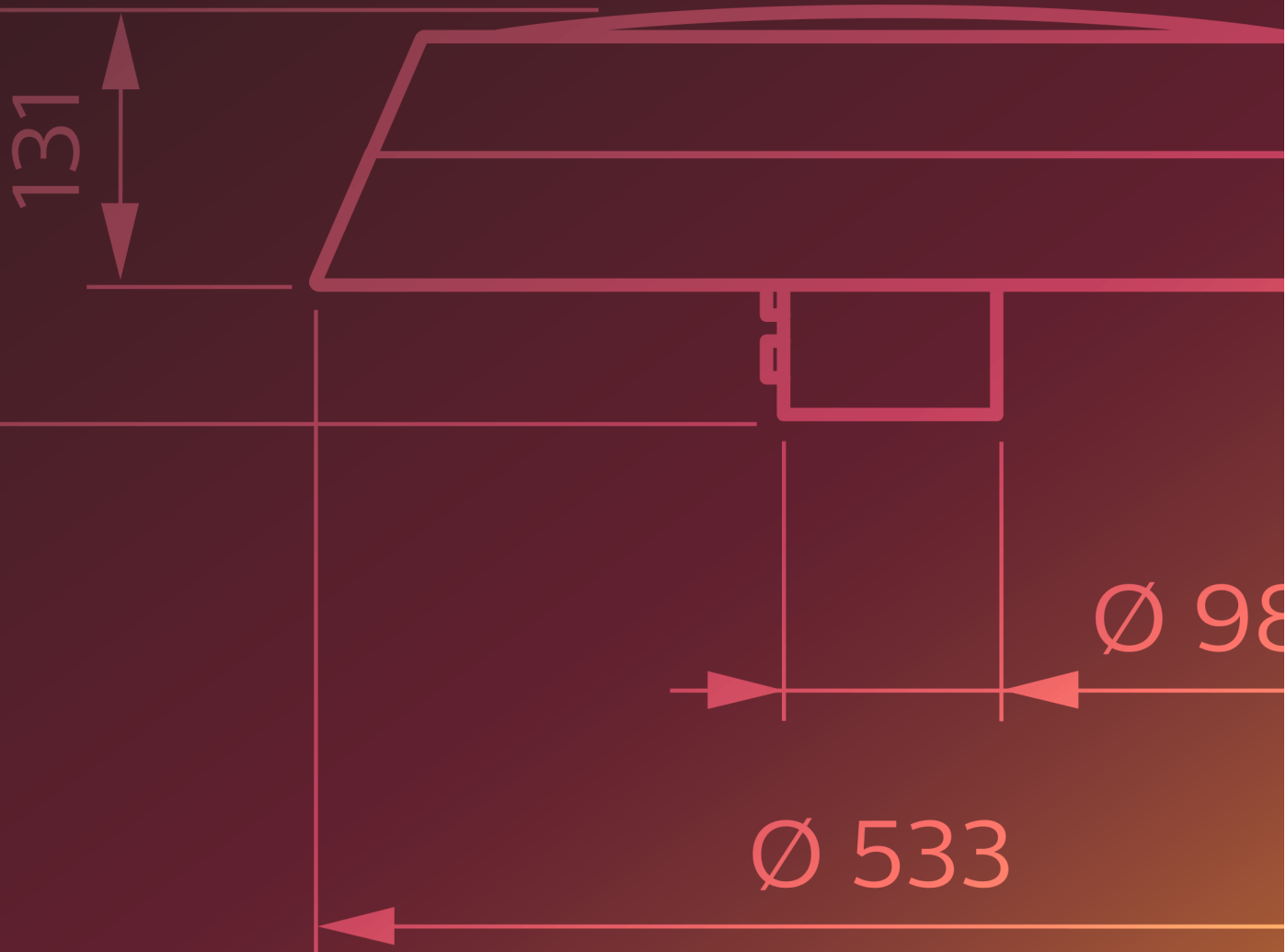

Dimensional drawings

BDP265-60

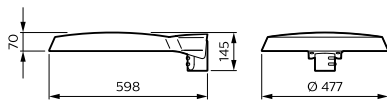

BDP265-76

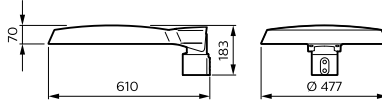

BDP270

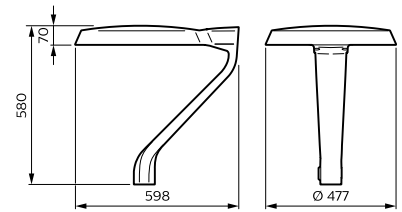

BDP266-60

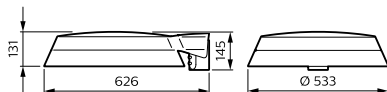

BDP266-76

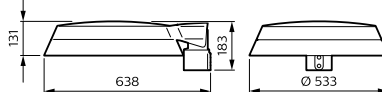

BDP267-60

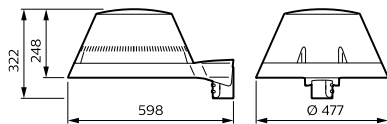

BDP267-76

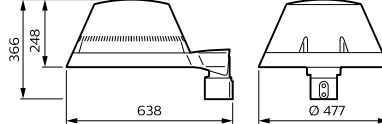

BDP272

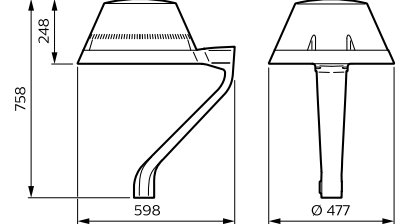

BDP267-60 + Ring

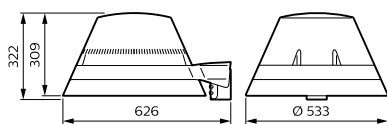

BDP267-76 + Ring

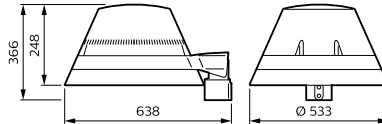

BDP268-60

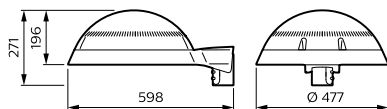

BDP268-76

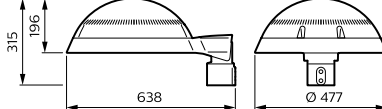

BDP273

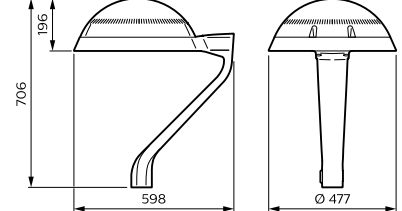

BDP268-60 + Ring

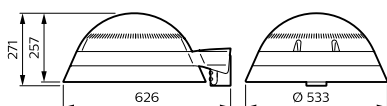

BDP268-76 + Ring

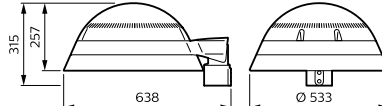

BDP271

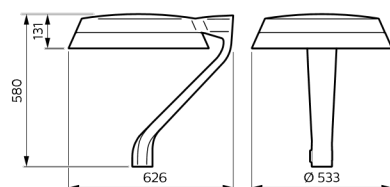

BDP272 + Ring

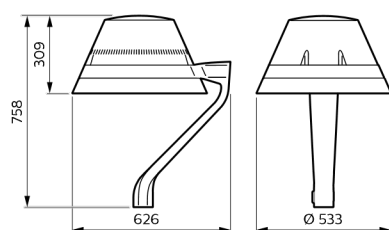

BDP273 + Ring

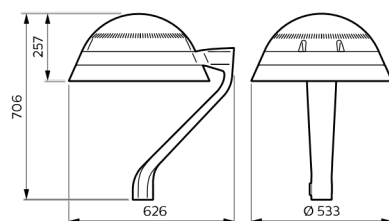

598

Specifications **Central Post-Top**

Product features		Specifications	
Type		BDP260, standard version BDP261, with decorative ring BDP262, with decorative top cone, and option decorative ring BDP263. with decorative top dome and option decorative ring	
Light source		Ledgine optimized Philips standarized LED-module	
System Power		Between 9,5 and 60W, depending on flux and color temperature	
Luminous flux	WW	LED12, 14, 16, 18, 20, 22, 24, 27, 30, 35, 39, 45, 50, 59, 64, 69, 74, 79	
(source flux) (x100 = Lm)	NW	LED14, 16, 18, 20, 22, 24, 27, 30, 35, 39, 45, 50, 59, 64, 69, 74, 79, 84, 90, 94, 100	
Luminaire efficacy	WW	Between 85 and 99 Lm/W, depending on flux	
(system flux)	NW	Between 104 and 123 Lm/W, depending on flux	
Optics		Philips standarized Ledgine optimized; Distribution Narrow: DN09/10/11/50 Distribution Medium: DM10/11/12/13/30/31/32/33/50 Distribution Wide: DW10/50/52, DX10/50/51 Distribution symmetrical: DS50	
Optical option		Back light control louver BL2 (not for DS50 or DX50/51)	
Controls system input		DALI	
Dimming		LineSwitch, DynaDimmer, LumiStep	
Group control		Coded mains	
Connectivity		Interact City LightWave for SR socket EasyAir wireless stand alone control module for SR socket Motion sensor for bottom SR socket	
Material		Spigot, housing & gear cover: high-pressure die-cast aluminium Bowl: Impact resistant UV stabilized clear (PCC) polycarbonate with internal parcial (dot pattern) texturing.	
Color		DGR (Philips dark grey)	
Color option		Selection of RAL colors on request	
Ingress protection		IP66	
Impact protection		IK10	
Weight		Approximately 7Kg without optional accessories	
Correlated color	WW	3000K	
temperature	NW	4000K	
Color rendering index	WW	80	
	NW	70	
Maintenance of Lumen	NW	Between L87 and L95, depending on flux	
output at 100,000 hours	WW	Between L87 and L95, depending on flux	
Operating temp. range		-40 up to +35 °C	
Driver		Integrated programmable LED driver	
Power/Data supply		Philips Xitanium Full prog, System Ready or Coded Mains	
Mains voltage		220-240V / 50-60 Hz	
Surge protection		6kV standard, option to add 10kV surge protection (SRG-10)	
Inrush current driver		40W: 22A / 290µs, 75W: 46A / 250µs	
Options		Constant Light output (CLO), also possible in combination with Dimming and connectivity options Electrical safety Class II StarSense RF 1.5 OLC Factory fitted cable, 4, 5, 6, 7 or 8 meter exterior length. Mini Photocell or Nema socket, photocell on SR socket 7-pin nema socket SR socket on top or top and bottom	
Maintenance		Driver: access by removing the top gear cover LED engine: maintenance in (local) workshop only	
Installation		Post-top mounting: Axial entry 62 or 76mm Connection: M20 gland with strain relief, cable Ø 6-12mm 2 x M8 mast fixation bolt Recommended mounting height: 4 to 6 meters Max. SCx: BDP260 (standard): 0,042 m² BDP261 (bottom ring): 0,066 m² BDP262 (top cone): 0,11 m² BDP262 (cone + ring): 0,13 m² BDP263 (top dome): 0,082 m² BDP263 (dome + ring): 0,11 m²	
Accessories		Spigot size reduction adapter from Ø 76mm to Ø 60mm Special adapter for pole-top Ø 90mm to fit luminaire with spigot Ø 62mm Bottom decorative ring, clear or golden Top accessory cone or dome	

Specifications **Asymmetric & Lyre version**

Product features		Specifications			
Type		BDP265, asymmetric standard version BDP266, asymmetric with decorative ring BDP267, asymmetric with decorative top cone, and option decorative ring BDP268, asymmetric with decorative top dome and option decorative ring BDP270, Lyre standard version BDP271, Lyre with decorative ring BDP272, Lyre with decorative top cone, and option decorative ring BDP273, Lyre with decorative top dome and option decorative ring			
Light source		Ledgine-O Philips standarized LED-module			
System Power		Between 5.5 and 83W, depending on flux and color temperature			
Luminous flux (source flux) (x100 = Lm)	WW	LED6, 8, 10, 12, 14, 16, 18, 20, 22, 24, 27, 30, 35, 39, 45, 50, 59, 64, 69, 74, 79, 84, 90, 94			
	NW	LED8, 12, 14, 16, 18, 20, 22, 24, 27, 30, 35, 39, 45, 50, 59, 64, 69, 74, 79, 84, 90, 94, 109, 120, 130			
Luminaire efficacy (system flux)	WW	Between 93 and 112 Lm/W, depending on flux			
	NW	Between 117 and 143 Lm/W, depending on flux			
Optics		Philips standarized Ledgine optimized; Distribution Narrow: DN09/10/11/50 Distribution Medium: DM10/11/12/13/30/31/32/33/50 Distribution Wide: DW10/50/52, DX10/50/51 Distribution symmetrical: DS50			
Optical option		Back light control louver BL1 and BL2 (not for DS50, DW52, DX50/51)			
Controls system input		DALI			
Dimming		LineSwitch, DynaDimmer, LumiStep			
Group control		Coded mains			
Connectivity		Interact City, LightWave for SR socket EasyAir wireless stand alone control module for SR socket Motion sensor for bottom SR socket			
Material		Spigot, housing & gear cover: high-pressure die-cast aluminium Bowl: Impact resistant UV stabilized clear (PCC) polycarbonate with internal parcial (dot pattern) texturing.			
Color		DGR (Philips dark grey)			
Color option		Selection of RAL colors on request			
Ingress protection		IP66			
Impact protection		IK09			
Weight		Asymmetric : approximately 7Kg, Lyre : approximately 8Kg, without optional accessories			
Correlated color temperature	WW	3000K			
	NW	4000K			
Color rendering index	WW	80			
	NW	70			
Maintenance of Lumen output at 100,000 hours	NW	Between L87 and L95, depending on flux			
	WW	Between L88 and L95, depending on flux			
Operating temp. range		-40 up to +35 °C			
Driver		Integrated programmable LED driver			
Power/Data supply		Philips Xitanium Full prog, System Ready or Coded Mains			
Mains voltage		220-240V / 50-60 Hz			
Surge protection		6kV standard, option to add 10kV surge protection (SRG-10)			
Inrush current driver		40W: 22A / 290µs, 75W: 46A / 250µs			
Options		Constant Light output (CLO), also possible in combination with Dimming and connectivity options Electrical safety Class II StarSense RF 1.5 OLC Factory fitted cable, 0.5, 1, 2, 4, 5, 6, 7, 8 and 10 meter exterior length For Lyre versions, cable length limited to 4, 5 and 6 meter Mini Photocell or Nema socket, photocell on SR socket 7-pin nema socket SR socket on top or top and bottom			
Maintenance		Driver & LED engine: maintenance in (local) workshop only			
Installation		Asymmetric versions: Post-top mounting diam 60/62 or 76mm. Side entry mounting diam 32-48mm, and 48/60mm Lyre versions: diam 60/62mm only Connection: M20 gland with strain relief, cable Ø 6-12mm 2 x M8 mast fixation bolt Recommended mounting height: Asymmetric versions: 4 to 8 meters Lyre versions: 4 to 6 meters Max. SCx: BDP265 (standard): 0,033 m² BDP266 (bottom ring): 0,036 m² BDP267 (top cone): 0,052 m² BDP267 (cone + ring): 0,071 m² BDP268 (top dome): 0,039 m² BDP268 (dome + ring): 0,057 m² BDP270 (standard): 0,089 m² BDP271 (bottom ring): 0,095 m² BDP272 (top cone): 0,121 m² BDP272 (cone + ring): 0,132 m² BDP273 (top dome): 0,095 m² BDP273 (dome + ring): 0,112 m²			
Accessories		Bottom decorative ring, clear or golden Top accessory cone or dome			



© 2018 Signify Holding. All rights reserved. The information provided herein is subject to change, without notice. Signify does not give any representation or warranty as to the accuracy or completeness of the information included herein and shall not be liable for any action in reliance thereon. The information presented in this document is not intended as any commercial offer and does not form part of any quotation or contract, unless otherwise agreed by Signify.

Philips and the Philips Shield Emblem are registered trademarks of Koninklijke Philips N.V. All other trademarks are owned by Signify Holding or their respective owners.

www.lighting.philips.com