



PHILIPS

Copenhagen gen2

Public Lighting

Timeless design
and future ready
technology



Global trends

We are increasingly urban and global
 Today 50% of the world's population lives in cities.
 This is expected to rise to 75% by 2050.

Environmental **awareness**
 Cities want to meet their sustainability goals and reduce
 light pollution and their impact on the environment.

Cities want to **establish identity**
 Municipalities want to enhance the quality of life, well
 being of citizens and create comfortable public spaces.

Growing connectivity
 There are new opportunities to improve urban life
 through intelligent lighting part of the IoT eco-system.

Contents

2	5
Global trends	Meet Copenhagen family
6	8
Explore the possibilities of Copenhagen family	Meet Copenhagen City LED gen2
10	12
Let your city shine with glow effect	Customize your city with dynamic uplight
14	16
Application areas	Copenhagen LED gen2
18	20
Application areas	LEDGINE optimized
22	23
Family range	Installation overview
24	25
Portfolio of optics	Configuration overview
28	32
Standard sets	Service tag for improved servicability
34	36
Designed for service ability	System ready architecture
37	38
Ready to be connected to Interact City	Specifications
39	
Dimensional drawings	



Copenhagen City LED gen2

Meet Copenhagen family

Copenhagen family was co-designed in cooperation with the Copenhagen's Office of City Architecture in the 1960s with the purpose of enhancing the aesthetic appeal of the city through lighting. Based on a discreet and timeless design Copenhagen comes in two types: Copenhagen City LED gen2 and Copenhagen LED gen2 to cover all needed applications. From motorways to footpaths, from city centers to parks, different areas of the city have unique lighting needs. Copenhagen can be effectively deployed in any environment and matched to its lighting needs. To meet the different mounting heights and offer harmonious propositions, we have added the mini and mega versions to the Copenhagen family.



Copenhagen LED gen2

Explore the possibilities of Copenhagen family

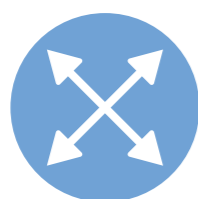

Wide application coverage

Thanks to the built in Philips LEDgine platform, and the wide range of available application-tailored optics, Copenhagen luminaire delivers the right amount of light and in the right direction on your street, enabling further energy savings.



High quality of light

Copenhagen luminaire delivers comfortable lighting without compromising on visibility and safety. It also offers a wide choice of color temperatures (2200, 2700, 3000 and 4000K) with a good to high color rendering.



Ready for connectivity

The luminaire comes with one or two Philips SR (System Ready) sockets, which make the luminaire future ready. What this means is that Copenhagen luminaire is ready to be paired with both standalone and advanced control and lighting software applications such as Interact City from Signify or sensors.

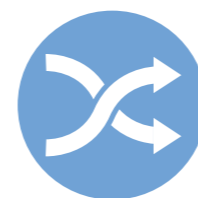

Improved maintenance

Each individual Copenhagen luminaire is uniquely identifiable, thanks to the Service tag application. By simply scanning a QR code you can gain instant access to the luminaire configuration and create your digital library of lighting assets and spare parts

Meet Copenhagen City LED gen2

Create the right atmosphere with light



- Public lighting
- Copenhagen City LED gen2
- Introduction**

The latest generation of the Copenhagen City LED gen2 offers fully balanced, comfortable lighting effects with minimum glare, enabled by a round LED engine, which follows the shape of the luminaire. The opal canopy option provides further possibilities to enhance the lighting impact and provides new options for city branding as it can be used to create both static (glow effect) and dynamic (RGBW) uplight. The luminaire comes with a variety of suspensions and optics, offering maximum freedom in designing lighting for city center and residential area applications.



Copenhagen City LED gen2
colored canopy

Available in:

- RAL 5017 Blue
- RAL 7035 Grey
- RAL 6009 Green
- RAL 8011 Brown
- RAL 9007 Dark alu

Other RAL colors available per request



Copenhagen City LED gen2
opal canopy

Let your city shine with **glow effect**

Lighting needs to do more than just delivering illumination during night time. Thanks to glow effect Copenhagen City LED gen2 offers guidance, comfort and creates a safe environment for every citizen. Glow effect highlights luminaire's elegant design and shape during night time.

The static glow effect is obtained thanks to spill light from the LED board canopy.

Customize your city with dynamic uplift

As the needs and roles of cities evolve, requirements towards lighting are also changing. Beyond illumination cities want to create their own signature, emphasizing on their unique character.



Thanks to dynamic RGBW you can remotely customize your city's lighting to any color of your choice via the dedicated app. Our dynamic RGBW Android app gives you the possibility to specify colors based on a calendar and assign your choices to selected group(s) of luminaires.

Whether you want to celebrate New Year's Eve, dress up for Halloween or raise awareness on a social issue we are here to help you light up your city for any occasion. Dynamic RGBW will not only create a unique atmosphere relevant to every event but it can also guide both citizens and tourists to the exact location.

Christmas



Halloween



Pink ribbon



Gay Pride



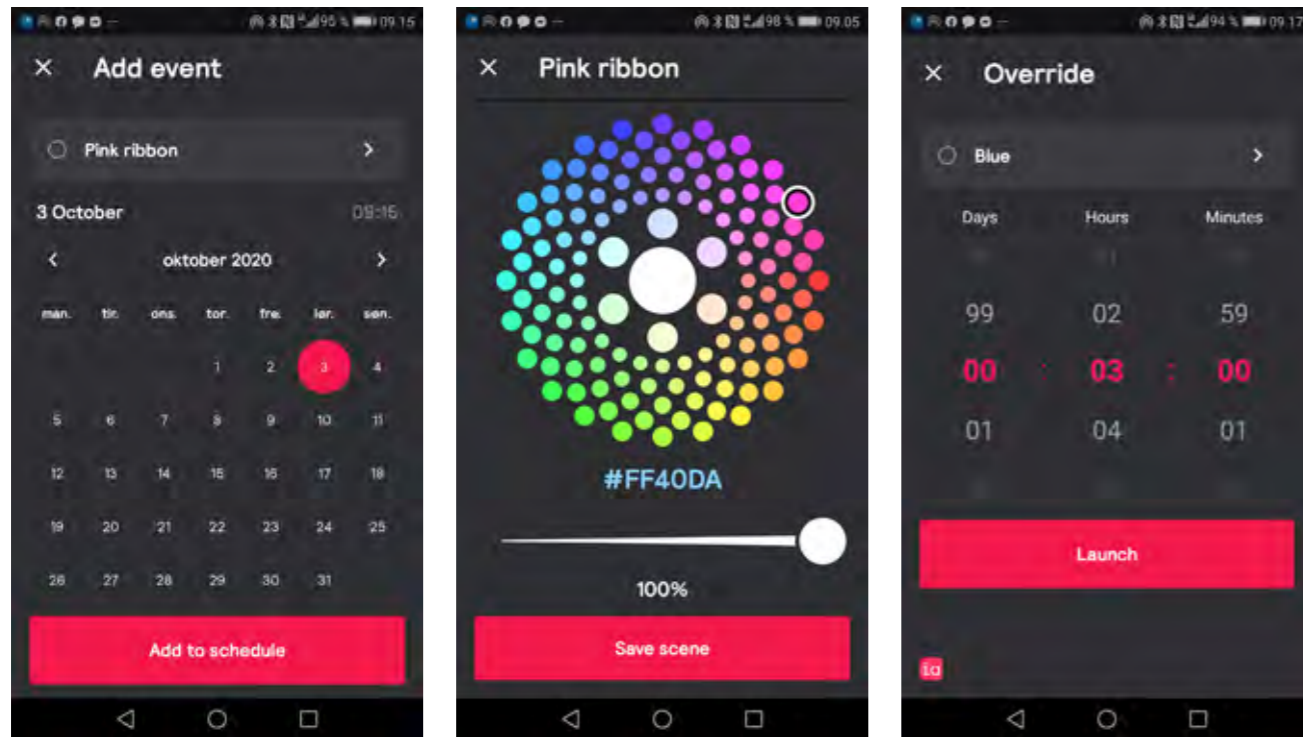

With our Dynamic RGBW Android App you can easily change color of you scenes and make changes to your calender function. You can also override events to adapt uplight to any desired color instantly. The Dynamic RGBW App helps you to fully adapt to any given occasion or unplanned event in only a few minutes.

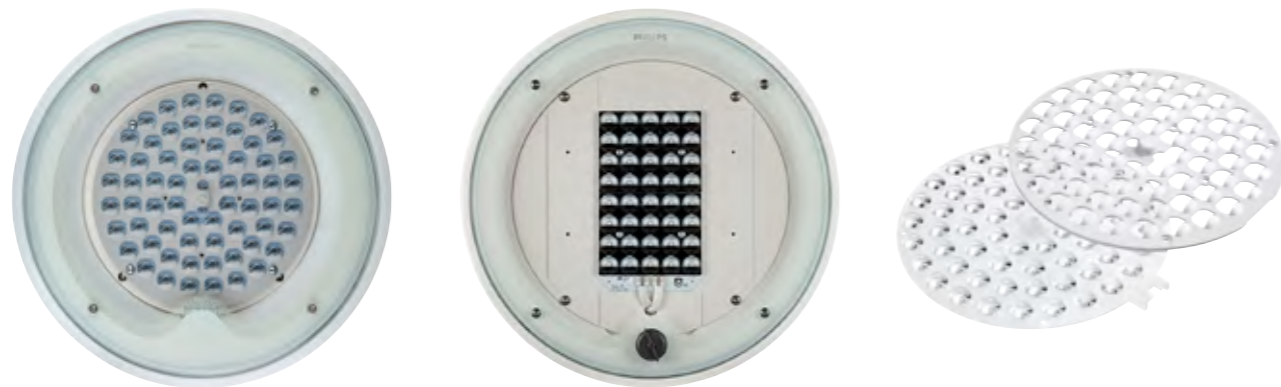

Back light covers are valued accessories in cities to prevent spill light from disturbing residents.

We offer different versions of back light covers to avoid glare or light spill and help to resolve complaints. Back light covers are available for both Copenhagen City and Copenhagen LED and fits discreetly behind the front glass of the luminaire.

Application areas

In the heart of the city

Designed around our LEDgine platform, Copenhagen City LED gen2 delivers outstanding levels of lighting and energy performance. Copenhagen City LED gen2 is part of our Urban Inspiration lighting portfolio with strong focus on the emotional values of lighting:

For every application in the city we do have several solutions to really inspire and enhance your city, while meeting your demands and beyond.

- create ambiance
- enhancing well-being
- promoting tourism and heritage
- increase the livability in the city

Public lighting

Copenhagen City LED gen2

Applications areas

City center

- Side street
- Square, park and playground
- Cycle path and footpath
- Shopping and pedestrian area

Residential area

- Residential street
- Cycle path and footpath
- Square, park and playground
- Parking area

Night life areas

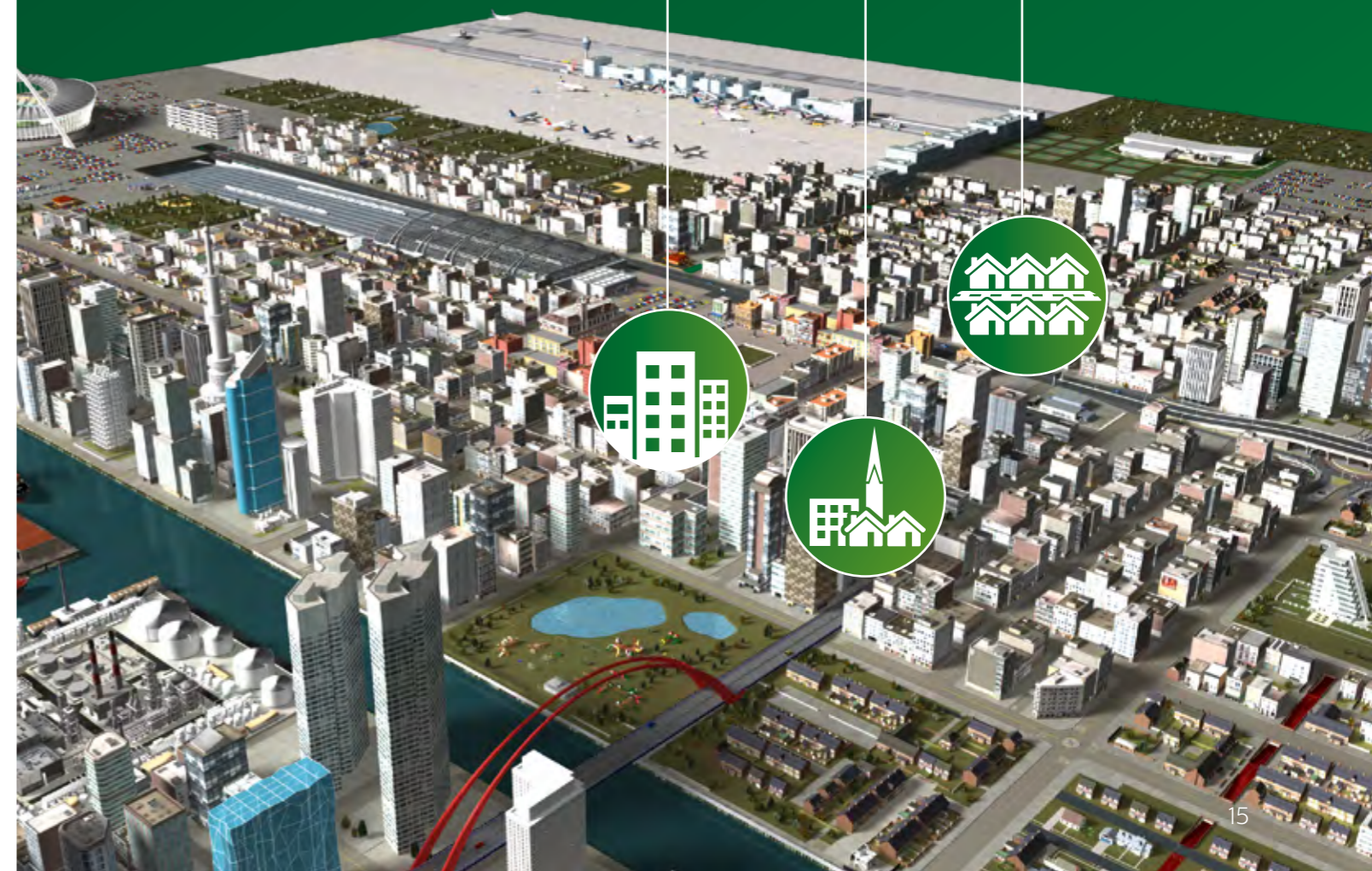

Copenhagen LED gen2

The right light for the right areas



The luminaire comes in 4 sizes to ensure that the dimensions of the luminaire and pole are well balanced, and that the installation blends harmoniously into its surroundings or lighting levels need. A variety of suspensions are available, enabling a variety of mounting options and providing maximum freedom during installation

Thanks to the built - in Philips LEDgine optimized LED platform, and the wide range of available application-tailored optics, Copenhagen LED gen2 delivers the right amount of light and in the right direction on your street, enabling further energy savings.



Copenhagen LED gen2 **mini**

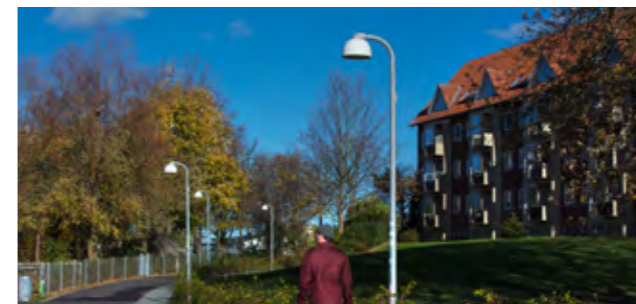

Copenhagen LED gen2 **small**



Copenhagen LED gen2 **large**



Copenhagen LED gen2 **mega**

Application areas

Different contexts need different light

From industrial areas to motorways to highways – different areas of the city have unique lighting needs. Copenhagen LED gen2 can be effectively deployed in any environment and match to its lighting needs.

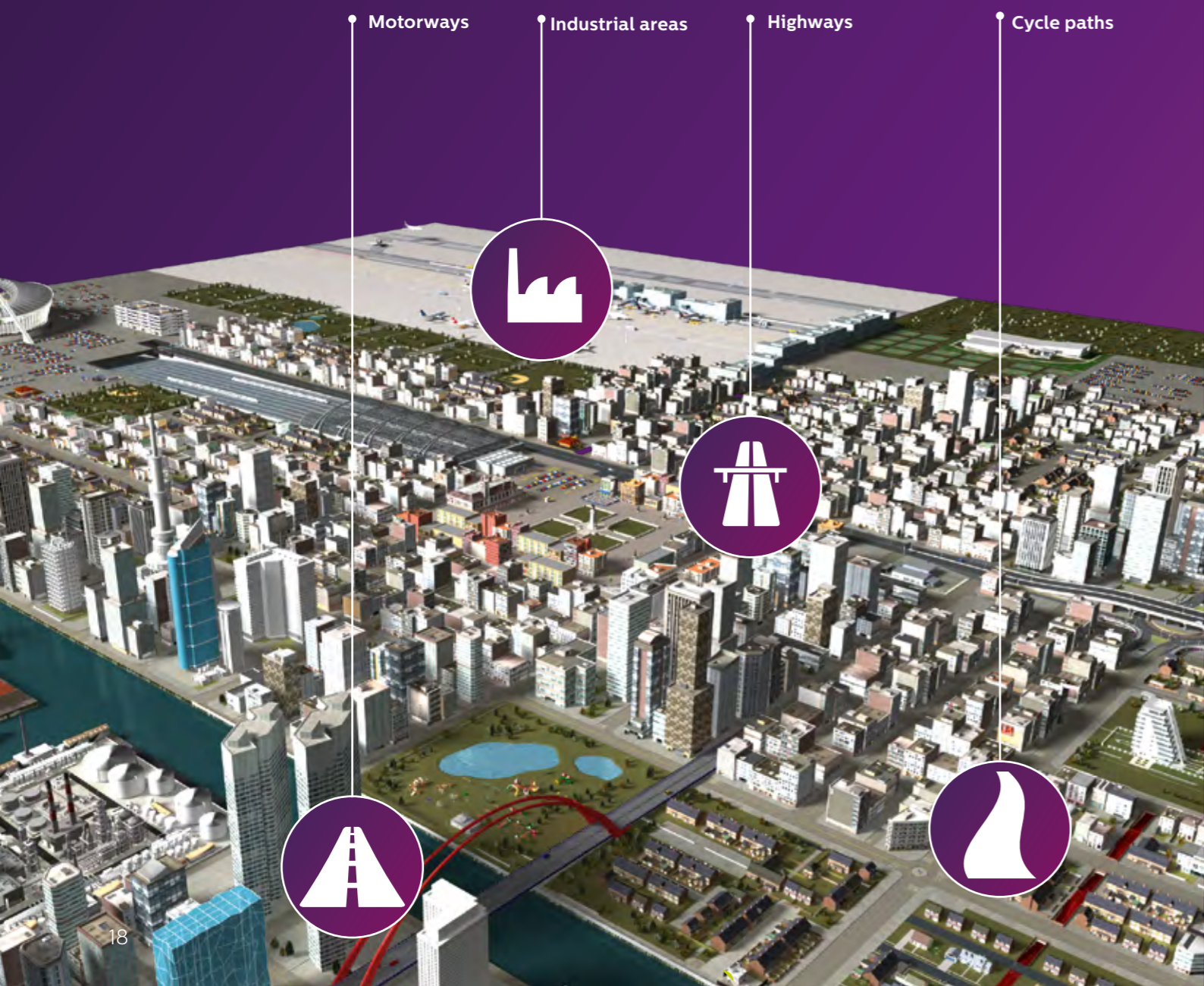



LEDGINE *optimized*

Thanks to the built in Philips LEDgine optimized LED platform, and the wide range of available application-tailored optics, Copenhagen LED gen2 delivers the right amount of light and in the right direction on your street, enabling further energy savings.



Complete new optics range ensures a perfect fit for every application. The optics offer flexibility, enabling standardization over applications with outstanding performance across a wide range of geometries – as well as design parameters such as tilt and overhang. They are easy to use and distribution remains the same, so even after a LED upgrade you are assured of design continuity. The optics comply with national and European road lighting standards.



Using a standard engine across key portfolio means you can benefit from the latest LED upgrades to various products without changing light distributions. The flux packages are pre-defined across product ranges, including CLO options. Flux minimization is achieved by using the highest flux package (up to L96B10) per standard. And for upgrades, the lighting image is continued and the engine is available for your installed base. Easy configuration is assured thanks to the Service tag.



For tuned project solutions, we can support you with the exclusive L-Tune tool. It enables you to build the required flux to ensure the best balance between operational life, maintained flux, energy costs and product type. You can create your own standard by matching requirements to your own policy. For serviceability, the L-Tune program codes are linked to the Service tag.

Family range

From busy traffic roads up to the city center, for renovation and new luminaires, the Copenhagen LED gen 2 & Copenhagen City LED gen 2 family are the perfect solution. Due to the different mounting possibilities and four different sizes, installations varying from 3 up to 12 meters will not be any issue.

Copenhagen City LED gen2



Mega



Large



Small

Copenhagen LED gen2



Mega



Large



Small



Mini



Backlight cover

Installation overview

Copenhagen City LED gen2



	Side entry	Wire suspended	Pendant
Small	BRS761	BSS761	BDS761
Large	BRS762	BSS762	BDS762
Mega	BRS763	BSS763	BDS763

*wire suspension kit is ordered separately.
 Single wire -240 (919008612531).
 Double wire -241 (919008609921)

Copenhagen LED gen2



	Post-top	Side entry	Wire suspended	Pendant
Mini	BPS559			BDS559
Small		BRS561	BSS561	BDS561
Large		BRS562	BSS562	BDS562
Mega		BRS563	BSS563	BDS563

*wire suspension kit is ordered separately.
 Single wire -240 (919008612531).
 Double wire -241 (919008609921)

Portfolio of optics

Copenhagen LED gen2

LEDGINE O optics for Road & Residential streets

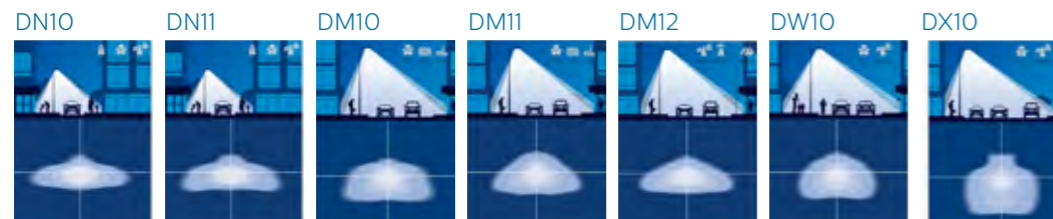

LEDGINE O optics for Residential streets, roundabouts and open areas



LEDGINE O optics for dedicated application areas (pedestrian crossings, optics with back light cover, ect.)

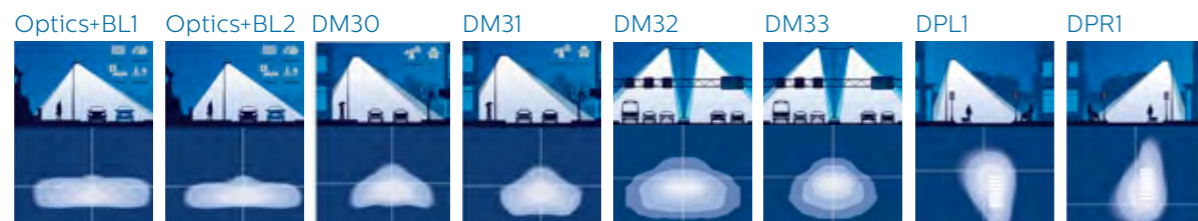

LEDGINE O optics for Copenhagen LED gen2 Mega catanery version



Copenhagen City LED gen2

LEDGINE optics for Road & Street



LEDGINE optics for Residential streets:

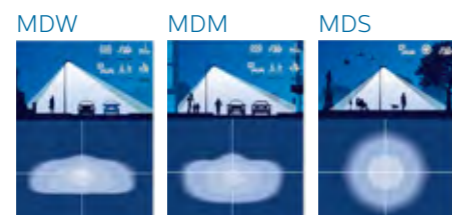

LEDGINE optic for dedicated application areas



Configuration overview

Stand alone

LEDGINE Round or Square
Easily replaceable LED unit
Glow effect (optional)



System Ready

LEDGINE Round or Square
Easily replaceable LED unit
Glow effect (optional)
2 x SR-connector:
Top: inside mounted
Bottom: mounted in front glass



Connected

LEDGINE Round or Square
Easily replaceable LED unit
Glow effect (optional)
Interact City integrated



Dynamic*

LEDGINE Round or Square
Easily replaceable LED unit
CityTouch integrated (optional)
Wireless controlled dynamic RGBW uplight



Copenhagen Mini (BPS559) is the newest member of the family. Copenhagen Mini has a pre-installed arm for Ø60 mm post-top mounting.



Standard sets

Public lighting

 Copenhagen
 gen2 family

Standard sets

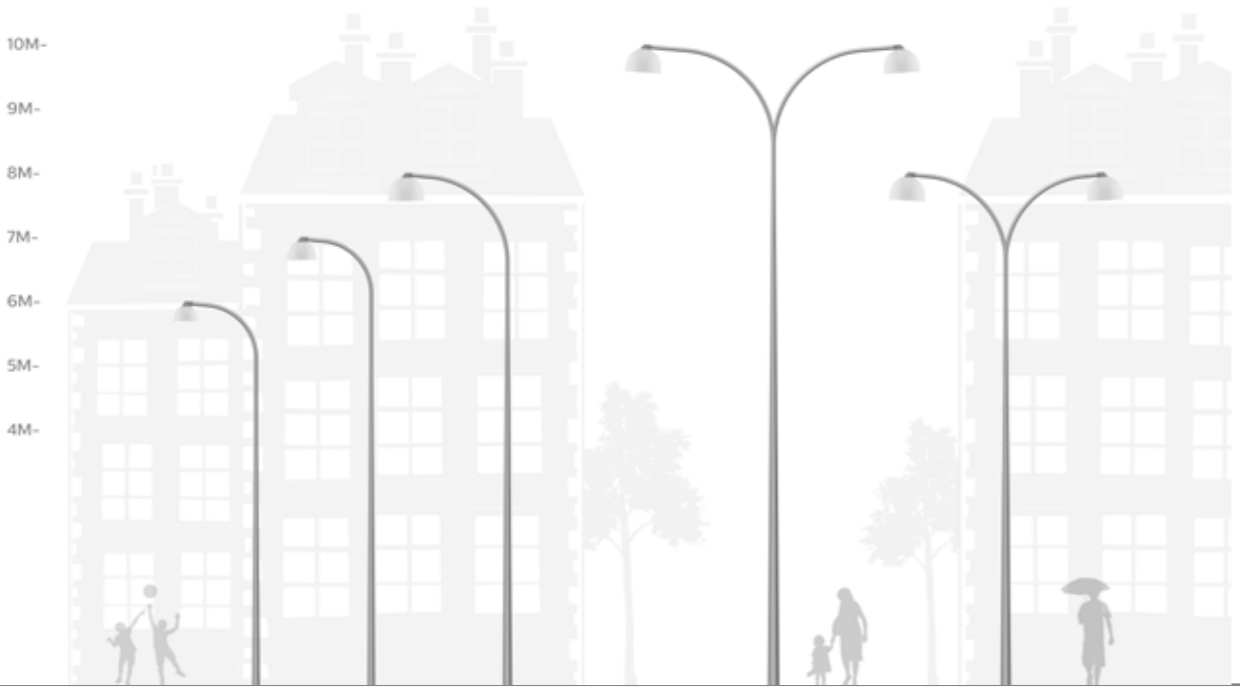



Designed for serviceability

Step 1



Step 2



Step 3



Step 4



Easy replacement of LED unit via quick connector.

Step 5



LED board and driver are easily replaceable.



Service tag for improved servicability

Since LED luminaires require different competencies and processes serviceability is always on our mind when designing new products. Copenhagen gen2 family is easily serviceable thanks to our Service tag system. Service tag is a unique QR-based identification system which can be found in individual luminaires and their packaging. Service tag provides 24/7 access to luminaires and spare parts information while it allows on the spot driver reprogramming. Thanks to Service tag maintenance could be easier.

NEW Late Stage Configuration delivers a flexible on-demand configuration and installation to Philips professional outdoor luminaires in Europe.

Why Service tag?



Simplifies installation and servicing full documentation and data at hand



Register your luminaire with your smartphone



All data is stored in the cloud and actively maintained, always up to date



Provides 24/7 access to luminaire and spare parts information



Facilitates spare parts and allows re-programming of drivers on the spot



Instant access to procedures, spare part list and programming

This tag features a QR-based identification system that gives you instant access to critical information during unpacking, installation, diagnostics, fault reporting and programming. Simply scan the tag with a smartphone or tablet running the Service tag app, and the contents of the box plus installation information are described. The tag also activates the five-year warranty. To assist in diagnosing breakdowns, scanning the tag provides the troubleshooting guide applicable to that luminaire. Sourcing spare parts and 'one touch' programming of parts to original settings can also be done using the app. It's that simple.

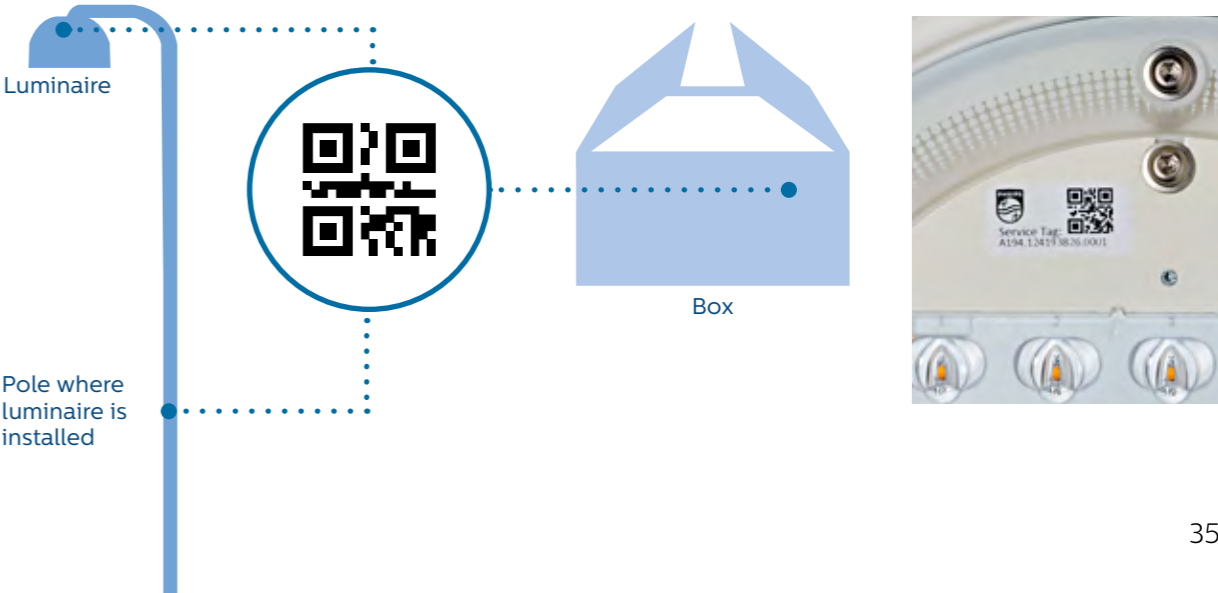

System ready architecture

The digital and smart city era is accelerating fast. To keep pace, cities need luminaires that are not only designed for today's technologies, but are prepared for future advances and upgrades. The System ready architecture gives you a scalable foundation that you can build on whenever your city is ready to opt into new advances in technology. So you can take light beyond illumination into a dynamic world of sensor-rich lighting - whenever you're ready.

Upgrade now or later

Copenhagen LED gen2 is a System ready luminaire, coming with universal sockets on each luminaire, so all you have to do is click in controllers or sensors to activate new applications. That means you can install your luminaires today and mount controllers and sensors at a later date - without any hassle.



Future-proof upgrades

System ready luminaires can be paired with sensors and controllers now or later. A city solution that is completely flexible and scalable.



Plug and play

Designed for hassle-free installation, controllers and sensors can be mounted without opening the luminaire on the bottom SR connector.



Standardized technology

Thanks to Zhaga standardization and the SR certified program, you will have access to preferred technology, allowing you to make use of innovations from different suppliers.



Aesthetic design

The small, unobtrusive form factor can be mounted discreetly on luminaires. The top connector is located inside the canopy so the controller is not visible and does not affect the aesthetic of the luminaire.



Flexibility

The SR socket can be mounted on the top, or on top and bottom of the luminaire, giving you the flexibility to choose from all sources of sensor applications. The IP66 rating also ensures there is no risk of water ingress.



Open innovation platform

Using this new System ready architecture gives you access to new innovations that could enhance your lighting even further in the future.

An open platform

Our System ready luminaires use state-of-the-art architectures and components. Because they are SR certified, they are compatible with all components released in our SR program. This ensures you'll always be ready for the latest innovations that will enable you to get more out of your lighting infrastructure.

Ready to be connected to Interact City

Interact City lighting management software turns your street lighting into a connected network capable of hosting sensors and other IoT enabled devices. It enables you to tap into a wide range of both lighting and non-lighting benefits such as dimming or incident detection.

Copenhagen gen2 family is ready to connect with Interact City when you are. The node is then integrated into the canopy and therefore does not affect the aesthetic of the luminaire.

For more information about Interact City visit: www.interact-lighting.com/city

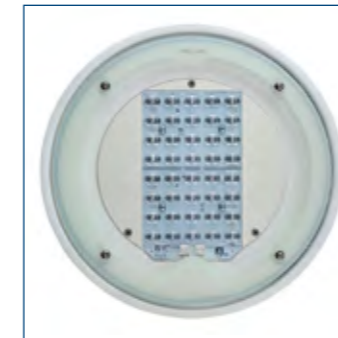

Public lighting
.....
Copenhagen
gen2 family
.....
Connectivity
.....

Get more value out of your lighting infrastructure

Control and monitor your street lighting remotely and immediately identify lighting failures using a single dashboard application. With full control of your city lighting you can identify opportunities for further energy savings by dimming, scheduling and zoning. Interact City enables you to reduce CO₂ emissions, meet sustainability targets and reduce costs, enabling you to reinvest the savings into other areas of your city's infrastructure.

The Open API's of the system also allow Interact City lighting management software to be integrated into your other city management systems and allows your existing partners or independent third parties to use it as a platform for future innovation



Specifications

Copenhagen City LED gen2	Copenhagen City LED gen2 small (Bx761)	Copenhagen City LED gen2 large (Bx5762)	Copenhagen City LED gen2 mega (Bx763)
Material	Housing: PE; rotational moulded		
	Front glass: Tempered glass silk screen printed		
Color	Opal white with glow effect or light-tight RAL colors on request		
Marine Salt Protection (MSP)	Yes		
Source flux	2000 lm to 10000 lm	4000 lm to 14000 lm	8000 lm to 14000 lm
Power consumption	13W to 83W	28W to 122W	47W to 122W
Color temperature	2200, 2700, 3000K or 4000K		
Color Rendering Index (CRI)	>80 (3000K), >70 (2200, 2700, 3000 and 4000K)		
IK- / IP-rating	IK08 / IP66	IK07 / IP66 (IK08 on option)	IK08 / IP66
Isolation class	Class I or II		
Surge protection	6 kV (10 kV on request)		
Life time – LED	100.000 h (L87 to L96B10)		
Life time - driver	100.000 h (0,5% failure / 5.000h)		
Weight	6 kg	8 kg	12 - 13,5 kg
Wind area (Scx)	Small = 0,08m ²	Large = 0,12m ²	Mega = 0,18m ²
CLO	Yes		
System Ready (SR)	Yes		
Control options	CityTouch Connect, DALI, Line Switch, DynaDimmer or LumiStep Wireless Dynamic RGBW uplight		
Comfort accessories	Back light cover Satin diffuser		
Certification:	CE / ENEC+		

Copenhagen LED gen2	Copenhagen LED gen2 mini (Bx559)	Copenhagen LED gen2 small (Bx561)	Copenhagen LED gen2 large (Bx562)	Copenhagen LED gen2 mega (Bx563)
Material	Housing: PE; rotational moulded			
	Front glass: Tempered glass silk screen printed			
Color	Opal white with glow effect or light-tight RAL colors on request (luminaire). Standard silver/sable, close to RAL9006. Other RAL colors are available upon request (bracket).			
Marine Salt Protection (MSP)	Yes			
Source flux	600 lm to 3500 lm	2100 lm to 12000 lm	4000 lm to 20000 lm	7500 lm to 35000 lm
Power consumption	6W to 30W	15W to 84W	28W to 142W	54W to 250W
Color temperature	2200, 2700, 3000K or 4000K			
Color Rendering Index (CRI)	>80 (3000K), >70 (2200, 2700, 3000 and 4000K)			
IK- / IP-rating	IK08 / IP66		IK07 / IP66 (IK08 on option)	IK08 / IP66
Isolation class	Class II	Class I or II		
Surge protection	6 kV (10 kV on request)			
Life time – LED	100.000 h (L86 to L96B10)			
Life time - driver	100.000 h (0,5% failure / 5.000h)			
Weight	3 kg	6 kg	8 kg	12 - 13,5 kg
Wind area (Scx)	Mini = 0,04m ²	Small = 0,08m ²	Large = 0,12m ²	Mega = 0,18m ²
CLO	Yes			
System Ready (SR)	Yes			
Control options	CityTouch Connect, DALI, Line Switch, DynaDimmer or LumiStep Wireless Dynamic RGBW uplight			
Comfort accessories	Back light cover Satin diffuser			
Certification:	CE / ENEC+			

Dimensional drawings

Public lighting
Copenhagen gen2 family
Specifications

Copenhagen LED gen2 mini

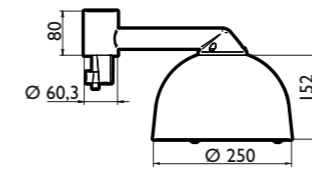

Post-top - BPS559

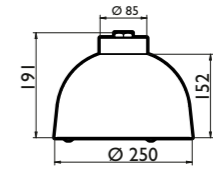

Center 1/2" thread - BDS559

Copenhagen (City) LED gen2 small

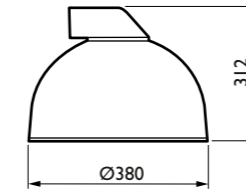
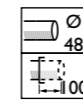

Side entry 48 - BRS561

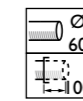

Side entry 60 - BRS561

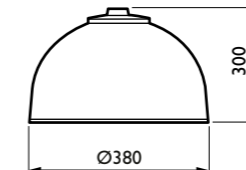

Center 3/4" thread - BDS561

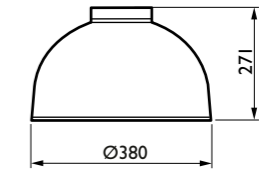

Suspended / wire - BSS561

Copenhagen (City) LED gen2 large

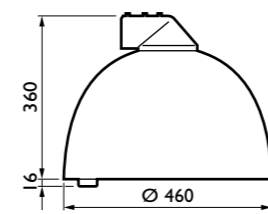
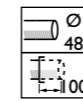

Side entry 48 - BRS562

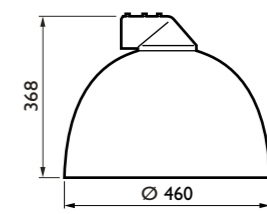
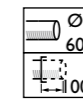

Side entry 60 - BRS562

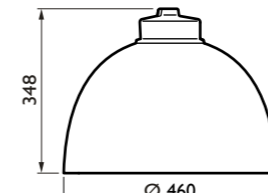

Center 3/4" thread - BDS562

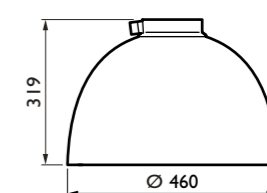

Suspended / wire - BSS562

Copenhagen (City) LED gen2 mega

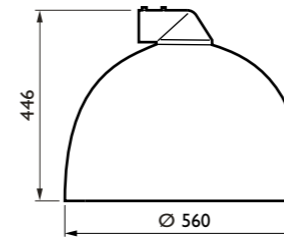
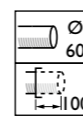

Side entry 60 - BRS563

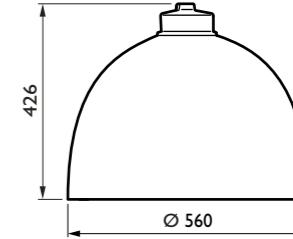

Center 3/4" thread - BDS563

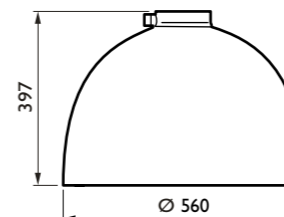

Suspended / wire - BSS563



© 2020 Signify Holding. All rights reserved. The information provided herein is subject to change, without notice. Signify does not give any representation or warranty as to the accuracy or completeness of the information included herein and shall not be liable for any action in reliance thereon. The information presented in this document is not intended as any commercial offer and does not form part of any quotation or contract, unless otherwise agreed by Signify.

Philips and the Philips Shield Emblem are registered trademarks of Koninklijke Philips N.V. All other trademarks are owned by Signify Holding or their respective owners.