

NatureConnect

by  Signify



NatureConnect mini island

NatureConnect mini island replicates a view of the sky. It consists of a “Sky & Sun” part that creates the decorative function of an artificial skylight and a “Daylight” part that creates the functional light. In combination with the NatureConnect link it mimics daylight by simulating the sun’s daily patterns, using light recipes that boost energy levels and help indoor spaces feel in sync with nature.

General Information

Light source	LED modules
Initial luminous flux	15300 lm
Efficacy	102 lm/W
Driver included	Yes
Driver/power unit/transformer	PSD (Power supply unit with DALI interface)
Maximum electrical power	150 W
Luminaire beam angle	100 °
Lifetime	50 khrs B50L90 100 khrs B50L80
Control interface	DALI
Connector	GST18i5 male
Protection class IEC	Safety class I
Ambient temperature range	+10 to +35 °C
Performance ambient temp. T _q	25 °C
Storage temperature	-40 to +60 °C
Ingress protection code	IP44 (bottom), IP20 (top)
Mech. impact protection code	IK02
Glow-wire test	650 °C
CE mark	Yes
ENEC mark	Yes
Warranty period	5 years

Operating and Electrical

Input voltage	220-240 V
Input frequency	50 to 60 Hz
Input current	0.7 A
Inrush current	50 A
Inrush time	330 us
Products per MCB (type C 16A)	10
Power factor (min)	0.9
Surge Protection	1 kV DM and 2 kV CM

Controls and User Interface

Lighting control	Compatible with NatureConnect link
Number of DALI addresses	6

Mechanical and Housing

Dimensions (LxWxH)	1195 x 1195 x 150 mm
Housing material	Steel
Housing color	White RAL9003 or Dark grey RAL7043
Optical cover/lens type	Polystyrene and Polycarbonate
Optical cover/lens finish	Opal
Net weight product	30 kg
Suspension accessories	4 pcs (cable lenght 5 m)

NatureConnect mini island

	Sky and Sun	Daylight
Light source colour	Tunable white&blue	Tunable white
Light output	4500 lm	10800 lm
Efficacy	80 lm/W	115 lm/W
UGR	n.a.	19
CCT	2700 K to Blue	2700 K to 6500 K
MDER*	up to 6.5	up to 0.9
Colour point SDCM	3	3
CRI	90	90
R9	> 50	> 50

MDER – melanopic daylight efficacy ratio is the spectrum of light determined by the ratio between MEDI – melanopic equivalent daylight illuminance (lux) and intensity (lux). This parameter indicates how efficient the luminaire is in achieving the health and wellbeing effect of daylight.

Product Data

910505103473	LP911P NC2 SKYLIGHT A W120L120 WHT
910505103544	LP911P NC2 SKYLIGHT A W120L120 GRY

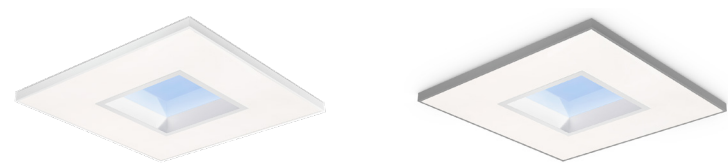

Dimensional drawing

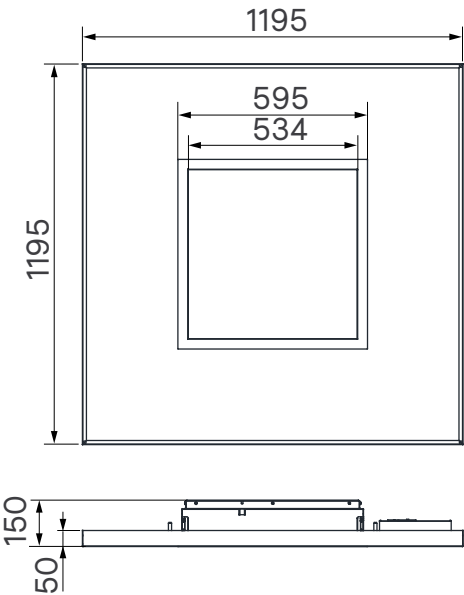

Specified data are valid for luminaire set at maximum power

© 2025 Signify Holding.
All rights reserved. The information provided herein is subject to change, without notice. Signify does not give any representation or warranty as to the accuracy or completeness of the information included herein and shall not be liable for any action in reliance thereon. The information presented in this document is not intended as any commercial offer and does not form part of any quotation or contract, unless otherwise agreed by Signify. All trademarks are owned by Signify Holding or their respective owners.