

LIGHTOLIER

by @signify

Track Lighting

Basic Track Heads

9021 Mini Universal

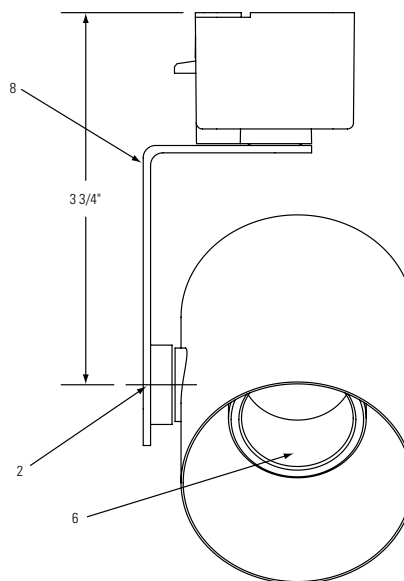
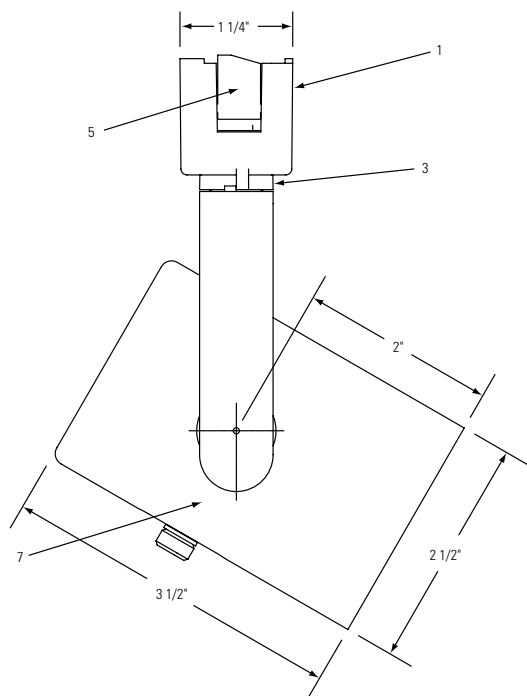

Project: _____
Location: _____
Cat.No: _____
Type: _____
Lamps: _____ Qty: _____
Notes: _____

Ordering Information

| Catalog No. | Finishes | Mounting | Lamps |
|----------------------------|---|----------------|---|
| 9021WH 9021BK 9021AL | Matte White Matte Black Metallic Aluminum | Lytespan Track | PAR16, R20, PAR20, PAR 30 and PAR38 from 30W to 250W |

Features

- 1. Lytespan Attachment Fitting:** Molded polycarbonate. Integral color. Adapter twists onto track, locks on.
- 2. Trunion Mounting:** Tensioned with internal spring washer and vibration resistant nut. Adjusts vertically 90°.
- 3. Pivot mounting:** Tensioned; adjusts horizontally 350° stop.

- 4. Movable Brass Contact:** Extends for connection to 2nd circuit in Advent Lytespan Track
- 5. Push Tab:** Molded Polycarbonate. Detaches unit.
- 6. Porcelain Socket**
- 7. Housing:** .040" aluminum
- 8. Yoke:** 1/8" Steel Yoke
- 9. Socket:** Sliding socket accommodates a variety of lamps and sockets

Electrical

Porcelain socket, medium base, nickel plated screw shell. No 18 braided SF-1 leads.

Finish

All painted finishes are baked enamel.

Labels

UL, cUL

Light to go

Compatible
configurations

Luminaire

9021WH

every
job matters

@signify