

PHILIPS

Maxos LED
General Lighting

4MX900I

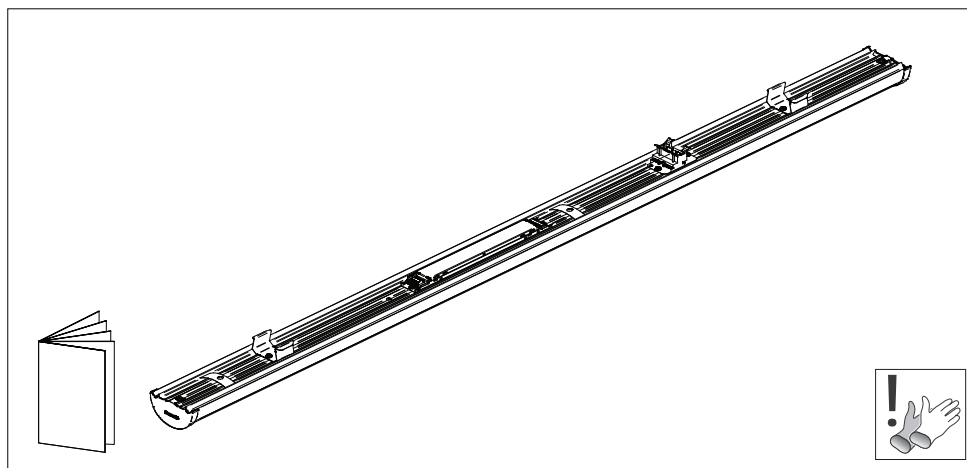

	Lum. pack	CCT			
4MX900	L1200 LED40S / LED60S	830 / 840	2.4		
	L1800 LED60S / LED90S	830 / 840	3.3		
	491 LED40S / LED50S / LED75S	830 / 840	2.8		
	581 LED40S / LED50S / LED75S	830 / 840	2.9		
4MX916/933	L1800 LED60S / LED90S	830 / 840	3.3		
	491 LED40S / LED50S / LED75S	830 / 840	2.8		
	581 LED40S / LED50S / LED75S	830 / 840	2.9		

	Type	L (mm)	A [mm]
	L1200	1200	120
	491	1479	120
	581	1530	120
	L1800	1800	50

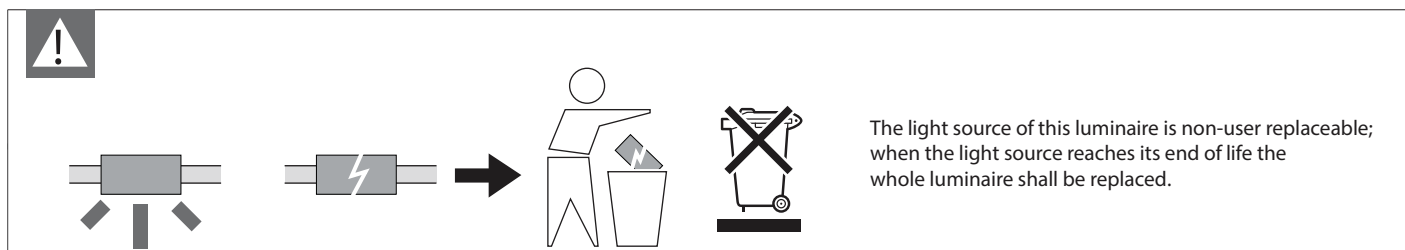

Given the choices made in this unique lighting concept, there are a few instructions regarding the maintenance.

- Prevent water from entering on or in the luminaire at installation and during use of the luminaire
- During installation or maintaining the luminaire please use gloves to avoid spots on the cover.
- Do not clean with a dry cloth as it will cause the product to attract dust. Dirty spots can be removed:
Only dust: use a damp cloth (no dripping water), preferably anti-static.
Fingerprints etc: use a damp cloth (no dripping water) with a cleaner appropriate for polycarbonate/PMMA plastics
- Do not touch electronic components as they are ESD sensitive.
- Do not stare into LED beam.
- Luminaire should not be used for illumination during building activities.
due to dust accumulation inside the luminaire.





Way of retrofit

Reflectors and optics



Check suspension distances. See pag. 4

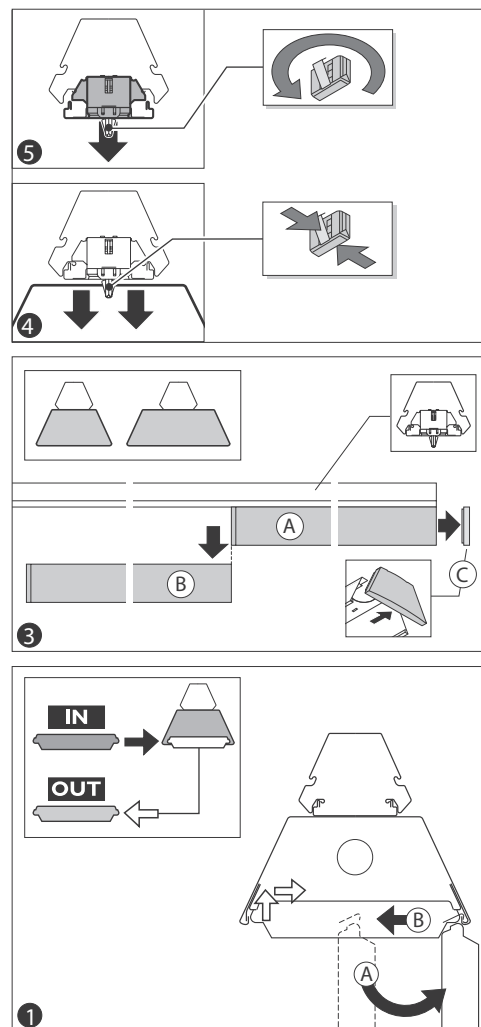
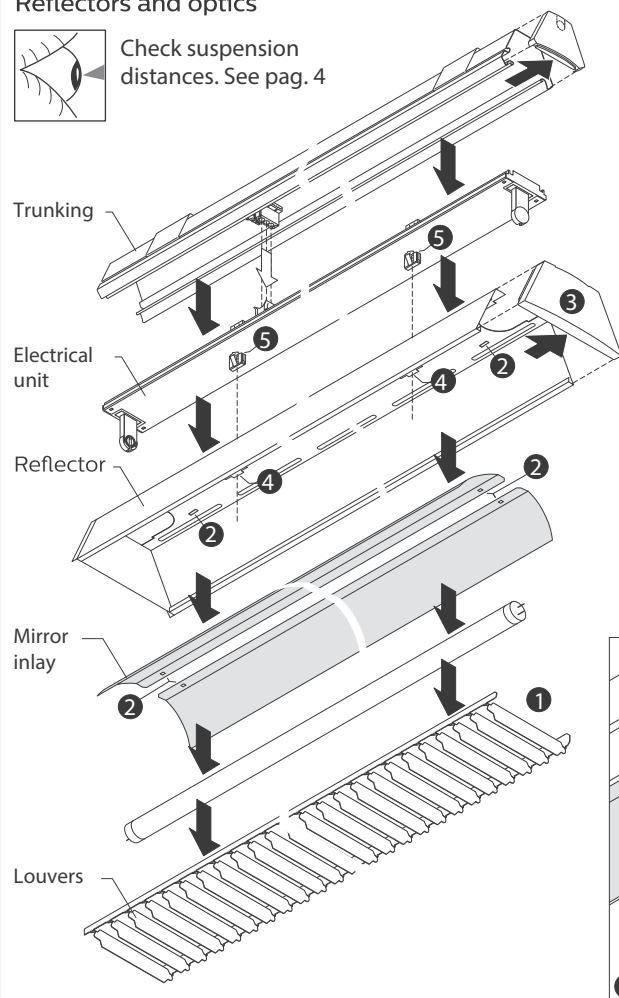

Reflectors and optics

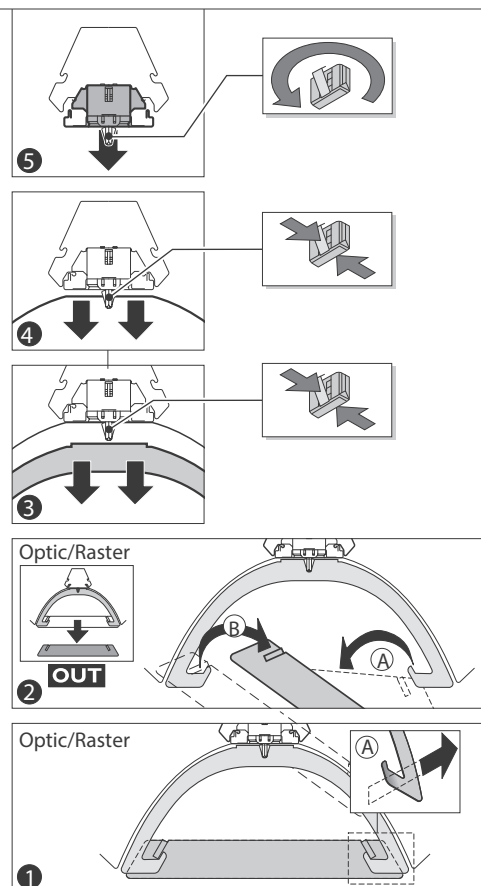
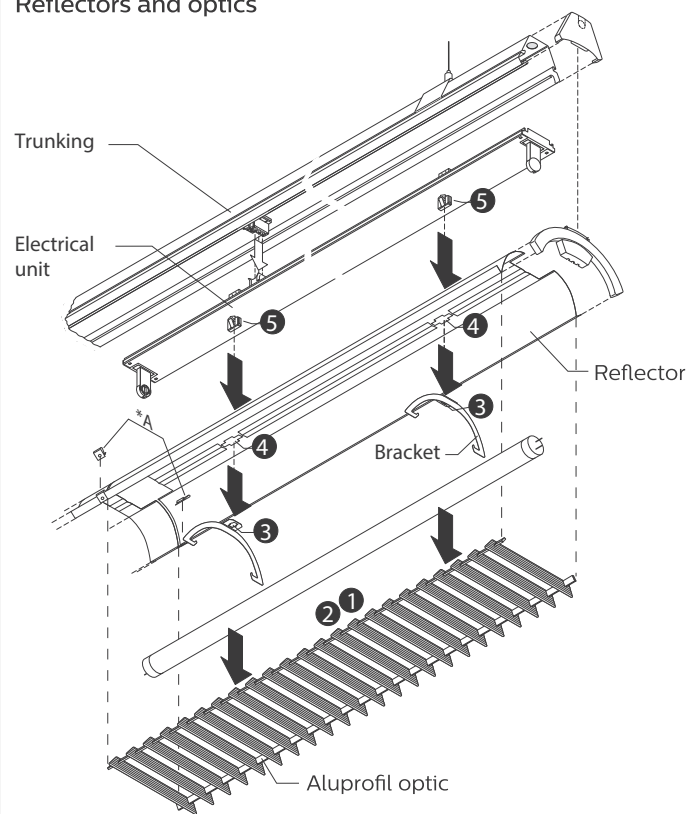



For all optics except A30

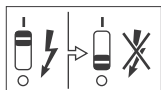

max. 30 kg

Trunking:
4MX856(1200/1800/3600)/
4MX056(TLD)/4MX656(TL5)



L (mm)	
1200	2x
1479	
1530	
1800	3x

2x  

max. 30 kg

Start

Maxos LED Performer 4MX900

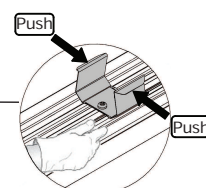

ATTENTION!



Service

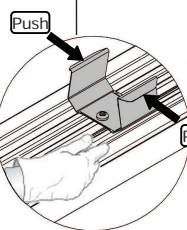

Service

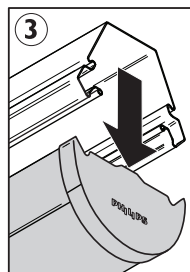
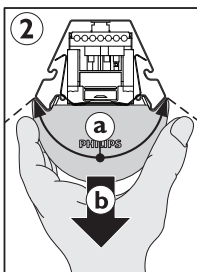
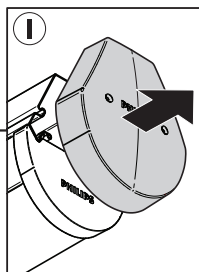
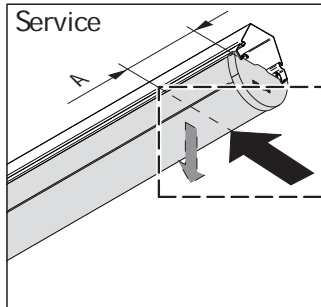

Type	L (mm)	A [mm]
L1200	1200	120
491	1479	120
581	1530	120
L1800	1800	50

Luminaire-Trunking compatibility:

Luminaire	Trunking
L1200	4MX856 (1200/1800/3600)
491	4MX656 (TL5)
581	4MX056 (TLD)
L1800	4MX856 (1200/1800/3600)



Maxos LED Performer A30 with PSU

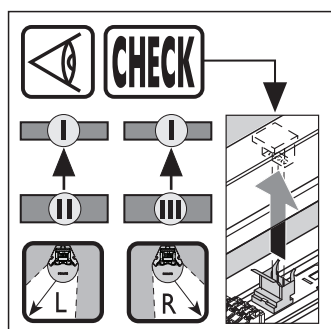

Trunking:
4MX856(1200/1800/3600) /
4MX056(TLD) / 4MX656(TL5)

max. 30 kg

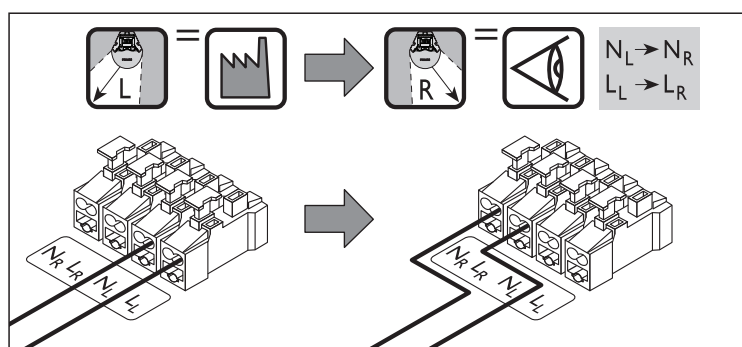
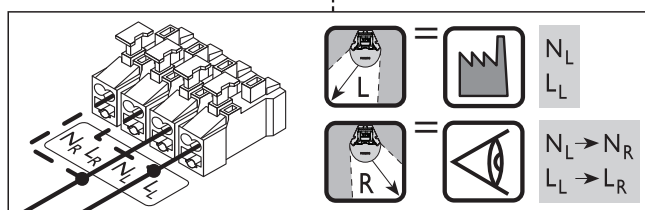
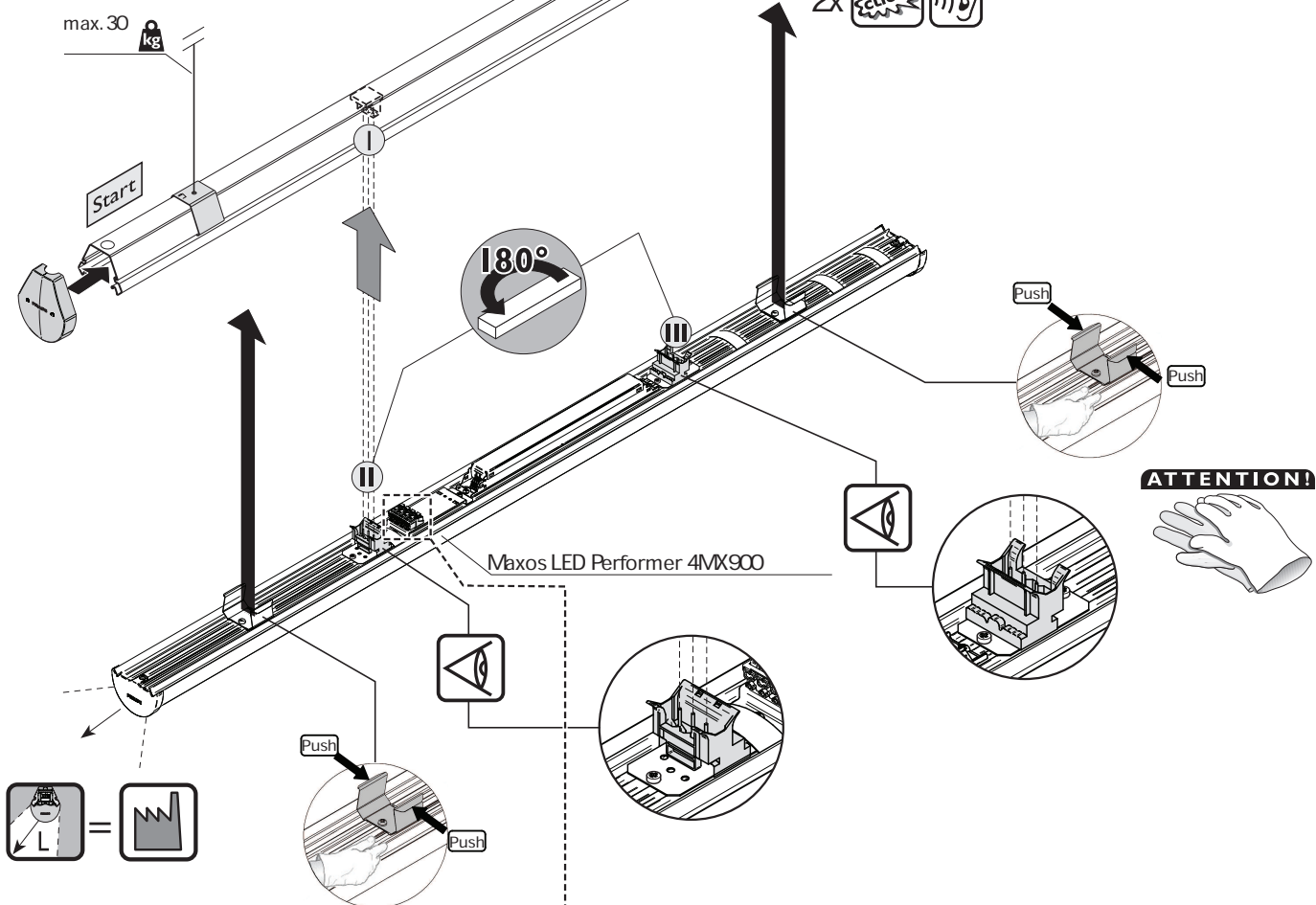



Maxos LED Performer A30 with PSD

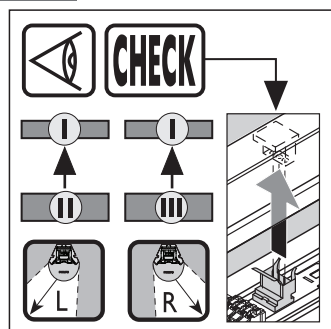

Trunking:
4MX856(1200/1800/3600)/
4MX056(TLD)/4MX656(TL5)



max. 30 kg

Start



Maxos LED Performer 4MX900

2x

Push

Push

ATTENTION!

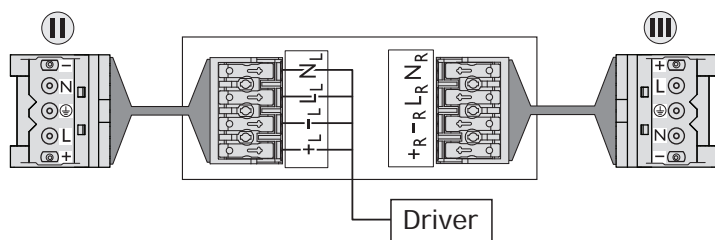
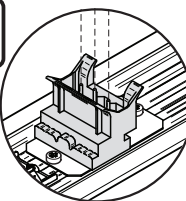
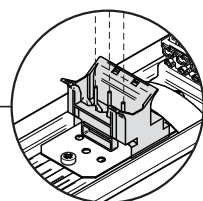
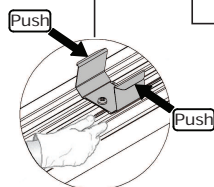

$N_L \rightarrow N_R$
 $L_L \rightarrow L_R$
 $-L \rightarrow -R$
 $+L \rightarrow +R$

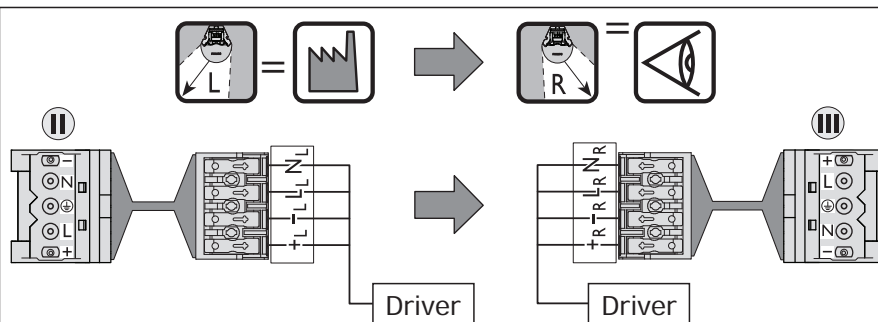

$N_L \rightarrow N_R$
 $L_L \rightarrow L_R$
 $-L \rightarrow -R$
 $+L \rightarrow +R$

Suspension distances

Without coupling piece

Without coupling piece suspension distances of the trunking max. 3m

With coupling piece

Type	D [m]
L1200	3,5
491	4
581	4
L1800	3,5

X = 0,1 - 0,7 m

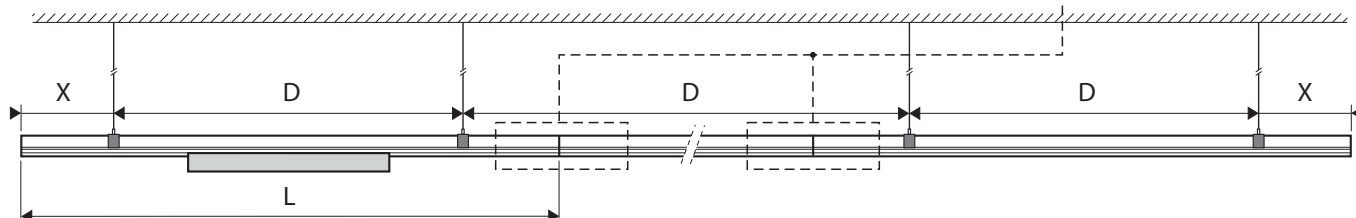
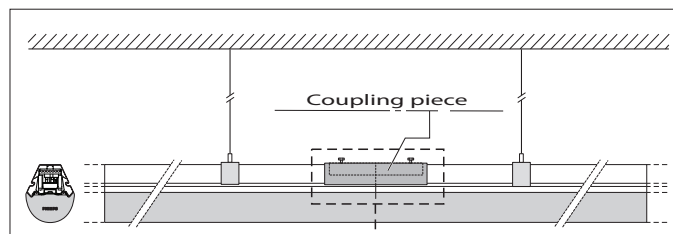

Inrush current

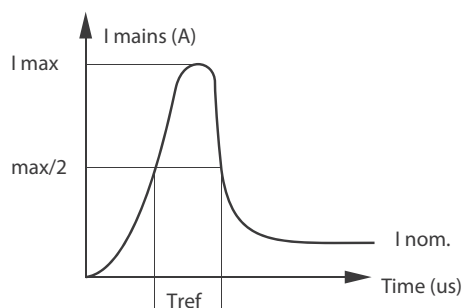

		I max [A]		Tref [μs]	
		PSU	PSD	PSU	PSD
L1200	LED40S	17,8	21	282	280
L1200	LED60S	17,8	21	282	280
491/581	LED40S	17,8	21	282	280
491/581	LED50S	17,8	21	282	280
491/581	LED75S	17,8	21	282	280
L1800	LED60S	17,8	21	282	280
L1800	LED90S	6,02	4,5	65	1000

PSU & PSD		MCB			
		B - 10 A	B - 16 A	C - 10 A	C - 16 A
L1200	LED40S	15	24	24	40
L1200	LED60S	15	24	24	40
491/581	LED40S	15	24	24	40
491/581	LED50S	15	24	24	40
491/581	LED75S	15	24	24	40
L1800	LED60S	15	24	24	40
L1800	LED90S	11	18	18	30



Mounting of electrical unit

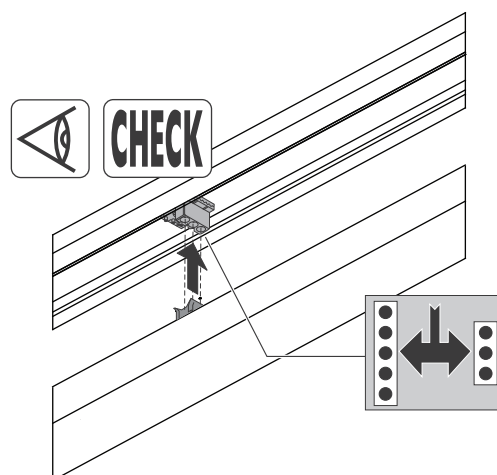
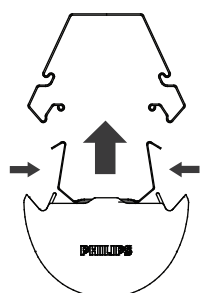

Option: DALI C-2R

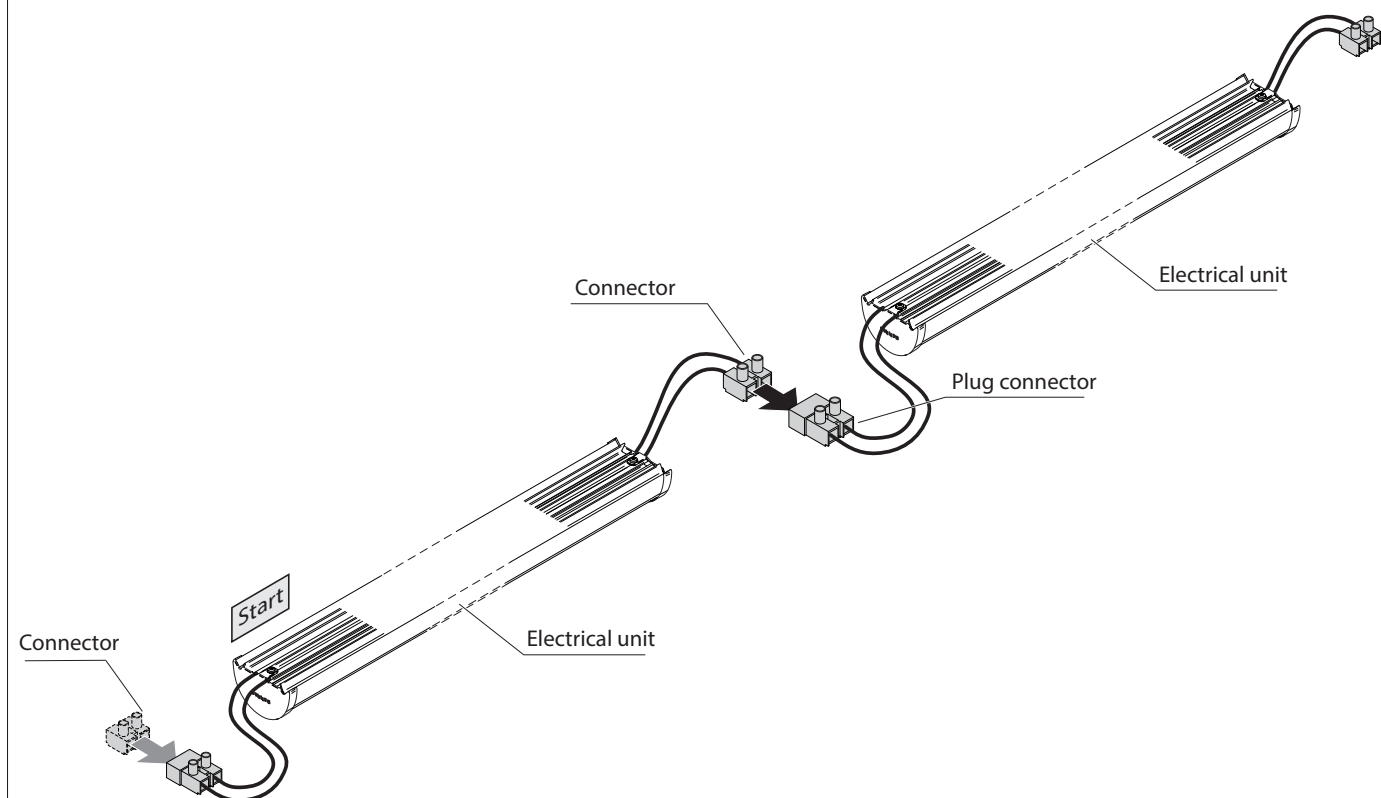

© 2018 Signify Holding

All rights reserved. This document contains information relating to the product portfolio of Signify which information may be subject to change. No representation or warranty as to the accuracy or completeness of the information included herein is given and any liability for any action in reliance thereon is disclaimed. The information presented in this document is not intended as any commercial offer and does not form part of any quotation or contract. Philips and the Philips Shield Emblem are registered trademarks of Koninklijke Philips N.V.. All other trademarks are owned by Signify Holding or their respective owners.

Signify Holding.
The Netherlands