

# MINI 200

## Installation Instruction

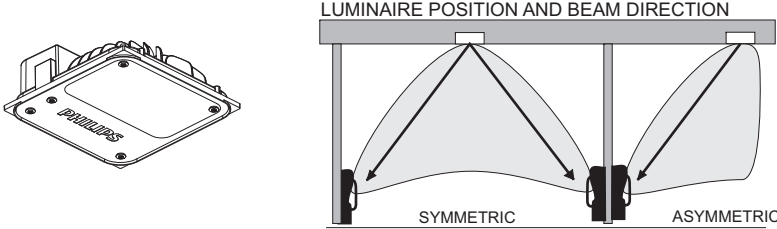

LUMINAIRE POSITION AND BEAM DIRECTION

SYMMETRIC

ASYMMETRIC

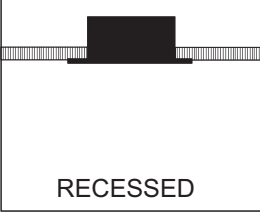

RECESSED

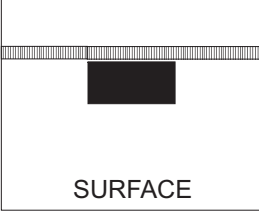

SURFACE

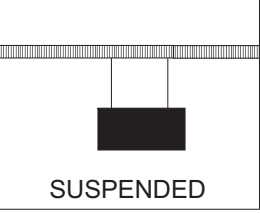



SUSPENDED

TYPE	: BY286V
LAMP	: LED
VOLTAGE	: 240 V, 50 Hz
IP CLASSIFICATION	: IP 65
NET WEIGHT	: 4.5Kg.
MAX. PROJECTED AREA	: 0.08 m <sup>2</sup>
CCT	: 5700 K
APPLICATION	: INDOOR USE ONLY

IP-65

Ta-45





## Dimensions

### Indoor Luminaire

#### SUSPENDED : BY286V + AC286P WH+AC286 WH

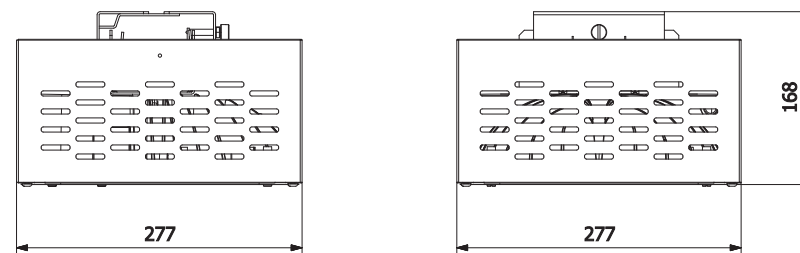

#### SURFACE : BY286V + AC286C WH+AC286 WH

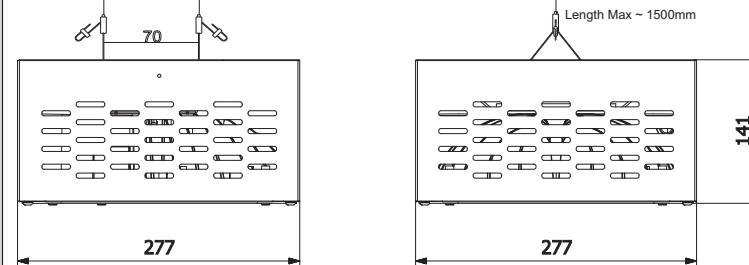

#### RECESSED : BY286V + AC286B WH

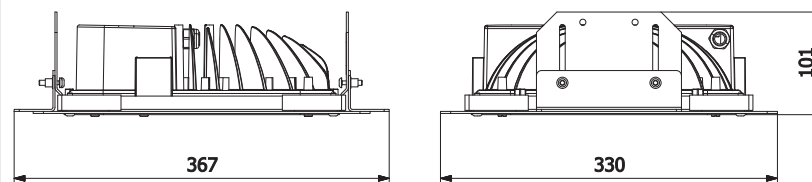

CUTOUT : 285X 285mm

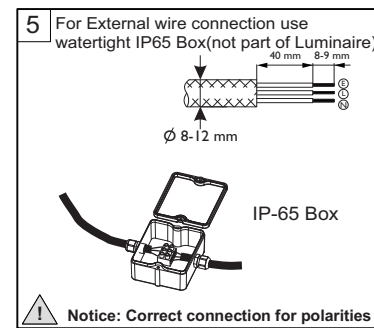
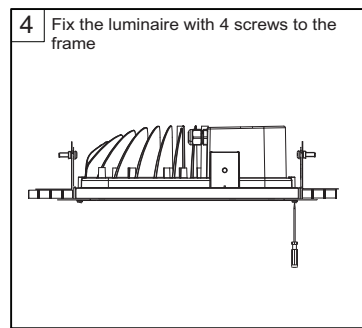
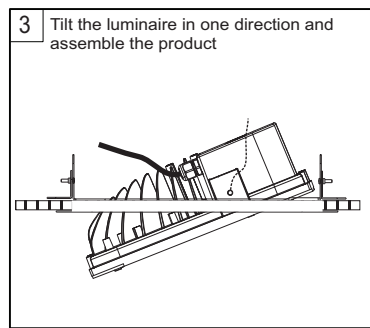
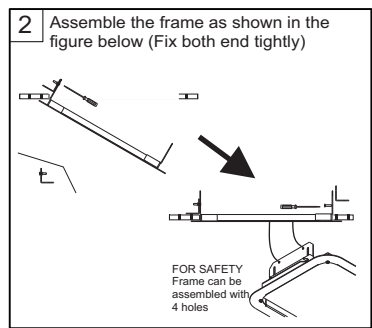
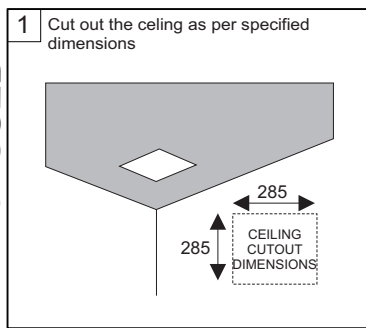
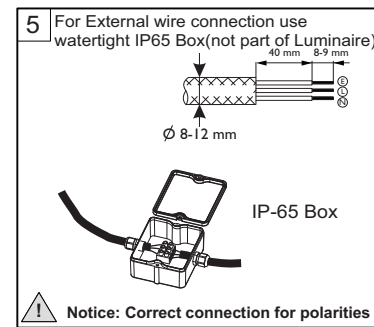
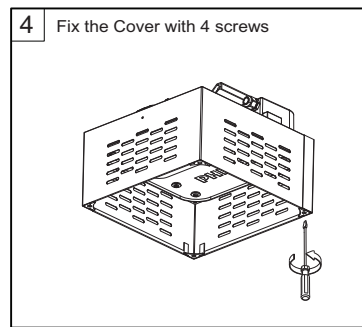
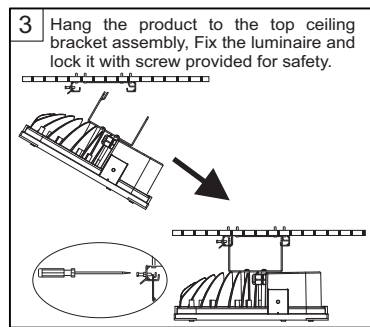
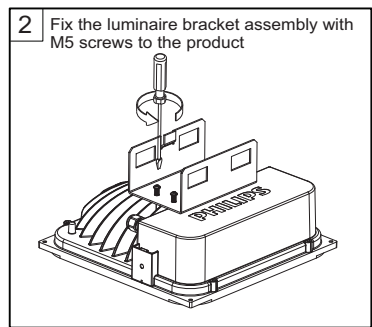
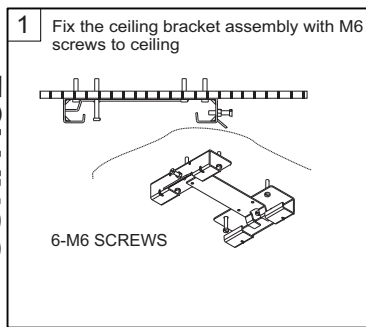
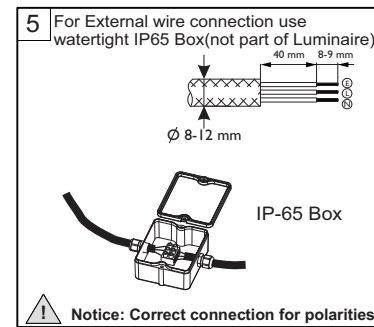
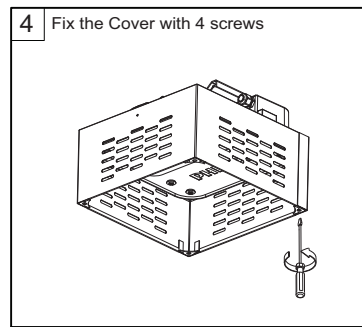
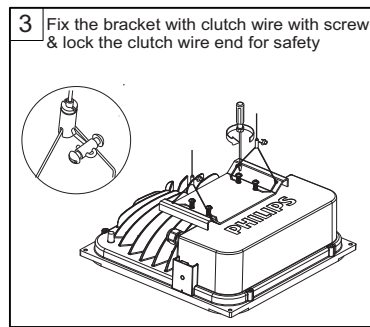
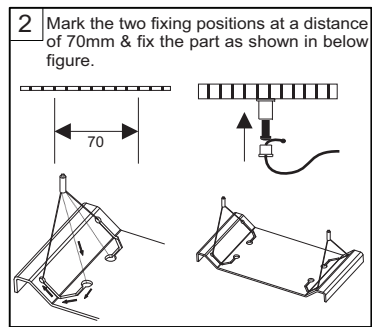
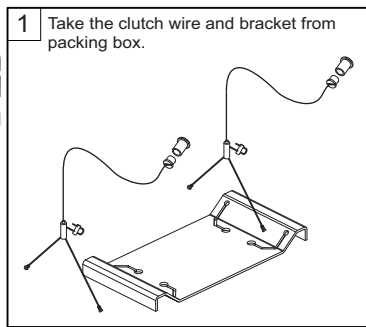

## CAUTION

1. Ensure L-N-E is connected in right manner.
  2. Ensure 3 core CABLE for Connections(Outer diameter 8-12mm, multi strand 1.2 sq. mm thickness) with IP-65 protected cable joint.
  3. 3 Core cable should be properly connected with ground.
  4. Ensure luminaire mounting is done properly with specified load(safety issue)
  5. Product should be operated between 140-270V a.c.
  6. Use Surge protection (up to 10kV) to protect against surges. Use Type B+C surge type SPD in distribution box to arrest switching and lighting surges
  7. Luminaire must be brought down from the mounting position for maintenance.
  8. In case the front glass is found broken/damaged it should not be powered on and is to be replaced before using the luminaire.
  9. The light source of this luminaire is not replaceable, when the light source reaches its end of life the whole luminaire shall be replaced.
- FAILURE OF PRODUCT DUE TO NON COMPLIANCE TO ANY OF THE ABOVE, VOIDS WARRANTY OF PRODUCT