

# HID-GreenVision – The electronic solution for growth light applications

## HID-GreenVision GP-SON

Full electronic driver for GP-SON 600/1000W lamps

### Benefits

- Flexible design-in (PCB in bracket, optimal heat dissipation)
- Low energy consumption
- High number of devices on a MCB (fuse)

### Features

- High efficiency: >95%
- Inrush current limiter
- Long lifetime of 30,000 hours, with 90% survivors at Tcase life
- Accurate lamp power stabilization of +/-3% over wide mains voltage range

### Application

- Luminaires for assimilation lighting (greenhouses/field pitch)

# HID-GreenVision GP-SON

## Versions

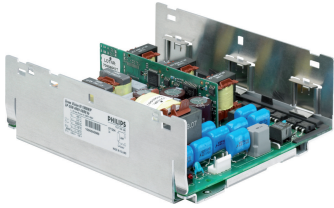

HID-GVIII 600W/P GP-SON 400V

## Dimensional drawing

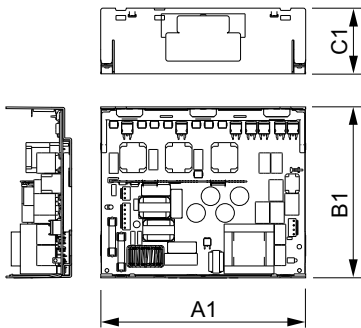

Product	A1	B1	C1
HID-GVIII 750W/P GP-SON 400V NA	181 mm	151 mm	58 mm
HID-GVIII 600W/P GP-SON 400V	58 mm	181 mm	150 mm
HID-GVIII 1000W/P GP-SON 400V	58 mm	181 mm	150 mm

## Product details



HID-GV III GP-SON

### Approval and Application

Energy Efficiency Index A2

### Operating and Electrical

Input Frequency 50 to 60 Hz

Input Voltage 400 V

### General Information

Number Of Lamps 1 piece/unit

Lamp Type GP-SON

## Mechanical and Housing

Order Code	Full Product Name	Housing
913700660361	HID-GVIII 600W/P GP-SON 400V	L 181x150x58

## HID-GreenVision GP-SON

Order Code	Full Product Name	Housing
913700660461	HID-GVIII 1000W/P GP-SON 400V	L 181x150x58
913712009361	HID-GVIII 750W/P GP-SON 400V NA	L 181x151x58

### System characteristics

Order Code	Full Product Name	Rated Ballast-Lamp Power
913700660361	HID-GVIII 600W/P GP-SON 400V	600W/P
913700660461	HID-GVIII 1000W/P GP-SON 400V	1000W/P

Order Code	Full Product Name	Rated Ballast-Lamp Power
913712009361	HID-GVIII 750W/P GP-SON 400V NA	750W/P

