



# Lighting



## EB-Certalume for PLT/C lamps

## Benefits

- Energy efficient, saving 25% energy compared to electromagnetic “C-type” ballasts
- The EB-C TL5 range has a robust design and meets safety, EMC and Immunity tests including safety approbation via an external test-house covering IEC/EN 61347.
- Ideal alternative for electromagnetic ballast, no ignitor needed Pre wired. Lamp/ mains wires and lamp holders are included for easy installation.
- Same size as electromagnetic ballast so ideal for replacements

- Energy efficient CELMA A3
- Complying to CCC certificate including safety acc IEC 61347
- Robust design for 20.000 hour lifetime and 3.000 on/off switches on one lamp.
- Rapid, flicker-free lamp start (< 1.6 s)
- High power factor 0.95 with THD <25%
- EMC compliant to EN 55015 2006 + A1 2007
- Wide voltage range for ignition and operation (165V-253V)
- 45 degree connector for easy connection with push button release

- Designed for applications where lamps burn for a long period of time and switching cycle (on/off) is infrequent. Typical areas of application include:
- Professional indoor applications (e.g. offices and hotels)
- Department stores, shops, supermarkets, convenient stores and public area's
- Indoor lighting boxes
- Homes

# EB-Certalume for PLT/C lamps

## Versions



## Dimensional drawing

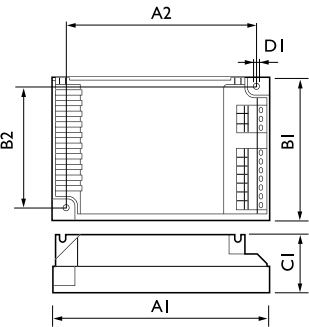

Product	D1	C1	A1	A2	B1
EB-C 113 PL-T/C 220-240V 50/60Hz	4.2 mm	31.0 mm	94.0 mm	86.0 mm	72.0 mm

