



Product Description

EB-Certalume for PLT/C lamps

Affordable, reliable, high frequency electronic ballast for 4-pin PL-T and PL-C fluorescent lamps, ideal alternative for electromagnetic (EM) ballasts

Benefits

- Energy efficient, saving 25% energy compared to electromagnetic “C-type” ballasts
- The EB-C TL5 range has a robust design and meets safety, EMC and Immunity tests including safety approbation via an external test-house covering IEC/EN 61347.
- Ideal alternative for electromagnetic ballast, no ignitor needed Pre wired, Lamp/ mains wires and lamp holders are included for easy installation.
- Same size as electromagnetic ballast so ideal for replacements

Features

- Energy efficient CELMA A3
- Complying to CCC certificate including safety acc IEC 61347
- Robust design for 20.000 hour lifetime and 3.000 on/off switches on one lamp.
- Rapid, flicker-free lamp start (< 1.6 s)
- High power factor 0.95 with THD <25%
- EMC compliant to EN 55015 2006 + A1 2007
- Wide voltage range for ignition and operation (165V-253V)
- 45 degree connector for easy connection with push button release

Application

- Designed for applications where lamps burn for a long period of time and switching cycle (on/off) is infrequent. Typical areas of application include:
- Professional indoor applications (e.g. offices and hotels)
- Department stores, shops, supermarkets, convenient stores and public area's
- Indoor lighting boxes
- Homes

EB-Certalume for PLT/C lamps

Versions



Dimensional drawing

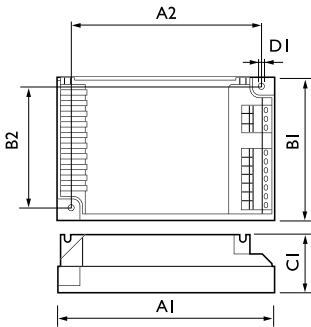

Product

EB-C 118 PL-T/C 220-240V 50/60Hz
EB-C 126 PL-T/C 220-240V 50/60Hz
EB-C 218 PL-T/C 220-240V 50/60Hz
EB-C 113 PL-T/C 220-240V 50/60Hz
EB-C 213 PL-T/C 220-240V 50/60Hz
EB-C 226 PL-T/C 220-240V 50/60Hz

Approval and Application

Energy Efficiency Index	A2
-------------------------	----

Operating and Electrical

Input Frequency	50 to 60 Hz
Input Voltage	220 to 240 V

General Information

Number Of Products On MCB (16A Type B) (Nom)	20
Lamp Type	PL-T/C

General Information

Order Code	Full Product Name	Number Of Lamps
913713198414	EB-C 113 PL-T/C 220-240V 50/60Hz	1 piece/unit
913713198514	EB-C 213 PL-T/C 220-240V 50/60Hz	2 piece/unit
913713198614	EB-C 118 PL-T/C 220-240V 50/60Hz	1 piece/unit

Order Code	Full Product Name	Number Of Lamps
913713198714	EB-C 218 PL-T/C 220-240V 50/60Hz	2 piece/unit
913713198814	EB-C 126 PL-T/C 220-240V 50/60Hz	1 piece/unit
913713198914	EB-C 226 PL-T/C 220-240V 50/60Hz	2 piece/unit

System characteristics

Order Code	Full Product Name	Lamp Power On PL-T/C	Rated Ballast-Lamp Power
913713198414	EB-C 113 PL-T/C 220-240V 50/60Hz	13.0 W	13 W

Order Code	Full Product Name	Lamp Power On PL-T/C	Rated Ballast-Lamp Power
913713198514	EB-C 213 PL-T/C 220-240V 50/60Hz	13.0 W	13 W

EB-Certalume for PLT/C lamps

Order Code	Full Product Name	Lamp Power On PL-T/C	Rated Ballast- Lamp Power
913713198614	EB-C 118 PL-T/C 220-240V 50/60Hz	16.0 W	18 W
913713198714	EB-C 218 PL-T/C 220-240V 50/60Hz	16.5 W	18 W
913713198814	EB-C 126 PL-T/C 220-240V 50/60Hz	24.5 W	26 W

Order Code	Full Product Name	Lamp Power On PL-T/C	Rated Ballast- Lamp Power
913713198914	EB-C 226 PL-T/C 220-240V 50/60Hz	24.5 W	26 W

Mechanical and Housing

Order Code	Full Product Name	Housing
913713198414	EB-C 113 PL-T/C 220-240V 50/60Hz	-
913713198514	EB-C 213 PL-T/C 220-240V 50/60Hz	-
913713198614	EB-C 118 PL-T/C 220-240V 50/60Hz	-

Order Code	Full Product Name	Housing
913713198714	EB-C 218 PL-T/C 220-240V 50/60Hz	-
913713198814	EB-C 126 PL-T/C 220-240V 50/60Hz	-
913713198914	EB-C 226 PL-T/C 220-240V 50/60Hz	-

