



Essentially smart and reliable

HF-Essential for TL5/TL-D

HF-Essential is the most cost-effective, slim and affordable ballast to reliably operate a fluorescent lamp. It is also the ideal entry-level product for EM system users who want to enjoy the benefits offered by electronic ballasts. The cost-saving and reliable HF-Essential has an energy efficiency class A2, and its robust design meets all relevant international safety and performance standards. HF-Essential is intended for use with indoor lighting fixtures such as recessed luminaires, which are largely used in office, industrial, hotel, restaurant and other applications.

Benefits

- Automatic restart (after voltage dip or lamp replacement) ensures easy operation and hassle-free re-lamping.
- DC emergency operation and EMC compliant to EN 55015 2006 + A1 2007
- Suitable for luminaires in protection class I and, after testing, class II

Features

- Complies with CE and Kema
- Robust design for 45,000 hours lifetime at $T_a=50\text{ }^{\circ}\text{C}$ and over 6,000 on/off switching operations on one lamp
- Energy efficiency class: A2
- Failure rate of 0.3% per 1,000 hours at $T_c \text{ max} = 75\text{ }^{\circ}\text{C}$
- Igniter and capacitor not required; flicker-free and noiseless

Application

- Ideal for applications where there is a need to reduce the wattage per square meter or to reduce operating costs
- Indoor applications such as office buildings, hospitals, supermarkets, department stores, homes and schools

HF-Essential for TL5/TL-D

Versions



Dimensional drawing

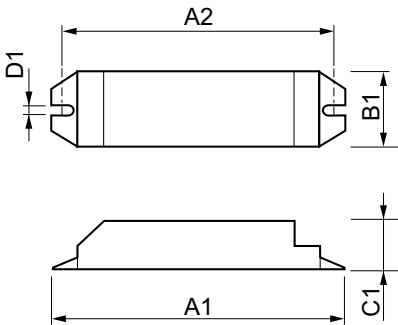

Product	D1	C1	A1	A2	B1
HF-E 218 TL-D 220-240 50/60Hz	4.2 mm	28.0 mm	150.0 mm	136.0 mm	40.0 mm
HF-E 136 TL-D 220-240 50/60Hz	4.2 mm	28.0 mm	150.0 mm	136.0 mm	40.0 mm
HF-E 236 TL-D 220-240 50/60Hz	4.2 mm	30.0 mm	211.0 mm	197.0 mm	40.0 mm

Approval and Application	
Energy Efficiency Index	A2
Operating and Electrical	
Input Frequency	50 to 60 Hz
Input Voltage	220 to 240 V
General Information	
Lamp Type	TL-D

General Information

Order Code	Full Product Name	Number Of Lamps
913713038866	HF-E 136 TL-D 220-240 50/60Hz	1 piece/unit
913713039066	HF-E 218 TL-D 220-240 50/60Hz	2 piece/unit

Order Code	Full Product Name	Number Of Lamps
913713039166	HF-E 236 TL-D 220-240 50/60Hz	2 piece/unit

Mechanical and Housing

Order Code	Full Product Name	Housing
913713038866	HF-E 136 TL-D 220-240 50/60Hz	L 150x40x28
913713039066	HF-E 218 TL-D 220-240 50/60Hz	L 150x40x28

Order Code	Full Product Name	Housing
913713039166	HF-E 236 TL-D 220-240 50/60Hz	L211x40x30

System characteristics

HF-Essential for TL5/TL-D

			Rated Ballast-Lamp	
Order Code	Full Product Name	Lamp Power On TL-D	Power	
913713038866	HF-E 136 TL-D 220-240 50/60Hz	30.7/32.7/35.1 W	36 W	
913713039066	HF-E 218 TL-D 220-240 50/60Hz	14.6/15.6/17 W	18 W	

			Rated Ballast-Lamp	
Order Code	Full Product Name	Lamp Power On TL-D	Power	
913713039166	HF-E 236 TL-D 220-240 50/60Hz	28/29.8/31.6 W	36 W	

