

Digital ignitors for maximum reliability

HID ignitors for series systems

HID ignitors for series systems

Benefits

- Easy installation and wiring
- Can operate with both semi-parallel and series ballasts
- Digital ignitors ensure maximum reliability

Features

- Ignitors equipped with screw terminal blocks as standard
- Series ignitor will only work in series circuits

Application

- Outdoor lighting (most popular application: road and tunnel lighting)

Versions

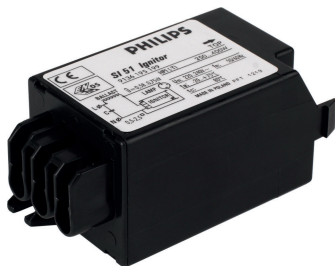

SI 51 & 51-S



SMD 57, 57-S, 58, 58-S, 88, 89, 90 & 91

HID ignitors for series systems

Dimensional drawing

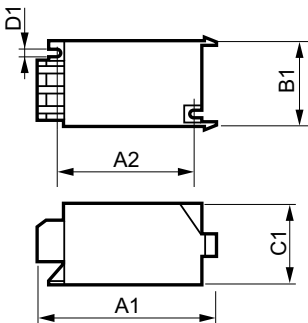

Product	D1	C1	A1	A2	B1
SND 58 220-240V 50/60Hz	4.3 mm	38.5 mm	84.5 mm	65.0 mm	41.5 mm

Product	D1	C1	A1	A2	B1
SI 51 220-240V 50/60Hz	4.3 mm	38.0 mm	84.5 mm	65.0 mm	41.0 mm

Operating and Electrical	
Input Frequency	50 to 60 Hz
Input Voltage	220 to 240 V
General Information	
Number Of Lamps	1 piece/unit
Mechanical and Housing	
Housing	SNI-85

General Information

Order Code	Full Product Name	Lamp Type
913619519966	SI 51 220-240V 50/60Hz	HPI

Order Code	Full Product Name	Lamp Type
913700185166	SND 58 220-240V 50/60Hz	SON/CDM/MH/HPI/HPA

System characteristics

Order Code	Full Product Name	Rated Ballast-Lamp Power
913619519966	SI 51 220-240V 50/60Hz	250/400 W

Order Code	Full Product Name	Rated Ballast-Lamp Power
913700185166	SND 58 220-240V 50/60Hz	35-600 W

HID ignitors for series systems

