



A comfortable heat source for your muscles

InfraRed Healthcare Heat Incandescent

Philips infrared lamps for healthcare and bodycare applications are designed for treating deep-seated muscular ailments and sports injuries. These incandescent reflector lamps are an excellent solution to provide localized heat treatment to relieve muscular pain. They can also be used to treat rheumatic ailments. This form of heat therapy has also been shown to speed the healing of different kinds of injuries such as sports injuries and non-infected wounds, in many cases providing rapid and effective pain relief. The benefits of this form of heat therapy are based on locally enhanced blood circulation in the skin caused by vasodilatory response. This results in an increased transport rate of metabolites and other essential biochemical compounds. Benefits are also gained by deeper penetration of heat, which provides a gentle, pleasant warming effect.

Benefits

- Optimal penetration into skin and muscles for ultimate relief of muscular pain
- 90% of energy transmitted as infrared heat
- Instant, accurately controllable source of radiant heat

Features

- Reflector shape allows concentrated heat to be applied where it is needed.
- PAR38 has a 100% aluminized internal reflector, which means that 100% of the heat leaves via the front.
- PAR38 has a small, round filament, which also contributes to more concentrated heat in the beam.
- Good balance between lifetime and heat output
- Red-colored lamps to reduce visual light emission and glare

InfraRed Healthcare Heat Incandescent

Application

- Providing relief from muscular pain and ailments such as rheumatism, lumbago, neuralgia and colds, etc.
- Promoting recovery from injury
- Providing comfort and cosmetic care

Versions



R95 Hardglass

Dimensional drawing

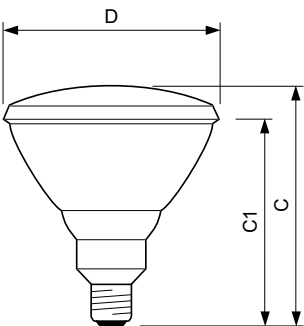

Product	D	C (max)	C1 (max)
PAR38 IR 150W E27 125-130V Red 1CT/12	121 mm	136 mm	124 mm
PAR38 IR 150W E27 230V Red 1CT/12	121 mm	136 mm	124 mm

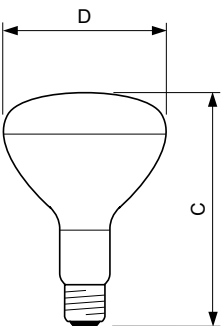

Product	D	C
R95 IR 100W E27 220-240V Red HG 1CT/20	95 mm	130 mm

InfraRed Healthcare Heat Incandescent

General Information	
Cap-Base	E27
Rated Lifetime (Hours)	300 hour(s)
Nominal lifetime	300 hour(s)
Operating Position	UNIVERSAL
Controls and Dimming	
Dimmable	Yes
Mechanical and Housing	
Bulb Finish	Red
Bulb Material	Hard Glass

Operating and Electrical

Order Code	Full Product Name	Voltage (Nom)	Power
			Consumption
923244544201	R95 IR 100W E27 220-240V Red HG 1CT/20	220-240 V	100 W
923806635606	PAR38 IR 150W E27 125-130V Red 1CT/12	125-130 V	150 W

Order Code	Full Product Name	Voltage (Nom)	Power
			Consumption
923806644210	PAR38 IR 150W E27 230V Red 1CT/12	230 V	150 W

Mechanical and Housing

Order Code	Full Product Name	Bulb Shape
923244544201	R95 IR 100W E27 220-240V Red HG 1CT/20	R95
923806635606	PAR38 IR 150W E27 125-130V Red 1CT/12	PAR38

Order Code	Full Product Name	Bulb Shape
923806644210	PAR38 IR 150W E27 230V Red 1CT/12	PAR38

