



# MSD Platinum – The power to light your creativity

## MSD Platinum (Touring/Stage)

The MSD Platinum lamps open up new levels of creative freedom in entertainment lighting, with powerful, compact and brilliantly intense light. Their compact, lightweight design provides the freedom to create smaller, lighter luminaires – for use at any location on stage. And their short arc, high color temperature and innovative reflector produce a sparkling, high beam intensity for outstanding color reproduction. They also offer long and reliable lifetime, high efficacy and fast replacement times. It all adds up to an intensely exciting creative experience.

### Benefits

- High beam intensity
- Freedom to create smaller and lighter fixtures
- High perceived brightness
- A long and reliable performance

### Features

- Very short arc
- Compact system
- High correlated color temperature
- Philips Platinum technology

### Application

- Events
- Shows/Theater
- Touring/Stage

# MSD Platinum (Touring/Stage)

## Warnings and Safety

- A lamp breaking is extremely unlikely to have any impact on your health. If a lamp breaks, ventilate the room for 30 minutes and remove the parts, preferably with gloves. Put them in a sealed plastic bag and take it to your local waste facilities for recycling. Do not use a vacuum cleaner.
- Lamp contains mercury. Manage in Accord with Disposal Laws. See: [www.lamprecycle.org](http://www.lamprecycle.org) or 1-800-555-0050

## Versions



MSD Platinum 5 R and 14 R



MSD Platinum 15 R, 16 R



MSD Platinum 11 R / 17 RA



MSD Platinum 20 R



MSD Platinum 20 R



MSD Platinum 200 Flex



MSD Platinum 25 R

## Dimensional drawing

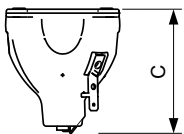
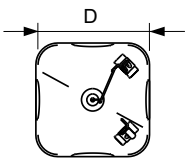

Product	D (max)	O	C (max)
MSD Platinum 15 R UNP/24	58.5 mm	1.3 mm	66.4 mm
MSD Platinum 15 R 1CT/8	58.5 mm	1.3 mm	66.4 mm
MSD Platinum 16 R UNP/24	58.5 mm	1.3 mm	66.4 mm
MSD Platinum 16 R 1CT/8	58.5 mm	1.3 mm	66.4 mm

# MSD Platinum (Touring/Stage)

## Dimensional drawing

D

D

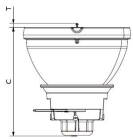
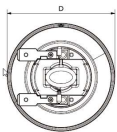
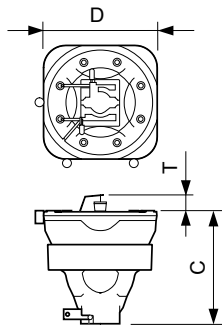

Product	D (max)	T (max)	O	C (max)
MSD Platinum 14 R 1CT/8	51.5 mm	6.8 mm	0.95 mm	57.1 mm
MSD Platinum 5 R UNP/24	51.4 mm	6.8 mm	1.0 mm	57.1 mm
MSD Platinum 5 R 1CT/8	51.4 mm	6.8 mm	1.0 mm	57.1 mm

Product	D (max)	O	C (max)
MSD Platinum 20 R 1CT/8	58.5 mm	1.2 mm	72 mm
MSD Platinum 20 R UNP/24	58.5 mm	1.2 mm	72 mm
MSD Platinum 20 RB UNP/24	58.5 mm	1.2 mm	72 mm
MSD Platinum 20 RB 1CT/8	58.5 mm	1.2 mm	72 mm
MSD Platinum 21 R 1CT/8	54 mm	1.2 mm	60 mm
MSD Platinum 25 R 1CT/8	54 mm	1.4 mm	60 mm

Product	D (max)	T (max)	O	C (max)
MSD Platinum 17 RA UNP/24	51.4 mm	10.0 mm	1.0 mm	63 mm
MSD Platinum 17 RA 1CT/8	51.4 mm	10.0 mm	1.0 mm	63 mm
MSD Platinum 11 R 1CT/8	51.5 mm	10 mm	0.95 mm	53 mm

Product	D (max)	O	C (max)	T
MSD Platinum 200 Flex 1CT/8	56.5 mm	0.8 mm	60 mm	7 mm

# MSD Platinum (Touring/Stage)

Controls and Dimming	
Dimmable	Yes
General Information	
Operating Position	Universal
Light Technical	
Color Code	2

## Operating and Electrical

Order Code	Full Product Name	Voltage (Max)	Voltage (Min)	Power (Rated) (Nom)
243527	MSD PLATINUM 5 R UNP/24	-	-	189 W
249888	MSD Platinum 5 R 1CT/8	-	-	189 W
261503	MSD Platinum 14 R 1CT/8	-	-	280 W
274019	MSD Platinum 15 R UNP/24	-	-	300 W
276089	MSD Platinum 15 R 1CT/8	-	-	300 W
326603	MSD Platinum 16 R UNP/24	-	-	330 W
293050	MSD Platinum 16 R 1CT/8	-	-	330 W
303628	MSD Platinum 11 R 1CT/8	80 V	55 V	250 W
259192	MSD Platinum 17RA UNP/24	-	-	350.0 W

Order Code	Full Product Name	Voltage (Max)	Voltage (Min)	Power (Rated) (Nom)
259176	MSD Platinum 17 RA 1CT/8	-	-	350.0 W
259200	MSD Platinum 20 R UNP/24	110 V	85 V	470 W
259184	MSD Platinum 20 R 1CT/8	110 V	85 V	470 W
323733	MSD Platinum 20 RB UNP/24	110 V	85 V	470 W
323741	MSD Platinum 20 RB 1CT/8	110 V	85 V	470 W
323659	MSD Platinum 21 R 1CT/8	-	-	470 W
341297	MSD Platinum 200 Flex 1CT/8	-	55 V	240 W
343095	MSD Platinum 25 R 1CT/8	115 V	85 V	550 W

## General Information

Order Code	Full Product Name	Cap-Base	Life To 50% Failures (Nom)	Main Application	System Description
243527	MSD PLATINUM 5 R UNP/24	-	3000 h	Stage/Touring	Reflector-E20.6
249888	MSD Platinum 5 R 1CT/8	-	3000 h	Stage/Touring	Reflector-E20.6
261503	MSD Platinum 14 R 1CT/8	-	2000 h	Stage/Touring	Reflector-E20.6
274019	MSD Platinum 15 R UNP/24	-	2000 h	Stage/Touring	na
276089	MSD Platinum 15 R 1CT/8	-	2000 h	Stage/Touring	na
326603	MSD Platinum 16 R UNP/24	-	1500 h	Stage/Touring	Reflector E21.9 TCM
293050	MSD Platinum 16 R 1CT/8	-	1500 h	Stage/Touring	Reflector E21.9 TCM
303628	MSD Platinum 11 R 1CT/8	-	2000 h	Stage/Touring	Reflector-E20.9
259192	MSD Platinum 17RA UNP/24	-	1500 h	Stage/Touring	Reflector-E20.9

Order Code	Full Product Name	Cap-Base	Life To 50% Failures (Nom)	Main Application	System Description
259176	MSD Platinum 17 RA 1CT/8	-	1500 h	Stage/Touring	Reflector-E20.9
259200	MSD Platinum 20 R UNP/24	-	1500 h	Stage/Touring	Reflector E21.9 TCM
259184	MSD Platinum 20 R 1CT/8	-	1500 h	Stage/Touring	Reflector E21.9 TCM
323733	MSD Platinum 20 RB UNP/24	-	1500 h	Stage/Touring	Reflector E21.9 TCM
323741	MSD Platinum 20 RB 1CT/8	-	1500 h	Stage/Touring	Reflector E21.9 TCM
323659	MSD Platinum 21 R 1CT/8	-	1500 h	Stage/Touring	Reflector-E21.4
341297	MSD Platinum 200 Flex 1CT/8	-	2000 h	-	-
343095	MSD Platinum 25 R 1CT/8	-	1500 h	Stage/Touring	-

## Light Technical

## MSD Platinum (Touring/Stage)

Order Code	Full Product Name	Correlated Color Temperature (Nom)	Color Rendering Index (Nom)	Luminous Flux (Min)	Luminous Flux (Nom)
243527	MSD PLATINUM 5 R UNP/24	8000 K	-	7100 lm	7950 lm
249888	MSD Platinum 5 R 1CT/8	8000 K	-	7100 lm	7950 lm
261503	MSD Platinum 14 R 1CT/8	7800 K	-	-	12350 lm
274019	MSD Platinum 15 R UNP/24	8000 K	-	11000 lm	13500 lm
276089	MSD Platinum 15 R 1CT/8	8000 K	-	11000 lm	13500 lm
326603	MSD Platinum 16 R UNP/24	8000 K	-	14300 lm	16000 lm
293050	MSD Platinum 16 R 1CT/8	8000 K	-	14300 lm	16000 lm
303628	MSD Platinum 11 R 1CT/8	7800 K	-	-	12000 lm
259192	MSD Platinum 17RA UNP/24	7000 K	85	-	15250 lm

Order Code	Full Product Name	Correlated Color Temperature (Nom)	Color Rendering Index (Nom)	Luminous Flux (Min)	Luminous Flux (Nom)
259176	MSD Platinum 17 RA 1CT/8	7000 K	85	-	15250 lm
259200	MSD Platinum 20 R UNP/24	8000 K	-	-	22400 lm
259184	MSD Platinum 20 R 1CT/8	8000 K	-	-	22400 lm
323733	MSD Platinum 20 RB UNP/24	8000 K	-	-	22400 lm
323741	MSD Platinum 20 RB 1CT/8	8000 K	-	-	22400 lm
323659	MSD Platinum 21 R 1CT/8	8000 K	-	14100 lm	15600 lm
341297	MSD Platinum 200 Flex 1CT/8	7800 K	-	-	12000 lm
343095	MSD Platinum 25 R 1CT/8	8000 K	-	22100 lm	24500 lm

