



# The new generation of energy-saving tube lighting

## Other LEDtube

Philips LEDtube integrates a LED light source into a traditional fluorescent form factor. This product is the ideal solution for uplamping in general lighting applications: it meets basic lighting requirements, offers significant energy savings, and is environmentally friendly.

### Beneficii

- Reduced operational cost thanks to lower energy consumption
- Lower maintenance cost thanks to 2-3 times longer lifetime than conventional lamps
- Fastest and easiest way to upgrade existing luminaires to LED technology; completely safe product and installation process

### Caracteristici

- Highly energy-efficient
- Easy installation
- Conventional form factor to fit into existing luminaires
- No mercury

### Cerere

- Hospitality, retail, office, industrial and home applications

## Other LEDtube

### Versions



### Cote

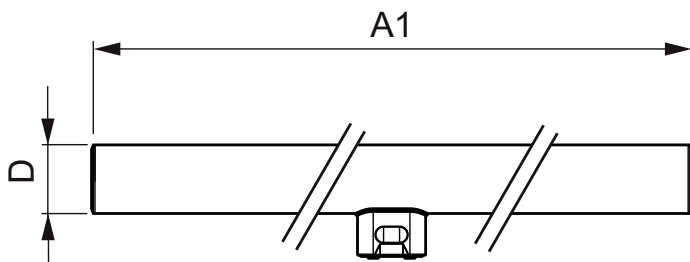

Product	D	A1
LED 3W 300mm S14D WW ND 1CT/4	30 mm	266,8 mm

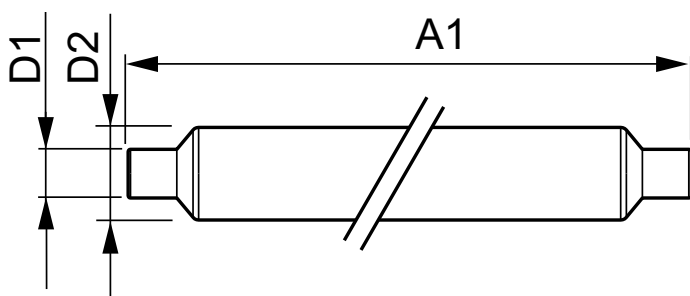

Product	C	D
LED 6.5W 310mm S19 WW ND 1CT/4	310 mm	38 mm

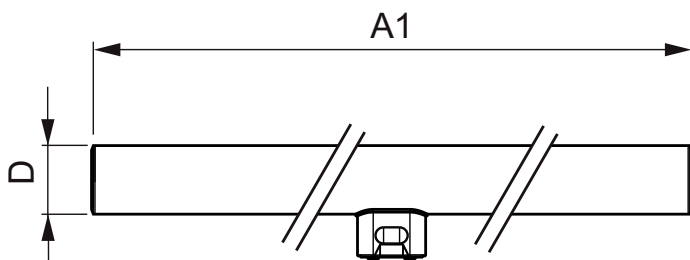

Product	D	A1
LED 4.5W 500mm S14D WW ND 1CT/4	30 mm	466,8 mm

## Other LEDtube

### Approval and Application

Etichetă de eficiență energetică (EEL) A+

### Controls and Dimming

Cu reglarea intensității luminoase Nu

### Operating and Electrical

Frecvență de intrare De la 50 până la  
60 Hz

Tensiune (nom.) 220-240 V

Timp de pornire (nom.) 0,5 s

### General Information

Baza elementului de fixare S14D

Durată de viață nominală (nom.) 15000 h

Durată de viață nominală (ore) 15000 h

Ciclu de comutare 50000X

### Light Technical

Unghi de distribuție luminoasă (nom.) 140°

Cod culoare 827

Temperatură de culoare corelată  
(nom.) 2700 K

Indice de redare a culorii (nom.) 83

Factorul de menținere a fluxului

luminos al lămpii la sfârșitul duratei de  
viață nominale (nom.)

Unghi de distribuție luminoasă  
nominal 140°

### Mechanical and Housing

Finisaj bec Mat (FR)

### Temperature

T-Ambient (max.) 45 °C

T-Ambient (min.) -20 °C

T-Storage (max.) 65 °C

T-Storage (min.) -40 °C

### Approval and Application

Order Code	Full Product Name	Consum de energie kWh/1000 h
58605100	LED 3W 300mm S14D WW ND 1CT/4	3 kWh
58607500	LED 4.5W 500mm S14D WW ND 1CT/4	5 kWh

### Operating and Electrical

Order Code	Full Product Name	Putere (Evaluată) (nom.)
58605100	LED 3W 300mm S14D WW ND 1CT/4	3 W

Order Code	Full Product Name	Putere (Evaluată) (nom.)
58607500	LED 4.5W 500mm S14D WW ND 1CT/4	4.5 W

### Light Technical

Order Code	Full Product Name	Flux luminos (nom.)	Flux luminos (Evaluat) (nom.)
58605100	LED 3W 300mm S14D WW ND 1CT/4	250 lm	250 lm
58607500	LED 4.5W 500mm S14D WW ND 1CT/4	375 lm	375 lm

## Other LEDtube

