

Simple, robust magnetic ballast

HID-Basic Semi-Parallel ballasts for MHN/CDM lamps

The HID Basic Semi-Parallel ballast is an impregnated (HID standard) electromagnetic copper/iron ballast for use with an external ignitor for metal-halide and CDM lamps.

Benefits

- Limited volume of ballast coil; also lightweight
- Simple installation and cabling

Features

- Orthocyclic winding process
- Ballasts equipped with screw terminal blocks as standard
- Earthing-while-mounting facility (HID Standard ballasts)
- Low watt losses

Application

- For use with MHN/CDM lamps in retail, lobby and city beautification applications
- HID-Basic ballasts should be restricted to built-in situations where relative humidity is limited.

HID-Basic Semi-Parallel ballasts for MHN/CDM lamps

Versions

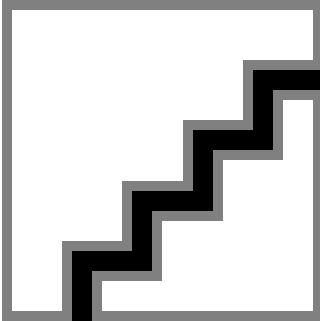

BMH 35L 302I TS

Dimensional drawing

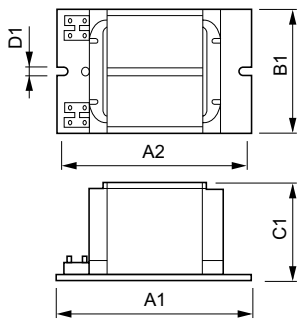

Product	D1	C1	A1	A2	B1
BMH 70L 300I TS	6.2 mm	51.5 mm	117.0 mm	102.0 mm	57.1 mm
BMH 35L 300I TS	6.2 mm	51.5 mm	117.0 mm	102.0 mm	57.1 mm

Operating and Electrical

Input Frequency 50 Hz

Input Voltage 220 V

System characteristics

Order Code	Full Product Name	Rated Ballast-Lamp Power
913713200567	BMH 35L 300I TS	35 W

Order Code	Full Product Name	Rated Ballast-Lamp Power
913713200667	BMH 70L 300I TS	70 W

