

Simple, robust magnetic ballast

HID-Basic Semi-Parallel ballasts for SON/CDM/MH lamps

The HID Basic Semi-Parallel ballast is an impregnated (HID standard) electromagnetic copper/iron ballast for use with an external ignitor for HID lamps.

Benefits

- Limited volume of ballast coil; also lightweight
- Simple installation and cabling

Features

- Orthocyclic winding process
- Ballasts equipped with screw terminal blocks as standard
- Earthing-while-mounting facility (HID Standard ballasts)
- Low watt losses

Application

- For use with SON and HPI (PLUS) lamps in road, public, area and industry lighting
- For use with MHN/CDM lamps in shop, lobby and city beautification applications
- HID-Basic ballasts should be restricted to built-in situations where relative humidity is limited.

HID-Basic Semi-Parallel ballasts for SON/CDM/MH lamps

Versions



BSN150L300I

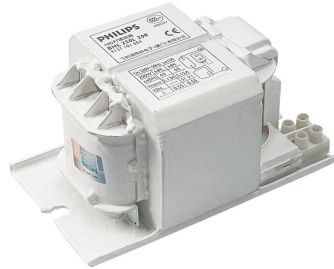

BSNE 150L 300I TS

Dimensional drawing

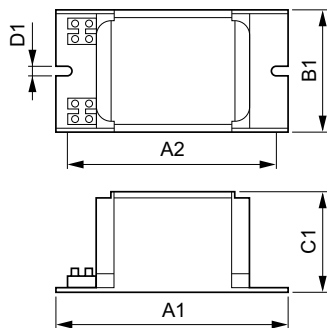
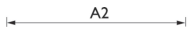

Product	D1	C1	A1	A2	B1
BSN 150L 300I TS	6.2 mm	64.5 mm	125.0 mm	110 mm	75.5 mm
BSN 70L 300I TS	6.2 mm	51.5 mm	117.0 mm	110 mm	57.1 mm
BSN 100L 300I	6.2 mm	51.5 mm	122.0 mm	107 mm	57.1 mm
BSN 70L 301I	6.2 mm	51.5 mm	117.0 mm	102 mm	57.1 mm
BSN 400L 300I TS	6.2 mm	82 mm	165.0 mm	150 mm	96.5 mm
BSN 150L 301I TS	6.2 mm	64.5 mm	125.0 mm	110 mm	75.5 mm
BSN 150L 301I	6.3 mm	64.5 mm	150.0 mm	104.0 mm	72.5 mm
BSN 250L 302I	6.3 mm	64.5 mm	150.0 mm	129.0 mm	72.5 mm
BSN 100L 300I TS	6.2 mm	51.5 mm	122.0 mm	107 mm	57.1 mm
BSN 400L 301I	6.2 mm	82 mm	165.0 mm	150 mm	96.5 mm
BSN 250L 301I TS	6.3 mm	64.5 mm	150.0 mm	135.0 mm	72.5 mm
BSN 250L 301I	6.3 mm	64.5 mm	150.0 mm	135.0 mm	72.5 mm
BSN 250L 300I TS	6.2 mm	64.5 mm	150.0 mm	135 mm	75.5 mm
BSN 250L 427I TS	6.2 mm	64.5 mm	150.0 mm	135 mm	75.5 mm
BSN 70L 301I	6.3 mm	51.5 mm	110.0 mm	89 mm	60.0 mm
BSN 600L 300I TS	6.2 mm	82 mm	175 mm	160 mm	96.5 mm
BSN 70L 300I	6.2 mm	51.5 mm	117.0 mm	102 mm	57.1 mm
BSN 50L 301I	6.3 mm	51.5 mm	110.0 mm	89 mm	60.0 mm

Product	D1	C1	A1	A2	B1
BSNE 400L 300I TS	6.3 mm	82 mm	165.0 mm	144 mm	96.0 mm
BSNE 150L 300I TS	6.3 mm	64.5 mm	120.0 mm	99.0 mm	75.0 mm
BSNE 250L 300I TS	6.3 mm	64.5 mm	165.0 mm	144 mm	75.0 mm

Operating and Electrical

HID-Basic Semi-Parallel ballasts for SON/CDM/MH lamps

Order Code	Full Product Name	Input Frequency	Input Voltage
913710100859	BSN 250L 427I TS	50 Hz	230 V (default) or 240 V
913710102016	BSN 150L 301I	60 Hz	220 V
913710102116	BSN 250L 301I	50 Hz	230 V
913710102143	BSN 250L 301I TS	50 Hz	230 V
913710102250	BSN 150L 301I TS	60 Hz	220 V
913710102850	BSN 250L 302I	50 Hz	230 V
913710102950	BSN 400L 301I	60 Hz	220 V
913710103750	BSN 100L 300I	50 Hz	220 V
913710104550	BSN 70L 300I	50 Hz	220 V
913710104643	BSN 70L 301I	60 Hz	220 V
913710105942	BSN 600L 300I TS	50 Hz	220 V

Order Code	Full Product Name	Input Frequency	Input Voltage
913710106842	BSN 100L 300I TS	50 Hz	220 V
913710106942	BSN 70L 300I TS	50 Hz	220 V
913710109142	BSN 150L 300I TS	50 Hz	220 V
913710109342	BSN 250L 300I TS	50 Hz	220 V
913710109542	BSN 400L 300I TS	50 Hz	220 V
913713206016	BSN 70L 301I	60 Hz	220 V
913713206116	BSN 50L 301I	60 Hz	220 V
913713019359	BSNE 150L 300I TS	50 Hz	220 V
913713019459	BSNE 250L 300I TS	50 Hz	220 V
913713019559	BSNE 400L 300I TS	50 Hz	220 V

System characteristics

Order Code	Full Product Name	Rated Ballast-Lamp Power
913710100859	BSN 250L 427I TS	250 W
913710102016	BSN 150L 301I	150 W
913710102116	BSN 250L 301I	250 W
913710102143	BSN 250L 301I TS	250 W
913710102250	BSN 150L 301I TS	150 W
913710102850	BSN 250L 302I	250 W
913710102950	BSN 400L 301I	400 W
913710103750	BSN 100L 300I	100 W
913710104550	BSN 70L 300I	70 W
913710104643	BSN 70L 301I	70 W
913710105942	BSN 600L 300I TS	600 W

Order Code	Full Product Name	Rated Ballast-Lamp Power
913710106842	BSN 100L 300I TS	100 W
913710106942	BSN 70L 300I TS	70 W
913710109142	BSN 150L 300I TS	150 W
913710109342	BSN 250L 300I TS	250 W
913710109542	BSN 400L 300I TS	400 W
913713206016	BSN 70L 301I	70 W
913713206116	BSN 50L 301I	50 W
913713019359	BSNE 150L 300I TS	150 W
913713019459	BSNE 250L 300I TS	250 W
913713019559	BSNE 400L 300I TS	400 W

