



Get your city ready for the future with DigiStreet

DigiStreet Catenary

Philips DigiStreet Catenary is a new member of the DigiStreet Road & Street family, and it enables you to benefit from the same lighting quality, distinctive design and the advantages of connected lighting systems in applications requiring catenary solutions. Supporting Smart City initiatives, the full DigiStreet range can be equipped with two System Ready (SR) sockets to enable your city to opt in for existing and future controls, sensors and applications such as the Philips CityTouch remote light management system. In addition, each individual luminaire is uniquely identifiable, thanks to the Philips Service tag, which is based on QR coding. With a simple scan of the QR code, which is located on the inside of the mast door, you gain instant access to the luminaire configuration, making maintenance and programming operations faster and easier, throughout the luminaire's entire lifetime.

Benefits

- Prepared for the future, DigiStreet Catenary is easy to upgrade directly after installation or later with future CMS nodes and sensors to enable new functionalities
- Dedicated optics to match international road and street geometries
- Equipped with Service tag, a QR-based identification system that makes each luminaire uniquely identifiable and provides maintenance, installation and spare part information

Features

- Catenary solution within the DigiStreet Road & street family
- Option to equip with two SR sockets for easy upgradability to new functionalities
- Easy luminaire identification due to the Philips Service tag
- L-tune tool available
- Lifetime 100Khrs up to L96 at Tq +25 °C

DigiStreet Catenary

Application

- Traffic routes and main access roads
- Urban areas
- City centers and main streets

Versions



DigiStreet Catenary-BTP764



DigiStreet Suspended-BSP764

Dimensional drawing

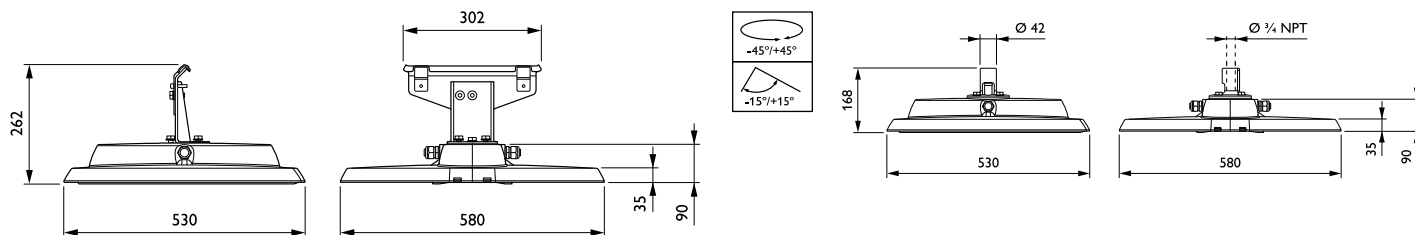

Product details



DigiStreet_Catenary-
BTP764-1DPP.tif



DigiStreet_Catenary-
BTP764-2DPP.tif

Product details



DigiStreet_Catenary-
BTP764-3DPP.tif



DigiStreet_Catenary-
BTP764-4DPP.tif



DigiStreet_Catenary-
BTP764-5DPP.tif



DigiStreet_Catenary-
BTP764-6DPP.tif



DigiStreet_Suspended-
BSP764-1DPP.tif



DigiStreet_Suspended-
BSP764-2DPP.tif

General Information

CE mark	Yes
Driver included	Yes
Flammability mark	For mounting on normally flammable surfaces
Lamp family code	LED64
Light source replaceable	Yes
Number of gear units	1 unit

Light Technical

Light source color	740 neutral white
Correlated Color Temperature (Nom)	4000 K
Optical cover type	Flat glass
Color rendering index (CRI)	70
Luminous Flux	6,400 lm
Standard tilt angle side entry	-
Standard tilt angle posttop	-
Upward light output ratio	0

Operating and Electrical

Power Consumption	38 W
-------------------	------

Controls and Dimming

Dimmable	Yes
----------	-----

Mechanical and Housing

Housing Color	Aluminum
---------------	----------

Approval and Application

Mech. impact protection code	IK09
Ingress protection code	IP66
Surge Protection (Common/Differential)	Luminaire surge protection level until 6 kV differential mode and 6 kV common mode

Application Conditions

Maximum dim level	10%
-------------------	-----

General Information

Order Code	Full Product Name	Product family code
912300023969	BTP764 LED64-4S/740 DSW1 PSD-SR SRT SRB	BTP764
912300023970	BSP764 LED64-4S/740 DW10 PSD-SR SRT SRB	BSP764

Light Technical

Order Code	Full Product Name	Luminaire light beam spread	Optic type outdoor
912300023969	BTP764 LED64-4S/740 DSW1 PSD-SR SRT SRB	-	Distribution symmetrical wide 1

Order Code	Full Product Name	Luminaire light beam spread	Optic type outdoor
912300023970	BSP764 LED64-4S/740 DW10 PSD-SR SRT SRB	52° - 7° x 151°	Distribution wide 10

