

# PHILIPS

## CoreLine SlimDown light

DN145



DN145B

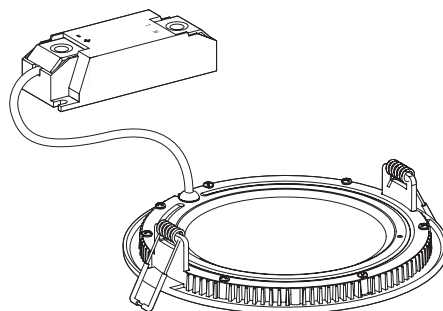

220 V  
240 V

50Hz  
60Hz

LED s

IK02

Ta  
25 °C

Max.  
35 °C  
Min.  
0 °C

GLOW  
WIRE  
650 °C



	System lumen (lm)	CCT (K)	Driver	P (W)	Ø mm	kg
DN145B LED20S	2100	3000/4000	IA1	22,5	203-208	0,65
DN145B LED10S	1100		PSD-E	13	152-157	0,45
DN145B LED20S	2100			22,5	203-208	0,62

DN145B

Dimensions in mm

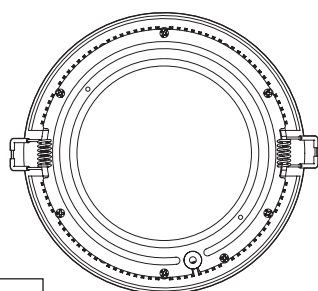

	1100 lm	2100 lm
A	166	217
B	200	200
C	72	72
D	32	32
E	152 - 157	203 - 208

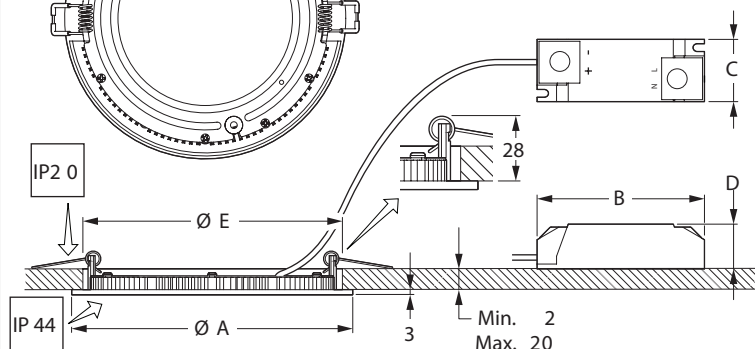

DN145B

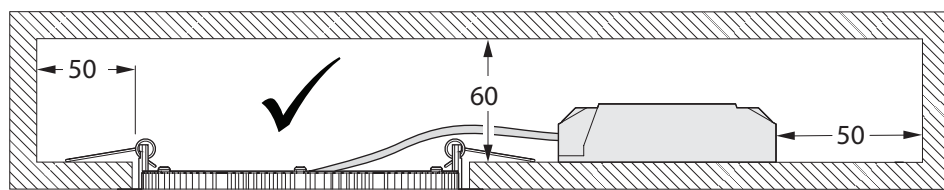
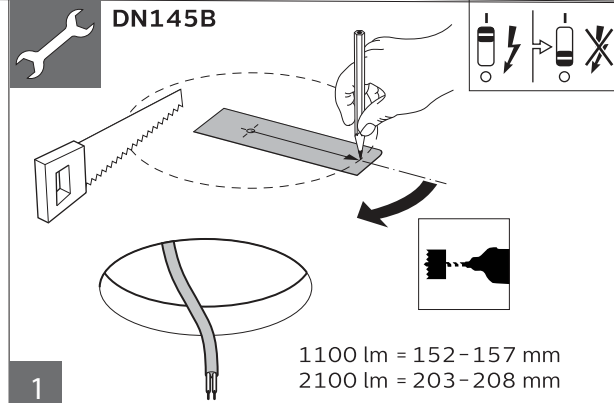

444316022141

© 2019 Signify Holding. All rights reserved

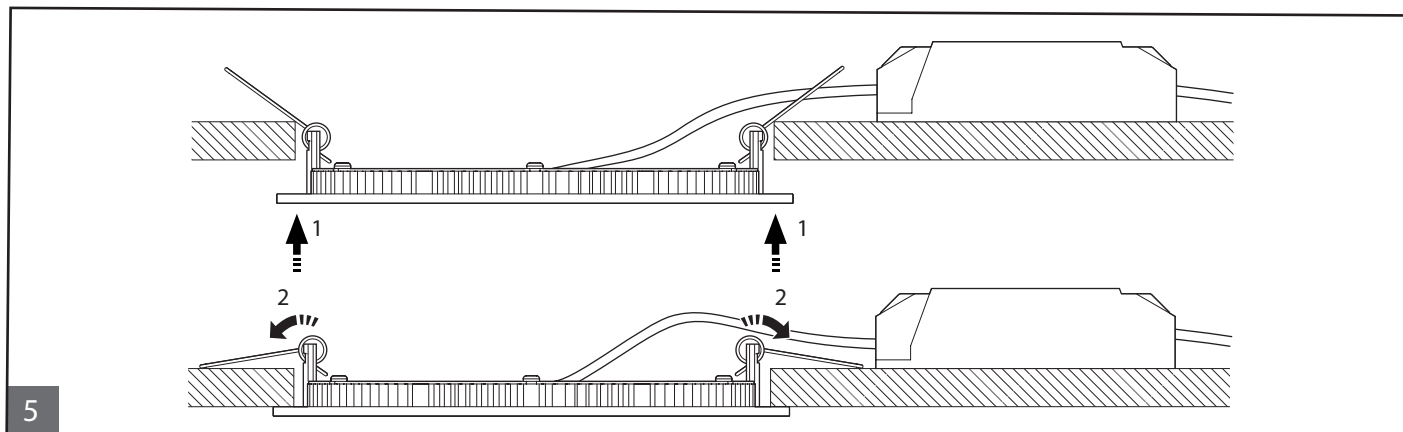
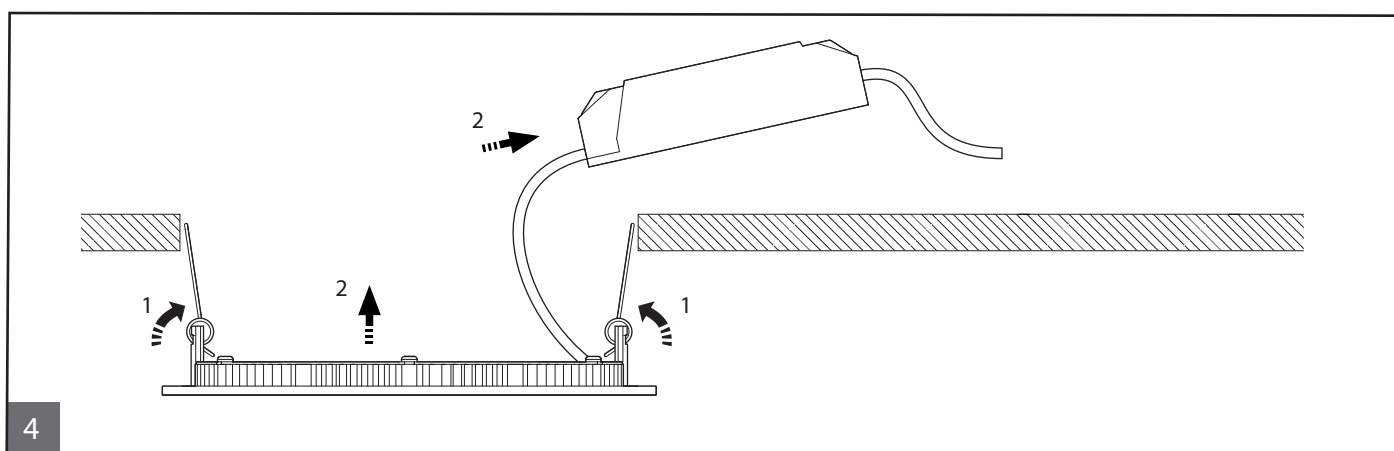
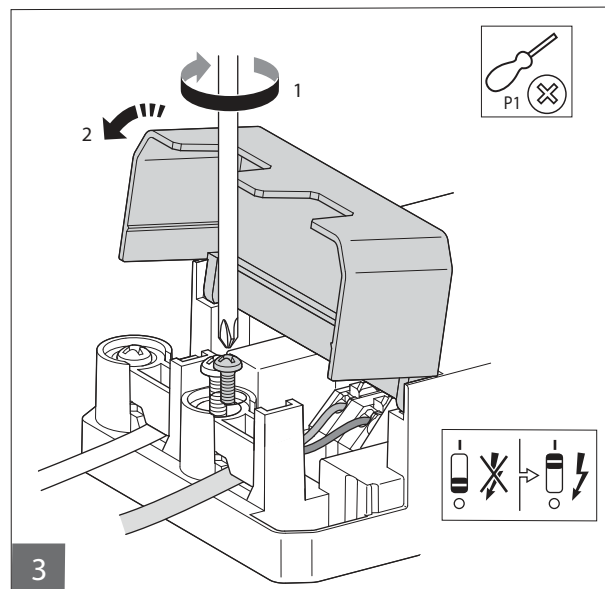
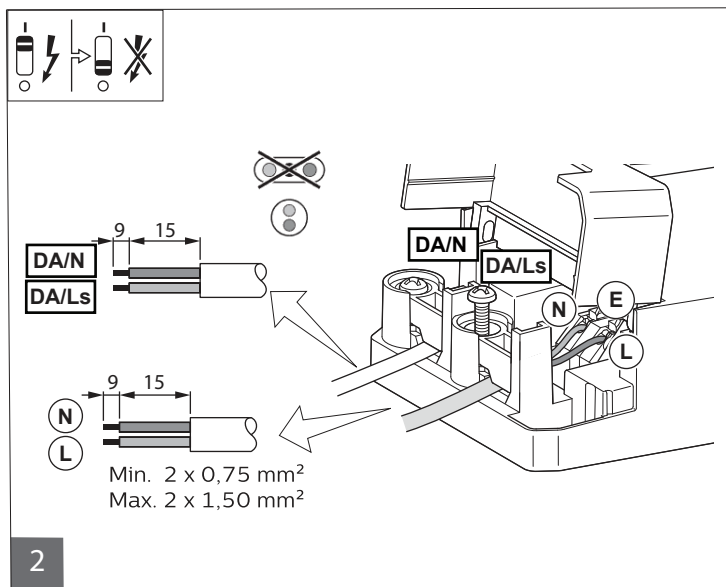

The light source contained in this luminaire shall only be replaced by the manufacturer or his service agent or a similar qualified person.

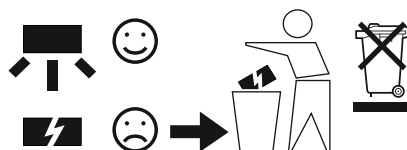

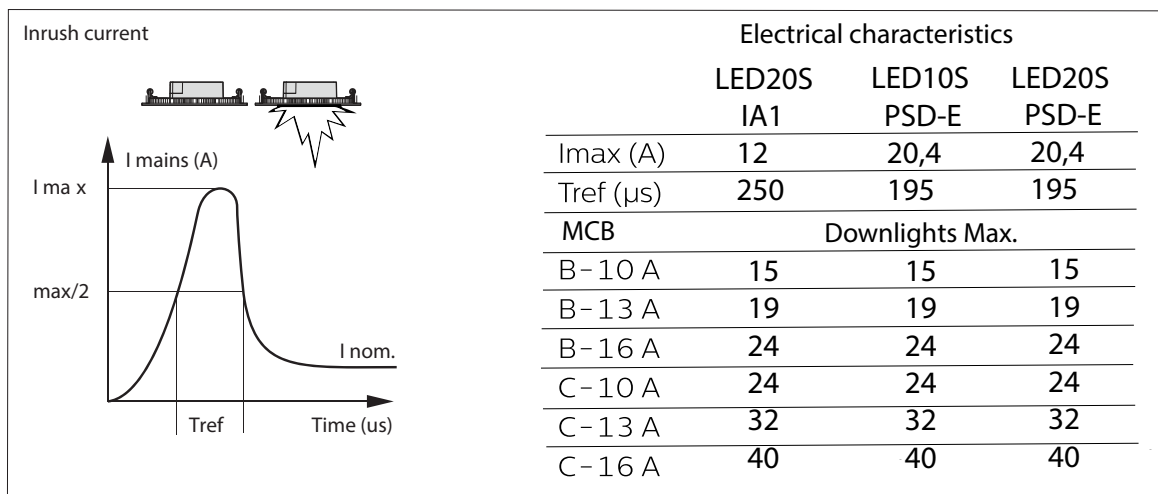

- The luminaire shall be installed by a qualified electrician and wired in accordance with the latest IEEE electrical regulations or the national requirements.
- If the external flexible cable or cord of this luminaire is damaged, it shall be exclusively replaced by the manufacturer or his service agent or a similar qualified person in order to avoid a hazard.



© 2018 Signify Holding

All rights reserved. This document contains information relating to the product portfolio of Signify which information may be subject to change. No representation or warranty as to the accuracy or completeness of the information included herein is given and any liability for any action in reliance thereon is disclaimed. The information presented in this document is not intended as any commercial offer and does not form part of any quotation or contract. Philips and the Philips Shield Emblem are registered trademarks of Koninklijke Philips N.V.. All other trademarks are owned by Signify Holding or their respective owners.

Signify Holding.  
The Netherlands