



Gardco PureForm LED area large P34 features a sleek, low profile design and optimal performance. PureForm area large is designed to achieve maximum pole spacing, with lumen output up to 50,000 lumens. Multiple distribution and shielding options are available to achieve maximum control. A full range of control options provides additional energy savings.

Project:	
Location:	
Cat.No:	
Type:	
Lumens:	Qty:
Notes:	

Ordering guide

Example: P34-96L-800-NW-G2-AR-5-120-F1-MGY

Prefix	Number of LEDs	Drive Current	LED Color - Generation	Mounting	Distribution	Voltage
P34						
P34 PureForm site and area, 34"	96L 96 LEDs (6 modules)	600 600mA ¹⁵	WW-G2 Warm White 3000K, 70 CRI Generation 2	AR Arm Mount (standard) ² <i>The following mounting kits must be ordered separately (See accessories)</i>	Type 2 2 Type 2 2-90 Rotated at 90° 2-270 Rotated at 270°	120 120V 208 208V 240 240V
		800 800mA	NW-G2 Neutral White 4000K, 70 CRI Generation 2			
		900 900mA				
	128L 128 LEDs (8 modules)	600 600mA ¹⁵	CW-G2 Cool White 5000K, 70 CRI Generation 2	SF Slip Fitter Mount ³ (fits to 2 3/8" O.D. tenon)	Type 3 3 Type 3 3-90 Rotated at 90° 3-270 Rotated at 270°	277 277V 347 347V 480 480V UNV 120-277V (50/60Hz) HVU 347-480V (50/60Hz)
			WY-G2 Warm Yellow 2700K, 80 CRI Generation 2 ¹			
			BW-G2 Balanced White 3500K (80 CRI) Generation 2 ¹			
		900 900mA	AM-G2 Direct Amber (590nm) Generation 2 ^{1, 15}	WS Wall mount with surface conduit rear entry permitted RAM Retrofit arm mount kit ²	Type 4 4 Type 4 4-90 Rotated at 90° 4-270 Rotated at 270°	5 Type 5 5W Type 5W AFR Auto Front Row AFR-90 Auto Front Row, rotated at 90° AFR-270 Auto Front Row, rotated at 270° BLC Back Light Control BLC-90 Back Light Control rotated at 90° BLC-270 Back Light Control rotated at 270°

Options						
Dimming controls		Motion sensing lens	Photo-sensing	Electrical	Luminaire	Finish
<div>DD0–10V External dimming (by others)^{4,5}</div> <div>DCCDual Circuit Control^{4,5,6,14}</div> <div>FAWSField Adjustable Wattage Selector^{4,5}</div> <div>DynaDimmer: Automatic Profile Dimming</div> <div>CS50Security 50% Dimming, 7 hours^{4,7,20}</div> <div>CM50Median 50% Dimming, 8 hours^{4,7,20}</div> <div>CS30Security 30% Dimming, 7 hours^{4,7,20}</div> <div>CM30Median 30% Dimming, 8 hours^{4,7,210}</div>		<div>IMRI3Integral with #3 lens¹⁶</div>	<div>PCBPhotocontrol Button^{7,8}</div> <div>TLRD5Twist Lock Receptacle 5 Pin⁹</div> <div>TLRD7Twist Lock Receptacle 7 Pin⁹</div> <div>TLRPCTwist Lock Receptacle w/Photocell^{8,10}</div>	<div>Fusing</div> <div>F1Single (120, 277, 347VAC)⁸</div> <div>F2Double (208, 240, 480VAC)⁸</div> <div>F3Canadian Double Pull (208, 240, 480VAC)⁸</div> <div>Pole Mount Fusing</div> <div>FP1Single (120, 277, 347VAC)⁸</div> <div>FP2Double (208, 240, 480VAC)⁸</div> <div>FP3Canadian Double Pull (208, 240, 480VAC)⁸</div> <div>Surge Protection (10kA standard)</div> <div>SP2Increased 20kA</div>	<div>Square Pole Adapter included as standard</div> <div>TBTerminal Block¹¹</div> <div>RPARound Pole Adapter (fits to 3"– 3.9" O.D. pole)¹²</div> <div>HISInternal Housing Side Shield¹³</div>	<div>Textured</div> <div>BKBlack</div> <div>WHWhite</div> <div>BZBronze</div> <div>DGYDark Gray</div> <div>MGYMedium Gray</div> <div>Customer specified</div> <div>RALSpecify optional color or RAL (ex: RAL7024)</div> <div>CCCustom color (Must supply color chip for required factory quote)</div>
<div>BLBi-level functionality^{4,19}</div>		<div>IMRI7Integral with #7 lens¹⁷</div>	<div>1. Extended lead times apply. Contact factory for details.</div> <div>2. Mounts to a 4–5" round pole with adapter included for square poles.</div> <div>3. Limited to a maximum of 45 degrees aiming above horizontal.</div> <div>4. Not available with other dimming control options.</div> <div>5. Not available with motion sensor.</div> <div>6. Not available with photocontrol.</div> <div>7. Not available in 347 or 480V.</div> <div>8. Must specify input voltage.</div> <div>9. Dimming will not be connected to NEMA receptacle if ordering with other control options.</div> <div>10. Not available in 480V. Order photocell separately with TLRD5/7.</div>			<div>11. TB not available with DCC.</div> <div>12. Not available with SF and WS. RPAs provided with black finish standard.</div> <div>13. HIS not available with Type 5, 5W, and BLC optics.</div> <div>14. Not available with 96L (6 modules).</div> <div>15. Amber LEDs (AM) available only in 600mA.</div> <div>16. Not available with DD, DCC, and FAWS dimming control options.</div> <div>17. Not available with DD, DCC, FAWS dimming control options.</div> <div>18. Not available with DD, DCC, FAWS, and BL dimming control options (DynaDimmer required).</div> <div>19. Must specify a motion sensor lens.</div> <div>20. Not available with 128L 1050mA.</div>
<div>WIAP^{4,19}Wireless Interact (includes SR driver and SR receptacle)</div>		<div>LB(7'–15' mounting height) sensor, Black color housing Wireless Interact, integral</div> <div>LW(7'–15' mounting height) sensor, White color housing</div> <div>HB(15'–40' mounting height) sensor, Black color housing</div> <div>HW(15'–40' mounting height) sensor, White color housing Interact, integral</div>				

P34 PureForm LED large Area light

PureForm P34 Accessories² (ordered separately, field installed)

Shielding Accessories

House Side Shield

Standard optic orientation	
HIS-96-H ¹	Internal House Side Shield for 96 LEDs (6 modules)
HIS-128-H ¹	Internal House Side Shield for 128 LEDs (8 modules)
Optic at 90 or 270 orientation	
HIS-96-V ¹	Internal House Side Shield for 96 LEDs (6 modules)
HIS-128-V ¹	Internal House Side Shield for 128 LEDs (8 modules)

Footnotes
1. HIS not available with Type 5, 5W, and BLC optics.
2. Consult Signify to confirm whether specific accessories are BAA-compliant.

Controls Accessories

BL Optional Remote Programming Tool	
FSIR-100	
IRT9015	Handheld remote for grouping and configuration of Wireless Interact WIAP (at least 1 required per site or use the Interact Pro App).

Pole Top Fitters

(F) = Specify finish

PTF2 – Pole top fitter fits 23/8-21/2" OD x 4" depth tenon	
PTF2-1-90-(F)	1 luminaire at 90°
PTF2-2-90-(F)	2 luminaires at 90°
PTF2-2-180-(F)	2 luminaires at 180°
PTF2-3-90-(F)	3 luminaires at 90°
PTF2-4-90-(F)	4 luminaires at 90°
PTF2-3-120-(F)	3 luminaires at 120°
PTF3 – Pole top fitter fits 3-31/2" OD x 6" depth tenon	
PTF3-1-90-(F)	1 luminaire at 90°
PTF3-2-90-(F)	2 luminaires at 90°
PTF3-2-180-(F)	2 luminaires at 180°
PTF3-3-90-(F)	3 luminaires at 90°
PTF3-4-90-(F)	4 luminaires at 90°
PTF3-3-120-(F)	3 luminaires at 120°

Mounting Accessories

(F) = Specify finish

P34-SF-G2-(F)	Slip Fitter Mount (fits to 2 3/8" O.D. tenon)
P34-RAM-G2-(F)	Retrofit Arm mount kit
P34-WS-G2-(F)	Wall mount with surface conduit rear entry permitted
P34-BD-G2	Bird deterrent

P34 PureForm LED large

Area light

LED Wattage and Lumen Values – 3000K

Ordering Code	Total LEDs	LED Current (mA)	Color Temp.	Average System Watts	Type 2			Type 3			Type 4		
					Lumen Output	BUG Rating	Efficacy (LPW)	Lumen Output	BUG Rating	Efficacy (LPW)	Lumen Output	BUG Rating	Efficacy (LPW)
P34-96L-800-WW-G2-x	96	800	3000	232	26591	B3-U0-G3	115	26039	B3-U0-G4	112	26627	B3-U0-G4	115
P34-96L-900-WW-G2-x	96	900	3000	263	29373	B4-U0-G3	112	28763	B3-U0-G4	110	29412	B3-U0-G4	112
P34-96L-1050-WW-G2-x	96	1050	3000	310	32791	B4-U0-G4	106	32110	B3-U0-G5	104	32835	B3-U0-G5	106
P34-128L-900-WW-G2-x	128	900	3000	350	38325	B4-U0-G4	110	37530	B3-U0-G5	107	38377	B3-U0-G5	110

Ordering Code	Total LEDs	LED Current (mA)	Color Temp.	Average System Watts	Type 5			Type 5W			Type AFR			Type BLC		
					Lumen Output	BUG Rating	Efficacy (LPW)	Lumen Output	BUG Rating	Efficacy (LPW)	Lumen Output	BUG Rating	Efficacy (LPW)	Lumen Output	BUG Rating	Efficacy (LPW)
P34-96L-800-WW-G2-x	96	800	3000	232	27785	B5-U0-G3	120	27119	B5-U0-G4	117	27643	B4-U0-G3	119	20034	B1-U0-G4	86
P34-96L-900-WW-G2-x	96	900	3000	263	30692	B5-U0-G4	117	29956	B5-U0-G4	114	30535	B4-U0-G3	116	22130	B1-U0-G4	84
P34-96L-1050-WW-G2-x	96	1050	3000	310	34264	B5-U0-G4	111	33442	B5-U0-G4	108	34089	B4-U0-G3	110	24706	B1-U0-G4	80
P34-128L-900-WW-G2-x	128	900	3000	350	40047	B5-U0-G4	115	39087	B5-U0-G4	112	39842	B4-U0-G4	114	28876	B1-U0-G4	83

LED Wattage and Lumen Values – 4000K

Ordering Code	Total LEDs	LED Current (mA)	Color Temp.	Average System Watts	Type 2			Type 3			Type 4		
					Lumen Output	BUG Rating	Efficacy (LPW)	Lumen Output	BUG Rating	Efficacy (LPW)	Lumen Output	BUG Rating	Efficacy (LPW)
P34-96L-800-NW-G2-x	96	800	4000	232	29545	B4-U0-G3	128	28932	B3-U0-G4	125	29585	B3-U0-G4	128
P34-96L-900-NW-G2-x	96	900	4000	263	32636	B4-U0-G4	124	31959	B3-U0-G4	122	32680	B3-U0-G5	124
P34-96L-1050-NW-G2-x	96	1050	4000	310	36434	B4-U0-G4	118	35678	B3-U0-G5	115	36483	B3-U0-G5	118
P34-128L-900-NW-G2-x	128	900	4000	350	42584	B4-U0-G4	122	41700	B4-U0-G5	119	42641	B3-U0-G5	122

Ordering Code	Total LEDs	LED Current (mA)	Color Temp.	Average System Watts	Type 5			Type 5W			Type AFR			Type BLC		
					Lumen Output	BUG Rating	Efficacy (LPW)	Lumen Output	BUG Rating	Efficacy (LPW)	Lumen Output	BUG Rating	Efficacy (LPW)	Lumen Output	BUG Rating	Efficacy (LPW)
P34-96L-800-NW-G2-x	96	800	4000	232	30872	B5-U0-G4	133	30131	B5-U0-G4	130	30715	B4-U0-G3	133	22261	B1-U0-G4	96
P34-96L-900-NW-G2-x	96	900	4000	263	34102	B5-U0-G4	130	33284	B5-U0-G4	127	33928	B4-U0-G3	129	24589	B1-U0-G4	94
P34-96L-1050-NW-G2-x	96	1050	4000	310	38071	B5-U0-G4	123	37157	B5-U0-G4	120	37877	B4-U0-G3	122	27451	B1-U0-G4	89
P34-128L-900-NW-G2-x	128	900	4000	350	44497	B5-U0-G4	127	43429	B5-U0-G5	124	44269	B4-U0-G4	127	32084	B1-U0-G5	92

LED Wattage and Lumen Values – 5000K

Ordering Code	Total LEDs	LED Current (mA)	Color Temp.	Average System Watts	Type 2			Type 3			Type 4		
					Lumen Output	BUG Rating	Efficacy (LPW)	Lumen Output	BUG Rating	Efficacy (LPW)	Lumen Output	BUG Rating	Efficacy (LPW)
P34-96L-800-CW-G2-x	96	800	5000	232	28659	B4-U0-G3	124	28064	B3-U0-G4	121	28697	B3-U0-G4	124
P34-96L-900-CW-G2-x	96	900	5000	263	31657	B4-U0-G3	121	31000	B3-U0-G4	118	31700	B3-U0-G5	121
P34-96L-1050-CW-G2-x	96	1050	5000	310	35341	B4-U0-G4	114	34608	B3-U0-G5	112	35389	B3-U0-G5	114
P34-128L-900-CW-G2-x	128	900	5000	350	41306	B4-U0-G4	118	40449	B3-U0-G5	116	41362	B3-U0-G5	118

Ordering Code	Total LEDs	LED Current (mA)	Color Temp.	Average System Watts	Type 5			Type 5W			Type AFR			Type BLC		
					Lumen Output	BUG Rating	Efficacy (LPW)	Lumen Output	BUG Rating	Efficacy (LPW)	Lumen Output	BUG Rating	Efficacy (LPW)	Lumen Output	BUG Rating	Efficacy (LPW)
P34-96L-800-CW-G2-x	96	800	5000	232	29946	B5-U0-G4	129	29228	B5-U0-G4	126	29793	B4-U0-G3	129	21593	B1-U0-G4	93
P34-96L-900-CW-G2-x	96	900	5000	263	33079	B5-U0-G4	126	32286	B5-U0-G4	123	32910	B4-U0-G3	125	23852	B1-U0-G4	91
P34-96L-1050-CW-G2-x	96	1050	5000	310	36929	B5-U0-G4	119	36043	B5-U0-G4	116	36740	B4-U0-G3	118	26628	B1-U0-G4	86
P34-128L-900-CW-G2-x	128	900	5000	350	43161	B5-U0-G4	123	42127	B5-U0-G5	120	42941	B4-U0-G4	123	31122	B1-U0-G5	89

Values from photometric tests performed in accordance with IESNA LM-79 and are representative of the configurations shown. Actual performance may vary due to installation and environmental variables, LED and driver tolerances, and field measurement considerations. It is highly recommended to confirm performance with a photometric layout.

NOTE: Some data may be scaled based on tests of similar (but not identical) luminaires. Contact factory for configurations not shown.

Predicted Lumen Depreciation Data

Predicted performance derived from LED manufacturer's data and engineering design estimates, based on IESNA LM-80 methodology. Actual experience may vary due to field application conditions. L₇₀ is the predicted time when LED performance depreciates to 70% of initial lumen output. Calculated per IESNA TM21-11. Published L₇₀ hours limited to 6 times actual LED test hours

Ambient Temperature °C	Driver mA	Calculated L ₇₀ Hours	L ₇₀ per TM-21	Lumen Maintenance % at 60,000 hrs
25°C	up to 1050 mA	>100,000 hours	>54,000 hours	>89%

P34 PureForm LED large

Area light

Optical Distributions

Based on configuration P34-128L-1050-NW-G2 (414W) mounted at 40ft.

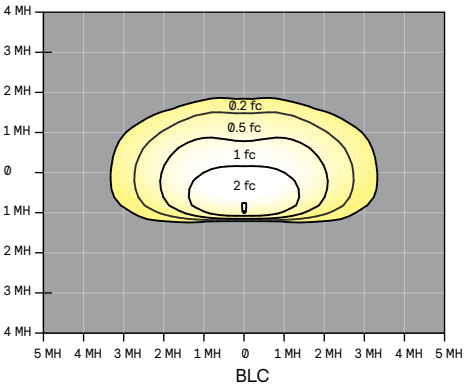
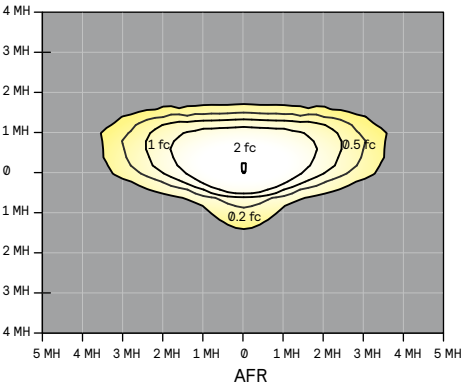
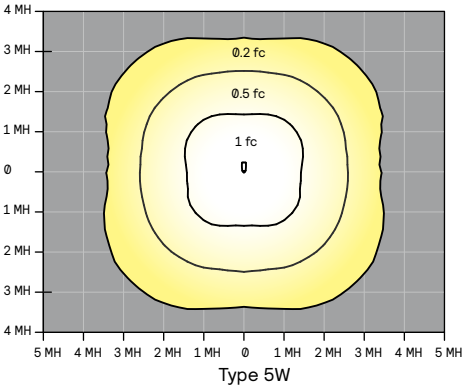
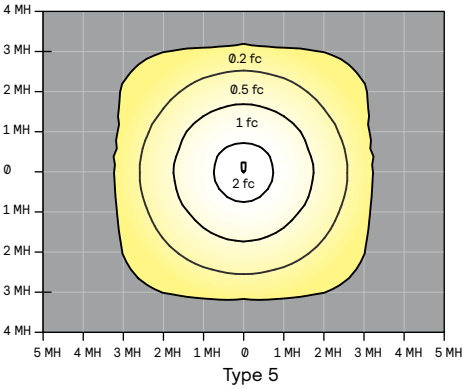
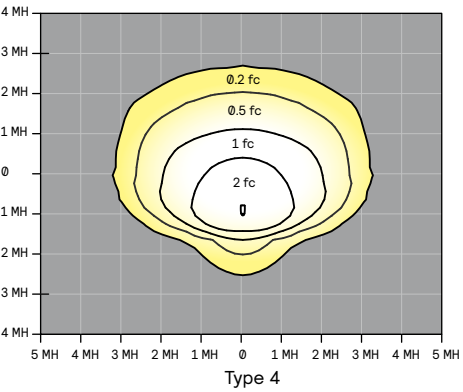
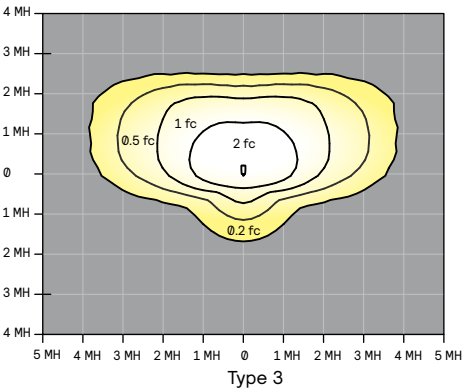
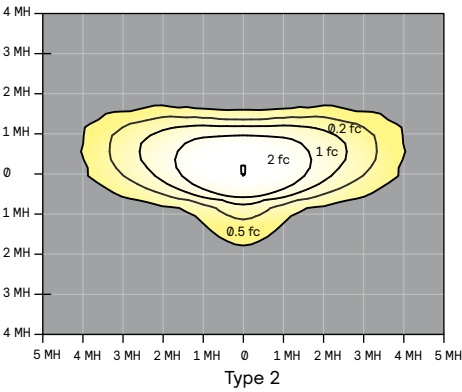

P34 PureForm LED large

Area light

Dimensions

Standard Arm (AR)

Weight: 35 Lbs (15.8 Kg) EPA: 0.30ft² (.028m²)

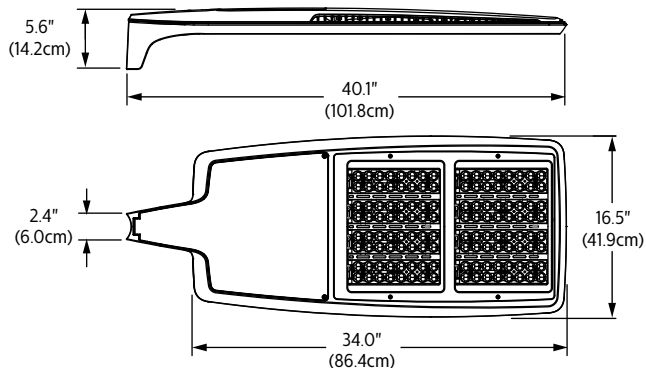

Wall (WS)

Weight: 37 Lbs. (16.8Kg) EPA: 0.35ft² (.033m²)

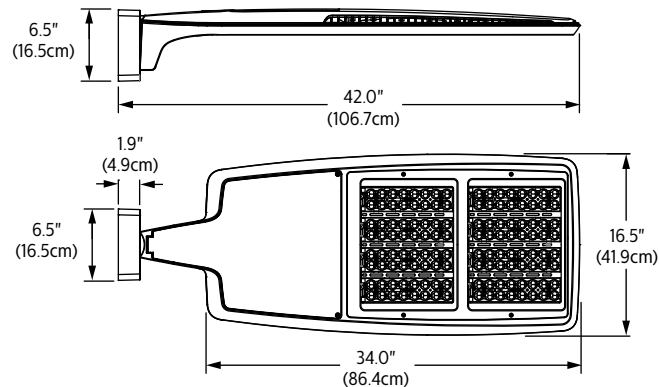

Retrofit Arm (RAM)

Weight: 39 Lbs (17.7 Kg) EPA: 0.33ft² (.031m²)

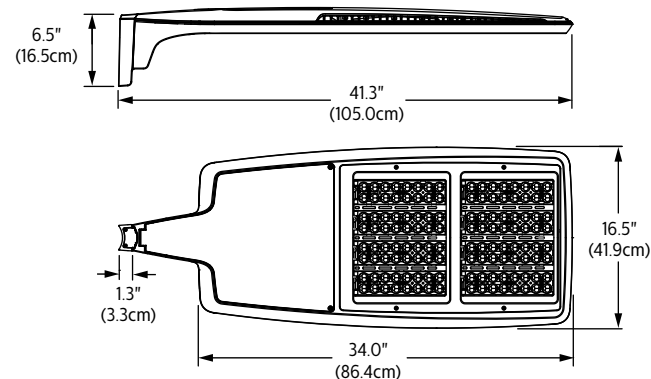

Slip fitter (SF)

Weight: 40 Lbs (18.1 Kg) EPA: 0.43ft² (.040m²)

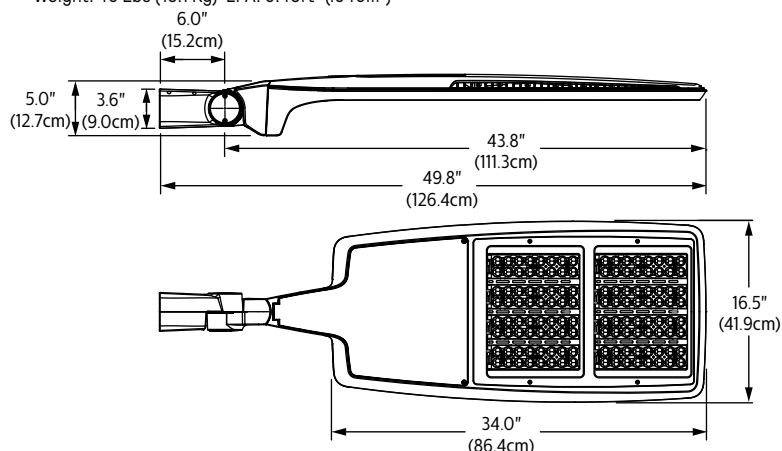

6 module configuration

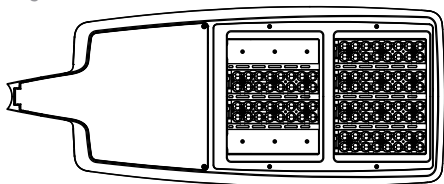

Standard Arm (AR) drill pattern

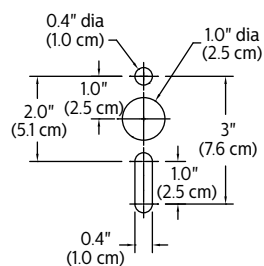

Retrofit arm (RAM) drill pattern

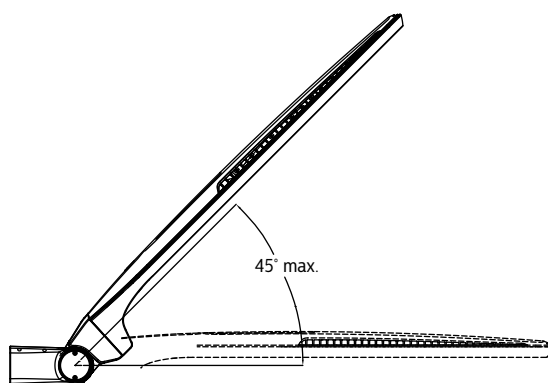
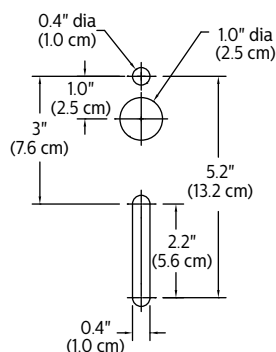

P34 PureForm LED large

Area light

Specifications

Housing

Two-piece sealed enclosure with main part of the housing designed as the structural and heat sink frame enclosed by cover to give its unique form. It also includes heat sinks, integral arm and separate, self-retained hinged, one-piece die cast door frame. All die-cast parts made of low copper die cast aluminum alloy for a high resistance to corrosion. The sleek profile with optimized surface area allows housing to provide excellent convection heat transfer with minimum use of heat fins, giving the freedom to have a clean minimalist aesthetic design. Luminaire housing rated to IP65, tested in accordance to Section 9 of IEC 60598-1.

Vibration resistance

Luminaire is tested and rated 1.5G over 100,000 cycles conforming to standards set forth by ANSI C136.31-2010. Testing includes vibration to 1.5G acceleration in three axes, all performed on the same luminaire.

Light engine

Light engine comprises of a module of 16-LED aluminum metal clad board fully sealed with optics offered in multiples of 6 and 8 modules or 96 and 128 LEDs. Module is RoHS compliant. Color temperatures: 3000K +/- 125K, 4000K, 5000K +/- 200K. Minimum CRI of 70. Also available in 2700K, 3500K, and Direct Amber with extended lead times. Direct Amber LED is narrow spectrum with dominant wavelength at 596 nm (peak wavelength at 601 nm). Contact factory for details. LED light engine is rated IP66 in accordance to Section 9 of IEC 60598-1.

Energy saving benefits

System efficacy up to 129 lms/W with significant energy savings over Pulse Start Metal Halide luminaires. Optional control options provide added energy savings during unoccupied periods.

Optical systems

Type 2, 3, 4, 5, 5W, and AFR distributions available. Internal Shield option mounts to LED optics and is available with Type 2, 3, 4, and AFR distributions including a dedicated BLC optic to provide the best backlight control possible for those stringent requirements around property lines. Types 2, 3, 4, AFR, and BLC when specified and used as rotated, are factory set only. Performance tested per LM-79 and TM-15 (IESNA) certifying its photometric performance. Luminaire designed with 0% uplight (U0 per IESNA TM-15).

Mounting

Standard luminaire arm mounts to 4" O.D. round poles. Can also be used with 5" O.D. poles. Square pole adapter included with every luminaire. Round Pole Adapter (RPA) required for 3-3.9" poles. PureForm features a retrofit arm kit. When specified with the retrofit arm (RAM) option, PureForm seamlessly simplifies site conversions to LED by eliminating the need for additional pole drilling on most existing poles. RAM will be boxed separately. Also optional are slipfitter and wall mounting accessories. Note that only fixed mounts (AR, RAM, WS) are required to meet IDA compliance. SF mounting will not meet IDA.

Control options

0-10V dimming (DD): Access to 0-10V dimming leads supplied through back of luminaire (for secondary dimming controls by others). Cannot be used with other control options.

Dual Circuit Control (DCC): Luminaire equipped with the ability to have two separate circuits controlling drivers and light engines independently. Permits separate switching of separate modules controlled by use of two sets of leads, one for each circuit. Not recommended to be used with other control options, motion response, or photocells.

Field Adjustable Wattage Selector (FAWS): Luminaire equipped with the ability to manually adjust the wattage in the field to reduce total luminaire lumen output and light levels. Comes pre-set to the highest position at the lumen output selected. Use chart below to estimate reduction in lumen output desired. Cannot be used with other control options or motion response.

FAWS Position	Percent of Typical Lumen Output
1	25%
2	50%
3	55%
4	65%
5	75%

FAWS Position	Percent of Typical Lumen Output
6	80%
7	85%
8	90%
9	95%
10	100%

Note: Typical value accuracy +/- 5%

Automatic Profile Dimming (CS/CM/CE/CA): Standard dimming profiles provide flexibility towards energy savings goals while optimizing light levels during specific dark hours. Dimming profiles include two dimming settings including dim to 30% or 50% of the total lumen output. When used in combination with not programmed motion response it overrides the controller's schedule when motion is detected. After 5 minutes with no motion, it will return to the automatic dimming profile schedule. Automatic dimming profile scheduled with the following settings:

- CS50/CS30:** Security for 7 hours night duration (Ex., 11 PM - 6 AM)
- CM50/CM30:** Median for 8 hours night duration (Ex., 10 PM - 6 AM)

All above profiles are calculated from mid point of the night. Dimming is set for 6 hours after the mid point and 1 or 2 hours before depending of the duration of dimming. Cannot be used with other dimming control options.

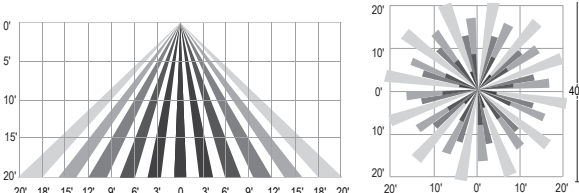

Motion response options

Bi-Level Infrared Motion Response (BL-IMRI): Motion Response module is mounted integral to luminaire factory pre-programmed to 50% dimming when not ordered with other control options. BL-IMRI is set/operates in the following fashion: The motion sensor is set to a constant 50%. When motion is detected by the PIR sensor, the luminaire returns to full power/light output. Dimming on low is factory set to 50% with 5 minutes default in "full power" prior to dimming back to low. When no motion is detected for 5 minutes, the motion response system reduces the wattage by 50%, to 50% of the normal constant wattage reducing the light level. Other dimming settings can be provided if different dimming levels are required. This can also be done with FSIR-100 Wireless Remote Programming Tool (contact Technical Support for details).

Infrared Motion Response Lenses (IMRI3/IMRI7): Infrared Motion Response Integral module is available with two different sensor lens types to accommodate various mounting heights and occupancy detection ranges. Lens #3 (IMRI3) is designed for mounting heights up to 20' with a 40' diameter coverage area. Lens #7 is designed for higher mounting heights up to 40' with larger coverage areas up to 100' diameter coverage area. See charts for approximate detection patterns:

IMRI3 Luminaire with #3 lens

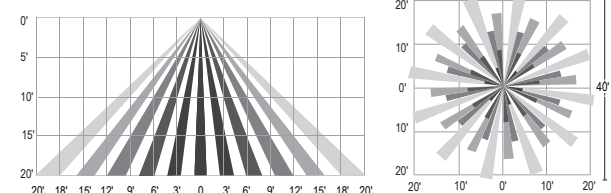

IMRI7 Luminaire with #7 lens

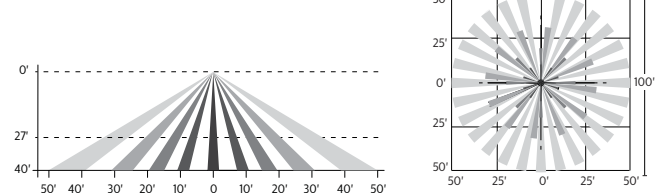

P34 PureForm LED large

Area light

Specifications (cont'd)

Outdoor Interact (WIAP): Connected sensor with integral occupancy and daylight sensing, supports wireless mesh connectivity. Sensor works in the standalone mode when configured without a gateway. When used with a gateway you are able to access additional functionalities such as energy monitoring, scheduling and BMS integration. Interact offers an App, a portal and a broad portfolio of Interact-ready Indoor and Outdoor luminaires, lamps and retrofit kits all working on the same system. The App provides flexibility to choose between a standalone or gateway mode. Setup with the gateway requires wired Internet access to the gateway. WIAP includes SR driver and SR receptacle. Daylight harvesting supported through dimming – activated via the Interact App. Sensors IP66 rated.

For more information on Interact Pro visit: www.interact-lighting.com/interactproscalablesystem

LB or LW low sensor

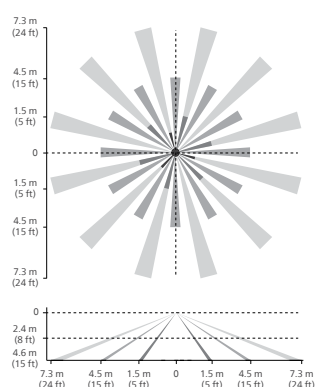

HB or HW high sensor

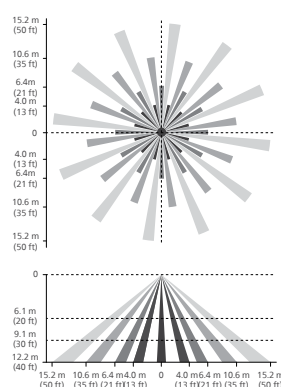

Note: The beam patterns shown are intended solely as a general guide and are not to scale. Sensing capabilities and coverage area depend on many factors including the size, speed and direction of travel of persons and vehicles; sensor mounting height; environmental and site conditions; etc.

Electrical

Twist-Lock Receptacle (TLRD5/TLRD7/ TLRPC): Twist Lock Receptacle with 5 pins enabling dimming or with 7 pins with additional functionality (by others) can be used with a twistlock photoelectric cell or a shorting cap. Dimming Receptacle Type B (5-pin) and Type D-24 (7-pin) in accordance to ANSI C136.41. Can be used with third-party control system. Receptacle located on top of luminaire housing. When specifying receptacle with twistlock photoelectric cell, voltage must be specified. When ordering Twist-lock receptacle (TLRD5 or TLRD7), photocell or shorting cap is not included. TLRPC is shipped standard with 5 pin.

Driver: Driver efficiency (>90% standard). 120-480V available (restrictions apply). Open/short circuit protection. Optional 0-10V dimming to 10% power. RoHS compliant.

Button Photocontrol (PCB): Button style design for internal luminaires mounting applications. The photocontrol is constructed of a high impact UV stabilized polycarbonate housing. Rated voltage of 120V or 208-277V with a load rating of 1000 VA. The photocell will turn on with 1-4Fc of ambient light.

Surge protection (SP1/SP2): Surge protection device tested in accordance with ANSI/IEEE C62.45 per ANSI/IEEE C62.41.2 Scenario I Category C High Exposure 10kV/10kA waveforms for Line-Ground, Line-Neutral and Neutral-Ground, and in accordance with DOE MSSLC Model Specification for LED Roadway Luminaires Appendix D Electrical Immunity High test level 10kV/10kA. 20kV / 10kA surge protection device that provides extra protection beyond the SP1 10kV/10kA level.

Listings

UL/cUL wet location listed to the UL 1598 standard, suitable for use in ambient temperatures from -40° to 40°C (-40° to 104°F). Most PureForm P34 configurations are qualified under Premium DesignLights Consortium® category. Consult DLC Qualified Products list to confirm your specific luminaire selection is approved. CCTs 3000K and warmer are Dark Sky Approved.

Finish

Each standard color luminaire receives a fade and abrasion resistant, electrostatically applied, thermally cured, triglycidyl isocyanurate (TGIC) textured polyester powdercoat finish. The surface treatment achieves a minimum of 1000 hours for salt spray resistant finish in accordance with testing performed and per ASTM B117 standard. Standard colors include bronze (BZ), black (BK), white (WH), dark gray (DGY), and medium gray (MGY). Consult factory for specs on optional or custom colors.

Warranty

PureForm luminaires feature a 5-year limited warranty. See signify.com/warranties for complete details and exclusions.

Buy American Act of 1933 (BAA):

This product is manufactured in one of our US factories and, as of the date of this document, this product was considered a commercially available off-the-shelf (COTS) item meeting the requirements of the BAA. This BAA designation hereunder does not address (i) the applicability of, or availability of a waiver under, the Trade Agreements Act, or (ii) the "Buy America" domestic content requirements imposed on states, localities, and other non-federal entities as a condition of receiving funds administered by the Department of Transportation or other federal agencies. Prior to ordering, please visit www.signify.com/baa to view a current list of BAA-compliant products to confirm this product's current compliance.

