



SmartBright LED Floodlight

BVP172 LED43/CW 50W WB GREY SAA KC

LED module 4300 lm

The SmartBright LED Floodlight is a versatile floodlight engineered to deliver significant energy savings, an ideal solution for diverse floodlighting applications. The product is also designed to meet relevant performance and safety standards, offering you reliable and long-lasting performance.

Product data

General Information	
Lamp family code	LED43 [LED module 4300 lm]
Lamp colour code	757 cool white
Light source replaceable	No
Driver included	Yes
Optical cover/lens type	PC-UV [Polycarbonate bowl/cover UV-resistant]
Luminaire light beam spread	30° x 80°
Control interface	-
Connection	Flying leads/wires
Cable	Cord 0.6 m without plug
Protection class IEC	Safety class I (I)
Flammability mark	F [For mounting on normally flammable surfaces]
CE mark	CE mark
Constant light output	No
Number of products on MCB	40

LED engine type	LED
-----------------	-----

Operating and Electrical

Input voltage	220 to 240 V
Input frequency	50 or 60 Hz
Inrush current	2.9 A
Inrush time	0.000225 ms
Power factor (min.)	0.9

Controls and Dimming

Dimmable	No
----------	----

Mechanical and Housing

Housing material	Aluminum die-cast
Optical cover/lens material	Polycarbonate
Mounting device	MBA [Mounting bracket adjustable]
Optical cover/lens shape	Flat
Optical cover/lens finish	Frosted

SmartBright LED Floodlight

Overall length	270 mm
Overall width	202 mm
Overall height	38 mm
Effective projected area	0.054 m ²
Colour	Grey

Approval and Application

Ingress protection code	IP65 [Dust penetration-protected, jet-proof]
Mech. impact protection code	IK07 [2 J reinforced]
Surge protection (common/differential)	4/2 kV

Initial Performance (IEC Compliant)

Initial luminous flux	4300 lm
Luminous flux tolerance	+/-10%
Initial LED luminaire efficacy	86 lm/W
Lamp colour temperature	5700 K
Colour Rendering Index	>70
Initial chromaticity	SDCM<7
Initial input power	50 W

Power consumption tolerance	+/-10%
-----------------------------	--------

Application Conditions

Ambient temperature range	-40 to +45 °C
Maximum dimming level	Not applicable

Product Data

Full product code	871016332086199
Order product name	BVP172 LED43/CW 50W WB GREY SAA KC
EAN/UPC – product	8710163320861
Order code	911401674204
Local Code	BVP172CW50W
Numerator – quantity per pack	1
Numerator – packs per outer box	8
Material no. (12NC)	911401674204
Net weight (piece)	1.200 kg



Dimensional drawing

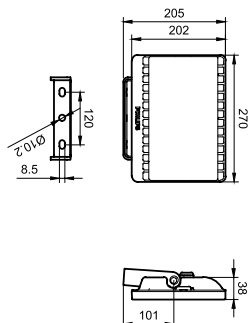

BVP171/172

