



# Greenspace Flex

## RS378B P15 940 PSU-E WB M55

Greenspace Flex, 15 W, 940 neutral white, 40°, Finger-protected

GreenSpace Flex is performance portfolio dedicated to Hospitality segment for GC/GM countries. With modular design concept, the light engines and different trims could have multiply of combination to satisfy diversified customer's requirement.

### Product data

General Information		Average CLO power consumption	
Number of gear units	1 unit	Average CLO power consumption	1170 W
Driver included	Yes	Power Consumption	15 W
Light source engine type	LED	Power Factor (Fraction)	0.9
CE mark	-	Connection	External connector
Warranty period	3 years	Cable	-
Glow-wire test	Temperature 600 °C, duration 30 s	Number of products on MCB of 16 A type B	-
EU RoHS compliant	Yes	<b>Temperature</b>	
<b>Light Technical</b>		Ambient temperature range	-20 to +45 °C
Luminous Flux	1,305 lm	<b>Controls and Dimming</b>	
Correlated Color Temperature (Nom)	4000 K	Dimmable	No
Luminous Efficacy (rated) (Nom)	87 lm/W	Driver/power unit/transformer	Electronic transformer
Color rendering index (CRI)	>90	Control interface	-
Light source color	940 neutral white	Constant light output	No
Optical cover type	-	<b>Mechanical and Housing</b>	
Luminaire light beam spread	40°	Housing Material	Aluminum Alloy
<b>Operating and Electrical</b>		Optic material	Polymethyl methacrylate
Input Voltage	220 to 240 V	Optical cover material	-
Line Frequency	50 or 60 Hz	Fixation material	Aluminum

# Greenspace Flex

Housing Color	Dark gray
Optical cover finish	-
Overall height	72 mm
Overall diameter	55 mm

## Approval and Application

Ingress protection code	IP20 [Finger-protected]
Mech. impact protection code	IK04 [0.5 J standard plus]
Protection class IEC	Safety class II

## Initial Performance (IEC Compliant)

Luminous flux tolerance	+/-10%
Initial chromaticity	SDCM<3
Power consumption tolerance	+/-10%

## Over Time Performance (IEC Compliant)

Median useful life L80B50	50,000 hour(s)
---------------------------	----------------

## Application Conditions

Maximum dim level	Not applicable
Suitable for random switching	No

## Product Data

Order product name	RS378B P15 940 PSU-E WB M55
Full product name	RS378B P15 940 PSU-E WB M55
Full product code	692382865013199
Order code	911401721332
Material Nr. (12NC)	911401721332
Numerator - Quantity Per Pack	1
EAN/UPC - Product/Case	6923828650131
Numerator - Packs per outer box	48
EAN/UPC - Case	6923828652548

## Dimensional drawing

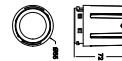
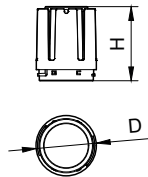

Modular Type	D, mm	H, mm
RS378B P6/P11 M55	55	49
RS378B P15 M55	55	49
RS378B P24 M70	70	90
RS378B P33 M87	87	107
RS378B P42 M102	102	116

