



# Greenperform Waterproof G2 - WT188C

## WT188C LED20 NW L1200 PSU MW

Greenperform Waterproof G2 - WT188C, 16 W, 2000 lm, 4000 K, 120°

Greenperform Waterproof G2 luminaire and its components are designed for both indoor and semi-outdoor application (anti-UV PC material housing and diffuser, stainless steel installation accessory). We design for friendly optical, energy saving, reliable quality, and easy wiring. Beyond that, GreenParking wireless motion detective system is ready to provide the maximum energy saving and new lighting experience to you.

### Product data

General Information		Light Technical	
Light source replaceable	No	Luminous Flux	2,000 lm
Number of gear units	1 unit	Correlated Color Temperature (Nom)	4000 K
Driver included	Yes	Luminous Efficacy (rated) (Nom)	125 lm/W
Light source engine type	LED	Color rendering index (CRI)	>80
CE mark	CE mark	Beam angle of light source	- degree(s)
Warranty period	3 years	Light source color	Neutral white
Flammability mark	-	Optic type	Symmetrical
ENEC mark	-	Optical cover type	Polycarbonate bowl/cover foggy
Glow-wire test	Temperature 750 °C, duration 5 s	Luminaire light beam spread	120°
EU RoHS compliant	Yes		

# Greenperform Waterproof G2 - WT188C

<b>Operating and Electrical</b>	
Input Voltage	220 to 240 V
Line Frequency	50 to 60 Hz
Inrush current	4 A
Inrush time	0.058 ms
Power Consumption	16 W
Power Factor (Fraction)	0.9
Connection	Flying leads/wires
Cable	Cable 0.2 m without plug
Number of products on MCB of 16 A type B 24	
<b>Temperature</b>	
Ambient temperature range	-30 to +45 °C
<b>Controls and Dimming</b>	
Dimmable	No
Driver/power unit/transformer	Power supply unit (On/Off)
Control interface	-
Constant light output	No
<b>Mechanical and Housing</b>	
Housing Material	Polycarbonate
Reflector material	Steel
Optic material	Polycarbonate
Optical cover material	Polycarbonate
Fixation material	Stainless steel
Housing Color	Gray and white
Optical cover finish	Opal
Overall length	1,177 mm
Overall width	84 mm
Overall height	83 mm

## Dimensional drawing

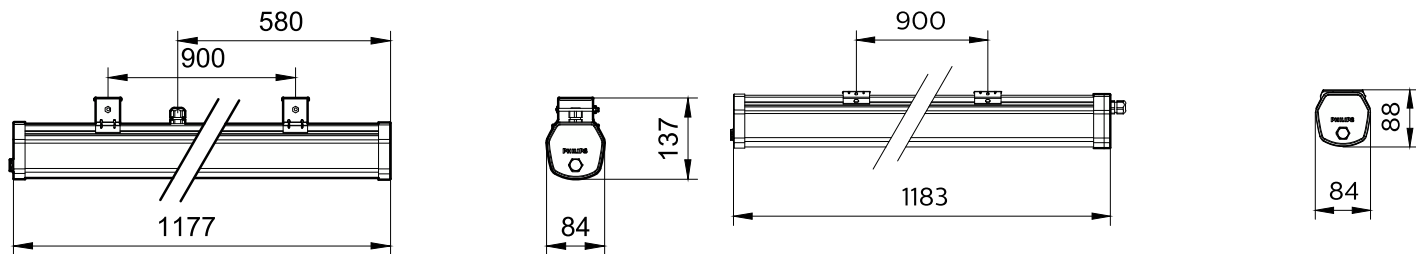

Dimensions (Height x Width x Depth)	83 x 84 x 1177 mm
<b>Approval and Application</b>	
Ingress protection code	IP65 [Dust penetration-protected, jet-proof]
Mech. impact protection code	IK08 [5 J vandal-protected]
Protection class IEC	Safety class I
<b>Initial Performance (IEC Compliant)</b>	
Luminous flux tolerance	+/-10%
Initial chromaticity	SDCM<5
Power consumption tolerance	+/-10%
<b>Over Time Performance (IEC Compliant)</b>	
Median useful life L70B50	50,000 h
Median useful life L80B50	45,000 h
Median useful life L90B50	35,000 h
<b>Application Conditions</b>	
Maximum dim level	Not applicable
<b>Product Data</b>	
Order product name	WT188C LED20 NW L1200 PSU MW
Full product name	WT188C LED20 NW L1200 PSU MW
Full product code	911401833297
Order code	911401833297
Material Nr. (12NC)	911401833297
Numerator - Quantity Per Pack	1
Numerator - Packs per outer box	1

## Greenperform Waterproof G2 - WT188C

