



Quebec LED

BRP776 LED16-4S/740 PSD DW50 PGR BK D9 S

QUEBEC LED - LED module 1600 lm - 4th generation, screw fixation - 740 neutral white - Power supply unit with DALI interface - Safety class I (I) - Distribution wide 50 - Flat glass - Black - Dimming via external communication DALI - Philips standard surge protection level kV - - - 25 °C - - - Side arm lateral

Quebec LED is a stylish luminaire designed to brighten up residential streets and pathways, precincts, parks and other urban spaces. It incorporates an energy-efficient LED engine with high-performance optics, while at the same time retaining the character of the original Quebec fixture. It also offers a choice of bowl versions and mounting options. All these factors together make Quebec LED a versatile solution that can meet the needs of any project.

Product data

General Information		Connection	Plug-in connector 3-pole Wieland/Adels compatible and 2x 2-pole control signal for light regulation
Lamp family code	LED16 [LED module 1600 lm]	Cable	-
Lamp version	4S [4th generation, screw fixation]	Protection class IEC	Safety class I (I)
Light source colour	740 neutral white	Flammability mark	NO [-]
Light source replaceable	Yes	CE mark	CE mark
Number of gear units	1 unit	ENEC mark	ENEC mark
Driver/power unit/transformer	PSD [Power supply unit with DALI interface]	Warranty period	5 years
Driver included	Yes	Outdoor optic type	Distribution wide 50
Optical cover/lens type	FG [Flat glass]	Remarks	*-Per Lighting Europe guidance paper **Evaluating performance of LED based
Luminaire light beam spread	23° - 8° x 152°		
Control interface	DALI		
Light regulation	Dimming via external communication DALI		

Quebec LED

	luminaires - January 2018*: statistically there is no relevant difference in lumen maintenance between B50 and for example B10. Therefore the median useful life (B50) value also represents the B10 value. * At extreme ambient temperatures the luminaire might automatically dim down to protect components
Constant light output	No
Number of products on MCB	29
EU RoHS compliant	Yes
LED engine type	LED
Serviceability class	Class A, the luminaire is equipped with serviceable parts (when applicable): LED board, driver, control units, surge-protection device, optics, front cover and mechanical parts
Product Family Code	BRP776 [QUEBEC LED]

Light Technical

Upward light output ratio	0.03
Standard tilt angle post-top	-
Standard tilt angle side entry	0°

Operating and Electrical

Input voltage	220 to 240 V
Input frequency	50 to 60 Hz
Inrush current	15 A
Inrush time	0.295 ms
Power factor (min.)	0.97
Power factor (nom.)	0.92

Controls and Dimming

Dimmable	Yes
----------	-----

Mechanical and Housing

Housing material	Aluminum
Reflector material	-
Optic material	Polymethyl methacrylate
Optical cover/lens material	Glass
Fixation material	Aluminium
Mounting device	No [-]
Optical cover/lens shape	Flat
Optical cover/lens finish	Silkscreen print gray
Fixation type	Side arm lateral
Overall height	388 mm

Overall diameter	472 mm
Effective projected area	0.094 m ²
Colour	Black
Dimensions (height x width x depth)	388 x NaN x NaN mm (15.3 x NaN x NaN in)

Approval and Application

Ingress protection code	IP65 [Dust penetration-protected, jet-proof]
Mech. impact protection code	IK08 [5 J vandal-protected]
Surge protection (common/differential)	Philips standard surge protection level kV

Initial Performance (IEC Compliant)

Initial luminous flux	1328 lm
Luminous flux tolerance	+/-7%
Initial LED luminaire efficacy	125 lm/W
Init. Corr. Colour Temperature	4000 K
Init. Color rendering index	>70
Initial chromaticity	(0.381, 0.379) SDCM <5
Initial input power	10.6 W
Power consumption tolerance	+/-11%

Over Time Performance (IEC Compliant)

Control gear failure rate at median useful life 100,000 h	10 %
Lumen maintenance at median useful life* 100,000 h	95

Application Conditions

Ambient temperature range	-40 to +50 °C
Performance ambient temperature Tq	25 °C
Maximum dimming level	25%

Product Data

Full product code	871869908992400
Order product name	BRP776 LED16-4S/740 PSD DW50 PGR BK D9 S
EAN/UPC - product	8718699089924
Order code	08992400
Numerator - quantity per pack	1
Numerator - packs per outer box	1
Material no. (I2NC)	912300023482
Net weight (piece)	6.175 kg



Quebec LED

Dimensional drawing

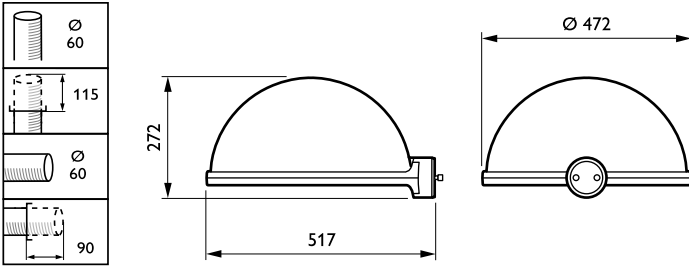

Quebec LED BRP775/776

Photometric data

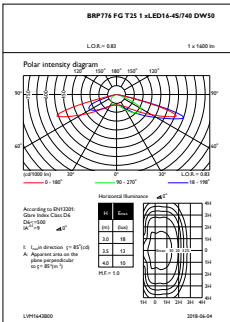

OFPL1_BRP776FGT251xLED16-4S740DW50

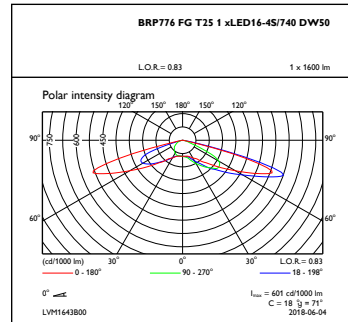

OFPC1_BRP776FGT251xLED16-4S740DW50

