



Harmony 1&2 LED

BGP661 LED84-4S/740 II DM50 FG GR-2900 D

Harmony 2 LED - LED module 8400 lm - 740 neutral white - Safety class II - Distribution medium 50 - Flat glass - Suspension set simple, standard

Harmony LED is based on a clean shape, a modular construction and complementary optical systems. It can be adapted to all styles of setting and types of application. Available in two sizes and designed for heights from 4 to 10 metres, the luminaire can be combined with several brackets and wall-mounted solutions, allowing you to compose varied, yet consistent installations. Harmony LED is the overall lighting solution for classic and contemporary urban settings, delivering outstanding levels of lighting and energy performance thanks to its LED engine and its application-tailored optics. Harmony LED is also equipped with dedicated light recipe that preserves a dark night sky.

Product data

General Information		Protection class IEC	Safety class II
Lamp family code	LED84 [LED module 8400 lm]	Flammability mark	NO [-]
Light source colour	740 neutral white	CE mark	CE mark
Light source replaceable	Yes	ENEC mark	-
Number of gear units	1 unit	Warranty period	5 years
Driver/power unit/transformer	PSD [Power supply unit with DALI interface]	Outdoor optic type	Distribution medium 50
Driver included	Yes	Remarks	*-Per Lighting Europe guidance paper "Evaluating performance of LED based luminaires - January 2018": statistically there is no relevant difference in lumen maintenance between B50 and for example B10. Therefore the median useful life (B50) value also represents the B10 value. * At extreme ambient
Optical cover/lens type	FG [Flat glass]		
Luminaire light beam spread	30° - 5° x 153°		
Control interface	DALI		
Connection	Plug-in connector 4-pole Wieland/Adels compatible		
Cable	-		

Harmony 1&2 LED

	temperatures the luminaire might automatically dim down to protect components
Constant light output	No
Number of products on MCB	11
LED engine type	LED
Product Family Code	BGP661 [Harmony 2 LED]

Light Technical

Upward light output ratio	0.03
Standard tilt angle post-top	0°
Standard tilt angle side entry	0°

Operating and Electrical

Input voltage	220 to 240 V
Input frequency	50 to 60 Hz
Inrush current	46 A
Inrush time	0.25 ms
Power factor (min.)	0.8

Controls and Dimming

Dimmable	Yes
----------	-----

Mechanical and Housing

Housing material	Aluminium
Reflector material	Glass
Optic material	Polymethyl methacrylate
Optical cover/lens material	Glass
Fixation material	Aluminium
Mounting device	SMS [Suspension set simple, standard]
Optical cover/lens shape	Flat
Optical cover/lens finish	Clear
Overall length	805.1 mm
Overall width	805.1 mm
Overall height	656 mm
Overall diameter	656 mm
Effective projected area	0.031 m ²
Colour	Grey
Dimensions (height x width x depth)	656 x 805 x 805 mm (25.8 x 31.7 x 31.7 in)

Approval and Application

Ingress protection code	IP66 [Dust penetration-protected, jet-proof]
Mech. impact protection code	IK09 [10 J]
Surge protection (common/differential)	Philips standard surge protection level kV

Initial Performance (IEC Compliant)

Initial luminous flux	7392 lm
Luminous flux tolerance	+/-7%
Initial LED luminaire efficacy	148 lm/W
Init. Corr. colour temperature	4000 K
Init. colour rendering index	≥70
Initial chromaticity	(0.380, 0.390) SDCM <5
Initial input power	50 W
Power consumption tolerance	+/-11%

Over Time Performance (IEC Compliant)

Control gear failure rate at median useful life 100,000 h	10 %
Lumen maintenance at median useful life* 100,000 h	L91

Application Conditions

Ambient temperature range	-40 to +50 °C
Performance ambient temperature Tq	25 °C
Maximum dimming level	20%

Product Data

Full product code	871869945028100
Order product name	BGP661 LED84-4S/740 II DM50 FG GR-2900 D
EAN/UPC – product	8718699450281
Order code	45028100
Numerator – quantity per pack	1
Numerator – packs per outer box	1
Material no. (12NC)	912300023976
Net weight (piece)	10.170 kg

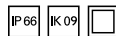

Harmony 1&2 LED

Dimensional drawing

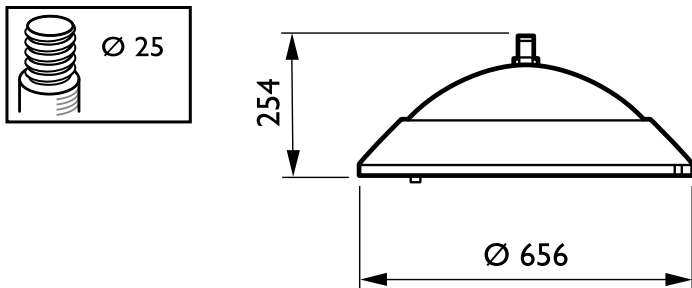

Harmony 1/2 LED BGP660/BGP661

