

PHILIPS

Lighting

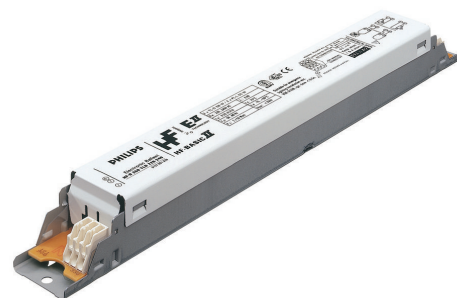

HF-Basic II for TL-D lamps

HF-B 136/236 TL-D EII 220-240V 50/60Hz

Second-generation slim, lightweight HF electronic ballasts for TL-D and PL-L fluorescent lamps, using Philips EII technology for applications with low switching frequency

Product data

General Information

Application code	EII
Type version	mk1
Lamp type	TL-D
Number of lamps	2 piece/unit
Number of products on MCB (16 A type B) (nom.)	28
Automatic restart	Yes

Operating and Electrical

Input voltage	220 to 240 V
Input frequency	50 to 60 Hz
Operating frequency (max.)	- kHz
Operating frequency (min.)	42 kHz
Operating frequency (nom.)	45 kHz
Ignition method	Cold Start
Crest factor (max.)	1.7
Power factor 100% load (nom.)	0.96
Ignition time (max.)	0.5 s
Mains voltage performance (AC)	-8%~+6%
Mains voltage safety (AC)	-10%~+10%

Earth leakage current (nom.)	0.5 mA
Inrush current width	0.25 ms
Constant wattage deviation	-2%/+2%
Ballast factor (nom.)	0.95
Power losses (nom.)	4.0 W
Inrush current peak (max.)	18 A

Wiring

Connector type input terminals	WAGO 251 universal connector [Suitable for both automatic wiring (ALF and ADS) and manual wiring]
Cable capacity output wires mutual (nom.)	120 pF
Connector type output terminals	WAGO 251 universal connector [Suitable for both automatic wiring (ALF and ADS) and manual wiring]
Cable length from device to lamp	2.00 m
Cable length hot-wiring	0.75 m
Wire strip length	8.0-9.0 mm
Dual fixture master/slave	Yes [Master/Slave operation possible]
Input terminal cross section	0.50-1.00 mm ²
Output terminal cross section	0.50-1.00 mm ²
Auto Insert (ALF/ADS) Wire Cross Section	0.5 mm ²

HF-Basic II for TL-D lamps

Cable capacity output wires to earth (nom.)	120 pF
System characteristics	
Rated ballast-lamp power	36 W
Rated lamp power on TL-D	36 W
System power on TL-D	36.5 W
Lamp power on TL-D	32 W
Power loss on TL-D	4.5 W
Temperature	
T ambient (max.)	50 °C
T ambient (min.)	-15 °C
T storage (max.)	80 °C
T storage (min.)	-40 °C
T case lifetime (nom.)	75 °C
T-Case maximum (max.)	75 °C
T-Ignition (max.)	50 °C
T-Ignition (min.)	-15 °C
Mechanical and Housing	
Housing	- [Not Specified]
Emergency Operation	
Battery voltage lamp ignition	198-254 V
Battery voltage lamp operation	176-254
Approval and Application	
Energy efficiency index	A2
EMI 9 kHz... 30 MHz	EN55015

EMI 30 MHz... 1,000 MHz	EN55022 level A
Safety standard	IEC 61347-2-3
Performance standard	IEC 60929
Quality standard	ISO 9000:2000
Environmental standard	ISO 14001
Harmonic current emission standard	IEC 61000-3-2
EMC immunity standard	IEC 61547
Vibration standard	IEC68-2-6 F c
Bumps standard	IEC 68-2-29 Eb
Humidity standard	EN 61347-2-3 clause 11
Approval marks	CE marking ENEC certificate VDE-EMV certificate
Temperature marking	Yes
Emergency standard	IEC 60598-2-22
Humming and noise level	Inaudible

Product Data

Full product code	871150093158030
Order product name	HF-B 136/236 TL-D EII 220-240V 50/60Hz
EAN/UPC – product	8711500931580
Order code	93158030
Local Code	HFB236TLDEII
Numerator – quantity per pack	1
Numerator – packs per outer box	12
Material no. (12NC)	913700192866
Net weight (piece)	0.215 kg

Dimensional drawing

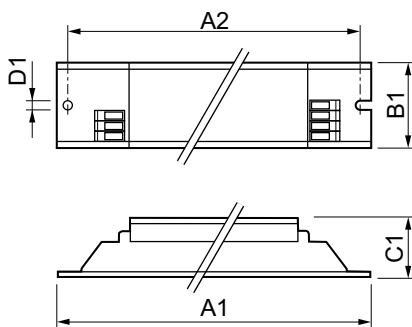

HF-B 236 TL-D EII 220-240V 50/60Hz

Product	D1	C1	A1	A2	B1
HF-B 136/236 TL-D EII 220-240V 50/60Hz	4.2 mm	28.0 mm	280.0 mm	265.0 mm	30.0 mm

HF-Basic II for TL-D lamps

