



# HID-HighPower for SON/MH/HPL/HPI

## BHL 2000 L76 380/400/415V 50HZ HP-317

Encapsulated ballasts for use with SON (T) (Plus), HPL, HPI and MH lamps with rated wattages of 1000 W and above

### Product data

<b>Operating and Electrical</b>		<b>Full product name</b>		BHL 2000 L76 380/400/415V 50HZ HP-317
Input Voltage	380 to 415 V	<b>Full EOC</b>		871150006384700
Line Frequency	50 Hz	<b>Order code</b>		06384700
Input frequency	50 Hz	<b>Material no. (12 NC)</b>		913700217903
		<b>Local order code</b>		BHL2000L76
<b>Wiring</b>		<b>SAP numerator – quantity per pack</b>		1
Connector type	Screw	<b>EAN/UPC — Product/Case</b>		8711500996664
		<b>Numerator – packs per outer box</b>		1
<b>Approval and Application</b>		<b>EAN/UPC - Case</b>		8711500063847
Approval marks	CE marking ENEC certificate			
<b>Product Data</b>				
Order product name	BHL 2000 L76-A2 380/400/415V 50Hz HP-317			

# HID-HighPower for SON/MH/HPL/HPI

## Dimensional drawing

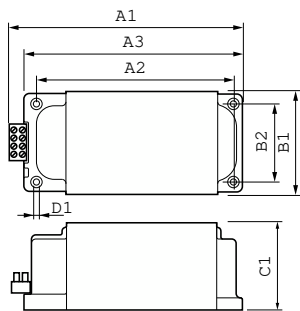

Product	D1	C1	A1	A2	A3	B1	B2
BHL 2000 L76-A2	6.5	102.0	317.0	282.0	306.0	117.0	88.0
380/400/415V 50Hz	mm	mm	mm	mm	mm	mm	mm
HP-317							

