



HID-High Power Basic for SON/MH/HPL

BMH 2000 L5018-A

Basic aluminum/iron ballasts for use with SON (T) (Plus), HPL, HPI and MH lamps with rated wattages of 1000 W and above • Basic aluminum/iron ballasts for use with SON (T) (Plus), HPL, HPI and MH lamps with rated wattages of 1000 W and above

Product data

General Information	
Application code	L5018-A2-A
Design	MHN
Lamp type	MHN-LA/FC
Number of lamps	1 piece/unit
Operating and Electrical	
Input voltage	380 to 415 V
Input frequency	50 Hz
Input voltage (multi-tab)	380/400/415
Mains voltage performance (AC)	-8%~+6%
Mains voltage safety (AC)	-10%~+10%
Wiring	
Wire strip length	7.0 mm
Ballast contact wire cross section	0.70-6.00 mm ²
Connector type	Screw
System characteristics	
Rated ballast-lamp power	2000 W
Recommended ignitor	Series ignitor

Temperature	
T storage (max.)	80 °C
T storage (min.)	-25 °C
T winding (max.)	130 °C
Delta-T normal conditions	60/80 °C

Approval and Application	
Approval marks	CE marking ENEC certificate

Product Data	
Full product code	871829111851000
Order product name	BMH 2000 L5018-A2-A
EAN/UPC – product	8718291118510
Order code	11851000
Local Code	BMH2000L5018
Numerator – quantity per pack	1
Numerator – packs per outer box	1
Material no. (12NC)	913700275326
Net weight (piece)	17.000 kg

HID-High Power Basic for SON/MH/HPL

Dimensional drawing

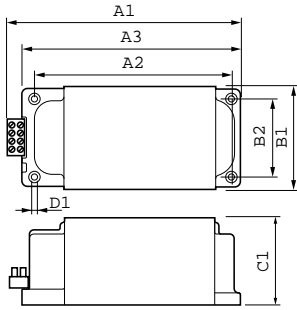

Product	D1	C1	A1	A2	A3	B1	B2
BMH 2000	6.5	111.0	317.0	284.0	317.0	126.0	106.0
L5018-A2-A	mm	mm	mm	mm	mm	mm	mm

BMH 2000 L5018-A

