

HID-Basic BHL MK4 for HPL/HPI

BHL 400 K307-A2 230/240V 50Hz BC2-160

Impregnated electromagnetic copper/iron ballasts for HPL, HPI (Plus) and SON-H lamps

Product data

| | |
|--------------------------|---------------------------------------|
| Operating and Electrical | |
| Input Voltage | 230 V (default) or 240 V |
| Line Frequency | 50 Hz |
| Input Frequency | 50 Hz |
| | |
| Wiring | |
| Connector Type | Screw |
| | |
| Approval and Application | |
| Approval Marks | CE marking ENEC certificate |
| | |
| Product Data | |
| Order product name | BHL 400 K307-A2 230/240V 50Hz BC2-160 |

| | |
|---------------------------------|---------------------------------------|
| Full product name | BHL 400 K307-A2 230/240V 50Hz BC2-160 |
| Full product code | 872790088703700 |
| Order code | 913700278226 |
| Material Nr. (12NC) | 913700278226 |
| Numerator - Quantity Per Pack | 1 |
| EAN/UPC - Product/Case | 8711500881595 |
| Numerator - Packs per outer box | 6 |
| EAN/UPC - Case | 8727900887037 |

HID-Basic BHL MK4 for HPL/HPI

Dimensional drawing

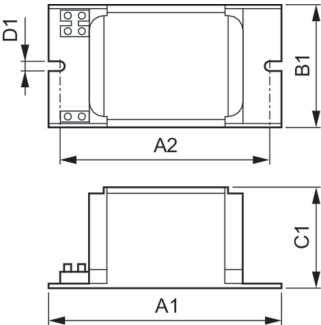

| Product | D1 | C1 | A1 | A2 | B1 |
|-------------------------------|--------|---------|----------|----------|---------|
| BHL 400 K307-A2 230/240V 50Hz | 6.2 mm | 65.0 mm | 160.0 mm | 139.0 mm | 76.0 mm |
| BC2-160 | | | | | |

