



HID-Basic BHL for HPL/HPI

BHL 400 K202 230V 50Hz BC2-151

Impregnated electromagnetic copper/iron ballasts for HPL, HPI (Plus) and SON-H lamps

Product data

Operating and Electrical		Full product name	BHL 400 K202 230V 50Hz BC2-151
Input Voltage	230 V	Full product code	872790094076300
Line Frequency	50 Hz	Order code	94076300
Input Frequency	50 Hz	Material Nr. (12NC)	913700284626
Wiring		Numerator - Quantity Per Pack	1
Connector Type	Screw	EAN/UPC - Product/Case	8727900940763
Approval and Application		Numerator - Packs per outer box	6
Approval Marks	CE marking ENEC certificate	EAN/UPC - Case	8727900940770
Product Data			
Order product name	BHL 400 K202-A2 230V 50Hz BC2-151		

HID-Basic BHL for HPL/HPI

Dimensional drawing

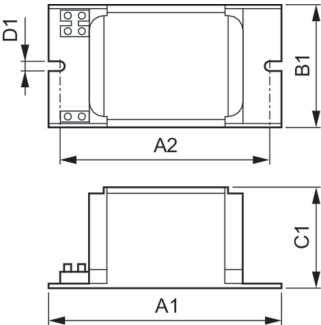

Product	D1	C1	A1	A2	B1
BHL 400 K202-A2 230V 50Hz	6.2 mm	65.0 mm	150.0 mm	129.0 mm	76.0 mm
BC2-151					

