



PrimaVision Power for CDM

HID-PV C 150 /S CDM 220-240V 50/60Hz

PrimaVision Power gear is designed for optimal performance of 100 and 150 W CDM lamps – ideal where high-intensity light is key.

Product data

Operating and Electrical	
Input Voltage	220 to 240 V
Line Frequency	50 to 60 Hz
Input frequency	50 to 60 Hz
Earth leakage current (max.)	0.35 mA
Inrush current width	.50 ms
Inrush current peak (max.)	50 A
Number of products on MCB (16 A type B) (nom.)	6
Wiring	
Cable length from device to lamp	2.0 m
Connector type	Insert
Temperature	
Ambient temperature range	-20°C to 60°C
T-case lifetime (nom.)	75 °C
T-Case maximum (max.)	85 °C
Mechanical and Housing	
Housing	/S

Approval and Application	
Approval marks	F-Marking CE marking VDE certificate VDE-EMV certificate CB certificate
Product Data	
Order product name	HID-PV C 150 /S CDM 220-240V 50/60Hz
Full product name	HID-PV C 150 /S CDM 220-240V 50/60Hz
Full EOC	871150091052330
Order code	91052330
Material no. (12 NC)	913700614066
Local order code	HIDPVC150S
SAP numerator – quantity per pack	1
EAN/UPC – Product/Case	8711500910523
Numerator – packs per outer box	12
EAN/UPC - Case	8711500910530

PrimaVision Power for CDM

Dimensional drawing

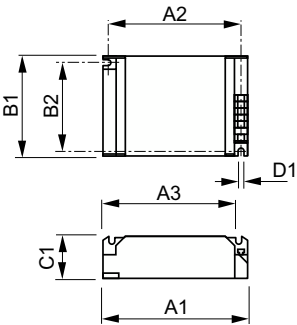

Product	D1	C1	A1	A2	B1	B2
HID-PV C 150 /S CDM 220-240V 50/60Hz	4.8 mm	32.0 mm	135.0 mm	123.5 mm	75.0 mm	63.5 mm

