

PrimaVision Power for CDM

HID-PV C 100 /I CDM 220-240V SOFT START

PrimaVision Power gear is designed for optimal performance of 100 and 150 W CDM lamps – ideal where high-intensity light is key.

Product data

Operating and Electrical	
Input Voltage	220 to 240 V
Line Frequency	50 to 60 Hz
Input Frequency	50 to 60 Hz
Earth Leakage Current (Max)	0.25 mA
Inrush Current Width	0.40 ms
Inrush Current Peak (Max)	40 A
Number of Products on MCB (16A Type B) (Nom)	17
Wiring	
Cable Length From Device to Lamp	2 m
Connector Type	Insert
Temperature	
Ambient temperature range	-20 °C to 45 °C
T-Case Lifetime (Nom)	75 °C
T-Case Maximum (Max)	75 °C
Mechanical and Housing	
Housing	/I

Approval and Application	
Ingress protection code	IP20 [Finger-protected]
Safety Standard	EN60928, 60926
Environmental Standard	ISO 14001
Approval Marks	CE marking ENEC certificate
Product Data	
Order product name	HID-PV C 100 /I CDM 220-240V 50/60Hz G5
Full product name	HID-PV C 100 /I CDM 220-240V SOFT START
Full product code	872790089951100
Order code	89951100
Material Nr. (12NC)	913700656366
Numerator - Quantity Per Pack	1
EAN/UPC - Product/Case	8711500881847
Numerator - Packs per outer box	10
EAN/UPC - Case	8727900899511

PrimaVision Power for CDM

Dimensional drawing

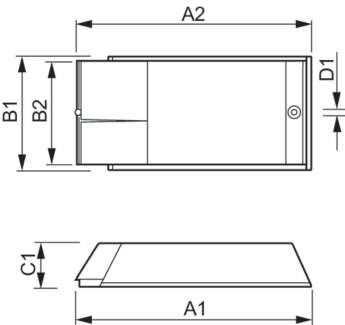

Product	D1	C1	A1	A2	B1	B2
HID-PV C 100 /I CDM 220-240V 50/60Hz G5	4.8 mm	34.2 mm	223.9 mm	206 mm	82.7 mm	38.6 mm

