

PHILIPS

Lighting



Electronic semi-parallel ignitor for HID lamp circuits

SN 58 T15

HID ignitors for semi-parallel systems

Product data

General Information	
Application Code	58 T15

Operating and Electrical	
Input Voltage	220 to 240 V
Input Frequency	50 to 60 Hz
Igniton Type	Semi-Parallel
Ignition Time (Max)	18 s
Ignition Time (Min)	12 s
Ignition Time (Nom)	15 s
Ignition Voltage (Max)	5.0 kV
Ignition Voltage (Min)	2.8 kV
Response Voltage	195 V
Mains Voltage Performance (AC)	-8%~+6%
Mains Voltage Safety (AC)	-10%~+10%
Power Losses (Nom)	1 W

Wiring	
Ballast Contact Wire Cross Section	0.50-2.50 mm ²
Connector Type	Screw

Temperature	
T-Ambient (Max)	75 °C
T-Ambient (Min)	-20 °C
T-Case Maximum (Max)	80 °C

Mechanical and Housing	
Housing	Akulon S223

Approval and Application	
Approval Marks	CE marking ENEC certificate

Product Data	
Full product code	697013372879600
Order product name	SN 58 T15
EAN/UPC - Product	6970133728796
Order code	913710010413
Numerator - Quantity Per Pack	1
Numerator - Packs per outer box	48
Material Nr. (12NC)	913710010413
Net Weight (Piece)	0.049 kg

Electronic semi-parallel ignitor for HID lamp circuits

Dimensional drawing

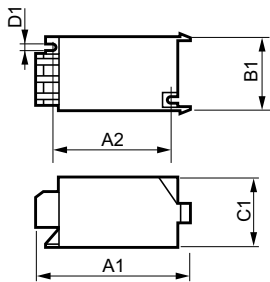

Product	C1	A1	A2	B1
SN 58 T15	38.5 mm	85.5 mm	65.0 mm	41.5 mm

SN 58 T15

