

# HID-High Power ballasts for HPL and HPI lamps

## BHL 1000L 202

The HID High-Power ballast is an impregnated (HID standard) electromagnetic copper/iron ballast for use with an external ignitor for HID lamps.

### Product data

General Information		Temperature	
Application Code	L202	T-Winding (Max)	130 °C
		Delta-T Normal Conditions	75 °C
Operating and Electrical		Approval and Application	
Input Voltage	230 V	Approval Marks	CE marking CCC certificate
Input Frequency	50 Hz		
Power Factor 100% Load (Min)	0.85	Product Data	
Mains Voltage Performance (AC)	-8%~+6%	Full product code	694818229967300
Mains Voltage Safety (AC)	-10%~+10%	Order product name	BHL 1000L 202
Input Current with PF Correction	5.3 A	EAN/UPC - Product	6948182295354
Input Current without PF Correction	7.5 A	Order code	913710104942
Power Factor without PF Compensation (Nom)	60	Numerator - Quantity Per Pack	1
Power Losses (Nom)	39 W	Numerator - Packs per outer box	1
Wiring		Material Nr. (12NC)	913710104942
Connector Type	Screw	Net Weight (Piece)	6.900 kg
System characteristics			
Rated Ballast-Lamp Power	1000 W		

# HID-High Power ballasts for HPL and HPI lamps

## Dimensional drawing

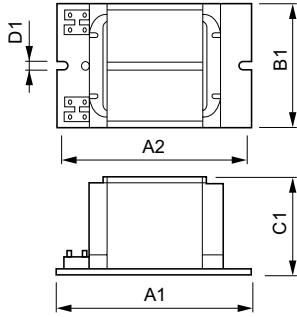

Product

BHL 1000L 202

BHL 1000 L202

