



# HID-Basic ballasts for HPL and HPI(PLUS) lamps

## BHL E 400 L202

The HID-Basic ballast is an impregnated (HID standard) electromagnetic ballast for HID lamps, for use in combination with an external ignitor.

### Product data

Operating and Electrical	
Input Voltage	230 V
Line Frequency	50 Hz
Input Frequency	50 Hz
Wiring	
Connector Type	Screw
Approval and Application	
Approval Marks	CE marking
Product Data	
Order product name	BHLE 400L 202

Full product name	BHL E 400 L202
Full product code	872790084180000
Order code	84180000
Material Nr. (12NC)	913713017650
Numerator - Quantity Per Pack	1
EAN/UPC - Product/Case	8711500997913
Numerator - Packs per outer box	6
EAN/UPC - Case	8727900841800

HID-Basic ballasts for HPL and HPI(PLUS) lamps

Dimensional drawing

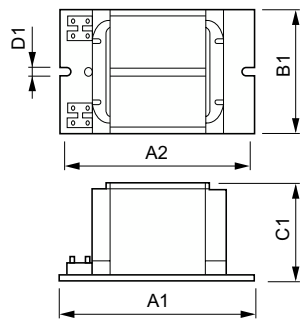

Product	D1	C1	A1	A2	B1
BHLE 400L 202	6.2 mm	64.5 mm	165.0 mm	144.0 mm	75.5 mm

