



HID-Basic ballasts for HPL and HPI(PLUS) lamps

BHLA 125L 200

The HID-Basic ballast is an impregnated (HID standard) electromagnetic ballast for HID lamps, for use in combination with an external ignitor.

Product data

General Information		Temperature	
Application Code	L200	T-Winding (Max)	130 °C
		Delta-T Normal Conditions	70 °C
Operating and Electrical		Approval and Application	
Input Voltage	220 V	Approval Marks	CE marking CCC certificate
Input Frequency	50 Hz		
Power Factor 100% Load (Min)	0.55	Product Data	
Mains Voltage Performance (AC)	-8%~+6%	Full product code	872790095590300
Mains Voltage Safety (AC)	-10%~+10%	Order product name	BHLA 125L 200
Input Current with PF Correction	1.95 A	EAN/UPC - Product	8711500999863
Input Current without PF Correction	2.18 A	Order code	913713018659
Power Factor without PF Compensation (Nom)	0.85	Numerator - Quantity Per Pack	1
Power Losses (Nom)	14.2 W	Numerator - Packs per outer box	6
Wiring		Material Nr. (12NC)	913713018659
Connector Type	Screw	Net Weight (Piece)	1.250 kg
System characteristics			
Rated Ballast-Lamp Power	125 W		

HID-Basic ballasts for HPL and HPI(PLUS) lamps

Dimensional drawing

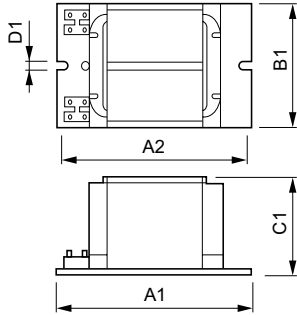

Product	D1	C1	A1	A2	B1
BHLA 125L 200	6.3 mm	64.5 mm	120.0 mm	100.0 mm	75.0 mm

BHLA 125 L200

