



HF-Selectalume II for TL5 lamps

HF-S 114-21 TL5 II 220-240V 50/60Hz

HF-Selectalume II TL5 is the most cost-effective, reliable and outstanding solution for fluorescent lamps. These ballasts are part of an overall high-efficiency lighting system that may help you or your customers to achieve any international or local energy code you need to comply with. HF-Selectalume II TL5 ballasts are the ideal choice for a broad range of new construction and retrofit applications within the commercial sector, including general surface mounting or office lighting, parking garages, warehouses, waterproof and other applications. The ballast is primarily designed for Indoor application. For outdoor application, the luminaire should be minimum Classland need to be sufficiently protected against water & dust. The installation should also be guard against any lightening surge or any other necessary electrical protection as deemed in such typical installation & application.

Product data

Operating and Electrical		T-Case Lifetime (Nom) 75 °C	
Input Voltage	220 to 240 V	T-Case Maximum (Max) 75 °C	
Line Frequency	50 to 60 Hz		
Input Frequency	50 to 60 Hz	Mechanical and Housing	
Earth Leakage Current (Max)	0.5 mA	Housing L 280x30x21	
Inrush Current Width	0.25 ms		
Inrush Current Peak (Max)	20 A	Approval and Application	
		Ingress protection code IP20 [Finger-protected]	
		Energy Efficiency Index A2	
		Approval Marks F-Marking CE marking ENEC certificate CCC certificate C-Tick certificate PSB certification TISI marking SIRIM approval CB Certificate CCC certificate VDE-EMV certificate	
Wiring			
Connector Type Input Terminals	WAGO 744 connector		
Connector Type Output Terminals	WAGO 744 connector [Suitable for manual wiring]		
Temperature			
Ambient temperature range	-15 °C to 50 °C		

HF-Selectalume II for TL5 lamps

Product Data	
Order product name	HF-S 114-21 TL5 II 220-240V 50/60Hz
Full product name	HF-S 114-21 TL5 II 220-240V 50/60Hz
Full product code	872790090556400
Order code	913713032866
Material Nr. (12NC)	913713032866

Numerator - Quantity Per Pack	1
EAN/UPC - Product/Case	8711500999337
Numerator - Packs per outer box	12
EAN/UPC - Case	8727900905564

Dimensional drawing

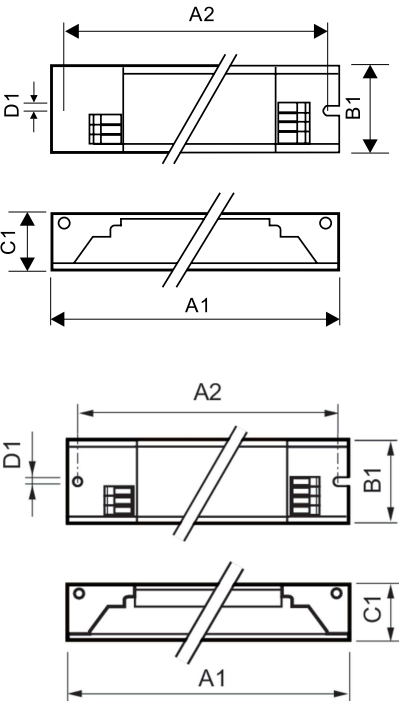

Product
HF-S 114-21 TL5 II 220-240V 50/60Hz

Product	A1	B1	C1	A2	B2	D1
HF-S 114-21 TL5 II 220-240V 50/60Hz	280 mm	30 mm	21 mm	265 mm		4.2 mm

