



HF-Selectalume II for TL5 lamps

HF-S 149 TL5 II 220-240V 50/60Hz

HF-Selectalume II TL5 is the most cost-effective, reliable and outstanding solution for fluorescent lamps. These ballasts are part of an overall high-efficiency lighting system that may help you or your customers to achieve any international or local energy code you need to comply with. HF-Selectalume II TL5 ballasts are the ideal choice for a broad range of new construction and retrofit applications within the commercial sector, including general surface mounting or office lighting, parking garages, warehouses, waterproof and other applications.

Product data

Operating and Electrical		Mechanical and Housing	
Input Voltage	220 to 240 V	Housing	L 280x30x21
Line Frequency	50 to 60 Hz		
Input Frequency	50 to 60 Hz	Approval and Application	
Earth Leakage Current (Max)	0.5 mA	Ingress protection code	IP20 [Finger-protected]
Inrush Current Width	0.25 ms	Energy Efficiency Index	A2 BAT
Inrush Current Peak (Max)	20 A	Approval Marks	F-Marking CE marking ENEC certificate CCC certificate C-Tick certificate PSB certification TISI marking SIRIM approval CB Certificate CCC certificate VDE-EMV certificate
Wiring			
Connector Type Input Terminals	WAGO 744 connector	Product Data	
Connector Type Output Terminals	WAGO 744 connector [Suitable for manual wiring]	Order product name	HF-S 149 TL5 II 220-240V 50/60Hz
Temperature		Full product name	HF-S 149 TL5 II 220-240V 50/60Hz
Ambient temperature range	-15 °C to 50 °C	Full product code	872790090558800
T-Case Lifetime (Nom)	75 °C	Order code	90558800
T-Case Maximum (Max)	75 °C	Material Nr. (12NC)	913713033466
		Numerator - Quantity Per Pack	1

HF-Selectalume II for TL5 lamps

EAN/UPC - Product/Case	8711500999351
Numerator - Packs per outer box	12
EAN/UPC - Case	8727900905588

Dimensional drawing

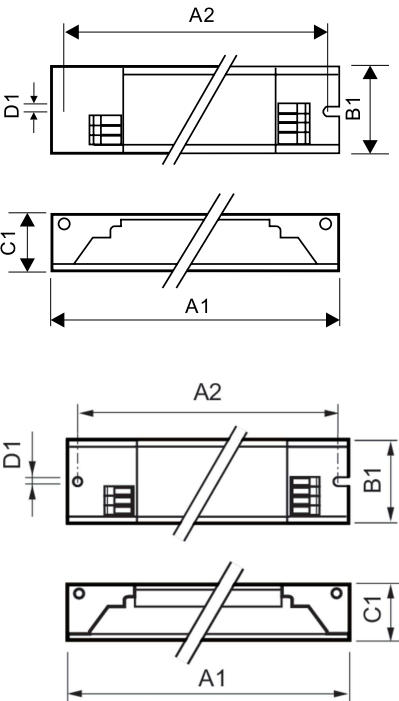

Product
HF-S 149 TL5 II 220-240V 50/60Hz

Product	A1	B1	C1	A2	B2	D1
HF-S 149 TL5 II 220-240V 50/60Hz	280 mm	30 mm	21 mm	265 mm		4.2 mm

