



HF-Selectalume II for TL5 lamps

HF-S 149 TL5 II 220-240V 50/60Hz

HF-Selectalume II TL5 is the most cost-effective, reliable and outstanding solution for fluorescent lamps. These ballasts are part of an overall high-efficiency lighting system that may help you or your customers to achieve any international or local energy code you need to comply with. HF-Selectalume II TL5 ballasts are the ideal choice for a broad range of new construction and retrofit applications within the commercial sector, including general surface mounting or office lighting, parking garages, warehouses, waterproof and other applications. The ballast is primarily designed for Indoor application. For outdoor application, the luminaire should be minimum Classland need to be sufficiently protected against water & dust. The installation should also be guard against any lightening surge or any other necessary electrical protection as deemed in such typical installation & application.

Product data

Operating and Electrical		T-Case Lifetime (Nom)		75 °C
Input Voltage	220 to 240 V	T-Case Maximum (Max)		75 °C
Line Frequency	50 to 60 Hz			
Input Frequency	50 to 60 Hz			
Earth Leakage Current (Max)	0.5 mA			
Inrush Current Width	0.25 ms			
Inrush Current Peak (Max)	20 A			
Wiring				
Connector Type Input Terminals	WAGO 744 connector			
Connector Type Output Terminals	WAGO 744 connector [Suitable for manual wiring]			
Temperature				
Ambient temperature range	-15 °C to 50 °C			

		T-Case Lifetime (Nom)		75 °C
		T-Case Maximum (Max)		75 °C
Mechanical and Housing				
Housing		L 280x30x21		
Approval and Application				
Ingress protection code		IP20 [Finger-protected]		
Energy Efficiency Index		A2 BAT		
Approval Marks		F-Marking CE marking ENEC certificate CCC certificate C-Tick certificate PSB certification TISI marking SIRIM approval CB Certificate CCC certificate VDE-EMV certificate		

HF-Selectalume II for TL5 lamps

Product Data	
Order product name	HF-S 149 TL5 II 220-240V 50/60Hz
Full product name	HF-S 149 TL5 II 220-240V 50/60Hz
Full product code	872790090558800
Order code	913713033466
Material Nr. (12NC)	913713033466

Numerator - Quantity Per Pack	1
EAN/UPC - Product/Case	8711500999351
Numerator - Packs per outer box	12
EAN/UPC - Case	8727900905588

Dimensional drawing

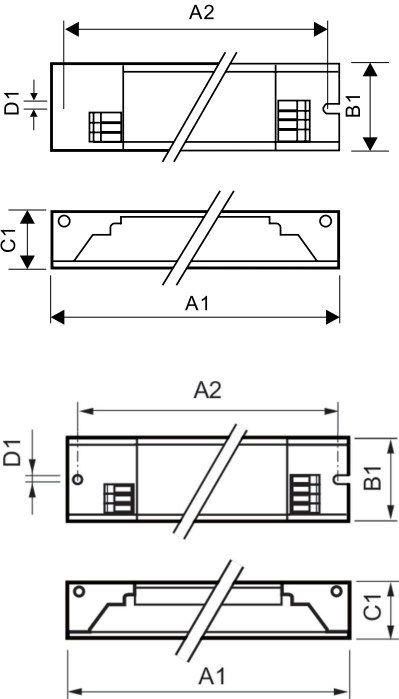

Product
HF-S 149 TL5 II 220-240V 50/60Hz

Product	A1	B1	C1	A2	B2	D1
HF-S 149 TL5 II 220-240V 50/60Hz	280 mm	30 mm	21 mm	265 mm		4.2 mm

